

- NUMBERED NOTES**
- 1 Provide and install 8000 MBH gas service and meters at 2 PS.
 - 2 New 6000 MBH gas service and meters.
 - 3 Run piping up in joists, top of UON.
 - 4 Exposed condensate piping from RTU's shall be connected to existing roof top gas vent at rear building.
 - 5 Coordinate gas and condensate piping with mechanical contractor to confirm provide as required. Connections are for field purposes only.
 - 6 Piping down to roof.
 - 7 Do not use existing piping to existing rooftop and gas meter.
 - 8 Connect gas to piping to existing rooftop with gas meter.

- NOTES**
- Gas pipe header behind cooking equipment shall be installed at 18" AFF, unless otherwise directed by Lucky's construction manager - verify prior to installation, and provide as directed. Cooking equipment supply pipe branches shall be corrugated stainless steel off the Schedule 40 steel header.
- Contractor shall provide and install equipment contractor chains of adequate length to allow for movement of equipment for cleaning and service, but not too long to allow for damage to gas piping or connections.
- Gas piping shall be run under the roof, UON.
- Contractor shall verify size and exact location of existing gas piping. Re-use piping if compliant with plans.

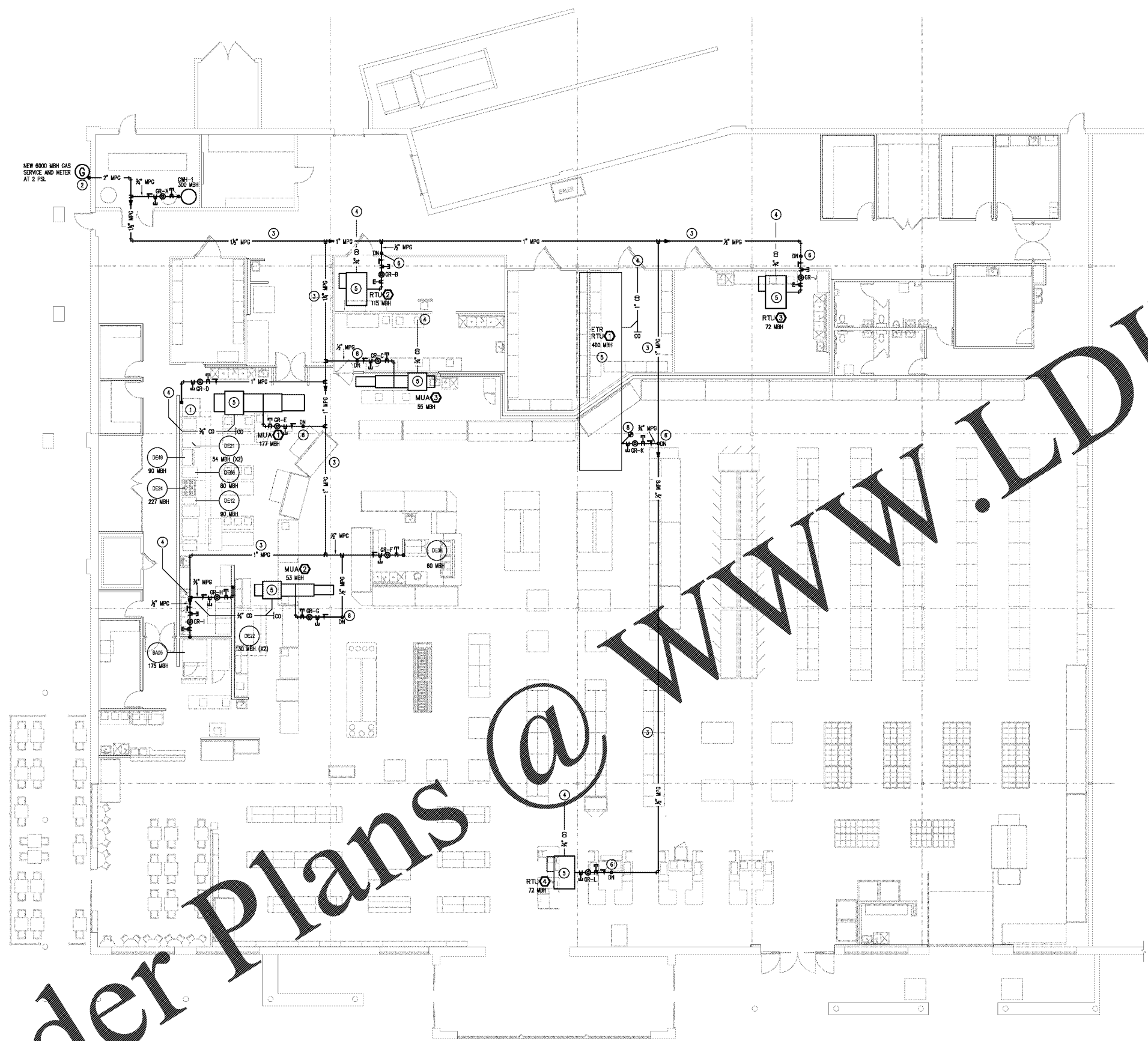

1 GAS PLAN
P401 1/8" = 1'-0"

Order Plans @ WWW.LDILLINE.COM

Lucky's Market

LUCKY'S MARKET
6420 NAPLES BLVD.
NAPLES, FLA. 34108

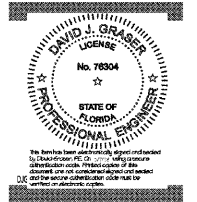

REVISIONS

PERMIT ISSUE
APRIL 27, 2019
BID ISSUE 04/27/19
STORE NUMBER
57

WD PROJECT NUMBER
LKYUP011

P401

GAS PLAN