

OCCUPANCY		FIXTURES REQUIRED		FIXED (2017) FLORIDA PLUMBING CODE	
TYPE	LOAD	REQ. W.C.	REQ. LAV.	MALE	FEMALE
MERCANTILE	222	1:500	1:750		
BUSINESS	9	1:25	1:40	2:1 UR	2:1 WC
STORAGE/PROP.	24	1:100	1:100	3:1 LAV	3:1 LAV
ASSEMBLY	100	1:100	1:100		

TOTAL OCCUPANT LOAD = 465
1st. 32 exterior patio dining seats
HIGH FLOW DRINK FOUNTAINS PROVIDED PER TABLE 402.1

- ### GENERAL NOTES
- REFER TO SHEET 06T FOR DOOR SIZES AND HARDWARE
 - SEE SHEET 06T3 & 06T4 FOR ADDITIONAL ACCESSIBILITY REQUIREMENTS
 - MEANS OF EGRESS PATH AND EXIT DISCHARGE SHALL BE ILLUMINATED AT ALL TIMES WHILE THE BUILDING IS OCCUPIED. MINIMUM LIGHT LEVEL SHALL BE 1 FOOT CANDLE. SEE ELECTRICAL DRAWINGS FOR EMERGENCY AND EXIT LIGHTING.
 - EXIT SIGNS SHALL BE WORDED "EXIT" IN LETTERS HAVING A PRINCIPLE STROKE OF NOT LESS THAN 3/4" WIDE AND AT LEAST 6" HIGH AND SHALL CONFORM TO CODES AND/OR APPLICABLE REGULATIONS. EXIT SIGNS SHALL BE INTERNALLY ILLUMINATED (MIN 90 MINUTE) AND PROVIDED WITH TWO SEPARATE POWER SUPPLIES. SEE ELECTRICAL DRAWINGS FOR LOCATIONS AND ADDITIONAL INFORMATION.
 - EXIT DOORS MUST BE OPENABLE FROM EGRESS SIDE WITHOUT USE OF A KEY, SPECIAL KNOWLEDGE OR EFFORT.
 - SEE ELECTRICAL AND FIRE ALARM DRAWINGS FOR FIRE ALARM, HORN, STROBES AND OTHER FIRE ALARM DEVICES.

- ### KEYED NOTES
- BREAKAWAY AUTOMATIC SLIDING DOORS WITH MOTION SENSORS. INSTALL EXIT SIGN AT INTERNATIONAL SYMBOL OF ACCESSIBILITY OR OR ADJACENT TO BUILDING ENTRANCE PER PLACE PER CODE. SEE SCHEDULE FOR ADDITIONAL INFORMATION.
 - BARRIER FREE EXIT DOOR AND CONCRETE LANDING. EACH GRADE LEVEL BARRIER FREE EXTERIOR EXIT DOOR SHALL BE IDENTIFIED BY A TACTILE EXIT SIGN WITH "EXIT" PLACE PER CODE. SEE SCHEDULE FOR ADDITIONAL INFORMATION.
 - GENERAL CONTRACTOR TO PROVIDE AND INSTALL OCCUPANT TALKING SIGNS, POSTED IN CONSPICUOUS LOCATION AS DIRECTED BY THE LOCAL BUILDING INSPECTOR. KEY QUANTITY, VERBAGE, AND FINAL LOCATIONS WITH THE INSPECTOR ON SITE.
 - GENERAL CONTRACTOR TO PROVIDE AND INSTALL ALL ACCESSIBLE FLOOR RISE LOCATION(S), POSTED IN CONSPICUOUS LOCATION AS DIRECTED BY THE LOCAL BUILDING INSPECTOR. KEY QUANTITY, VERBAGE, AND FINAL LOCATIONS WITH THE INSPECTOR ON SITE.
 - LOCATION OF EXISTING FIRE PROTECTION SPRINKLER SYSTEM.
 - THIS ROOM TO BE IDENTIFIED BY OWNER FOR FIRE RATED CONSTRUCTION.

BUILDING CODE ANALYSIS (FOR CONSTRUCTION & EGRESS)

FLORIDA BUILDING CODE (2017)
FLORIDA FIRE CODE (2017)
DEFINITIONS AND ABBREVIATIONS

- Mixed Use Occupancy
- Means of Egress
- Occupancy
- Tenant Space Height and Area
- Fire Alarm
- Incidental Use Areas (Section 509)
- Accessories (Section 508)
- Construction requirements
- Building element fire-resistive requirements in hours (table 601)
- Occupant load calculations for egress
- Exit capacity (1005)
- Exit capacity calculations
- Exit arrangement
- Exit doors (1008.1.1)
- Alone (NFA 101.1)

wd

107 DISCOVERY BLVD
LIN, OH 4
814 747 000 T
WDP@WENERS.COM

Lucky's Market

LUCKY'S MARKET
PROMENADE AT NAPLES
6424 NAPLES BLVD.
NAPLES, FL 34109

REVISONS

PERMIT ISSUE
MAY 7, 2018
BID ISSUE 05/07/18
STORE NUMBER
57
WD PROJECT NUMBER
LKYU0011

G0.2 LIFE SAFETY PLAN AND NOTES

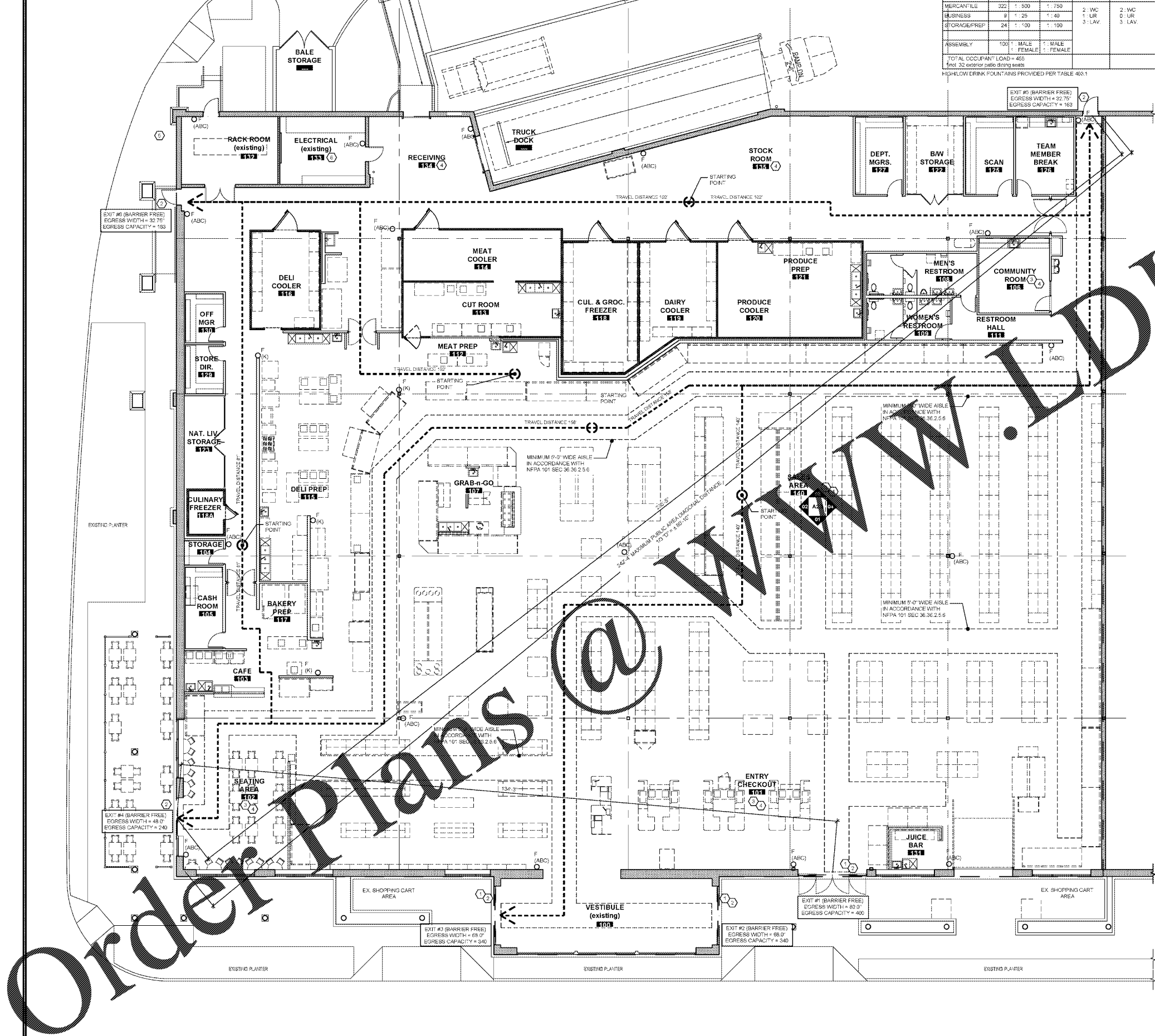

LEGEND:

(E) PROPOSED FIRE EXTINGUISHER LOCATION (FOR USE ON TYPE A, B & C FIRES) - COORDINATE FINAL LOCATIONS WITH FIRE AUTHORITY HAVING JURISDICTION AND LUCKY'S
 (K) PROPOSED FIRE EXTINGUISHER LOCATION (FOR USE ON GREASE FIRES) - COORDINATE FINAL LOCATIONS WITH FIRE AUTHORITY HAVING JURISDICTION AND LUCKY'S
 (F) FIRE EXTINGUISHER LOCATIONS AND QUANTITIES SHOWN FOR BID REFERENCE ONLY. THE FINAL LOCATIONS AND QUANTITIES SHALL BE AS APPROVED BY THE LOCAL FIRE DEPARTMENT REQUIREMENTS