

Order Plans @ www.LDILine.com

KEYNOTES

- 16.145 CONNECT TO EXISTING BRANCH CIRCUIT. VERIFY PRIOR TO ROUGH-IN THAT EXISTING CIRCUIT HAS CAPACITY TO ACCOMMODATE NEW LOAD. VERIFY CONDITION OF BRANCH CIRCUIT, CONDUIT AND WIRE PRIOR TO USE TO INSURE THAT THEY MEET ALL U.L. RATINGS AND REPLACE AS REQUIRED.
- 16.W13 WATER HEATERS: A. DISCONNECT EXISTING, AND RECONNECT NEW WATER HEATERS. COORDINATE WITH MECHANICAL CONTRACTOR. B. FURNISH AND INSTALL HANDLE LOCKS (LOCK OFF) ON ALL CIRCUIT BREAKERS FEEDING WATER HEATERS.



REDESIGN COLLABORATIVE
1301 E. 30th St., #110
Arlington, VA 22204
703.261.5665
rd@re-design.com

STIPULATION FOR THE CONTRACTOR: THE CONTRACTOR SHALL VERIFY ALL EXISTING CONDITIONS PRIOR TO ROUGH-IN. THE CONTRACTOR SHALL FIELD VERIFY ALL EXISTING CONDITIONS PRIOR TO SUBMITTING FINAL BIDS. CONTRACTOR SHALL CAREFULLY COORDINATE NEW WORK AND DEMOLITION WITH ALL OTHER DISCIPLINES AND EXISTING CONDITIONS.

CONSULTANTS
JASON C. ADAMS
P.E.
1001 N. 11th St., Suite 202
Arlington, VA 22204
703.261.5665
PROJ: 17-127-25

Remodel Proto
Walmart
GORDONSVILLE, VA
164 CAMP CREEK PKWY., LOUISA, VA 23083
STORE NO.: 4852-223
17-127-25 : PROJ:
JOB NUMBER: 143 SGR-OK

ISSUE BLOCK

1	REV #3	04/26/18

CHECKED BY: BMD
DRAWN BY: JRL
PROTO CYCLE: 02/23/18
DOCUMENT DATE: 04/10/18
BG PROJECT NO: 19532

This document originally issued and sealed by
Jason Christopher Adams, P.E.
#633422
on 04/26/2018.
This document should not be
used for construction
NOT FOR CONSTRUCTION

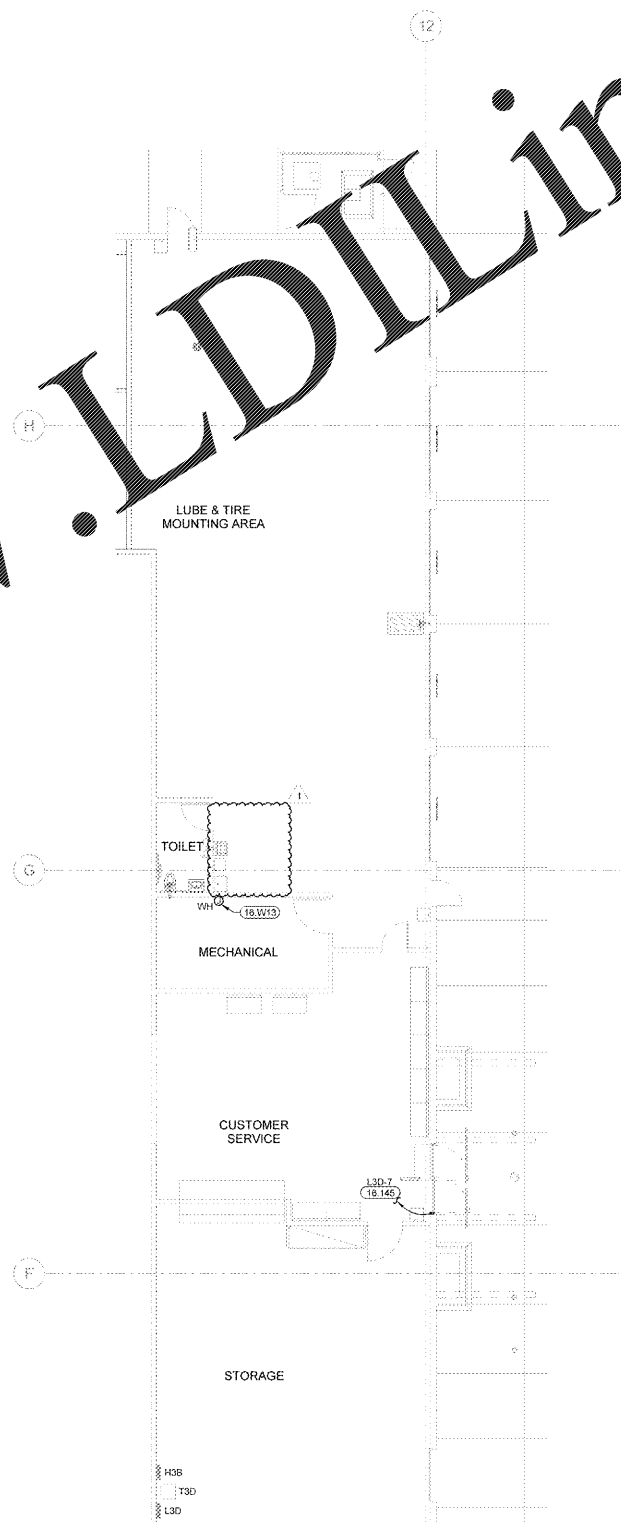

1 ACC POWER PLAN
1/8" = 1'-0"

EXISTING CONDITIONS WERE TAKEN FROM ORIGINAL DRAWINGS AND MAY NOT REFLECT EXACT AS-BUILT CONDITIONS. CONTRACTOR SHALL FIELD VERIFY ALL EXISTING CONDITIONS PRIOR TO SUBMITTING FINAL BIDS. CONTRACTOR SHALL CAREFULLY COORDINATE NEW WORK AND DEMOLITION WITH ALL OTHER DISCIPLINES AND EXISTING CONDITIONS.

EACH SUBCONTRACTOR IS RESPONSIBLE FOR HAVING A THOROUGH KNOWLEDGE OF ALL DRAWINGS AND SPECIFICATIONS IN THEIR RELATED FIELD. THE FAILURE TO ACQUAINT THEMSELVES WITH THIS KNOWLEDGE DOES NOT RELIEVE THE RESPONSIBILITY OF PERFORMING THE WORK PROPERLY. NO ADDITIONAL COMPENSATION SHALL BE ALLOWED BECAUSE OF CONDITIONS THAT OCCUR DUE TO FAILURE TO FAMILIARIZE WORKERS WITH THIS KNOWLEDGE.

AUTO CARE
CENTRAL
ELECTRICAL
PLANS

SHEET:
E5