

GENERAL POWER NOTES

11.20.15

- TELEPOWER POLE(S); MOUNT JUNCTION BOX(ES) TO TOP SIDE OF BOTTOM CHORD OF BAR JOIST. INSTALL FINISHED PRE-WIRED POWER POLE AND TERMINATE PROVIDED FLEXIBLE CONDUIT AND WIRING TO JUNCTION BOX. PROVIDE UNISTRUT SUPPORTS AND HARDWARE TO SECURE TELEPOWER POLE PLUMB TO BUILDING STRUCTURE.
- PROVIDE LIQUID-TIGHT FLEXIBLE METAL CONDUIT AND WIRING FROM DISCONNECT SWITCH OR JUNCTION BOX TO EQUIPMENT KNOCKOUT OR ELECTRICAL CONNECTION POINT.
- WHERE EQUIPMENT NAMEPLATE PROTECTIVE DEVICE RATING DIFFERS FROM SIZE PROVIDED, CHANGE OUT BRANCH CIRCUIT WIRING AND OVERCURRENT DEVICE TO APPROPRIATE RATING PER NEC.
- ELECTRONIC FIRE PROTECTION/SECURITY ALARM BOXES AND CONDUITS SHOWN ON POWER PLANS SHALL BE PROVIDED UNDER THIS CONTRACT. IN ADDITION, UNLESS NOTED OTHERWISE, THE FOLLOWING GENERAL NOTES APPLY:

- ALL ALARM JUNCTION BOXES SHALL BE 4"x4"x2-1/8" MINIMUM.
- ALARM RACEWAYS SHALL BE 3/4" MINIMUM WITH PULL WIRE AND INSULATING BUSHINGS AT END OF VERTICAL RACEWAY RUN.
- VERTICAL RACEWAYS FROM ALARM BOXES SHALL BE EITHER CONCEALED INSIDE WALL OR SURFACE MOUNTED (TO MATCH JUNCTION BOX MOUNTING). ALL VERTICAL RUNS SHALL BE TURNED 90-DEGREES AT TOP SIDE OF BOTTOM CHORD OF BAR JOIST AND EXTENDED HORIZONTALLY TO LOCATION ACCESSIBLE BY VERTICAL FLOOR TYPE LIFT.

- UPON COMPLETION OF ELECTRICAL INSTALLATION AND PRIOR TO ENERGIZING CIRCUIT:
 - INSPECT WIRE AND CABLE FOR PHYSICAL DAMAGE.
 - PERFORM CONTINUITY TEST.
 - VERIFY PROPER PHASING CONNECTION TO THREE PHASE OR LOW VOLTAGE.
- REPLACE ANY MISSING, DAMAGED OR BROKEN RECEPTACLES AND COVER PLATES THROUGHOUT THE INTERIOR AND EXTERIOR OF THE STORE.

KEYNOTES

16.282 RELOCATE EXISTING PHOTO LAB. VERIFY LOCATION WITH MANUFACTURER'S RECOMMENDATIONS PRIOR TO INSTALLATION. ALL CONDUIT AND WIRING SHALL BE CONCEALED AT MAIN ENTRANCE DOORS.

16.402 EC SHALL COORDINATE WITH GENERAL CONTRACTOR AND ARCHITECTURAL DEMOLITION PLANS THE EXTENT OF ELECTRICAL DEMOLITION. REMOVE CONDUITS AND WIRES ALL THE WAY BACK TO ORIGINATING JUNCTION BOXES OR PANELBOARDS. DEMOLITION SHALL NOT AFFECT ACTIVE CIRCUITS. LABEL DEMOLISHED CIRCUITS IN PANELBOARDS AS "SPARE". COORDINATE EXACT REQUIREMENTS WITH EXISTING CONDITIONS PRIOR TO BE.

16.650 CONDUIT SLEEVE; PROVIDE 1-1/2" CONDUIT SLEEVE WITH BUSHINGS ABOVE BAR JOIST (UNLESS NOTED OTHERWISE). PROVIDE TEMPORARY FIRE STOP WITHIN CONDUIT.

16.902 EXTERIOR SIGN POWER; WHERE ELECTRICAL CONNECTIONS FOR SIGNAGE OCCUR BELOW ROOF LINE, MOUNT JUNCTION BOXES TO WALL AT SIGN CONNECTION POINT AND PROVIDE 3/4" CONDUIT TO CONTROL BOX FOR LOW VOLTAGE WIRING (INSTALLED BY OTHERS). REFER TO ARCHITECTURAL DRAWINGS FOR EXACT SIGN LOCATIONS PRIOR TO INSTALLATION. WHERE ELECTRICAL CONNECTIONS FOR SIGNAGE OCCUR ABOVE ROOF LINE, PROVIDE UNISTRUT TO MOUNT JUNCTION BOXES TO BACK SIDE OF PARAPET AND PROVIDE 3/4" CONDUIT TO CONTROL BOX FOR LOW VOLTAGE WIRING (INSTALLED BY OTHERS). PROVIDE ONLY ONE PENETRATION THROUGH THE ROOF. REF ARCHITECTURAL EXTERIOR WALL SECTIONS AND SIGN ATTACHMENT FOR ROOF AND PARAPET PENETRATION REQUIREMENTS.

16.957 CONNECT CIRCUITS TO EXISTING BRANCH CIRCUITRY. MINIMUM WIRE SIZE AND PANELBOARD CIRCUIT ARE NOTED. VERIFY SIZE, RATING AND CONDITION OF EXISTING BRANCH CIRCUIT CONDUIT AND WIRE PRIOR TO USE TO ENSURE THAT THEY MEET REQUIRED SIZE AND ALL U.L. RATINGS AND REPLACE AS REQUIRED.

16.W11 EXISTING EXHAUST FAN (EF) TO BE REPLACED. COORDINATE REMOVAL OF EXISTING EF, AND INSTALLATION AND RECONNECTION OF NEW EF WITH MECHANICAL CONTRACTOR.

16.W15 WATER HEATERS; A. DISCONNECT EXISTING, AND RECONNECT NEW WATER HEATERS. COORDINATE WITH MECHANICAL CONTRACTOR. B. FURNISH AND INSTALL HANDLE LOCKS (LOCK OFF) ON ALL CIRCUIT BREAKERS FEEDING WATER HEATERS.

REDESIGN

RETAIL DESIGN COLLABORATIVE

112015-0307.Dwg
A.70790
7.11.15
JCS
1/26/15

STIPULATION FOR THE CONTRACTOR TO VERIFY THE EXISTING CONDITIONS AND TO BE RESPONSIBLE FOR THE ACCURACY OF THE INFORMATION PROVIDED. THE CONTRACTOR SHALL BE RESPONSIBLE FOR VERIFYING THE EXISTING CONDITIONS AND TO BE RESPONSIBLE FOR THE ACCURACY OF THE INFORMATION PROVIDED. THE CONTRACTOR SHALL BE RESPONSIBLE FOR VERIFYING THE EXISTING CONDITIONS AND TO BE RESPONSIBLE FOR THE ACCURACY OF THE INFORMATION PROVIDED.

CONSULTANTS

JASON C. ADAMS
ELECTRICAL ENGINEER
112015-0307.Dwg
A.70790
7.11.15
JCS
1/26/15

Walmart

GORDONSVILLE, VA
164 CAMP CREEK PKWY., LOUISA, VA 23093
STORE NO.: 4852-223

143 SSGORC
17-127-25
1

ISSUE BLOCK

REV #	DATE
1	04/25/18

CHECKED BY: BMD
DRAWN BY: JRL
PROTO CYCLE: 02/23/18
DOCUMENT DATE: 04/10/18
BS PROJECT NO: 19532

This document originally issued and dated by:
Jason Christopher Adams, P.E.
on 04/25/18
This document should not be considered a certified document
NOT FOR CONSTRUCTION

POWER PLAN

SHEET: **E2**

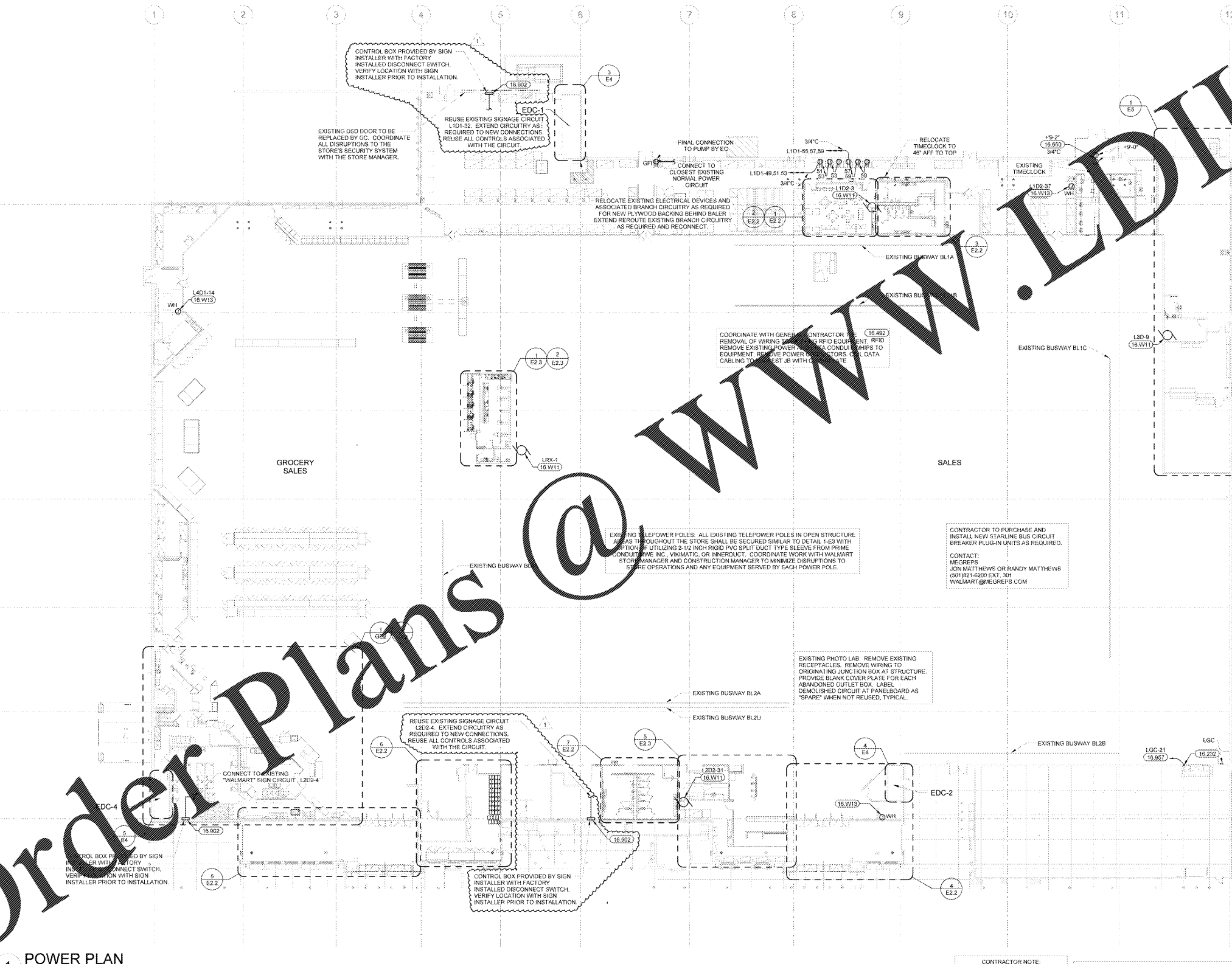

1 POWER PLAN
1" = 20'-0"

CONTRACTOR NOTE
COORDINATE DISCONNECTION AND RECONNECTION OF EXISTING ELECTRICAL EQUIPMENT AS REQUIRED FOR INSTALLATION OF NEW WALL FINISHES.

CLEAN RECEPTACLES AND COVER PLATES AND REPLACE DAMAGED OR MISSING RECEPTACLES AND COVER PLATES IN THE FOLLOWING SPACES (HAIR SALON, NAIL SALON, OPERATIONS OFFICE, OPERATIONS TRAINING ROOM, SPORT SHOP, AND WIRELESS) AS APPLICABLE.

EXISTING CONDITIONS WERE TAKEN FROM ORIGINAL DRAWINGS AND MAY NOT REFLECT EXACT "AS-BUILT" CONDITIONS. CONTRACTOR SHALL VERIFY ALL EXISTING CONDITIONS PRIOR TO SUBMITTING FINAL BIDS. CONTRACTOR SHALL CAREFULLY COORDINATE NEW WORK AND DEMOLITION WITH ALL OTHER DISCIPLINES AND EXISTING CONDITIONS.

EACH SUBCONTRACTOR IS RESPONSIBLE FOR HAVING A THOROUGH KNOWLEDGE OF ALL DRAWINGS AND SPECIFICATIONS IN THEIR RELATED FIELD. THE FAILURE TO ACQUAINT THEMSELVES WITH THIS KNOWLEDGE DOES NOT RELIEVE THE RESPONSIBILITY OF PERFORMING THE WORK PROPERLY. NO ADDITIONAL COMPENSATION SHALL BE ALLOWED BECAUSE OF CONDITIONS THAT OCCUR DUE TO FAILURE TO FAMILIARIZE WORKERS WITH THIS KNOWLEDGE.

Order Plans

www.LDOnline.com

EXISTING TELEPOWER POLES: ALL EXISTING TELEPOWER POLES IN OPEN STRUCTURE AREAS THROUGHOUT THE STORE SHALL BE SECURED SIMILAR TO DETAIL 1-63 WITH CONDUIT WIRE INC., VIKRAMATIC, OR INNERDUCT. COORDINATE WORK WITH WALMART STORE MANAGER AND CONSTRUCTION MANAGER TO MINIMIZE DISRUPTIONS TO STORE OPERATIONS AND ANY EQUIPMENT SERVED BY EACH POWER POLE.

CONTRACTOR TO PURCHASE AND INSTALL NEW STAINLESS STEEL BUS CIRCUIT BREAKER PLUG-IN UNITS AS REQUIRED.

CONTACT:
MEGREPS
JON MATTHEWS OR RANDY MATTHEWS
(501)821-6200 EXT. 301
WALMART@MEGREPS.COM

EXISTING PHOTO LAB. REMOVE EXISTING RECEPTACLES. REMOVE WIRING TO ORIGINATING JUNCTION BOX AT STRUCTURE. PROVIDE BLANK COVER PLATE FOR EACH ABANDONED OUTLET BOX. LABEL DEMOLISHED CIRCUIT AT PANELBOARD AS "SPARE" WHEN NOT REUSED, TYPICAL.

CONTROL BOX PROVIDED BY SIGN INSTALLER WITH FACTORY INSTALLED DISCONNECT SWITCH. VERIFY LOCATION WITH SIGN INSTALLER PRIOR TO INSTALLATION.

CONTROL BOX PROVIDED BY SIGN INSTALLER WITH FACTORY INSTALLED DISCONNECT SWITCH. VERIFY LOCATION WITH SIGN INSTALLER PRIOR TO INSTALLATION.

EXISTING OSD DOOR TO BE REPLACED BY GC. COORDINATE ALL DISRUPTIONS TO THE STORE'S SECURITY SYSTEM WITH THE STORE MANAGER.

REUSE EXISTING SIGNAGE CIRCUIT L1D1-32. EXTEND CIRCUITRY AS REQUIRED TO NEW CONNECTIONS. REUSE ALL CONTROLS ASSOCIATED WITH THE CIRCUIT.

RELOCATE EXISTING ELECTRICAL DEVICES AND ASSOCIATED BRANCH CIRCUITRY AS REQUIRED FOR NEW PLYWOOD BACKING BEHIND BALER. EXTEND RELOCATED EXISTING BRANCH CIRCUITRY AS REQUIRED AND RECONNECT.

COORDINATE WITH GENERAL CONTRACTOR. REMOVE OF WIRING AND RFD EQUIPMENT. RFD REMOVE EXISTING POWER AND DATA WIRING TO EQUIPMENT. REQUEST JIB WITH CABLEING TO BEST JIB WITHIN 10'.

EXISTING PHOTO LAB. REMOVE EXISTING RECEPTACLES. REMOVE WIRING TO ORIGINATING JUNCTION BOX AT STRUCTURE. PROVIDE BLANK COVER PLATE FOR EACH ABANDONED OUTLET BOX. LABEL DEMOLISHED CIRCUIT AT PANELBOARD AS "SPARE" WHEN NOT REUSED, TYPICAL.

REUSE EXISTING SIGNAGE CIRCUIT L212-4. EXTEND CIRCUITRY AS REQUIRED TO NEW CONNECTIONS. REUSE ALL CONTROLS ASSOCIATED WITH THE CIRCUIT.

CONTROL BOX PROVIDED BY SIGN INSTALLER WITH FACTORY INSTALLED DISCONNECT SWITCH. VERIFY LOCATION WITH SIGN INSTALLER PRIOR TO INSTALLATION.

CONNECT TO EXISTING WALMART SIGN CIRCUIT, L202-4

CONTROL BOX PROVIDED BY SIGN INSTALLER WITH FACTORY INSTALLED DISCONNECT SWITCH. VERIFY LOCATION WITH SIGN INSTALLER PRIOR TO INSTALLATION.