

SHEET NOTES

- REFER TO SHEET A8 FOR SCHEDULE FINISH KEY AND GENERAL FINISH NOTES.
- USE CONTINUOUS SEALANT WHERE COUNTER TOP AND CASEWORK MEET WALL OR OTHER OBSTACLES.
- USE CONTINUOUS SEALANT AT TOP, BOTTOM AND SIDES WHERE BASE IS PRESENT ON COUNTERS AND CASEWORK.
- WHERE NEW LAMINATE IS INDICATED FOR EXISTING CASEWORK, REMOVE EXISTING LAMINATE AND/OR FINISHES TO BASE SUBSTRATE PRIOR TO INSTALLATION OF NEW. INSTALLATION OF NEW LAMINATE OVER EXISTING IS NOT ACCEPTABLE, EXCEPT AS NOTED.
- INSTALL ALL ALUMINUM CORNER GUARDS AT ALL EXPOSED MILLWORK CORNERS, REF. TO SPECIFICATIONS.
- REFURBISH EXISTING SOLID SURFACE COUNTERTOPS AND WALL CAPS. CONTACT MANUFACTURER FOR MANUFACTURER'S INSTRUCTIONS FOR RESTORING SOLID SURFACE COUNTERTOPS.
- FOR STAINLESS STEEL COUNTERTOPS, REFURBISH TO LIKE NEW CONDITION.

**REDESIGN**  
 RETAIL DESIGN COLLABORATIVE  
 1001 E. 37th Dr., #1010  
 Tulsa, OK 74106  
 (918) 435-3665  
 info@rethink.com

STIPULATION FOR THE CONTRACTOR TO VERIFY AND CONFIRM THE EXISTING CONDITIONS AND MATERIALS AT THE PROJECT SITE PRIOR TO THE START OF WORK. THE CONTRACTOR SHALL BE RESPONSIBLE FOR OBTAINING ALL NECESSARY PERMITS AND APPROVALS FROM THE LOCAL, STATE AND FEDERAL AUTHORITIES. THE CONTRACTOR SHALL BE RESPONSIBLE FOR OBTAINING ALL NECESSARY PERMITS AND APPROVALS FROM THE LOCAL, STATE AND FEDERAL AUTHORITIES. THE CONTRACTOR SHALL BE RESPONSIBLE FOR OBTAINING ALL NECESSARY PERMITS AND APPROVALS FROM THE LOCAL, STATE AND FEDERAL AUTHORITIES.

CONSULTANTS

**Walmart**  
 GORDONSVILLE, VA  
 884 CAMP CREEK PKWY., LOUISA, VA 23083  
 STORE NO.: 4862-223  
 143 SGR-COR  
 17-02725 | PHOTO:  
 2018 Remodel Proto

ISSUE BLOCK

NO.	REV.	DATE
1	REV 3	04/26/18

CHECKED BY: DF  
 DRAWN BY: TP  
 PHOTO CYCLE: 02/26/18  
 DOCUMENT DATE: 04/10/18

CASEWORK

SHEET: **A9**

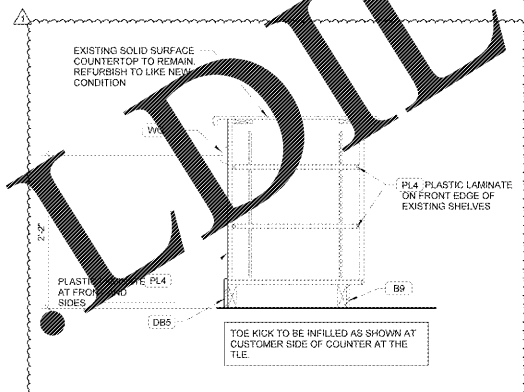

**13** BASE CABINET SECTION (AT AUTO CENTER)  
 1" = 1'-0"

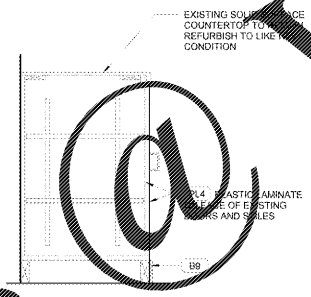

**6** BASE CABINET SECTION  
 1" = 1'-0"

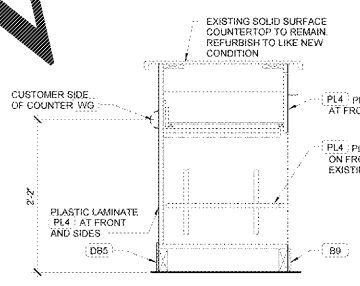

**5A** BASE CABINET SECTIONS  
 1" = 1'-0"

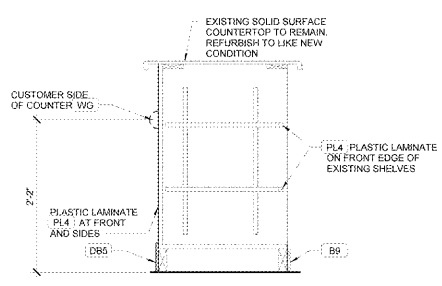

**5** BASE CABINET SECTIONS  
 1" = 1'-0"

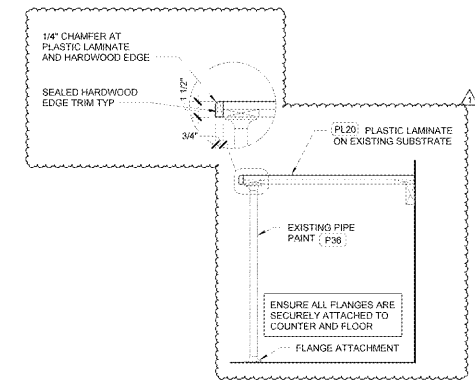

**2** COUNTER SECTION  
 1" = 1'-0"

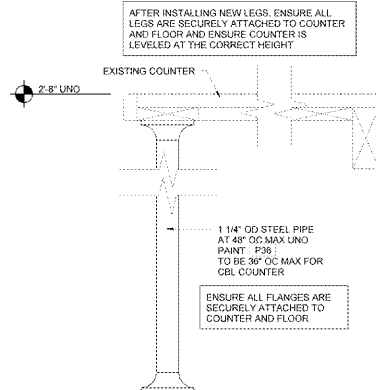

**1** COUNTER LEG  
 3/8" = 1'-0"

**Order Plans**

**WWW.LDILine.com**