

STIPULATION FOR THE USER:
THE DRAWING AND INFORMATION CONTAINED HEREIN ARE THE PROPERTY OF REI DESIGN. NO PART OF THIS DRAWING OR INFORMATION IS TO BE REPRODUCED, COPIED, OR TRANSMITTED IN ANY FORM OR BY ANY MEANS, ELECTRONIC OR MECHANICAL, INCLUDING PHOTOCOPYING, RECORDING, OR BY ANY INFORMATION STORAGE AND RETRIEVAL SYSTEM, WITHOUT THE WRITTEN PERMISSION OF REI DESIGN.

CONSULTANTS:

Walmart
GORDONSVILLE, VA
884 CAMP CREEK PKWY., LOUISA, VA 23083
STORE NO.: 4852-223
JOB NUMBER: 143 SGR-OR
2018 Remodel Proto

ISSUE BLOCK

1	REV 3	04/26/18
---	-------	----------

CHECKED BY: DF
DRAWN BY: TP
PROTO CYCLE: 02/26/18
DOCUMENT DATE: 04/10/18

SITE DETAILS

SHEET: **SP2**

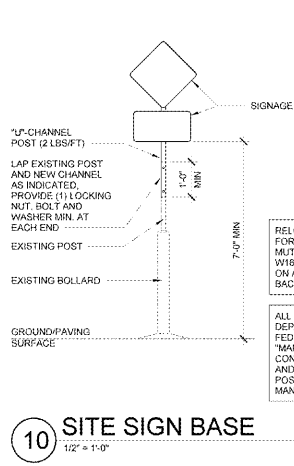

10 SITE SIGN BASE
1/2" = 1'-0"

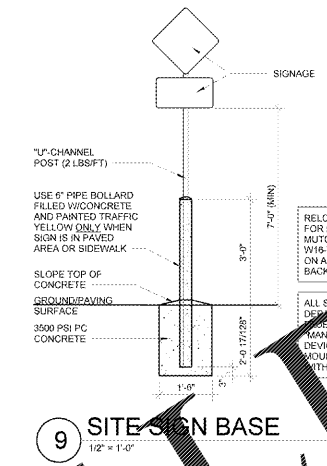

9 SITE SIGN BASE
1/2" = 1'-0"

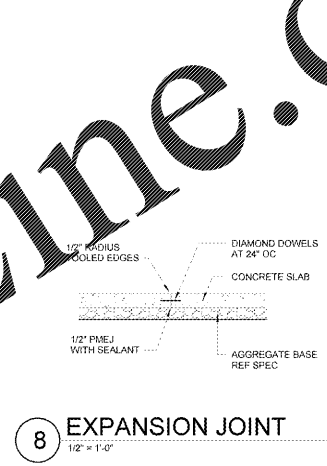

8 EXPANSION JOINT
1/2" = 1'-0"

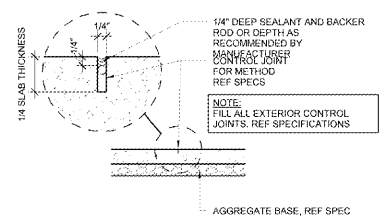

7 EXTERIOR SIDEWALK/PAVING CONTRACTION JOINT
1/2" = 1'-0"

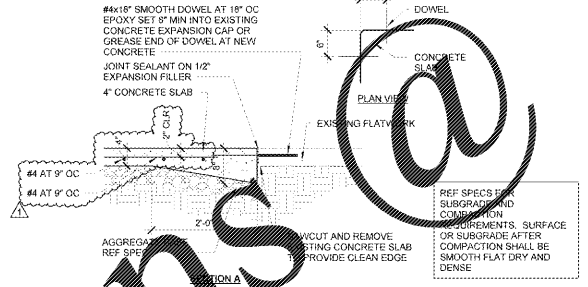

6 NETWORK JOINT
1/2" = 1'-0"

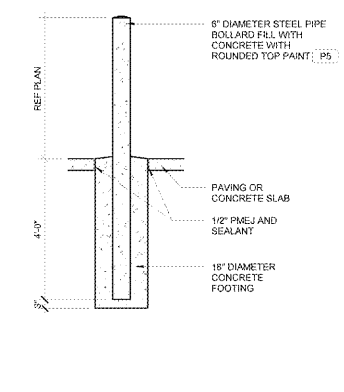

5 BOLLARD DETAIL
1/2" = 1'-0"

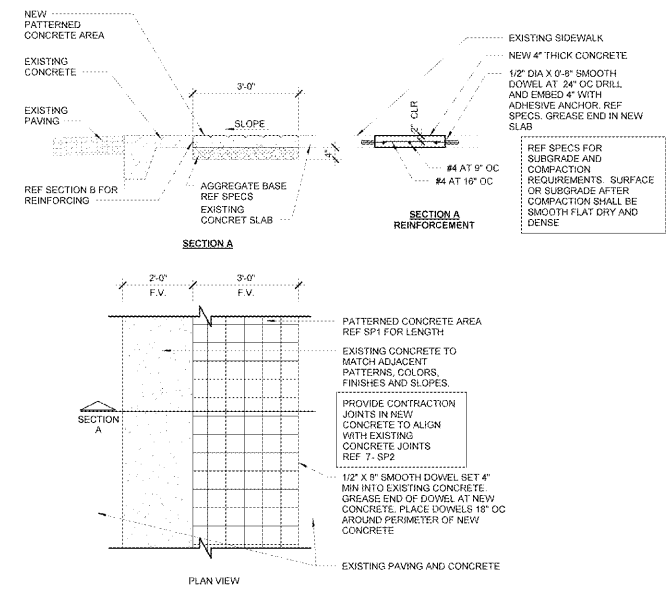

4 SIDEWALK SECTION
1/2" = 1'-0"

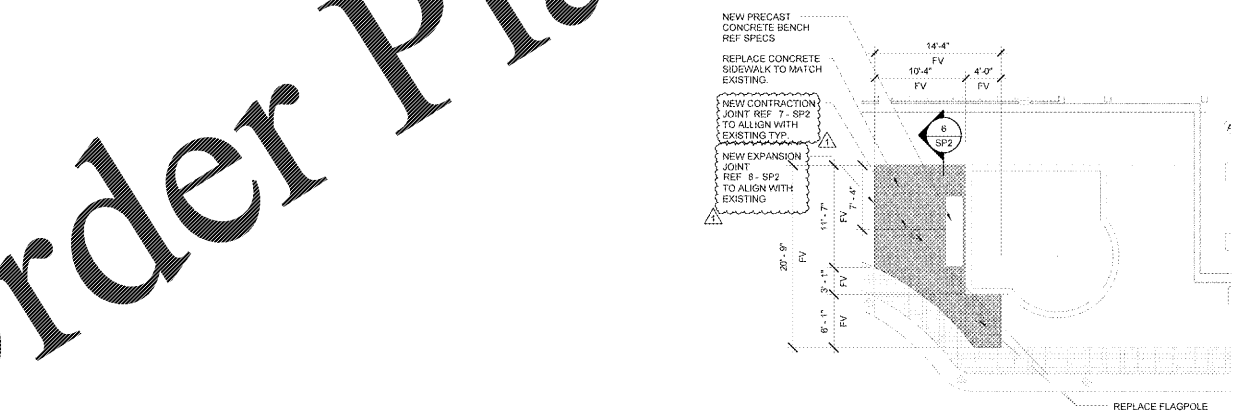

3 SIDEWALK NEW CONSTRUCTION PLAN
1/8" = 1'-0"

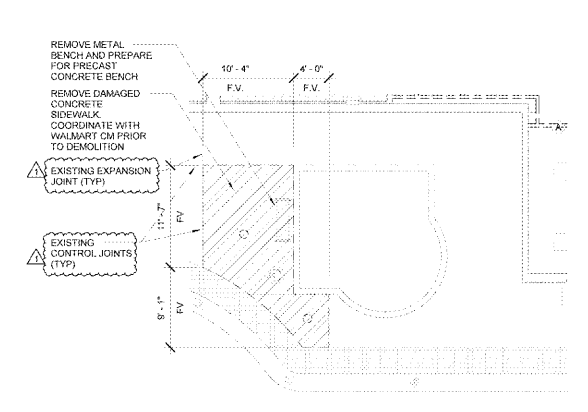

2 SIDEWALK DEMOLITION PLAN
1/8" = 1'-0"

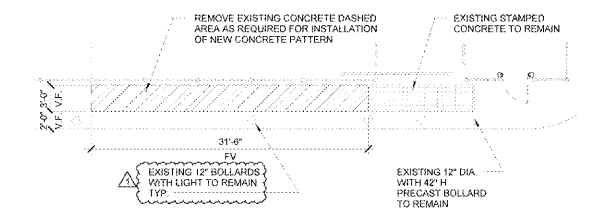

1 SIDEWALK DEMOLITION PLAN
1/8" = 1'-0"

Order Plans @ www.LDOnline.com