

LEGEND

- IP.S. IRON PIN SET (1/2" REBAR)
IP.F. IRON PIN FOUND
C.M.F. CONCRETE MONUMENT FOUND
O.T.P. OPEN TOP PIPE
B.M. BENCHMARK
T.B.M. TEMPORARY BENCHMARK
C.T.P. CRIMP TOP PIPE
M.T. MARKED TREE
D.H. DRILL HOLE
L.L.L. LAND LOT LINE
L.L. LAND LOT
P.L. PROPERTY LINE
C.E. CENTERLINE
B.L. BUILDING LINE
R.O.W. RIGHT-OF-WAY
S.E. SANITARY SEWER EASEMENT
D.E. DRAINAGE EASEMENT
C.C. CURB & GUTTER
B.O.C. BACK OF CURB
T.O.C. TOP OF CURB
G.M.D. GEORGIA MILETA DISTRICT
P.L./P.G. PLAT BOOK/PAGE
D.B./P.G. DEED BOOK/PAGE
P.O.B. POINT OF BEGINNING
T.P.O.B. TRUE POINT OF BEGINNING
ELEV. ELEVATION
I.E. INVERT ELEVATION
F.F.E. FINISHED FLOOR ELEVATION
E.P. EDGE OF PAVEMENT
A.S.P. ALUMINIZED STEEL PIPE TYPE 2
R.C.P. REINFORCED CONCRETE PIPE
D.I.P. DUCTILE IRON PIPE
P.V.C. POLYVINYLCHLORIDE PIPE
V.C.P. VITRIFIED CLAY PIPE
L.P. LIGHT PIPE
P.P. POWER POLE OR UTILITY POLE
M.H. MANHOLE
M.W.C.B. SINGLE WING CATCH BASIN
D.W.C.B. DOUBLE WING CATCH BASIN
J.B. JUNCTION BOX
O.S. OUTLET STRUCTURE
F.E.S. FLARED END SECTION
H.W. HEADWALL
D.I. DROP INLET
G.R.I. GRATE INLET
F.I. FIRE HYDRANT
W.V. WATER VALVE
W.M. WATER METER
G.V. GAS VALVE
+94.2 EXISTING GROUND ELEVATION
PROPOSED GROUND ELEVATION
91.0 EXISTING CONTOUR ELEVATION
PROPOSED CONTOUR ELEVATION
P.W. POWERLINE
T.P. TREE PROTECTION FENCE
C.R.Z. CRITICAL ROOT ZONE
U.T. UNDERGROUND TELEPHONE LINE
G. GAS LINE
C.T.V. CABLE T.V. LINE
U.C.T.V. UNDERGROUND CABLE T.V. LINE
S. SANITARY SEWER LINE
S.W. STORM SEWER PIPE
W. WATER LINE / PIPE
F.L. FENCE LINE
B.C./C.R./S. BRANCH/CREEK/STREAM CENTERLINE
D.C./D.R. DRAIN CENTERLINE
F.Z. FLOOD HAZARD ZONE LIMITS
T. TREE
L.A. LIMITED ACCESS
S. STATION
N.F. NOW OR FORMERLY
T.B.L. TEST BORING LOCATION
W.E. WATER LINE EASEMENT

CITY OF GAINESVILLE WATER NOTES:

- 1. THE GAINESVILLE PUBLIC UTILITIES DEPARTMENT SHALL BE NOTIFIED 24 HOURS PRIOR TO ANY WATER OR SANITARY SEWER LINE CONSTRUCTION OR REPAIRS. ONLY CONTRACTORS APPROVED BY GAINESVILLE PUBLIC UTILITIES DEPARTMENT WILL BE ALLOWED TO PERFORM CONSTRUCTION OR REPAIRS CONNECTED TO SAID WATER OR SANITARY SEWER MAINS. CALL THE CONSTRUCTION INSPECTOR'S OFFICE AT (770) 538-2407 PRIOR TO BEGINNING ANY CONSTRUCTION, OR TO APPLY TO BECOME AN APPROVED CONTRACTOR.
2. A WATER MAIN AND SANITARY SEWER MATERIALS AND WORKMANSHIP SHALL BE IN ACCORDANCE WITH THE CITY OF GAINESVILLE'S "STANDARD SPECIFICATIONS FOR WATER MAINS AND SANITARY SEWERS", LATEST EDITION.
3. THE CONTRACTOR SHALL BE RESPONSIBLE FOR MAINTAINING A MARKED-UP SET OF DESIGN DRAWINGS SHOWING ALL "AS-BUILT CONDITIONS". THE "RECORD DRAWINGS" SHALL BE MADE AVAILABLE TO THE DESIGNER AND/OR THE CITY INSPECTOR UPON REQUEST. THE MARK-UPS SHALL BE AT THE SITE AT ALL TIMES AND SHALL BE UTILIZED TO DEVELOP FINAL RECORD DRAWINGS. FINAL ACCEPTANCE OF WATER AND/OR SEWER MAIN CONSTRUCTION WILL NOT BE GRANTED UNTIL AS-BUILT DRAWINGS HAVE BEEN RECEIVED BY CITY OF GAINESVILLE PUBLIC UTILITIES ENVIRONMENTAL COMPLIANCE AND PERMITTING OFFICE.
4. COMMERCIAL MULTI-UNIT BUILDINGS CONTAINING UNITS TO BE LEASED AND USED AS RESTAURANTS OR OTHER BUSINESS TYPES REQUIRING INSTALLATION OF A SANITARY SEWER PRE-TREATMENT DEVICE, SHALL BE REQUIRED TO INSTALL A SEPARATE WATER METER. MINIMUM COVER OVER WATER AND SEWER LINES SHALL BE 4 FEET. WATER MAINS 12-INCHES AND LARGER SHALL HAVE A MINIMUM 5-FEET OF COVER.
5. COORDINATE WATER AND SEWER CONNECTIONS WITH ARCHITECTURAL PLANS FOR THE PROPOSED BUILDING.
6. PRIOR TO BACKFLOW PREVENTION INSTALLATION, CONTACT BACKFLOW INSPECTOR AT (770) 297-5443.
7. BACKFLOW PREVENTION DEVICE INSTALLATION REQUIRES A PLUMBING PERMIT TO BE OBTAINED FROM TOWN OF BRASELTON/CITY OF GAINESVILLE BLDG. INSP. DEPT. BY A MASTER PLUMBER.
8. ALL WATER MAIN MATERIALS AND WORKMANSHIP SHALL BE IN ACCORDANCE WITH THE CITY OF GAINESVILLE "STANDARD SPECIFICATIONS FOR CONSTRUCTION OF WATER MAINS, LATEST EDITION."

TOWN OF BRASELTON SANITARY SEWER NOTES:

- 1. ALL WATER AND SEWER LINE CONSTRUCTION SHALL BE IN ACCORDANCE WITH THE TOWN OF BRASELTON STANDARD SPECIFICATIONS AND DETAILS, LATEST EDITION.
2. ALL WATER AND SEWER FACILITIES SHALL BE INSTALLED BY A LICENSED UTILITY CONTRACTOR IN THE STATE OF GEORGIA.
3. MARKING TAPE SHOWING "CAUTION BURIED SEWER LINE" SHALL BE INSTALLED APPROXIMATELY 18-INCHES ABOVE ALL WATERLINES.
4. ALL WATER AND SEWER CONSTRUCTION IS INSPECTED AND TESTED AS PER BRASELTON STANDARDS PRIOR TO FINAL ACCEPTANCE BY THE TOWN.
5. AS-BUILTS RECORD DRAWINGS FOR THIS PROJECT MUST BE SUBMITTED AND APPROVED PRIOR TO FINAL ACCEPTANCE BY THE TOWN OF BRASELTON. AS-BUILT DRAWINGS SHALL BE PREPARED ON THE TOWN OF BRASELTON'S COORDINATE SYSTEM.
6. THE BRASELTON SEWER DEPARTMENT SHALL BE NOTIFIED AT A MINIMUM 48 HOURS (MONDAY THROUGH FRIDAY) PRIOR TO COMMENCING ANY WORK, TESTING, AND PRIOR TO MAKING ANY CONNECTIONS TO EXISTING SEWER LINES OF MANHOLES.
7. CITIES ARE NOT REQUIRED TO LOCATE WATER AND SEWER LINES THAT WERE INSTALLED BY A DEVELOPER OR OTHER PERSONS THAT HAVE NOT YET BEEN ACCEPTED IN TO THE CITY'S OWNERSHIP (ACCEPTANCE OF FINAL PLAT). THE PERSON INSTALLING THOSE LINES IS REQUIRED TO INSTALL AND MAINTAIN VISIBLE, PERMANENT MARKERS (I.E. COLOR CODED WIRE FLAGS, VALVE MARKERS, SERVICE STUB MARKERS, ETC.) IN ORDER TO IDENTIFY THE WATER AND SEWER FACILITIES AT THE TIME THE LINES ARE INSTALLED. ONCE THE CITY HAS TAKEN LEGAL OWNERSHIP OF THOSE WATER AND SEWER LINES, THE CITY IS RESPONSIBLE FOR LOCATING THEM WHEN A REQUEST IS RECEIVED.

Table with 2 columns: CONTROL POINT #, DESCRIPTION, NORTHING, EASTING, ELEVATION. Includes points #107 and #20882.

NOTE: DUCTILE IRON PIPE SHALL: 1. CONFORM TO AWMA C150 AND AWMA C151. 2. BE THICKNESS PRESSURE CLASS 350. 3. BE CEMENT LINED IN ACCORDANCE WITH AWMA C104. 4. HAVE RUBBER JOINTED GASKETS CONFORMING TO AWMA C111. 5. BE PAINTED GREEN. (SANITARY SEWER SPECIFICATIONS (SECTION 02736 PART 2 (2.03))

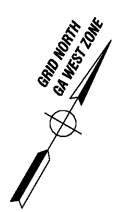
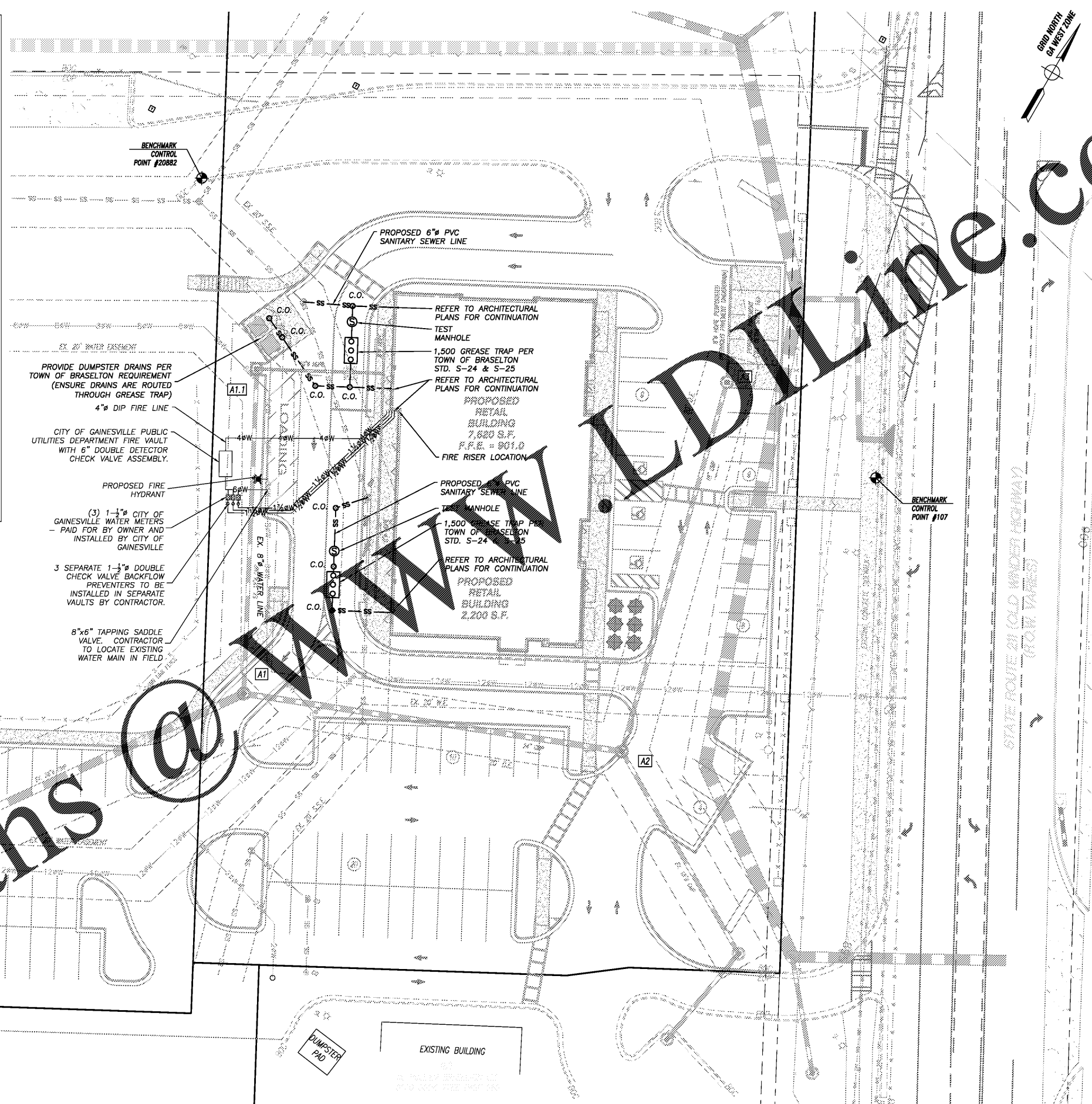

Development Planning & Engineering, Inc. 5076 STOL INDUSTRIAL WAY SUITE 200 BUFORD, GEORGIA 30518 (770) 271-2868 www.dpengr.com

PREPARED FOR: FRIENDSHIP ROAD PROPERTIES, LLC 3101 TOWERCREEK PKWY. SUITE 420 ATLANTA, GA 30339 MR. RANDY HERRON (404) 578-8296

PROJECT NAME: CREEKSIDE RETAIL

TASK: UTILITY PLAN

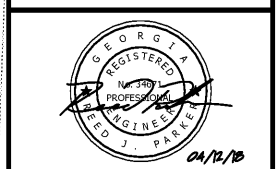

PROJECT INFORMATION: CREEKSIDE RETAIL Project Name 15-082F Project Number OLD WINDER HIGHWAY Project Address G.M.D. 1749 Parcel No.(s) Land Lot / District TOWN OF BRASELTON HALL COUNTY County, State

Table with 2 columns: DATE, REVISION. Includes a grid for tracking changes.

Table with 2 columns: R/JP DESIGN, AS SHOWN SCALE; R/JP DRAWN, 5 of 17; KWB CHECKED, SHEET; DATE, 03/20/18; PROJECT No., 15-082F

Order Plans @ WWW.LDILINE.COM

