

Order Plans @ www.LDILine.com

www.LDILine.com

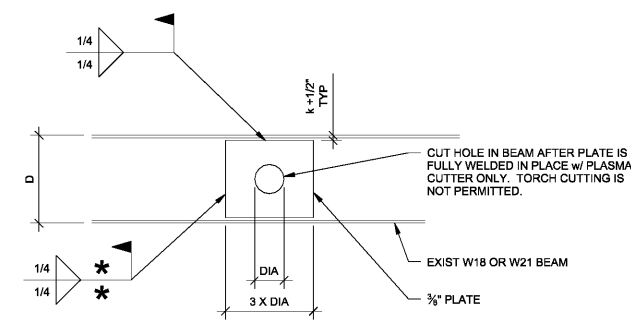

* NOTE: PERFORMING ENTIRE LENGTH OF VERTICAL WELDS CONTINUOUSLY WILL WEAKEN BEAM. PERFORM VERTICAL WELDS INTERMITTANTLY WITH 3 INCH MAXIMUM LENGTH. ALTERNATE SIDES OF PLATE AND ALLOW EA WELD SEGMENT TO COOL.

NOTE: WEB REINFORCING DESIGNED ONLY FOR (2) - 4 INCH SANITARY SEWER LINES RUNNING EAST-WEST BELOW THE EXIST SECOND FLOOR BETWEEN GRIDS E AND F AND PENETRATING WEBS OF W18 OR LARGER BEAMS. LOCATE PENETRATIONS IN ACCORDANCE WITH THE PLUMBING DRAWINGS. NOTIFY ENGINEER IF OTHER BEAM PENETRATIONS ARE REQ'D.

HOLE DIA SHALL BE A MINIMUM AS REQ'D, BUT NO MORE THAN THE BEAM DEPTH DIVIDED BY 3

WEB REINFORCING DETAIL AT PIPE PENETRATION

1"=1'-0"

Dunn Structural Engineering
125 S Lexington Ave
Suite 308
Asheville, NC 28801
828.775.5110

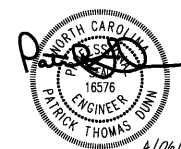

A/06/18

KEN NISCH, AIA

29110 Center Road
Suite 200
Southfield, MI 48034 USA
248 355 0890
248 355 0895 Fax

Copyright © 2018
KEN NISCH, AIA
All rights reserved

Certification:

Consultants:
RETAIL DESIGN CONSULTANT

JGA INC
29355 Northwestern Hwy
Suite 300
Southfield, MI 48034 USA
248 355 0890
248 355 0895 Fax
www.jga.com

JGA Prj #: 1-218-082

Project Location:
Soft Surroundings
BILTMORE VILLAGE
10 BROOK STEET
SPACE #160
ASHEVILLE, TN 28803
4,740 SQUARE FEET

DRAWINGS ISSUED FOR:
 programming
 schematic des.
 design dev.
 bidding
 permits/LL review 04-06-18
 construction

REVISIONS:

Prj. no. 8-218-030
Drawn PD
Checked PD
Approved KN

Do not scale this print. Use figured dimensions only.

Drawing title:
EXIST'G STL. BEAM PENETRATION DTL.

Sheet no.
S-1.0