



Project Location:  
**Soft Surroundings**  
**BILTMORE VILLAGE**  
 10 BROOK STREET  
 SPACE #160  
 ASHEVILLE, TN 28803  
 4,740 SQUARE FEET

DRAWINGS ISSUED FOR:  
 programming  
 schematic des.  
 design dev.  
 bidding  
 permits/11 review 04-06-18  
 construction

REVISIONS: 04-20-18

Prj. no. 8-218-030  
 Drawn RM - GV  
 Checked KR - GV  
 Approved KN

Do not scale this print. Use figured dimensions only.

Drawing title:  
**LO-VOLTAGE CEILING PLAN**

Sheet no.  
**A-2.4**

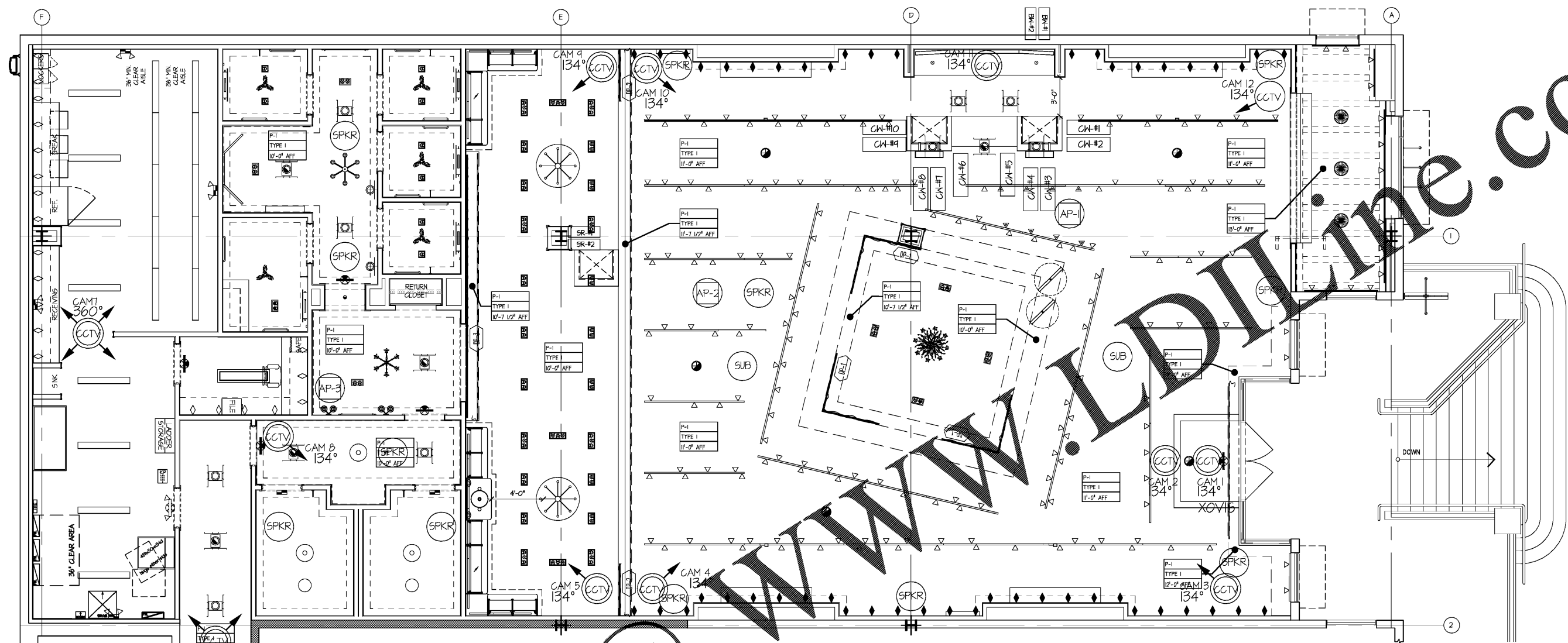

**LOW VOLTAGE FLOOR PLAN**  
 SCALE: 1/4" = 1'-0"  
 NORTH

**LOW VOLTAGE WIRING ASSISTANCE SYMBOLS/NOTATIONS/ FOR VENDORS**

WALL MOUNTED KEY PAD      DATA BAI     ALARM SYSTEM DATA CONNECTION  
 MD     MOTION DETECTOR FRONT AND BACK DOOR

NOTE THAT SALES AREA MOTION DETECTOR IS NOT INDICATED AND THAT PLACEMENT WILL BE DETERMINED AT THE TIME OF INSTALLATION.

**LOW VOLTAGE WIRING ASSISTANCE SYMBOLS/NOTATIONS/ FOR VENDORS**

SPKR     SPEAKERS CEILING MOUNTED-  
 CCTV     CLOSED CIRCUIT TELEVISION CAMERA W/ NO. LOCATION AND ROTATION.  
 KP     SECURITY KEYPAD TO ALARM  
 AP-1     WIRELESS ACCESS POINT TYPICAL INDICATION

SEE MOOD MEDIA LAYOUT FOR SPEAKER LOCATIONS. ALL SPEAKERS ARE CEILING MOUNTED WITH THE PERIMETER SATELLITES BEING INSTALLED ON BRACKETS AND THE SPEAKERS IN THE MIDDLE BEING FLUSH MOUNTED INTO THE CEILING.

**LOW VOLTAGE WIRING ASSISTANCE SYMBOLS/NOTATIONS/ FOR VENDORS**

DATA OUTLETS IN MANAGER OFFICE/LEDGE (5/TOTAL)		DATA OUTLETS AT SHIPPING/RECEIVING LEDGE (4) TOTAL	
MON1	MOR4	SR-#1	SR-#3
MOR2	MOR5	SR-#2	SR-#4
MOR3			
DATA OUTLETS AT CASH WRAP COUNTER (2/TOTAL #1 & #2 WHEN MOBILE CASH WRAP IS NOT ADJACENT TO FIXED CASH WRAP)		DATA OUTLETS AT BACK WRAP (2/TOTAL)	
CH-#1	CH-#5	CH-#9	BH-#1
CH-#2	CH-#6	CH-#10	BH-#2
CH-#3	CH-#7	CH-#11	
CH-#4	CH-#8	CH-#12	

**REFLECTED CEILING KEY NOTES**

HVAC DIFFUSERS ARE SHOWN ON MECHANICAL PLANS FOR PLACEMENT AND SPECIFICATION.

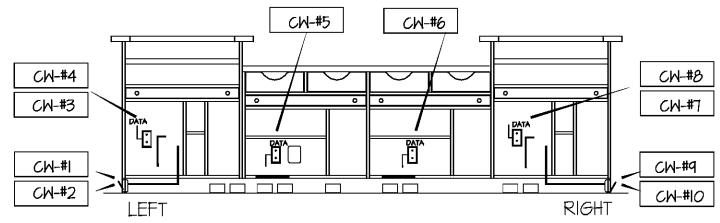

**ASSOCIATE SIDE OF CASH WRAP ELEVATION**  
 FEB-3-2017MPPM

**Order Plans**