

KEN NISCH, AIA
 29110 Laker Road
 Suite 200
 Southfield, MI 48034 USA
 248 355 0890
 248 355 0895 Fax

Copyright © 2018
 KEN NISCH, AIA
 All rights reserved

Certification:
 I HEREBY CERTIFY THAT THESE
 PLANS WERE PREPARED BY ME AND OR
 UNDER MY SUPERVISION AND TO THE BEST
 OF MY KNOWLEDGE THEY CONFORM TO CODES AND
 TO THE REQUIREMENTS OF THE ARCHITECTURAL
 PROFESSION.



ARCHITECTURAL REG: 5040
 EXP. DATE: JUNE 30, 2018
 DATE SIGNED: APRIL 06, 2018

Consultants:
RETAIL DESIGN CONSULTANT

JGA INC
 2355 Northwestern Hwy
 Suite 300
 Southfield, MI 48034 USA
 248 355 0890
 248 355 0895 Fax
 www.jga.com

JGA Prj #: 1-218-082

Project Location:
Soft Surroundings
BILTMORE VILLAGE
 10 BROOK STREET
 SPACE #160
 ASHEVILLE, TN 28803
 4,740 SQUARE FEET

DRAWINGS ISSUED FOR:
 programming
 schematic des.
 design dev.
 bidding
 permits/ll review 04-06-18
 construction

REVISIONS: 04-20-18

Prj. no. 8-218-030
 Drawn RM - GV
 Checked KR - GV
 Approved KN

Do not scale this print. Use figured dimensions only.

Drawing title:
REFLECTED CEILING PLAN

Sheet no.
A-2.1

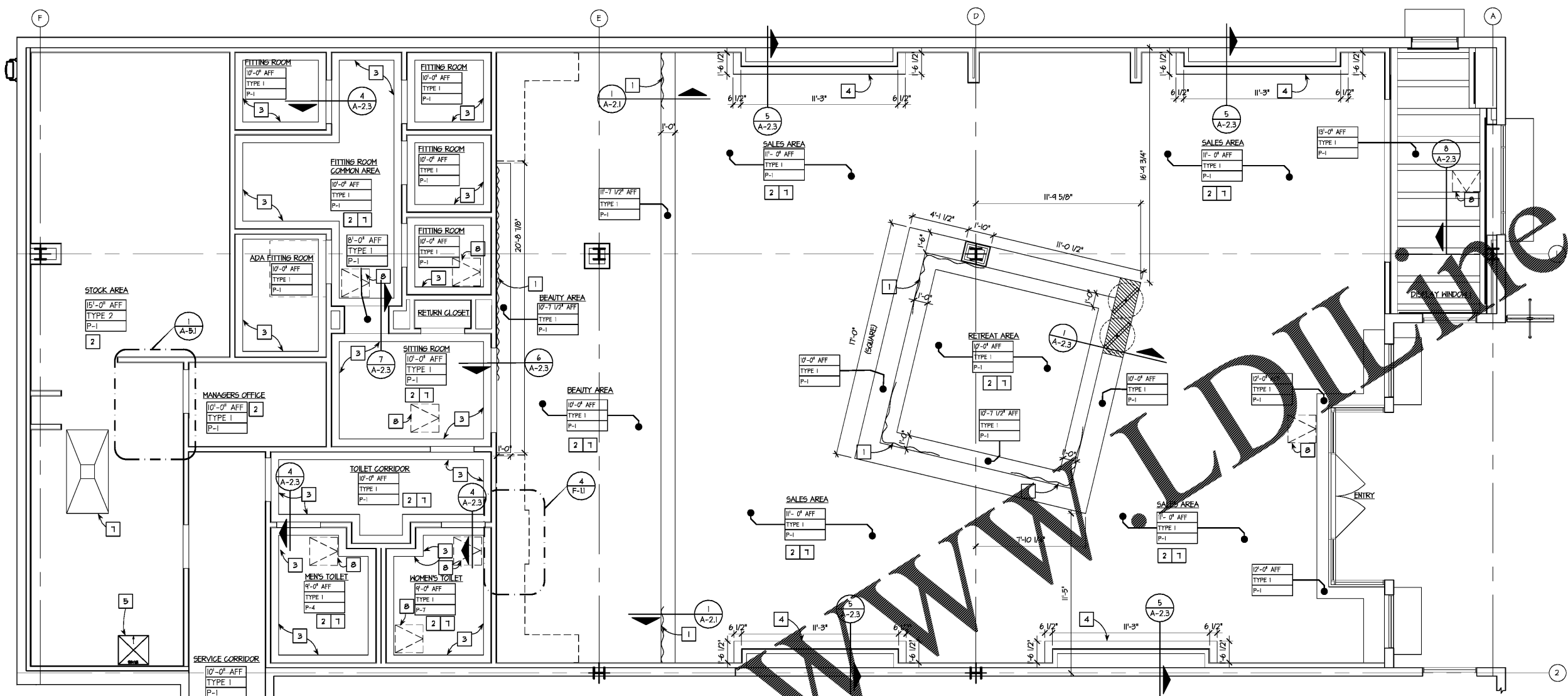

REFLECTED CEILING PLAN
 SCALE: 1/4" = 1'-0"

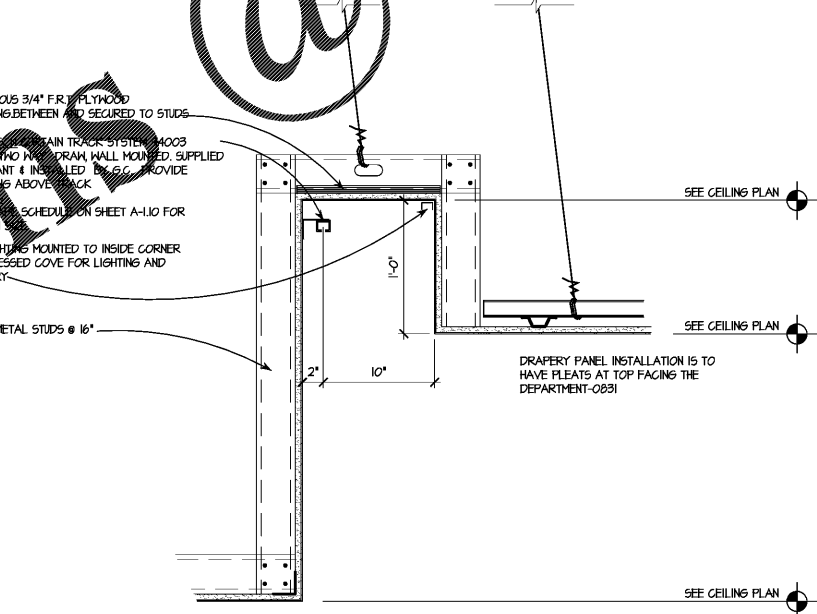

1 CURTAIN /DRAPE TRACK AT LGT COVE IN BEAUTY DEPT
 A-2.1 SCALE: 1 1/2" = 1'-0"

REFLECTED CEILING TYPES

HEIGHT AFF: 5/8" GYPSUM WALL BOARD SUSPENDED ON 7/8" HAT TRACK SECURED TO COLD ROLLED CHANNELS 48" ON CENTER (OR USG DRYWALL SUSPENSION SYSTEM OR EQUAL) SECURED FROM TOP CHORD OF BR JOISTS ABOVE FRAME DETAILS AS SHOWN OR AS REQUIRED, CLARIFY IN BID CLARIFICATIONS.
 TYPE 1
 FINISH: GYP

HEIGHT AFF: OPEN TO DECK ABOVE. DECK HEIGHT VARIES. DECK, JOISTS AND MECHANICAL EQUIPMENT TO BE CLEANED PRIOR TO RECEIVING FINISH. (P-1)
 TYPE 2
 FINISH: GYP

REFLECTED CEILING KEY NOTES

- 1 CEILING MOUNTED CURTAIN SYSTEM. ARCHITRAC SERIES 6403 RAILS W/ BALL BARRING CARRIERS CARRYING CUSTOM SHEER DRAPERY PANELS.
- 2 TENANTS COMMUNICATION CONTRACTORS WILL COORDINATE WITH TENANTS GENERAL CONTRACTOR THE IN CEILING CAMERA LOCATIONS, MOTION DETECTORS AND SPEAKERS. SEE COVER SHEET FOR CONTACT.
- 3 LINE OF MILLHORK CROWN TRIM AT CEILING WITH QUIET FRIEZE BOARD. IN TOILET ROOMS, TOILET CORRIDOR, FITTING ROOM CORRIDOR, AND FITTING ROOMS. CROWN PROVIDED AND INSTALLED BY TENANTS FIXTURE/MILLHORK CONTRACTOR. REFERENCE FIXTURE SHOP DRAWINGS.
- 4 LINE OF MILLHORK CROWN TRIM AT CEILING WITH FRIEZE BOARD ALONG PERIMETER OF FEATURE WALLS AS INDICATED ON THE PLAN. PROVIDED AND INSTALLED BY TENANTS FIXTURE/MILLHORK CONTRACTOR. REFERENCE FIXTURE SHOP DRAWINGS FOR ASSEMBLY.
- 5 ELECTRICAL SERVICE TRANSFORMER LOCATED ON PLATFORM IN STOCK AREA. SEE ELECTRICAL DRAWINGS.
- 6 CONCEALED INTEX FORMS (408-846-5667). G.C. TO PROVIDE AND INSTALL FLUSH ACCESS PANELS IN GYP CEILING FOR PIPES, ETC. AND LOCATIONS. ACCESS PANELS TO LED DRIVERS AND FINAL HOOK UP OF SAME. G.C. TO PLACE AS CLOSE AS POSSIBLE TO AREAS NOTED. PANEL MAXIMUM SIZE IS 24x24 ACCESS PANEL.
- 7 EXHAUST HOOD FOR CLOTHING STEAMER. REFER TO HVAC DRAWINGS FOR EXHAUSTING DIAGRAM.
- 8 G.C. TO PROVIDE AND INSTALL 2x2 ACCESS PANELS WHERE REQUIRED (I.E. BELOW HVAC EQUIPMENT ETC.) V.I.F. (OR AS INDICATED ON G.L.S. PLAN THIS SHEET). PANELS TO BE MANUFACTURED BY "INTEX FORMS" FIERGLASS WITH ROUND EDGES, TAPE IN PANELS. CONTACT: WWW.INTEXFORMS.COM. ALL ABOVE BY G.C.

NOTE: NEW BLADE SIGN AND NEW ANNING REFER TO EXTERIOR ELEVATION FOR FURTHER INFORMATION.

REFLECTED CEILING PLAN GENERAL NOTES

- A. LIGHT FIXTURE CIRCUITRY AS INDICATED ON ELECTRICAL SHEETS. LIGHTING FIXTURES LOCATED ON THIS SHEET AND TAKE PRECEDENCE OVER MECHANICAL COMPONENTS. CALL ARCHITECT AND OR TENANT REPRESENTATIVE FOR RELOCATION DISCREPANCIES RESOLUTION.
- B. DIFFUSERS, GRILLES EMERGENCY LIGHT FIXTURE UNIT BASE PLATES, RECEPTACLES, ACCESS PANELS, AND ALL SUSPENSION APPARATUS OF LIGHTING FIXTURES ARE TO BE PAINTED TO MATCH ADJACENT CEILING.
- C. EXIT SIGNS ARE TO BE INTERNALLY ILLUMINATED AND COLOR AS PER CODE REQUIREMENTS (RED/GREEN)
- D. LIGHT FIXTURES SHOWN ON REFLECTED CEILING PLAN TAKE PRECEDENCE OVER THE LIGHTING PLAN ON THE ELECTRICAL SHEETS. CIRCUITING ON ELECTRICAL SHEETS IS TO BE MAINTAINED. THE LIGHT FIXTURES ARE TO BE INSTALLED PER THIS REFLECTED CEILING PLAN.
- E. SEE RESPONSIBILITY SCHEDULE FOR DIVISION OF LABOR.
- F. SEE MEP-FP DRAWINGS FOR ADDITIONAL NOTES, SPECIFICATIONS AND REQUIREMENTS FOR ALL ELECTRICAL, MECHANICAL AND FIRE PROTECTION ITEMS.
- G. SEE FIRE PROTECTION DRAWINGS FOR QUANTITY AND LOCATION OF HEADS. SUBMIT SHOP DRAWINGS FOR APPROVAL PRIOR TO LAYOUT.
- H. COORDINATE WITH OWNER'S VENDORS FOR MUSIC AND SECURITY BEFORE CLOSING CEILING.
- I. VERIFY ALL FIXTURE TYPES, LOCATIONS AND VOLTAGES. COORDINATE WITH OWNER'S VENDOR AND ELECTRICAL DRAWINGS.
- M. SPRINKLER HEADS: GYPSUM BOARD CEILING TO HAVE CONCEALED HEADS.
- N. COORDINATE LOCATION OF SPEAKERS WITH TENANT VENDOR.
- O. TERMINATE SECURITY SYSTEM RING AT SERVER LOCATION
- P. ALL CHANDELIERS INDICATED ARE TO HAVE MOUNTED ABOVE CEILING FOR PROPER SUPPORT OF CHANDELIERS A HEAVY DUTY SUSPENSION BRACKET

Order Plans @