

X:\JGA\Projects\1218082\Correspondence\Consultants\India\1218082\_CAD\A-19\_8082.dwg, 4/9/2018 5:30:12 PM, PDF995

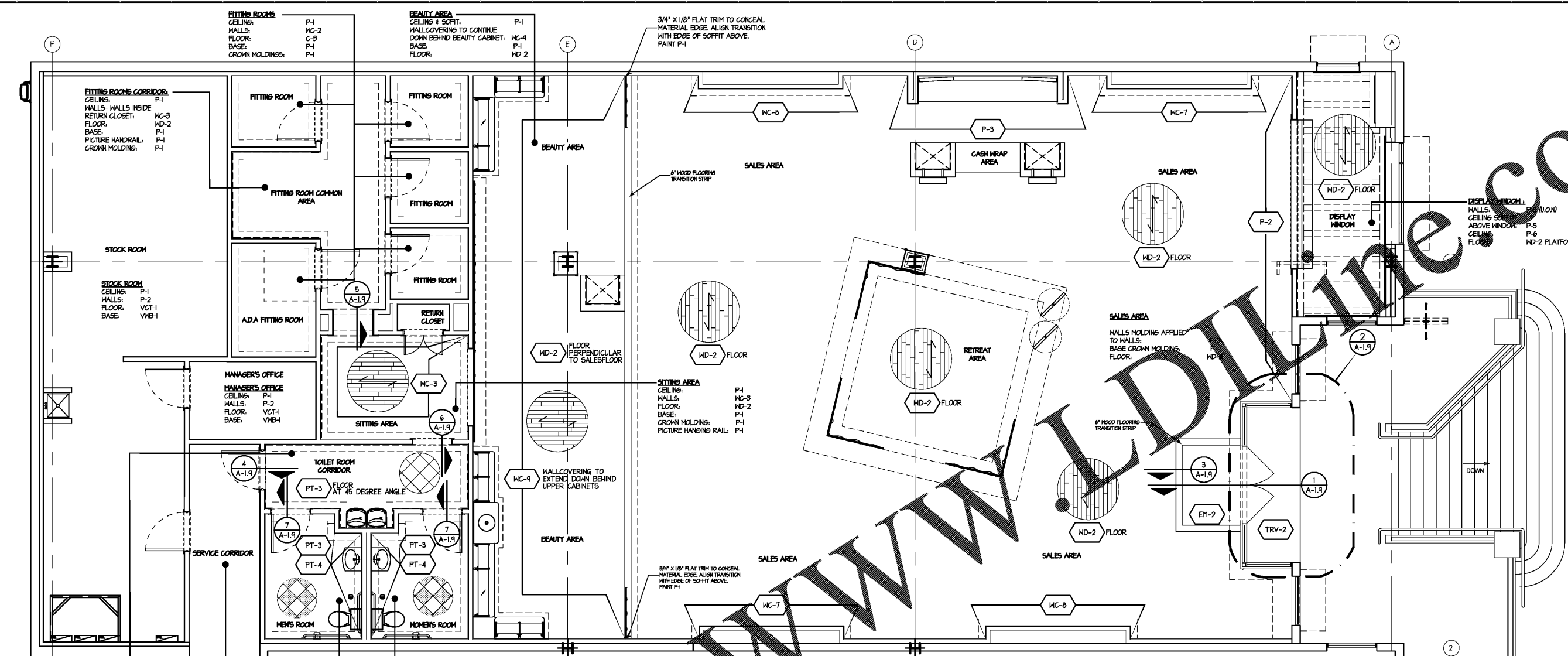

**DECOR FLOOR PLAN**  
SCALE: 1/4" = 1'-0"

**Order Plans**

**3 TYPICAL COCOA MAT / WOOD FLOOR TRANSITION**  
SCALE: FULL  
FTCPWD01

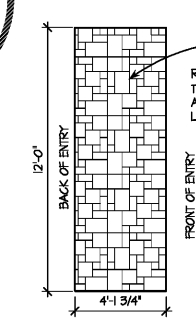

**2 ENTRY TILE LAYOUT**  
SCALE: N.T.S.

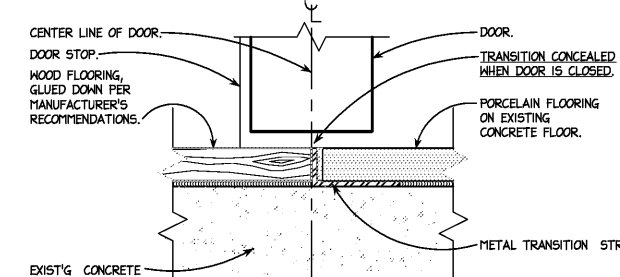
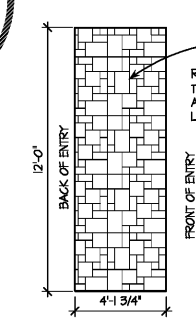

**6 TYPICAL WOOD / TILE FLOOR TRANSITION**  
SCALE: FULL  
FTCPCC01

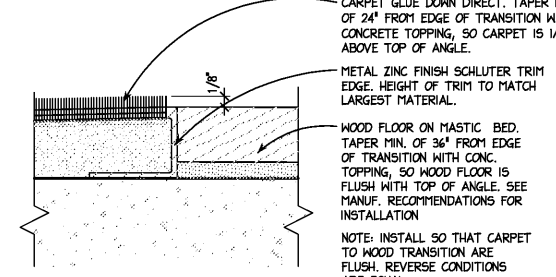

**5 TYPICAL CARPET / WOOD FLOOR TRANSITION**  
SCALE: FULL  
FTCPWD01

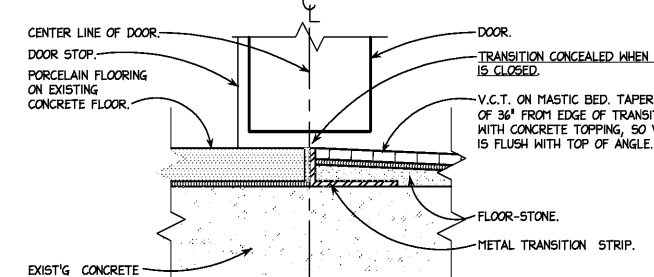

**4 TYPICAL TILE / VCT FLOOR TRANSITION**  
SCALE: FULL  
FTCPCC01

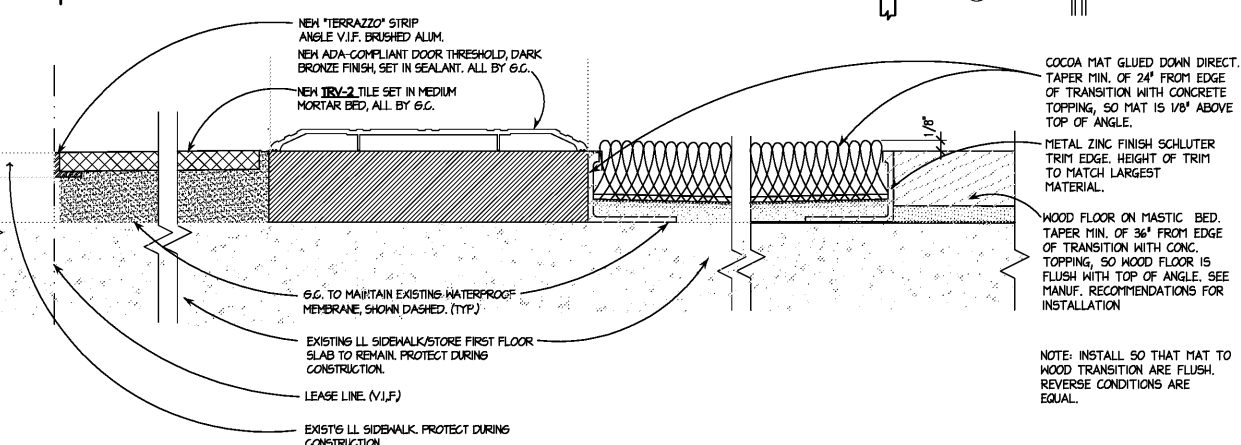

**1 ENTRY FLOOR TRANSITION**  
SCALE: FULL  
FTCPWD01-ENTRY

NOTE: INSTALL SO THAT MAT TO WOOD TRANSITION ARE FLUSH. REVERSE CONDITIONS ARE EQUAL.

REVISIONS:

Prj. no. 8-218-030  
Drawn IN, GV  
Checked KR, GV  
Approved KN

Do not scale this print. Use figured dimensions only.

Drawing title: **DECOR FLOOR PLAN**

Sheet no. **A-1.9**

**KEEN NISCH, AIA**

1110 Inlake Road  
Suite 200  
Southfield, MI 48034 USA  
248 355 0890  
248 355 0895 Fax

Copyright © 2014  
KEN NISCH, AIA  
All rights reserved

Certification:  
KENNETH E. NISCH, AIA  
No. 5090  
EXPIRATION DATE: 06/30/2016

DATE SIGNED: 03/30/2016

Consultants:  
**RETAIL DESIGN CONSULTANT**

**JGA INC**  
29355 Northwestern Hwy  
Suite 300  
Southfield, MI 48034 USA  
248 355 0890  
248 355 0895 Fax  
www.jga.com

**JGA Prj #: 1-218-082**

Project Location:  
**Soft Surroundings**  
**BILTMORE VILLAGE, SPACE #160**  
10 BROOK STREET  
ASHEVILLE, TN 28803

DRAWINGS ISSUED FOR:

- programming
- schematic des.
- design dev.
- bidding
- permits/IT review 04-06-18
- construction