

CONTRACTOR MUST PROTECT EXISTING UNDERGROUND 9" X 16" BOX CULVERT AT ALL TIMES. PREVENT DISTURBANCE OF CULVERT AT ALL TIMES DURING CONSTRUCTION.

UTILITY KEYNOTES

- 1. INSTALL CONCRETE FLUME AND SALVAGED TRENCH DRAIN
- 2. REPLACE EXISTING STORM STRUCTURE IN KIND. REPLACE EXISTING CASTING WITH BEEHIVE CASTING (NEENAG R-4346 OR APPROVED EQUAL)
- 3. ELECTRICAL CONDUIT FROM POLE MOUNTED TRANSFORMER (SEE ELECTRICAL PLANS)
- 4. 1 1/2" PVC WATER SERVICE
- 5. FIRE HYDRANT ASSEMBLY
- 6. CONNECT TO EXISTING WATER MAIN
- 7. 6" WATER MAIN
- 8. LIGHT POLE (SEE ELECTRICAL PLANS)
- 9. (2) 4" IT CONDUIT (INSTALL BY DIRECTIONAL BORE WHERE APPLICABLE PER ELECTRICAL PLANS)
- 10. SITE LIGHTING CONDUIT (SEE ELECTRICAL PLANS)
- 11. INSPECTION PORT FOR UNDERGROUND DETENTION CHAMBER
- 12. HAND HOLE FOR ELECTRICAL CONDUIT (SEE ELECTRICAL PLANS)
- 13. RPZ IN HOT BOX (SEE PLUMBING PLANS)

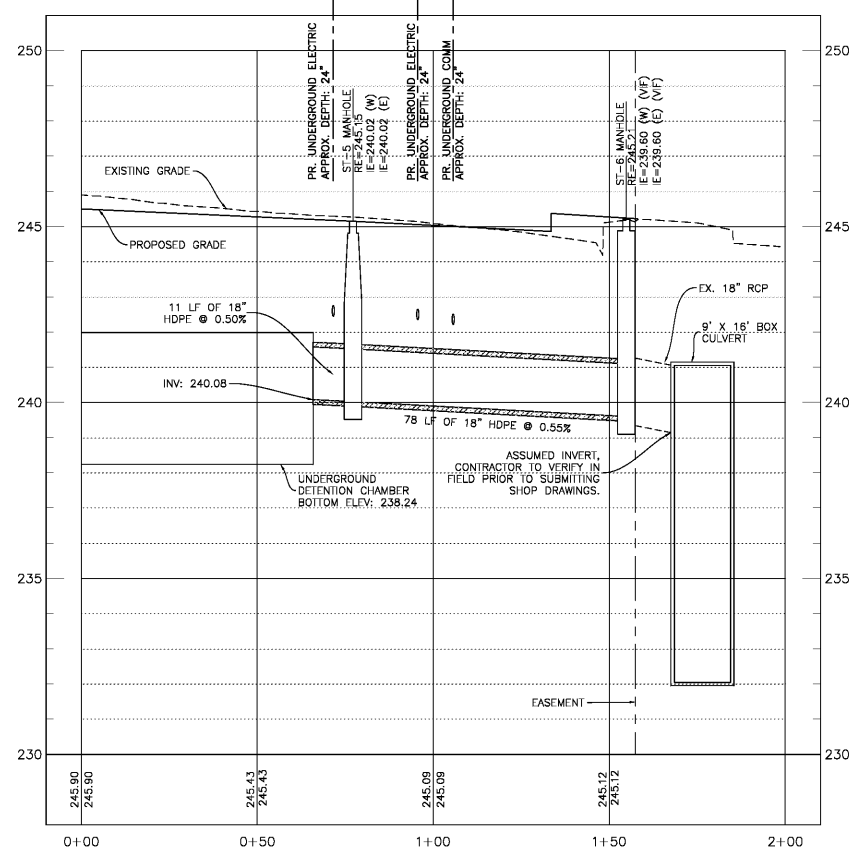

STORM CENTERLINE PROFILE  
HOR. SCALE 1" = 20'  
VERT. SCALE 1" = 2'

Order Plans @ [www.wildfire.com](http://www.wildfire.com)

Vertical scale markers on the left side of the drawing: three eighths inch = one foot, one eighth inch = one foot, one quarter inch = one foot, one half inch = one foot, one inch = one foot, one and one half inches = one foot, two inches = one foot, three inches = one foot, four inches = one foot, five inches = one foot, six inches = one foot, seven inches = one foot, eight inches = one foot, nine inches = one foot, ten inches = one foot, eleven inches = one foot, twelve inches = one foot.

 <b>U.S. Department of Veterans Affairs</b> MEMPHIS VAMC 1030 JEFFERSON AVE, MEMPHIS, TN 38104	 ARCHITECT/ENGINEERS: <b>GUIDON DESIGN</b> 905 N. CAPITOL AVE. SUITE 100 INDIANAPOLIS, IN 46204 317.800.6388 WWW.GUIDONDESIGN.COM SUSTAINABLE ARCHITECTURE + ENGINEERING	PROJECT LEAD Architect, Structural Engineer, Civil Engineer <b>GUIDON DESIGN</b> 1151 Kildaire Farm Rd. Suite 120 Cary, NC 27511 MEP Engineer APOGEE CONSULTING GROUP 3211 Internet Blvd., Suite 220 Frisco, TX 75034 Functional Design CARL WALKER INC. 1151 Kildaire Farm Rd. Suite 120 Cary, NC 27511 Telephone: 919-858-7420 / 469-777-5143	Drawing Title <b>UTILITY PLAN</b>	Project Title <b>CONSTRUCT PARKING GARAGE ON WEST LOT</b>	Project Number <b>15.1067</b>	<b>OFFICE OF FACILITIES MANAGEMENT</b> VA Project Number <b>614-319</b>
			Approved for Design Concept: <b>FACILITY MANAGEMENT DIVISION MANAGER</b>	Location <b>MEMPHIS, TN</b>	Building Number <b>CU101</b>	
Revisions:	Date:	Date: <b>11/14/2016</b>	Checked By: <b>KJC</b>	Drawn By: <b>CMB</b>	Drawing Number <b>CU101</b>	 U.S. Department of Veterans Affairs