

A
three inches = one foot
B
one and one half inches = one foot
C
one inch = one foot
D
three quarters inch = one foot
E
one half inch = one foot
F
three eighths inch = one foot
G
one quarter inch = one foot
H
one eighth inch = one foot
I
one eighth inch = one foot
J
one eighth inch = one foot
K
one eighth inch = one foot
L
one eighth inch = one foot
M
one eighth inch = one foot
N
one eighth inch = one foot
O
one eighth inch = one foot
P
one eighth inch = one foot
Q
one eighth inch = one foot
R
one eighth inch = one foot
S
one eighth inch = one foot
T
one eighth inch = one foot
U
one eighth inch = one foot
V
one eighth inch = one foot
W
one eighth inch = one foot
X
one eighth inch = one foot
Y
one eighth inch = one foot
Z
one eighth inch = one foot



A PICTURE (EXISTING CONDITIONS, FOR REFERENCE ONLY)
NTS
NOTE: EXISTING HOIST WAY VENT TO BE DEMOLISHED AND REPLACED WITH NEW. REFER TO DETAIL 3/MH601 FOR NEW HOIST WAY VENT AND FLASHING REQUIREMENTS.

- KEYED NOTES**
- NEW 40"x40" ROOFTOP HOIST WAY VENT ON TOP OF ROOF. SEE DETAIL 3/MH601 FOR HOIST WAY VENT AND FLASHING REQUIREMENTS.
 - TIE NEW SMOKE DETECTOR (BY ELECTRICAL) TO FACP AND FACP. SEE DETAIL 4/MH601.
 - DEMOLISH EXISTING HOIST WAY VENT AND REPLACE WITH NEW.

- GENERAL NOTES**
- THE DRAWING SHOWS THE GENERAL ARRANGEMENT AND LOCATION OF EQUIPMENT, DUCTWORK, PIPING, ETC. THE CONTRACTOR SHALL BE RESPONSIBLE FOR COORDINATING THE MECHANICAL INSTALLATION WITH THE STRUCTURE AND OTHER TRADES AND SHALL PROVIDE ADDITIONAL OFFSETS AND FITTINGS AS NECESSARY.
 - THE HEATING, VENTILATING AND AIR CONDITIONING SYSTEMS SHALL COMPLY WITH THE 2012 EDITION OF THE INTERNATIONAL MECHANICAL CODE, NFPA 90A, AND LOCAL CODE OFFICIAL REQUIREMENTS. IN THE EVENT OF A CONFLICT BETWEEN CODES, THE MOST STRINGENT SHALL ALWAYS GOVERN.
 - THE CONTRACTOR SHALL CHECK AND VERIFY ALL CLEARANCES PRIOR TO FABRICATION OR INSTALLATION OF EQUIPMENT, DUCTWORK, AND PIPING SYSTEMS. WHERE CONDITIONS REQUIRE A CHANGE IN DUCT OR PIPE ROUTING, NOTIFY THE CONTRACTING OFFICER FOR AN ACCEPTABLE ALTERNATIVE METHOD. LOCATE ALL MECHANICAL EQUIPMENT SO THAT COMPONENTS REQUIRING ACCESS (SERVICE AND MAINTENANCE) ARE FULLY ACCESSIBLE.
 - INSTALL ALL DUCT MOUNTED DEVICES (DAMPERS, ETC.) AND PIPING SPECIALTIES IN EASILY ACCESSIBLE LOCATIONS. ADVISE THE CONTRACTING OFFICER IN ADVANCE OF INSTALLATION IF ACCESS WILL BE HINDERED SO AN ALTERNATE LOCATION CAN BE SELECTED.
 - THE CONTRACTOR SHALL FIRESTOP ALL PENETRATIONS OF FIRE RATED WALLS/FLOORS/CEILINGS BY DUCTWORK PIPING, ETC., WITH U.L. LISTED FIRE STOPPING MATERIAL TO MAINTAIN FIRE RATINGS OF THE BARRIER.
 - SEISMIC PROTECTION OF EQUIPMENT, DUCTWORK, PIPING AND UTILITIES SHALL BE PROVIDED IN ACCORDANCE WITH SECTION 16 OF THE 2012 EDITION OF THE INTERNATIONAL BUILDING CODE. ALL SEISMIC RESTRAINT AND BRACING SHALL BE SUBSTANTIATED BY MANUFACTURER'S SUBMITTALS PER THE SPECIFICATIONS.



2 ROOF PLAN - MECH. - BLDG D
3/16" = 1'-0"

MECHANICAL LEGEND

AFF	ABOVE FINISHED FLOOR
(E)	EXISTING
ECC	ENGINEERING CONTROL CENTER
ESP	EXTERNAL STATIC PRESSURE
FACP	FIRE ALARM CONTROL PANEL
HVD	HOIST WAY VENT DAMPER
NTS	NOT TO SCALE
WMBS	WIRE MESH BIRD SCREEN
M	MOTORIZED DAMPER
SD	SMOKE DETECTOR

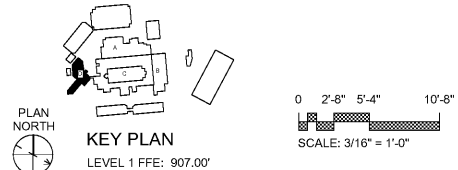

100% CONSTRUCTION DOCUMENT SUBMISSION FULLY SPRINKLERED

Order Plans @ www.LDOnline.com

CONSULTANTS:
Date

ARCHITECT/ENGINEERS:
BES DESIGN/BUILD
766 Middle St, Fairhope, AL 36532
Phone: 251.990.5778
Fax: 251.990.3716

Drawing Title
MECHANICAL NEW WORK PLAN - BLDG D
Approved: Project Director

Project Title
UPGRADE ELEVATORS BUILDINGS A, B, C, and D
Location
ATLANTA VAMC
1670 CLAIRMONT ROAD, DECATUR, GA, 30033
Date
2017.05.01
Drawn
MDF
Checked
WWB
Project Number
508-14-123
Building Number
A, B, C & D
Drawing Number
MH101.D
Dwg. 19 of 28

ATLANTA VA MEDICAL CENTER
Department of Veterans Affairs