

**A PICTURE**  
NTS (EXISTING CONDITIONS, FOR REFERENCE ONLY)

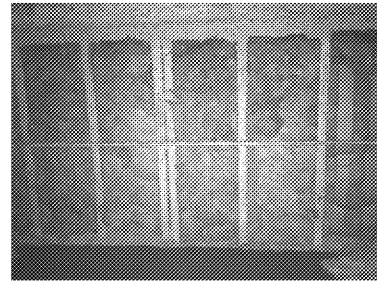

**B PICTURE**  
NTS (EXISTING CONDITIONS, FOR REFERENCE ONLY)

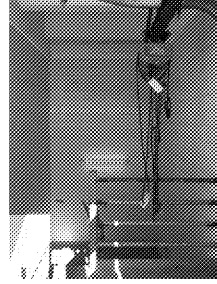

**C PICTURE**  
NTS (EXISTING CONDITIONS, FOR REFERENCE ONLY)



**D PICTURE**  
NTS (EXISTING CONDITIONS, FOR REFERENCE ONLY)



- KEYED NOTES**
- PROVIDE NEW 48"x36" LOUVER WITH POWER CLOSED DAMPER. PROVIDE LOUVER WITH WMBS FINISH AND KYNAR FINISH. COORDINATE COLOR WITH EXISTING. PENETRATE HOISTWAY THROUGH PENTHOUSE MECHANICAL ROOM FLOOR AND THROUGH NON-COMBUSTIBLE DUCT TO EXTERIOR WALL LOUVER. REFERENCE DETAIL 6/MH01 FOR LOUVER INSTALLATION.
  - HOISTWAY VENT DAMPER NORMALLY CLOSED.
  - TIE NEW SMOKE DETECTOR (SD) TO EXISTING DDC AND FACP. SEE DETAIL 4/MH01.
  - HANG DAMPERS TO STRUCTURE WITH 18 GAGE STRAP SUPPORT. SEE DETAIL 2/MH01.
  - RELOCATE ELECTRICAL CONDUIT WITHIN WORK AREA. SEE REFERENCE PHOTO A.

- GENERAL NOTES**
- THE DRAWINGS SHOW THE GENERAL ARRANGEMENT AND LOCATION OF EQUIPMENT, DUCTWORK, PIPING, ETC. THE CONTRACTOR SHALL BE RESPONSIBLE FOR COORDINATING THE MECHANICAL INSTALLATION WITH THE STRUCTURE AND OTHER TRADES AND SHALL PROVIDE ADDITIONAL OFFSETS AND FITTINGS AS NECESSARY.
  - THE HEATING, VENTILATING AND AIR CONDITIONING SYSTEMS SHALL COMPLY WITH THE 2012 EDITION OF THE INTERNATIONAL MECHANICAL CODE, NFPA 90A, AND LOCAL CODE OFFICIAL REQUIREMENTS. IN THE EVENT OF A CONFLICT BETWEEN CODES, THE MOST STRINGENT SHALL ALWAYS GOVERN.
  - THE CONTRACTOR SHALL CHECK AND VERIFY ALL CLEARANCES PRIOR TO FABRICATION OR INSTALLATION OF EQUIPMENT, DUCTWORK AND PIPING SYSTEMS. WHERE CONDITIONS REQUIRE A CHANGE IN DUCT OR PIPE ROUTING, NOTIFY THE CONTRACTING OFFICER FOR AN ACCEPTABLE ALTERNATIVE METHOD. LOCATE ALL MECHANICAL EQUIPMENT SO THAT COMPONENTS REQUIRING ACCESS (SERVICE AND MAINTENANCE) ARE FULLY ACCESSIBLE.
  - INSTALL ALL DUCT MOUNTED DEVICES (DAMPERS, ETC.) AND PIPING SPECIALTIES IN EASILY ACCESSIBLE LOCATIONS. ADVISE THE CONTRACTING OFFICER IN ADVANCE OF INSTALLATION IF ACCESS WILL BE HINDERED SO AN ALTERNATE LOCATION CAN BE SELECTED.
  - THE CONTRACTOR SHALL FIRESTOP ALL PENETRATIONS OF FIRE RATED WALLS/FLOORS/CEILING BY DUCTWORK PIPING, ETC., WITH U.L. LISTED FIRE STOPPING MATERIAL TO MAINTAIN FIRE RATING OF THE BARRIER.
  - SEISMIC PROTECTION OF EQUIPMENT, DUCTWORK, PIPING AND UTILITIES SHALL BE PROVIDED IN ACCORDANCE WITH SECTION 16 OF THE 2012 EDITION OF THE INTERNATIONAL BUILDING CODE. ALL SEISMIC RESTRAINT AND BRACING SHALL BE SUBSTANTIATED BY MANUFACTURER'S SUBMITTALS PER THE SPECIFICATIONS.
  - ELEVATOR SHAFT P-13 AND P-14 ARE LOCATED ON THE EXTERIOR OF THE BUILDING AND ABOVE THE 12TH FLOOR. THE CONTRACTOR SHALL MAKE PROVISIONS TO MAINTAIN SAFETY WHILE INSTALLING THE EXTERIOR LOUVER.

**MECHANICAL LEGEND**

AFF	ABOVE FINISHED FLOOR
(E)	EXISTING
ECC	ENGINEERING CONTROL CENTER
ESP	EXTERNAL STATIC PRESSURE
FACP	FIRE ALARM CONTROL PANEL
HVD	HOIST WAY VENT DAMPER
NTS	NOT TO SCALE
WMBS	WIRE MESH BIRD SCREEN
M	MOTORIZED DAMPER
SD	SMOKE DETECTOR
FD	FIRE DAMPER

SEE REFERENCE SHEET LSP13-C FOR EXTENT OF ROOF PLAN AND EQUIPMENT.

SEE REFERENCE SHEET LSP13-C FOR EXTENT OF ROOF PLAN AND EQUIPMENT.

**2 PENTHOUSE FLOOR - MECH. - S5, S6, P1, P2, P3, P4, P13 & P14 - BLDG C**  
3/16" = 1'-0"

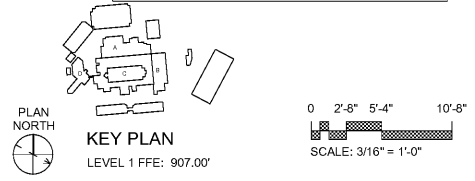

100% CONSTRUCTION DOCUMENT SUBMISSION  
FULLY SPRINKLERED

CONSULTANTS:

ARCHITECT/ENGINEERS:  
  
 BES DESIGN/BUILD, LLC  
 766 Middle St, Fairhope, AL 36532  
 Phone: 251.990.5778  
 Fax: 251.990.3716

Drawing Title  
**MECHANICAL NEW WORK PLAN - BLDG C**  
 Approved: Project Director

Project Title  
**UPGRADE ELEVATORS BUILDINGS A, B, C, and D**  
 Location  
 ATLANTA VAMC  
 1670 CLAIRMONT ROAD, DECATUR, GA, 30033  
 Date  
 2017.05.01  
 Drawn  
 MDF  
 Checked  
 WWB  
 Project Number  
 508-14-123  
 Building Number  
 A, B, C & D  
 Drawing Number  
**MH101.C**  
 Dwg. 18 of 28

ATLANTA VA MEDICAL CENTER

Scale: one eighth inch = one foot  
 one quarter inch = one foot  
 one half inch = one foot  
 three eighths inch = one foot  
 one inch = one foot  
 one and one half inches = one foot  
 two inches = one foot  
 three inches = one foot  
 three and one half inches = one foot  
 four inches = one foot  
 four and one half inches = one foot  
 five inches = one foot  
 five and one half inches = one foot  
 six inches = one foot  
 six and one half inches = one foot  
 seven inches = one foot  
 seven and one half inches = one foot  
 eight inches = one foot  
 eight and one half inches = one foot  
 nine inches = one foot  
 nine and one half inches = one foot  
 ten inches = one foot  
 ten and one half inches = one foot  
 eleven inches = one foot  
 eleven and one half inches = one foot  
 twelve inches = one foot  
 twelve and one half inches = one foot  
 thirteen inches = one foot  
 thirteen and one half inches = one foot  
 fourteen inches = one foot  
 fourteen and one half inches = one foot  
 fifteen inches = one foot  
 fifteen and one half inches = one foot  
 sixteen inches = one foot  
 sixteen and one half inches = one foot  
 seventeen inches = one foot  
 seventeen and one half inches = one foot  
 eighteen inches = one foot  
 eighteen and one half inches = one foot  
 nineteen inches = one foot  
 nineteen and one half inches = one foot  
 twenty inches = one foot  
 twenty and one half inches = one foot  
 twenty one inches = one foot  
 twenty one and one half inches = one foot  
 twenty two inches = one foot  
 twenty two and one half inches = one foot  
 twenty three inches = one foot  
 twenty three and one half inches = one foot  
 twenty four inches = one foot  
 twenty four and one half inches = one foot  
 twenty five inches = one foot  
 twenty five and one half inches = one foot  
 twenty six inches = one foot  
 twenty six and one half inches = one foot  
 twenty seven inches = one foot  
 twenty seven and one half inches = one foot  
 twenty eight inches = one foot  
 twenty eight and one half inches = one foot  
 twenty nine inches = one foot  
 twenty nine and one half inches = one foot  
 thirty inches = one foot  
 thirty and one half inches = one foot  
 thirty one inches = one foot  
 thirty one and one half inches = one foot  
 thirty two inches = one foot  
 thirty two and one half inches = one foot  
 thirty three inches = one foot  
 thirty three and one half inches = one foot  
 thirty four inches = one foot  
 thirty four and one half inches = one foot  
 thirty five inches = one foot  
 thirty five and one half inches = one foot  
 thirty six inches = one foot  
 thirty six and one half inches = one foot  
 thirty seven inches = one foot  
 thirty seven and one half inches = one foot  
 thirty eight inches = one foot  
 thirty eight and one half inches = one foot  
 thirty nine inches = one foot  
 thirty nine and one half inches = one foot  
 forty inches = one foot  
 forty and one half inches = one foot  
 forty one inches = one foot  
 forty one and one half inches = one foot  
 forty two inches = one foot  
 forty two and one half inches = one foot  
 forty three inches = one foot  
 forty three and one half inches = one foot  
 forty four inches = one foot  
 forty four and one half inches = one foot  
 forty five inches = one foot  
 forty five and one half inches = one foot  
 forty six inches = one foot  
 forty six and one half inches = one foot  
 forty seven inches = one foot  
 forty seven and one half inches = one foot  
 forty eight inches = one foot  
 forty eight and one half inches = one foot  
 forty nine inches = one foot  
 forty nine and one half inches = one foot  
 fifty inches = one foot  
 fifty and one half inches = one foot  
 fifty one inches = one foot  
 fifty one and one half inches = one foot  
 fifty two inches = one foot  
 fifty two and one half inches = one foot  
 fifty three inches = one foot  
 fifty three and one half inches = one foot  
 fifty four inches = one foot  
 fifty four and one half inches = one foot  
 fifty five inches = one foot  
 fifty five and one half inches = one foot  
 fifty six inches = one foot  
 fifty six and one half inches = one foot  
 fifty seven inches = one foot  
 fifty seven and one half inches = one foot  
 fifty eight inches = one foot  
 fifty eight and one half inches = one foot  
 fifty nine inches = one foot  
 fifty nine and one half inches = one foot  
 sixty inches = one foot  
 sixty and one half inches = one foot  
 sixty one inches = one foot  
 sixty one and one half inches = one foot  
 sixty two inches = one foot  
 sixty two and one half inches = one foot  
 sixty three inches = one foot  
 sixty three and one half inches = one foot  
 sixty four inches = one foot  
 sixty four and one half inches = one foot  
 sixty five inches = one foot  
 sixty five and one half inches = one foot  
 sixty six inches = one foot  
 sixty six and one half inches = one foot  
 sixty seven inches = one foot  
 sixty seven and one half inches = one foot  
 sixty eight inches = one foot  
 sixty eight and one half inches = one foot  
 sixty nine inches = one foot  
 sixty nine and one half inches = one foot  
 seventy inches = one foot  
 seventy and one half inches = one foot  
 seventy one inches = one foot  
 seventy one and one half inches = one foot  
 seventy two inches = one foot  
 seventy two and one half inches = one foot  
 seventy three inches = one foot  
 seventy three and one half inches = one foot  
 seventy four inches = one foot  
 seventy four and one half inches = one foot  
 seventy five inches = one foot  
 seventy five and one half inches = one foot  
 seventy six inches = one foot  
 seventy six and one half inches = one foot  
 seventy seven inches = one foot  
 seventy seven and one half inches = one foot  
 seventy eight inches = one foot  
 seventy eight and one half inches = one foot  
 seventy nine inches = one foot  
 seventy nine and one half inches = one foot  
 eighty inches = one foot  
 eighty and one half inches = one foot  
 eighty one inches = one foot  
 eighty one and one half inches = one foot  
 eighty two inches = one foot  
 eighty two and one half inches = one foot  
 eighty three inches = one foot  
 eighty three and one half inches = one foot  
 eighty four inches = one foot  
 eighty four and one half inches = one foot  
 eighty five inches = one foot  
 eighty five and one half inches = one foot  
 eighty six inches = one foot  
 eighty six and one half inches = one foot  
 eighty seven inches = one foot  
 eighty seven and one half inches = one foot  
 eighty eight inches = one foot  
 eighty eight and one half inches = one foot  
 eighty nine inches = one foot  
 eighty nine and one half inches = one foot  
 ninety inches = one foot  
 ninety and one half inches = one foot  
 ninety one inches = one foot  
 ninety one and one half inches = one foot  
 ninety two inches = one foot  
 ninety two and one half inches = one foot  
 ninety three inches = one foot  
 ninety three and one half inches = one foot  
 ninety four inches = one foot  
 ninety four and one half inches = one foot  
 ninety five inches = one foot  
 ninety five and one half inches = one foot  
 ninety six inches = one foot  
 ninety six and one half inches = one foot  
 ninety seven inches = one foot  
 ninety seven and one half inches = one foot  
 ninety eight inches = one foot  
 ninety eight and one half inches = one foot  
 ninety nine inches = one foot  
 ninety nine and one half inches = one foot  
 one hundred inches = one foot