

GENERAL FLOOR PLAN NOTES

1. DEPICTION OF EXISTING CONDITIONS ARE BASED ON OWNER-FURNISHED DOCUMENTS AND FIELD OBSERVATIONS. EXISTING ELEMENTS AND CONDITIONS CONCEALED BY IN-PLACE EQUIPMENT AND FINISHES WERE NOT OBSERVED OR INVESTIGATED. ONCE CUTTING AND SELECTIVE DEMOLITION WORK IS COMPLETE, REPORT ANY CONFLICTS TO ARCHITECT. THE CONTRACTOR SHALL MAKE ADJUSTMENTS AND/OR ALTERATIONS NECESSARY TO INSTALL COMPLETE AND OPERABLE SYSTEMS IN ACCORDANCE WITH THE CODES HAVING JURISDICTION. NO ADDITIONAL COST TO THE GOVERNMENT.
2. CONTRACTOR SHALL NOTIFY THE CONTRACTING OFFICE IMMEDIATELY IF THERE IS ANY CONFLICT OR DEVIATION BETWEEN THE EXISTING CONDITIONS AND THE DRAWINGS AND/OR SPECIFICATIONS.
3. ALL PENETRATIONS THROUGH RATED FLOOR/CEILING ASSEMBLIES AND THROUGH FIRE RATED AND SMOKE BARRIER ASSEMBLIES, THOSE CREATED BY REMOVAL OF PENETRATIONS AND THOSE DISCOVERED DURING CONSTRUCTION AS A RESULT OF NEW WORK AND THOSE CREATED BY NEW WORK SHALL BE SEALED PROPERLY. ALL RATED SEPARATIONS SHALL MEET CURRENT CODE REQUIREMENTS.
4. ONLY ONE ELEVATOR BANK SHALL BE WORKED ON AT A TIME. THE OTHER ELEVATORS IN THE BANK SHALL REMAIN IN WORKING ORDER UNTIL THE ELEVATOR BEING WORKED ON IS COMPLETE.
5. ALL DIMENSIONS ARE OF EXISTING CONDITIONS & SHALL BE FIELD VERIFIED.
6. REMOVE EXISTING HORIZONTAL WAY DOORS ENTIRELY WHERE NEW HORIZONTAL WAY DOORS ARE SCHEDULED.

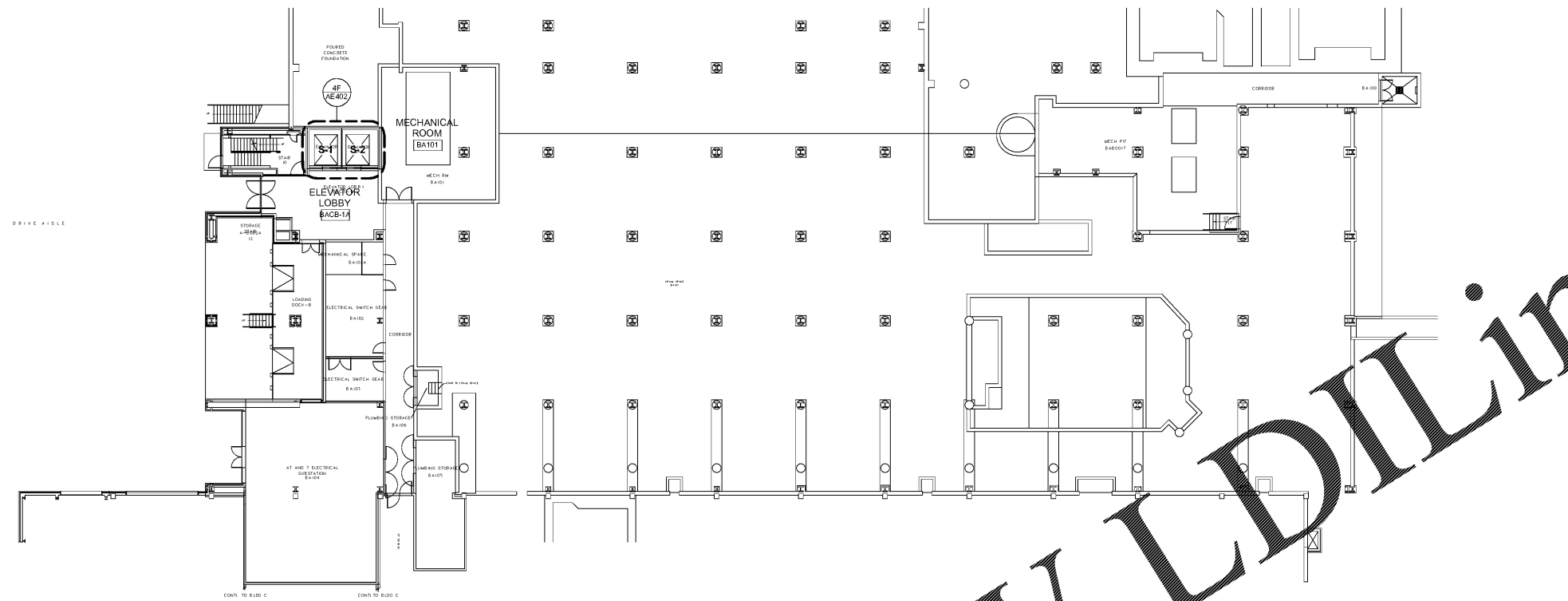

6C BASEMENT FLOOR - BLDG A
1/16" = 1'-0" 880.77'

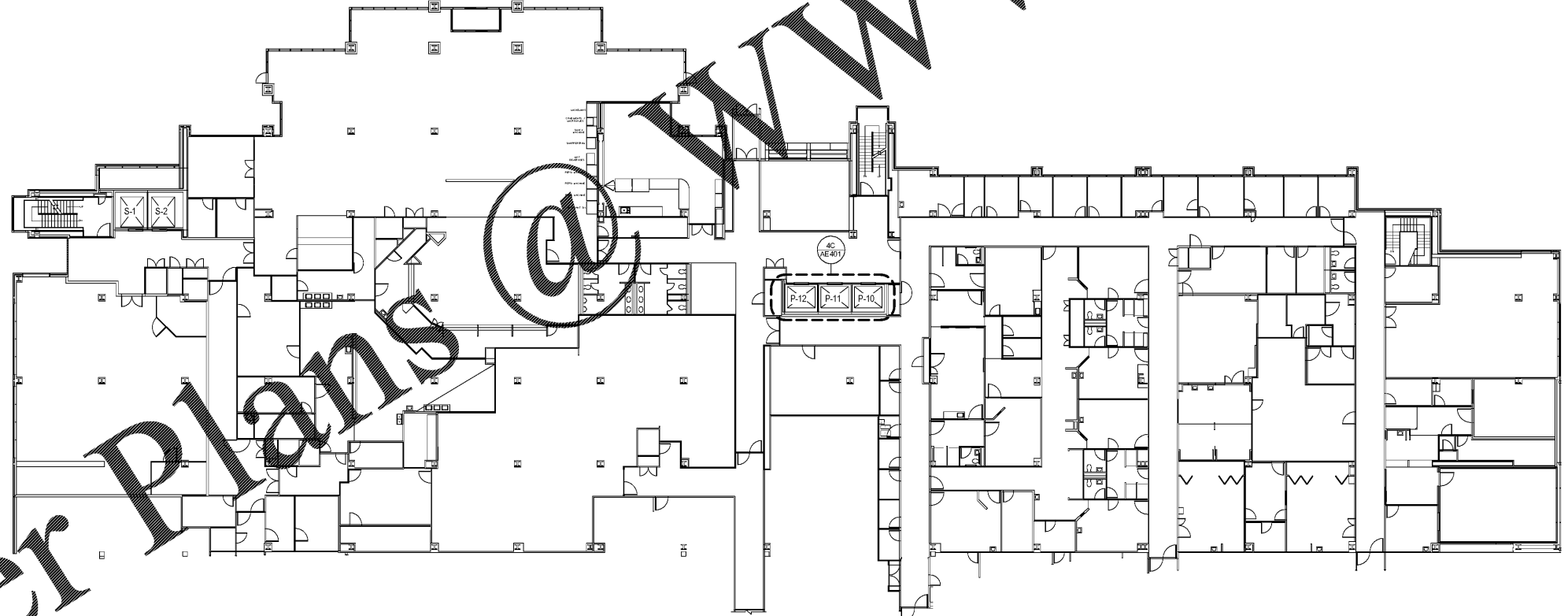

6F FIRST FLOOR - BLDG A
1/16" = 1'-0" F.F.E. 907.00'

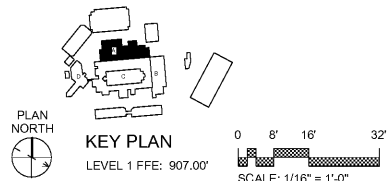

100% CONSTRUCTION DOCUMENT SUBMISSION FULLY SPRINKLERED

Order Plans @ www.ldilines.com

Project # 1411
Date 4/27/2017 3:59 PM

CONSULTANTS:

ARCHITECT/ENGINEERS:



BES DESIGN/BUILD, LLC
766 Middle St, Fairhope, AL 36532
Phone: 251.990.5778
Fax: 251.990.3716

Drawing Title
OVERALL PLAN - BASEMENT & FIRST FLOOR - BLDG A

Approved: Project Director

Project Title
UPGRADE ELEVATORS BUILDINGS A, B, C, AND D

Location
ATLANTA VAMC 1670 CLAIRMONT ROAD, DECATUR, GA, 30033

Date: 2017.05.01
Drawn: JDM
Checked: RP

Project Number
508-14-123

Building Number
A, B, C & D

Drawing Number
AE101
Dwg. 5 of 28

ATLANTA VA MEDICAL CENTER

