



SEALS  
 COPYRIGHT © 2017 ROSENBLUM COE ARCHITECTS, INC.  
 THIS DRAWING HAS BEEN PREPARED BY ROSENBLUM COE ARCHITECTS, INC. FOR THE PROJECT AND IS THE PROPERTY OF ROSENBLUM COE ARCHITECTS, INC. NO PART OF THIS DOCUMENT MAY BE REPRODUCED OR TRANSMITTED IN ANY FORM OR BY ANY MEANS, ELECTRONIC OR MECHANICAL, INCLUDING PHOTOCOPYING, RECORDING, OR BY ANY INFORMATION STORAGE AND RETRIEVAL SYSTEM, WITHOUT THE WRITTEN PERMISSION OF ROSENBLUM COE ARCHITECTS, INC. STATUTORY RIGHTS RESERVED.

NOTES

GENERAL NOTES  
 1. REFER TO P101 FOR GENERAL NOTES.

**MUSC**  
 MEDICAL UNIVERSITY  
 of SOUTH CAROLINA  
 PROJECT NUMBER: H51-50068  
 DHEC PROJECT NUMBER: 580145

**CONSTRUCTION DOCUMENTS**

**STORM EYE INSTITUTE  
 OPTICAL SHOP  
 H51-50068  
 167 ASHLEY AVE  
 CHARLESTON, SC 29425**

**ROSENBLUM COE  
 ARCHITECTS,  
 INC.**  
 1643 MEANS STREET  
 CHARLESTON, SC 29412  
 843.577.6073

**PLUMBING FIRST FLOOR PLAN**

SHEET NAME		<b>P101</b>
PROJECT NUMBER	17016	
DRAWN BY	TSN	
CHECKED BY	CRB	
DATE	05/09/2018	
SCALE	1/4" = 1'-0"	

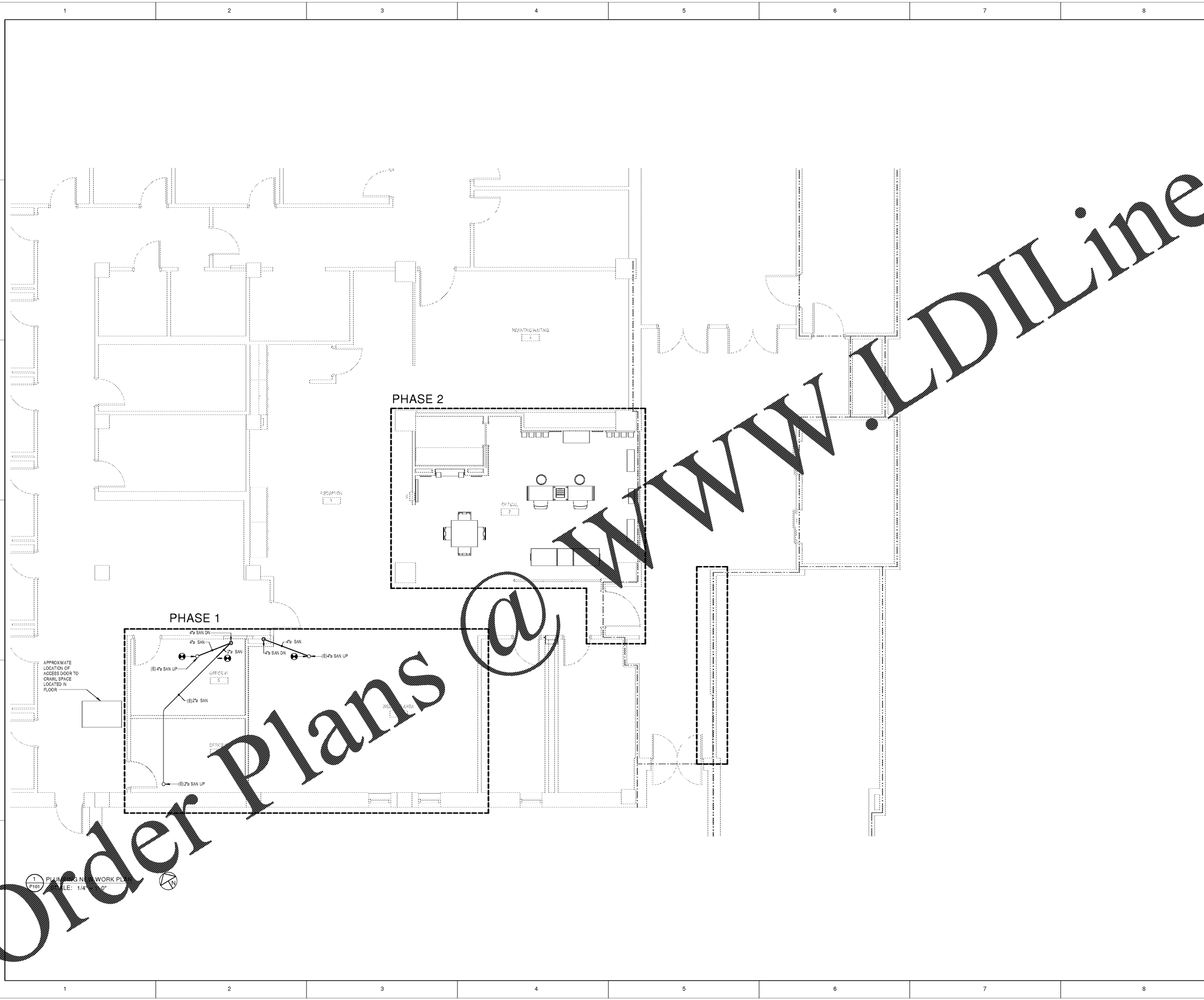

Order Plans @

www.LDILine.com