

SEALS
COPYRIGHT BY ROSENBLUM COE ARCHITECTS, INC.
THIS DRAWING HAS BEEN PREPARED BY ROSENBLUM COE ARCHITECTS, INC. FOR THE PROJECT AND IS THE PROPERTY OF ROSENBLUM COE ARCHITECTS, INC. NO PART OF THIS DOCUMENT MAY BE REPRODUCED OR TRANSMITTED IN ANY FORM OR BY ANY MEANS, ELECTRONIC OR MECHANICAL, INCLUDING PHOTOCOPYING, RECORDING, OR BY ANY INFORMATION STORAGE AND RETRIEVAL SYSTEM, WITHOUT THE WRITTEN PERMISSION OF ROSENBLUM COE ARCHITECTS, INC.

NOTES

- GENERAL NOTES
- REFER TO P001 FOR GENERAL NOTES.
 - ALL PIPING SHOWN IS LOCATED BELOW FIRST FLOOR SLAB WITHIN CRAWL SPACE. FIRST FLOOR WALLS ARE SHOWN FOR REFERENCE ONLY.

MUSC
MEDICAL UNIVERSITY
of SOUTH CAROLINA
PROJECT NUMBER: H51-50068
DHEC PROJECT NUMBER: 580145

CONSTRUCTION DOCUMENTS

STORM EYE INSTITUTE
OPTICAL SHOP
H51-50068
167 ASHLEY AVE
CHARLESTON, SC 29425

ROSENBLUM COE ARCHITECTS, INC.
1643 MEANS STREET
CHARLESTON, SC 29412
843.577.6073

PLUMBING CRAWL SPACE PLAN

SHEET NAME	
PROJECT NUMBER	17016
DRAWN BY	TSN
CHECKED BY	CRB
DATE	05/09/2018
SCALE	1/4" = 1'-0"

P100

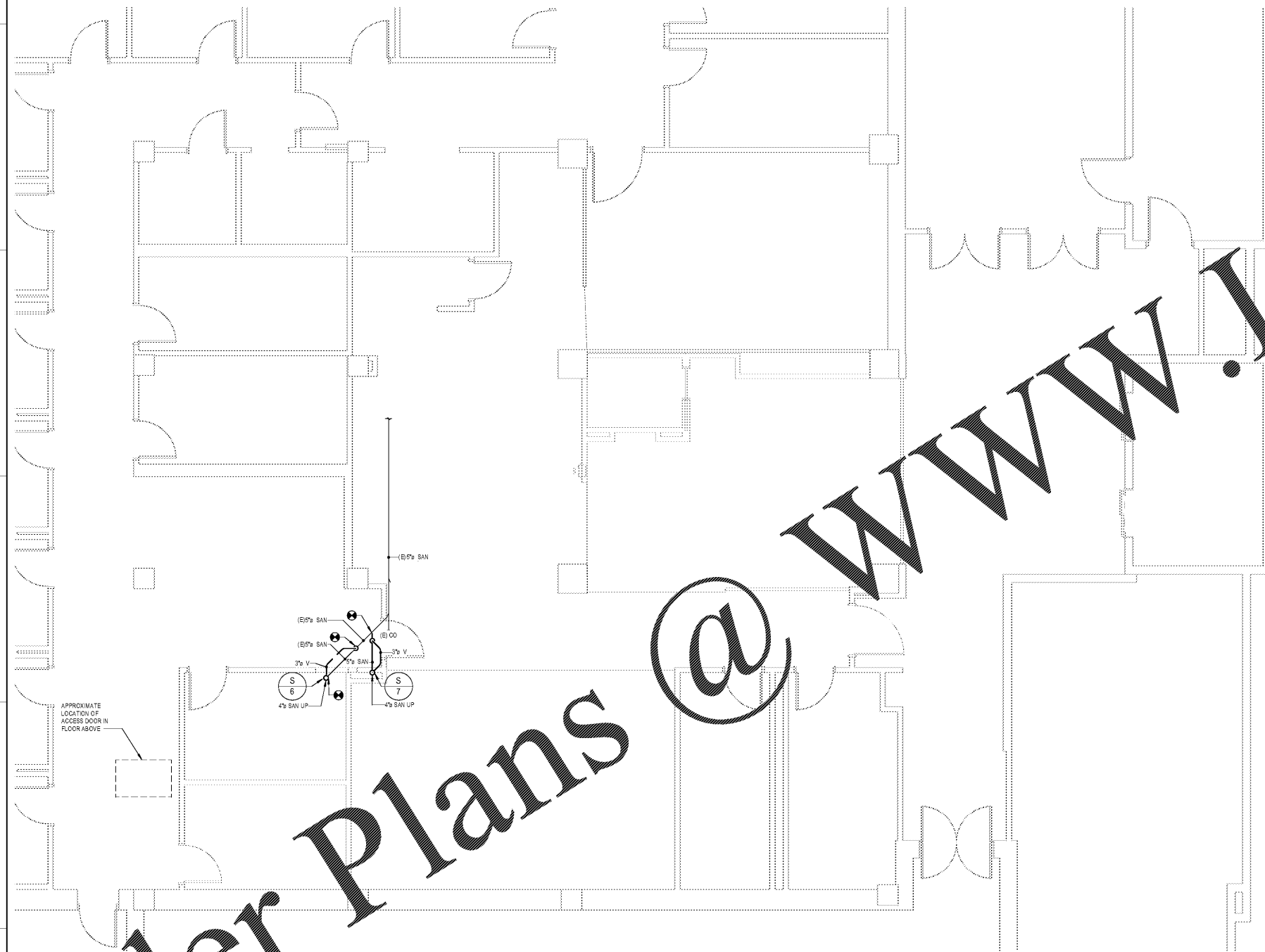

1 PLUMBING CRAWL SPACE PLAN
SCALE: 1/4" = 1'-0"

Order Plans @ www.LDILine.com