

SEALS
© COPYRIGHT BY ROSENBLUM COE ARCHITECTS, INC.
THIS DRAWING HAS BEEN PREPARED BY ROSENBLUM COE ARCHITECTS, INC. FOR THE PROJECT AND IS THE PROPERTY OF ROSENBLUM COE ARCHITECTS, INC. NO PART OF THIS DOCUMENT MAY BE REPRODUCED OR TRANSMITTED IN ANY FORM OR BY ANY MEANS, ELECTRONIC OR MECHANICAL, INCLUDING PHOTOCOPYING, RECORDING, OR BY ANY INFORMATION STORAGE AND RETRIEVAL SYSTEM, WITHOUT THE WRITTEN PERMISSION OF ROSENBLUM COE ARCHITECTS, INC.

NOTES
1. REMOVE ALL MOUNTING SINK PRIOR TO RISER DEMOLITION.
RENDER ALL RISERS AND DOMESTIC HOT AND COLD WATER MAINS LOCATED IN CORRIDOR.
2. CONTRACTOR SHALL DEMOLISH SANITARY RISER FOR LOCATION. SEE RENOVATION PLANS FOR MORE INFORMATION.

GENERAL NOTES
1. REFER TO PD01 FOR GENERAL NOTES.
2. ALL PIPING SHOWN IS LOCATED BELOW FIRST FLOOR SLAB WITHIN CRAWL SPACE. FIRST FLOOR WALLS ARE SHOWN FOR REFERENCE ONLY.

 **MUSC**
MEDICAL UNIVERSITY
of SOUTH CAROLINA
PROJECT NUMBER: H51-50068
DHEC PROJECT NUMBER: 580145

CONSTRUCTION DOCUMENTS

**STORM EYE INSTITUTE
OPTICAL SHOP
H51-50068**
167 ASHLEY AVE
CHARLESTON, SC 29425

 **ROSENBLUM COE
ARCHITECTS,
INC.**
1643 MEANS STREET
CHARLESTON, SC 29412
843.577.6073

**PLUMBING FIRST FLOOR
DEMOLITION PLAN**

SHEET NAME	
PROJECT NUMBER	17016
DRAWN BY	TSN
CHECKED BY	CRB
DATE	05/09/2018
SCALE	1/4" = 1'-0"

PD101

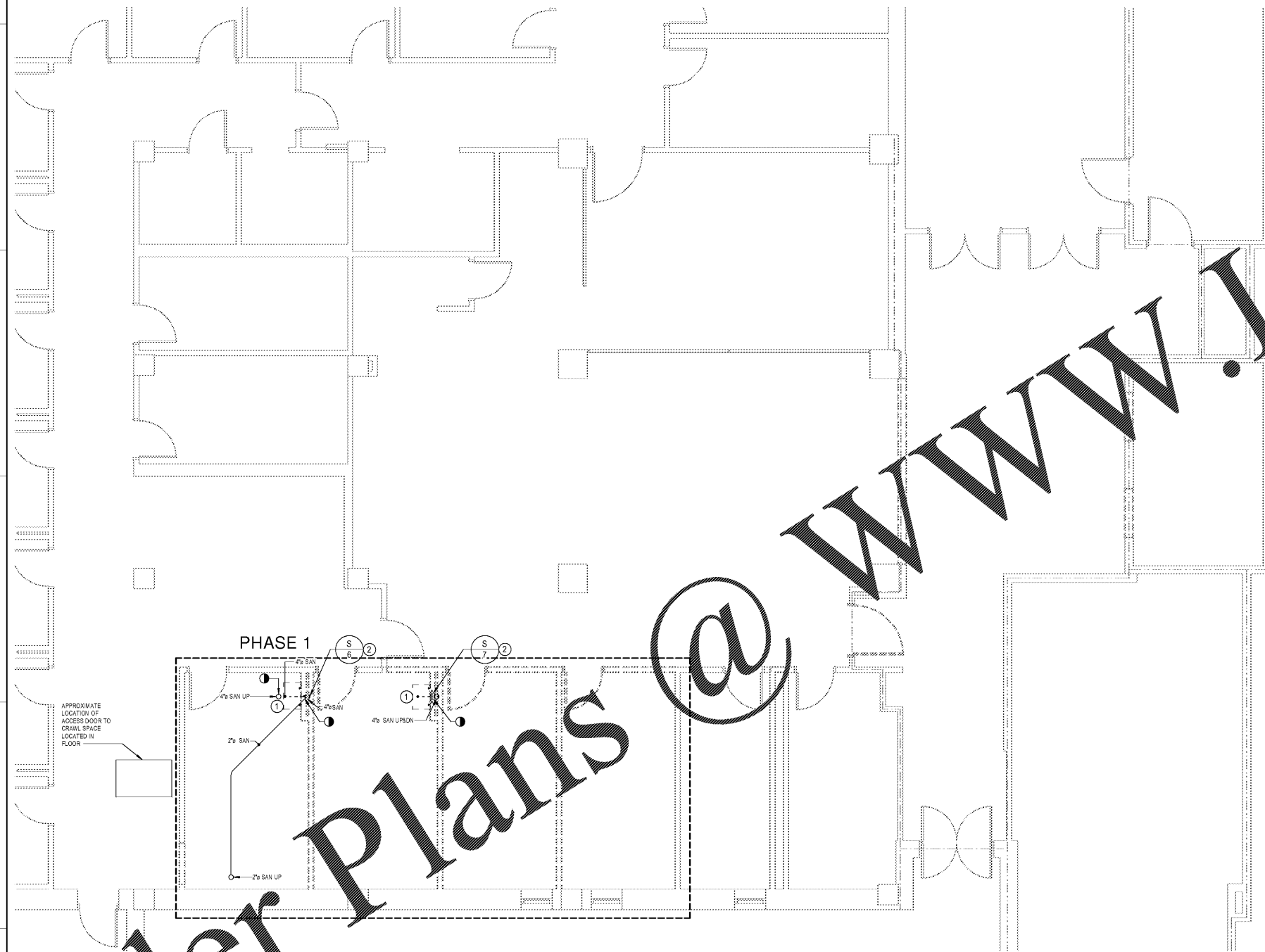

Order Plans @ www.LDILine.com