

5 EXPO WALL PASSTHROUGH SECTION AT SHELVING
7/16"

4 EXPO PASSTHROUGH EDGE DETAIL
12/16"

3 NEOCERAM GLASS AT WF GRILL - BASE
7/16"

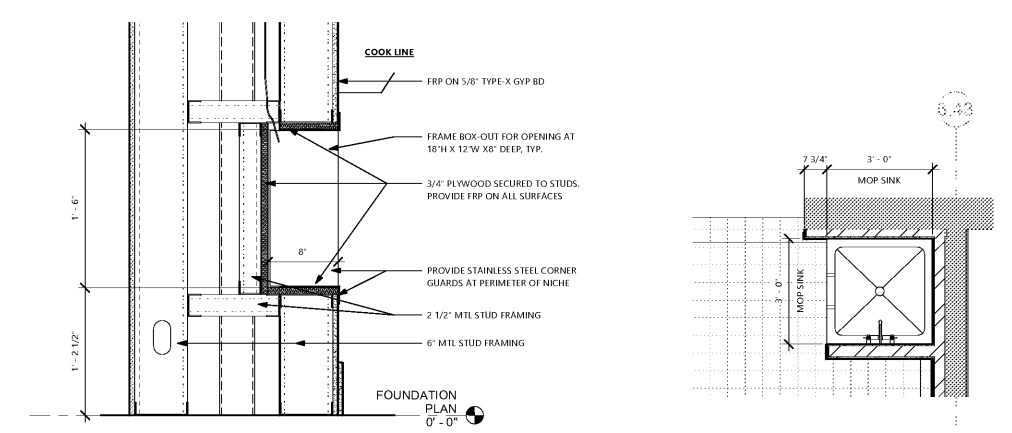

2 COOKLINE NICHE 2
11/16"

1 ENLARGED PLAN - CANWASH
12/16"

CONSTRUCTION
DOCUMENTS
05/10/2018

No.	Description	Date

Steven A. Starr, AIA
Lic. # RA013717
Signature Date: 05/10/2018
Date of expiration: 6/30/2019



INTERIOR
COMPONENTS -
CANWASH &
DETAILS

A7.09

Order Plans @

WWW.LDILine.com