

Zone and Wattage Chart							
ZONE	#spkrs	type	location	tap	load		vol cntrl
					bar-ch 1	house-ch 2	
1	5	6" pendant	bar/lounge	15	90		Z-1 at bar
	1	sub woofer		60	60		
2	1	6" pendant	hostess	15	15		AT100
3	4	6" surface mount	main dining	15	90		AT100
	2	4" surface mount		15	30		
4	2	4" surface mount	MDR side dining	15	30		AT100
5	1	all weather in-ceiling	Front Entry	20	20		AT100
6	1	5" in-ceiling	vestibule	15	15		AT100
7	2	4" surface mount	patio	15	30		AT100
8	2	in-ceiling 8"	restrooms	4	8		AT100
Notes: Tap speakers as designed.				Total wattage	165	193	#spkrs
				+20%	198	231	
				Amplifier	2x300		22

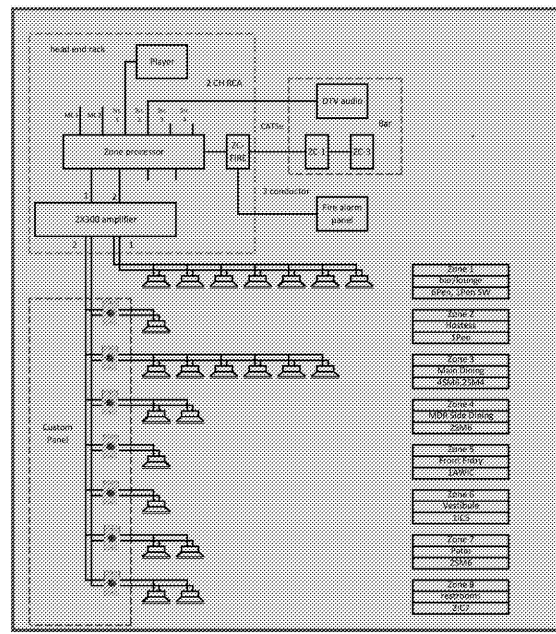

indicates GC Call outs

indicates AV Tech notes

- pendant speakers
- pendant sub-woofer
- in-ceiling 6" econo speaker
- ceiling speaker
- ceiling all weather speaker
- 6" surface mounted speaker
- 4" surface mounted speaker
- volume control panel
- equipment rack

- GC Call Outs**
1. Provide 1 double gang electrical box with conduit stub out into the ceiling for the CAT5e control cable.
 2. Provide 1 (one) single gang electrical box with conduit stub out into the interior ceiling. Set at 11"0" and at 2"0" from wall edge as indicated, for speaker wire to patio speaker.
 3. Provide 1 (one) single gang electrical box with conduit stub out into the interior ceiling. Set at 11"0" and at 6"0" from wall edge as indicated, for speaker wire to patio speaker.
 4. Provide wall penetration and conduit sleeve for speaker located in the awning over the front entry door.
 5. Provide 2 (two) outlets for the in-ceiling speakers.
 - vestibule - 8.3" diameter canopy - 8.3" diameter
 6. Install AV vendor provided 11" x 8.5" electrical junction box and provide 3 (three) 3/4" conduit stub outs into the ceiling for the volume control speaker wires. Box **MUST** be mounted horizontally.

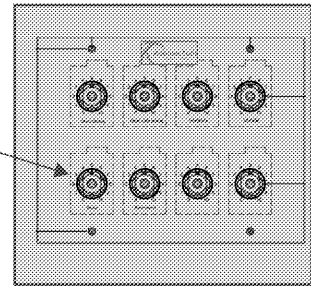
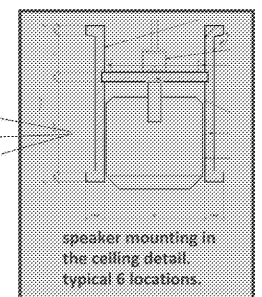
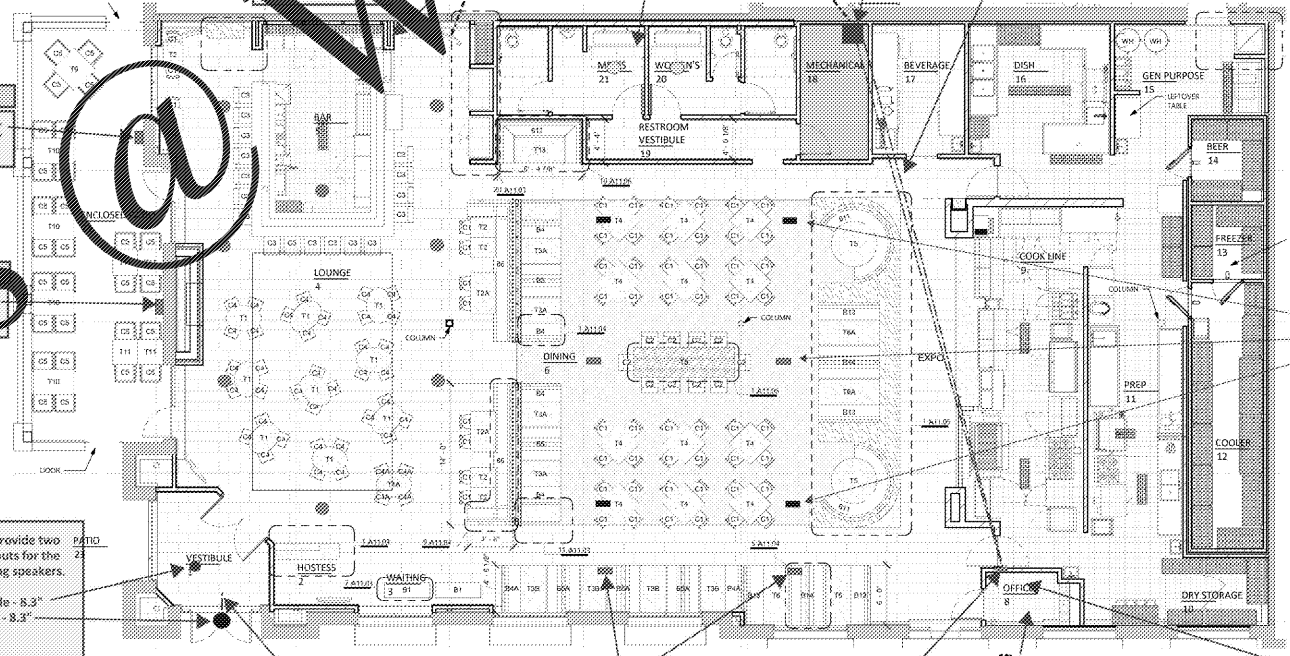
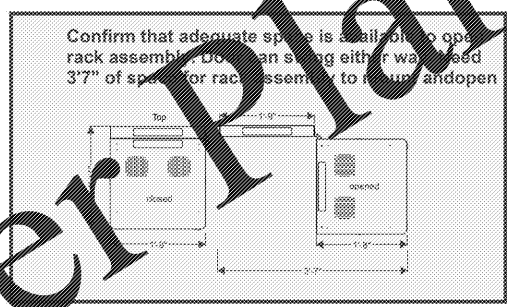

GC to provide two (2) outlets for the in-ceiling speakers.
vestibule - 8.3" canopy - 8.3"

GC to provide wall penetration and conduit sleeve for the outdoor speaker.

These speakers must be installed, zero wood and soffit, before the decorative ceiling detail is put in place. Mount speakers to inside wall of the soffit at 13" and angled down at a 45 degree angle.

GC to install AV vendor provided 8.5" x 11" electrical junction box and provide 3 (3/4") conduit stub out into the ceiling for the speaker wire and custom control panel. The box will be mounted horizontally (11" W x 8.5" H).

Order Plans @

Ambiance Systems LLC
A Subsidiary of Ambiance Radio™

CONSTRUCTION DOCUMENTS
05/10/2018

No.	Description	Date

Steven A. Starr, AIA
Lic. # RA013717
Signature Date: 05/10/2018
Date of expiration: 6/30/2019



AV DETAILS
A2.06
sheet number | title