

TAG	SYMBOL	DESCRIPTION
C	○	3" RECESSED CAN
C1	○	3" RECESSED CAN - ADJUSTABLE
C2	○	6" RECESSED CAN
DL	⊗	DIMOND LIGHT FIXTURES MOUNTED TO UNDERSIDE OF STRUCTURE - REF. ELEVATIONS FOR MTD HEIGHT & CORNER LIGHT
Ef	⊗	LED FLOOR FIXTURE
Es	⊗	LED SPOT FIXTURE
Ms	⊗	MONOPOINT SPOT - VERIFY STEM LENGTH - PATO
H	⊗	LENSED 2x4 FLUORESCENT
H1	⊗	LENSED 2x4 FLUORESCENT
I	—	FLUORESCENT STRIP
L	—	MULTI LAMP ADJUSTABLE RECESSED LINEAR FIXTURE IN RECESSED ELEMENT
LS1	—	LED TAPE LIGHT AT BAR FACE & TOWER KICK
LS2	—	LED LINEAR LIGHT ABOVE CURB
P	○	PANEL FIXTURE CENTERED OVER RESTROOM SINK DRAINS

TAG	SYMBOL	DESCRIPTION
T	—	LINEAR TAPE IN ACRYLIC LIQUOR TIER
V	○	FIXTURES AT BAR SOFFIT
WG	○	CYLINDER WALL WASH AT FIREPLACE - REF. ELEVATIONS FOR MOUNTING HEIGHT
WP	○	EXTERIOR WALL WASH IN SERVICE YARD - MOUNT CENTER OF FIXTURE AT 7'-0" AFF
WS	○	RESTROOM WALL SCONES - REF. ELEVATIONS FOR MOUNTING HEIGHT
T1	—	TRACK MOUNTED OVER WOOD FINISH DINING - REF. INT. ELEVATIONS FOR TRACK HEIGHTS
T2	—	TRACK MOUNTED IN "Y" BEAM IN MAIN DINING - REF. INT. ELEVATIONS FOR TRACK HEIGHTS
T3	—	TRACK SUSPENDED FROM CEILING - REF. INT. ELEVATIONS FOR TRACK HEIGHTS
FAN	—	FAN/BLIND - MOUNT SPYWARE WITH 1" DOWNWARD AND BLOWER CEILING INT. DARK BRONZE FINISH
EM-1	—	EMERGENCY FIXTURE - CEILING MOUNTED
EX	—	EMERGENCY FIXTURE - CEILING MOUNTED
EX-R	—	EMERGENCY FIXTURE - CEILING MOUNTED

SYMBOL	DESCRIPTION
⊕	CEILING HEIGHT & MATERIAL (SEE FINISH SCHEDULE)
⊗	SUPPLY DIFFUSER SEE MECHANICAL FOR MORE DETAIL
⊘	RETURN GRILLE SEE MECHANICAL FOR MORE DETAIL

SPRINKLER GENERAL NOTES

SPRINKLERS ARE TO BE DESIGN-BUILD. CONTRACTOR TO REVIEW EXISTING SPRINKLER SYSTEM TO WORK WITH NEW DESIGN.

- PRIOR TO COMMENCING SPRINKLER WORK, THE CONTRACTOR SHALL PROVIDE SPRINKLER SHOP DRAWINGS, SIGNED AND SEALED BY A FIRE PROTECTION ENGINEER LICENSED IN APPLICABLE JURISDICTION.
- THE FIRE PROTECTION CONTRACTOR TO PROVIDE MATERIAL AND INSTALLATION TO MODIFY EXISTING FIRE SUPPRESSION SYSTEM AS WELL AS NEW SPRINKLER SYSTEM DESIGN TO COMPLY WITH MUNICIPAL CODES AND ORDINANCES IN ACCORDANCE WITH NFPA 13. THE SYSTEM SHALL ALSO MEET ALL APPLICABLE BUILDING CODES, ORDINANCES, AND THE REQUIREMENTS OF THE AUTHORITY HAVING JURISDICTION AND INSURANCE CARRIER. VERIFY REQUIREMENTS PRIOR TO BID SUBMITTAL. PROVIDE REQUIRED DOCUMENTATION INCLUDING CALCULATIONS AND ENGINEER CERTIFIED DOCUMENTATION.
- FOR INFORMATION, CONTRACT DOCUMENTS IS GENERAL INFORMATION AND FOR BID PURPOSES ONLY. CONTRACTOR TO PERFORM REQUIRED CALCULATIONS, AND COORDINATE WITH OTHER TRADES. PROVIDE ALL PERSONAL MATERIALS AND LABOR AS REQUIRED FOR COORDINATION AND TO MEET AUTHORITY HAVING JURISDICTION AND INSURANCE CARRIER REQUIREMENTS AT NO ADDITIONAL COST TO THE OWNER.
- MODIFY EXISTING SPRINKLER SYSTEM. RELOCATE AND/OR PROVIDE ADDITIONAL SPRINKLERS, PIPING, HANGERS, ETC. COORDINATE WITH WALLS, CEILING, LIGHTS, DIFFUSERS, STRUCTURE, OBSTRUCTIONS, ETC. IN AREAS AFFECTED BY SCOPE OF WORK.
- COORDINATE SPRINKLER SYSTEM MODIFICATIONS TO MINIMIZE SYSTEM IMPAIRMENT. PROVIDE FIRE WATCH AND INTERIM FIRE PROTECTION MEASURES WHERE REQUIRED BY THE AUTHORITY HAVING JURISDICTION, INSURANCE CARRIER OR OWNER.
- COORDINATE PIPE ROUTING NEAR ELECTRICAL EQUIPMENT WITH NFPA 70.
- COORDINATE SPRINKLER TEMPERATURES NEAR HEAT-PRODUCING SOURCES WITH NFPA 13.
- DO NOT CONNECT MORE THAN ONE SPRINKLER TO AN EXISTING ONE INCH OUTLET.
- REMOVE ALL ABANDONED PIPING, FITTINGS, HANGERS, ETC.
- FORWARD COMPLETED CONTRACTOR MATERIAL TEST CERTIFICATES TO THE OWNER.
- FIRE SUPPRESSION LINES SHALL BE MOUNTED TO PROVIDE CLEARANCE FOR CEILING MOUNTED LIGHT FIXTURES AND EQUIPMENT.
- FIRE EXTINGUISHERS SHALL BE LOCATED PER THE REQUIREMENTS OF NFPA 10. THE SIZE SHALL BE A MINIMUM OF 2-A, 10-BC, IS/ARE REQUIRED AND SHALL BE INSTALLED AT A MAXIMUM OF 48" ABOVE THE FINISHED FLOOR TO THE TOP OF THE HANDLE.
- FIRE ALARM SUBMISSION, IF APPLICABLE, MUST BE COORDINATED BY CONTRACTOR. CONTRACTOR MUST ALSO COORDINATE SPRINKLER DESIGN WITH PLUMBING, ELECTRICAL, AND MECHANICAL DESIGN DRAWINGS. CONTRACTOR TO CHECK WITH LANDLORD TO SEE IF SPECIFIC VENDOR IS REQUIRED.

CONTRACTOR MUST GIVE LANDLORD (5) FIVE (OR OTHERS SPECIFIED BY LANDLORD) WORKING DAYS NOTICE PRIOR TO PERFORMING WORK ON THE SPRINKLER SYSTEM.

REFLECTED CEILING PLAN NOTES

- ALL CONTRACTORS ARE TO REVIEW ALL DRAWINGS. NOTIFY ARCHITECT IMMEDIATELY OF ANY OBSTRUCTION OR CONFLICT IN NEW WORK.
- ALL CEILING HEIGHTS INDICATED ARE TO BE FROM FINISHED FLOOR UNLESS NOTED OTHERWISE. MINIMUM CEILING HEIGHT ALONG ACCESSIBLE ROUTE SHALL BE 80" AFF (PER ADA GUIDELINES).
- ALL DIMENSIONS ARE TAKEN FROM END OF TRACK, CENTERLINE OF FIXTURE, OR FINISH FACE OF SURFACE UNLESS NOTED OTHERWISE.
- LOCATE ALL TRACK AND RECESSED FIXTURES @ CENTERLINE OF TILE OR OPENING UNLESS NOTED OTHERWISE.
- EMERGENCY LIGHTING SHALL BE INSTALLED BASED ON THE OCCUPANCY AS DETERMINED BY CHAPTERS 11 THRU 43 OF THE NFPA 101 LIFE SAFETY CODE, 2012 EDITION. ANY REQUIRED EMERGENCY LIGHTING SHALL BE INSTALLED PER SECTION 7.9 OF THE LIFE SAFETY CODE. ADDITIONAL LIGHTING MAY BE REQUIRED BY THE FIRE INSPECTOR.
- SPRINKLER HEADS SHALL BE CENTERED IN CEILING TILE WITH TYPE, STYLE, AND ESCUTCHEON COVER FINISH TO MATCH ADJACENT CEILING COLOR (UNLESS) - IN THE CASE OF A PLENUM OBSTRUCTION, CONTRACTOR TO CONTACT/COORDINATE A SOLUTION WITH THE ARCHITECT PRIOR TO INSTALLATION.
- CONTRACTOR SHALL REMOVE DEBRIS OR MATERIAL FROM ABOVE CEILING PRIOR TO FINAL CLEANING. GENERAL CONTRACTOR IS RESPONSIBLE FOR DAMAGES CAUSED BY DEBRIS OR UNSECURED MATERIAL ABOVE FINISHED CEILING.
- SEE NOTED REFLECTED CEILING PLAN AND FINISH SCHEDULES FOR CEILING FINISHES.
- ANY EXISTING HVAC RETURN AIR OPENINGS SHALL BE PROTECTED WITH TEMPORARY FILTERS. PROVIDE REQUIRED ACCESS PANELS FOR MECHANICAL, ELECTRICAL, AND PLUMBING SYSTEMS. LOCATION AND TYPE OF ACCESS PANEL SHALL BE VERIFIED WITH ARCHITECT PRIOR TO CONSTRUCTION.
- PENETRATIONS AND OPENINGS IN CEILING FOR FIXTURES OR MECHANICAL SYSTEM PATHS AND REGISTERS SHALL BE PRECISELY CUT FOR INSTALLED ITEMS WITH EDGES CONCEALED BY MOUNTING TRIM OR COVER. INSTALLATION OF TRIM AND COVERS SHALL BE FLUSH TO SURFACE.
- G.C. TO PROVIDE REQUIRED ACCESS PANELS IN CEILING FOR MECHANICAL, ELECTRICAL, AND PLUMBING SYSTEMS. LOCATION AND TYPE OF ACCESS PANEL SHALL BE VERIFIED WITH ARCHITECT PRIOR TO CONSTRUCTION.
- PENETRATION OF PARTITIONS FOR MECHANICAL SYSTEMS SHALL BE HERMETICALLY SEALED. PENETRATIONS WITHIN RATED PARTITION ASSEMBLIES SHALL PROVIDE FOR REQUIRED DAMPERS, DEVICES, SLEEVES, AND FIREPROOFING TO MAINTAIN APPROVED RATING.
- OWNER'S VENDOR TO SUBMIT FINAL HVAC TEST AND BALANCE REPORT WITH ALL OTHER REQUIRED CLOSEOUT DOCUMENTS AT OR BEFORE FINAL WALK THROUGH.
- REFERENCE ELECTRICAL PLANS FOR LIGHT FIXTURES AND SWITCHING.
- COORDINATE WITH MECHANICAL PLAN FOR LOCATION OF DIFFUSERS.
- ANY WIRES & CABLES THAT ARE CONNECTED TO THE TOP OR BOTTOM CHORD OF THE JOIST MUST BE AT THE PANEL JOINTS AND NOT TIED TO A TOP OR BOTTOM CHORD.

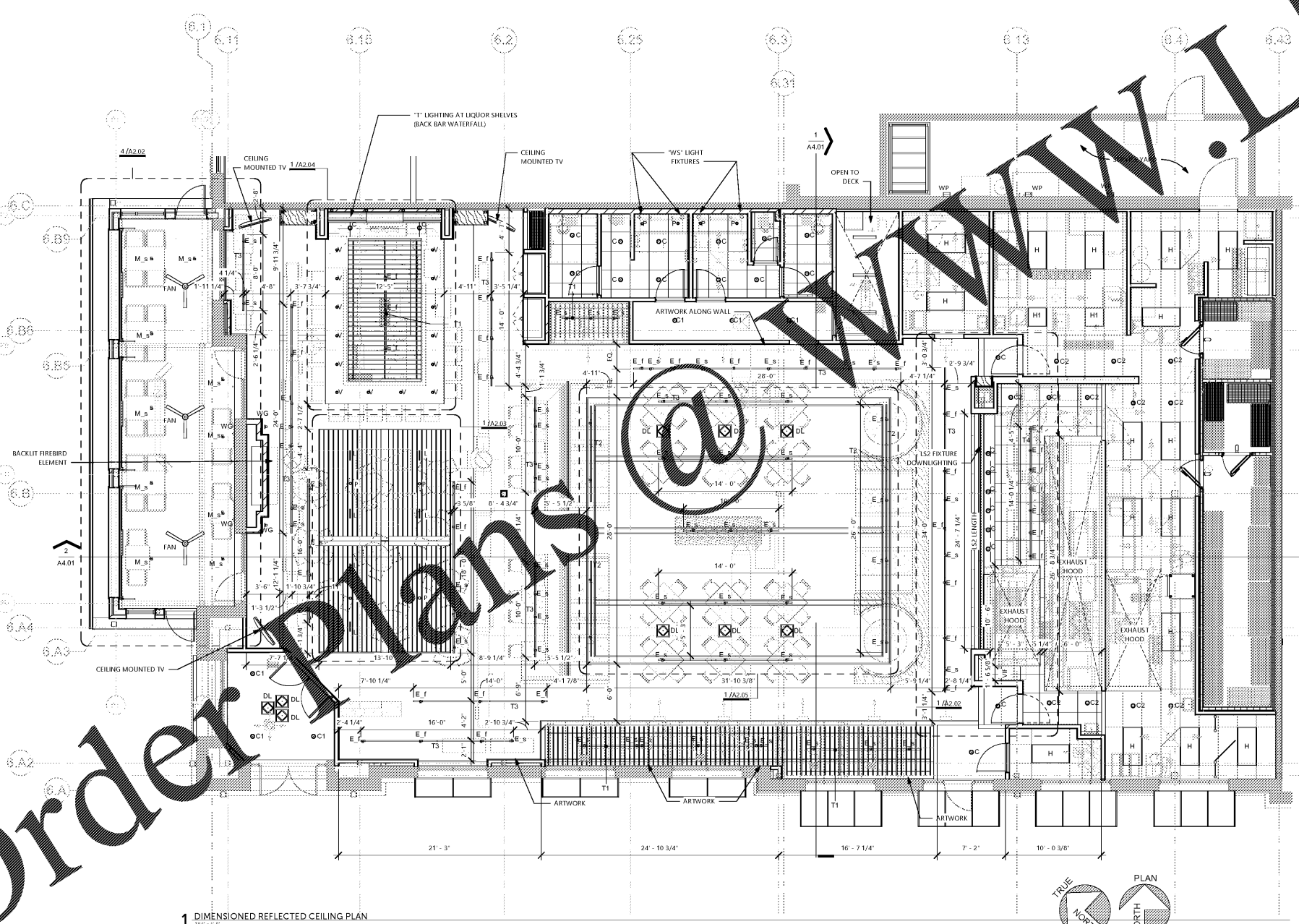

1 DIMENSIONED REFLECTED CEILING PLAN

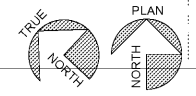

Order Plans

DIMENSIONED
CEILING PLAN
A2.01a