

RESTAURANT GENERAL NOTES

1. ALL KITCHEN WALLS- PROVIDE CEMENTITIOUS BACKER BOARD FROM FLOOR TO 1'-0" AFF AND PLYWOOD FROM 1'-0" TO 10'-0" AFF. M.R. GWB (GREENBOARD) ABOVE 10'-0".
2. PROVIDE CEMENTITIOUS TILE BACKERBOARD BEHIND ALL WALL TILE INCLUDING BASE.
3. PROVIDE FIRE RETARDANT TREATED WOOD PANELS IN KITCHEN WALLS FROM TOP OF TILE BASE TO CEILING.
4. LIGHTING AT ALL FOOD PREP AREAS AND KITCHEN HAS BEEN DESIGNED TO PROVIDE 30 FOOT CANDLES. LIGHTING IN ALL OTHER AREAS HAS BEEN DESIGNED TO PROVIDE AT LEAST 10 FOOT CANDLES. ALL EXPOSED LAMPS IN FOOD PREP AREAS ARE TO BE ENCAPSULATED LAMPS.
5. G.C. TO COORDINATE WITH ALL ELECTRICAL SERVICE EQUIPMENT AND TEMPORARY WIRING.
6. REFER TO KITCHEN DRAWINGS FOR ALL FOOD SERVICE EQUIPMENT.
7. CLASS A ABC TYPE CHEMICAL SURFACE MOUNTED FIRE EXTINGUISHER TO BE LOCATED IN THE KITCHEN AT THE EXACT LOCATION WITH FIRE MARSHAL.
8. WALL ASSEMBLY AT HOODS AND WITHIN 24" OF HOODS TO BE NON-COMBUSTIBLE METAL STUDS WITH CEMENTITIOUS TILE BACKERBOARD.

GENERAL NOTES

1. ONCE INITIAL BUILDING PERMIT IS OBTAINED, ALL REVISIONS WILL BE ISSUED TO THE CONTRACTOR SIGNED AND SEALED. IT IS THE CONTRACTOR'S RESPONSIBILITY TO RESUBMIT REVISIONS TO PREVIOUSLY APPROVED PLANS TO ALL APPLICABLE JURISDICTIONS IF THEY DEEM NECESSARY.
2. PRIOR TO CONSTRUCTION START ALL TRADES ARE TO REVIEW ALL DRAWINGS.
3. CONTRACTOR TO LAYOUT ALL WALLS, STRUCTURE, CEILING, MILLWORK EQUIPMENT, FIXTURES & FURNITURE PRIOR TO UNDER SLAB WORK AND/OR FRAMING. VERIFY ALL DIMENSIONS IN FIELD. NOTIFY ARCHITECT IMMEDIATELY OF ANY DISCREPANCIES AND/OR CONFLICTS.
4. ALL DIMENSIONS TO EXISTING BUILDING ELEMENTS ARE TO BE VERIFIED IN FIELD. GC TO NOTIFY ARCHITECT OF ANY DISCREPANCIES BETWEEN DRAWINGS AND EXISTING FIELD CONDITIONS PRIOR TO START OF CONSTRUCTION.
5. ALL PENETRATIONS THROUGH AND WITHIN RATED FIRE ASSEMBLIES SHALL BE SEALED AND PROTECTED WITH THE APPLICABLE UL RATED PENETRATION ASSEMBLIES IN ACCORDANCE WITH APPLICABLE CODES AS INTERPRETED AND APPROVED BY THE LOCAL GOVERNING AUTHORITIES.
6. AT EACH CORE-DRILL LOCATION AT ELECTRICAL FLOOR BOXES, PLUMBING, ETC. POUR BACK MUST BE DOWELED INTO EXISTING SLAB - VAPOR BARRIER MUST BE REPAIRED & OVERLAP EXISTING BY A MINIMUM OF 6" & PROPERLY TAPED BEFORE POUR BACK. GC MUST COORDINATE ALL CORE-DRILL AREAS WITH LANDLORD PRIOR TO WORK COMMENCEMENT.
7. PATCH AND REPAIR ALL PENETRATIONS IN EXISTING FLOOR WITH LIKE MATERIALS WHERE EXISTING FLOORING SHOWN TO REMAIN. EXISTING SLAB TO BE SMOOTH W/ ALL DERRIS AND RESIDUE REMOVED IN ORDER TO RECEIVE NEW FINISHES.
8. PATCH AND REPAIR ALL PENETRATIONS IN EXISTING AND NEW WALLS WITH LIKE MATERIALS. PROVIDE A SMOOTH SURFACE TO ACCEPT SPECIFIED MATERIAL.
9. ALL WOOD BLOCKING TO BE FIRE RETARDANT TREATED WOOD. PROVIDE CONCEALED WOOD BLOCKING AS NECESSARY FOR ALL WALL-MOUNTED ELEMENTS, INCLUDING BEHIND GWB FOR GRAB BARS AND MIRRORS IN RESTROOMS.
10. PROVIDE M.R. GWB FOR ALL NON-TILED WALLS OR PORTIONS THERE OF TO CEILING IN RESTROOMS.
11. G.C. TO COORDINATE DELIVERY OF ALL OWNER SUPPLIED ITEMS.
12. ALL ANGLES IN STORE PLAN TO BE ON A 45° OR 90° ANGLE OFF PERIMETER WALLS, UNLESS NOTED OTHERWISE.
13. LANDLORD MAY REQUIRE SPECIFIC VENDORS / CONTRACTORS TO BE USED FOR, BUT NOT LIMITED TO, ALL FIRE ALARMS, FIRE SPRINKLER AND ROOFING WORK. COORDINATE WITH LANDLORD PRIOR TO START OF CONSTRUCTION.
14. ALL INTERIOR WALL DIMENSIONS ON THIS SHEET ARE TAKEN FROM FACE OF STUD UNLESS NOTED OTHERWISE.
15. ACOUSTICAL INSULATION TO BE PROVIDED IN CAVITY OF DEMISING WALLS.
16. THE FIRE EXTINGUISHING SYSTEM SHALL BE ACCEPTANCE-TESTED IN ACCORDANCE WITH THE FIRE PREVENTION CODE AND WITH THE MANUFACTURERS INSTRUCTION. TEST TO BE IN PRESENCE OF FIRE DEPARTMENT.
17. PROVIDE INSULATION AND GYPSUM WALL BOARD OVER EXISTING SHELL BUILDING METAL STUDS. PROVIDE TYPE "X" GYPSUM ON TENANT DEMISING WALLS AND AS REQUIRED BY CODE.

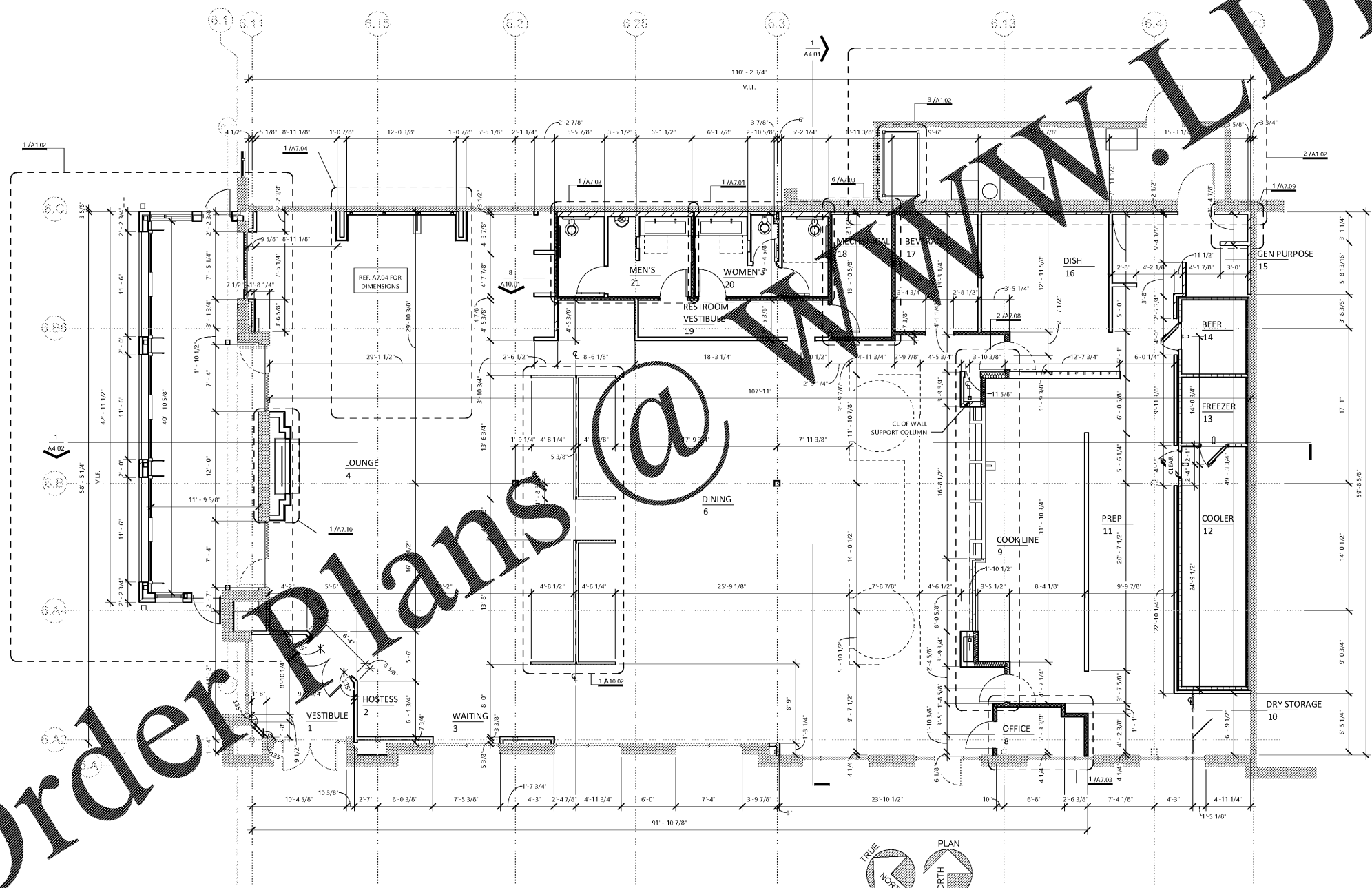

1 DIMENSIONED FLOOR PLAN
REV: 1.0

CONSTRUCTION DOCUMENTS
05/10/2018

No.	Description	Date

Steven A. Starr, AIA
Lic. # RA013717
Signature Date: 05/10/2018
Date of expiration: 6/30/2019



DIMENSIONED FLOOR PLAN
A1.01a
sheet number | title