

ITEM	SIDE DOCK OPERATIONS DATA	CHARLOTTE PLAN
LINEAR FOOTAGE OF BASE (PRODUCE INCLUDED)	850'-4"	906'-2"
ASSUMED PALLET STORAGE	66	73
BUILDING DIMENSIONS	119'-4" x 178'-0"	119'-4" x 178'-0"
SALES FLOOR DIMENSIONS	74'-6" x 175'-9"	74'-6" x 175'-9"
LENGTH OF MULTIDECK	108'	116'
COOLER MILK DOORS	4	4
COOLER GENERAL DOORS	12	16
FREEZER GENERAL DOORS	16	16
SPOT MERCHANDISERS	8	13
CART STORAGE	(119) MODEL 563W	(119) MODEL 563W

SIDE DOCK AREA SUMMARY		
OCCUPANCY USE	ROOM NAME	SQUARE FOOTAGE
MERCANTILE (M)	SALES / VESTIBULE	14,738
	MEN'S ROOM	107
	WOMEN'S ROOM	151
SUBTOTAL (MERCANTILE)		15,103
BUSINESS (B)	OFFICE	289
	BREAK ROOM	419
SUBTOTAL (BUSINESS)		708
STORAGE / STOCK (S-1)	BACKROOM	3,380
	COOLER	1,317
	FREEZER	648
SUBTOTAL (STORAGE / STOCK)		5,345
SUBTOTAL (OCCUPANCIES)		21,156
EXTERIOR / INTERIOR WALLS / UNOCCUPIED SPACE		1,089
BUILDING SQUARE FOOTAGE		22,245
EXTERIOR CANOPY		2,278
TOTAL SQUARE FOOTAGE (INCLUDING CANOPY)		24,523

Issued:	Date:
A Permit Set	12/05/17
B Client Review Set	05/03/18
C Bid Set	05/11/18
D	
Revisions:	Date:
1	
2	
3	
4	
5	
6	
7	
8	
9	

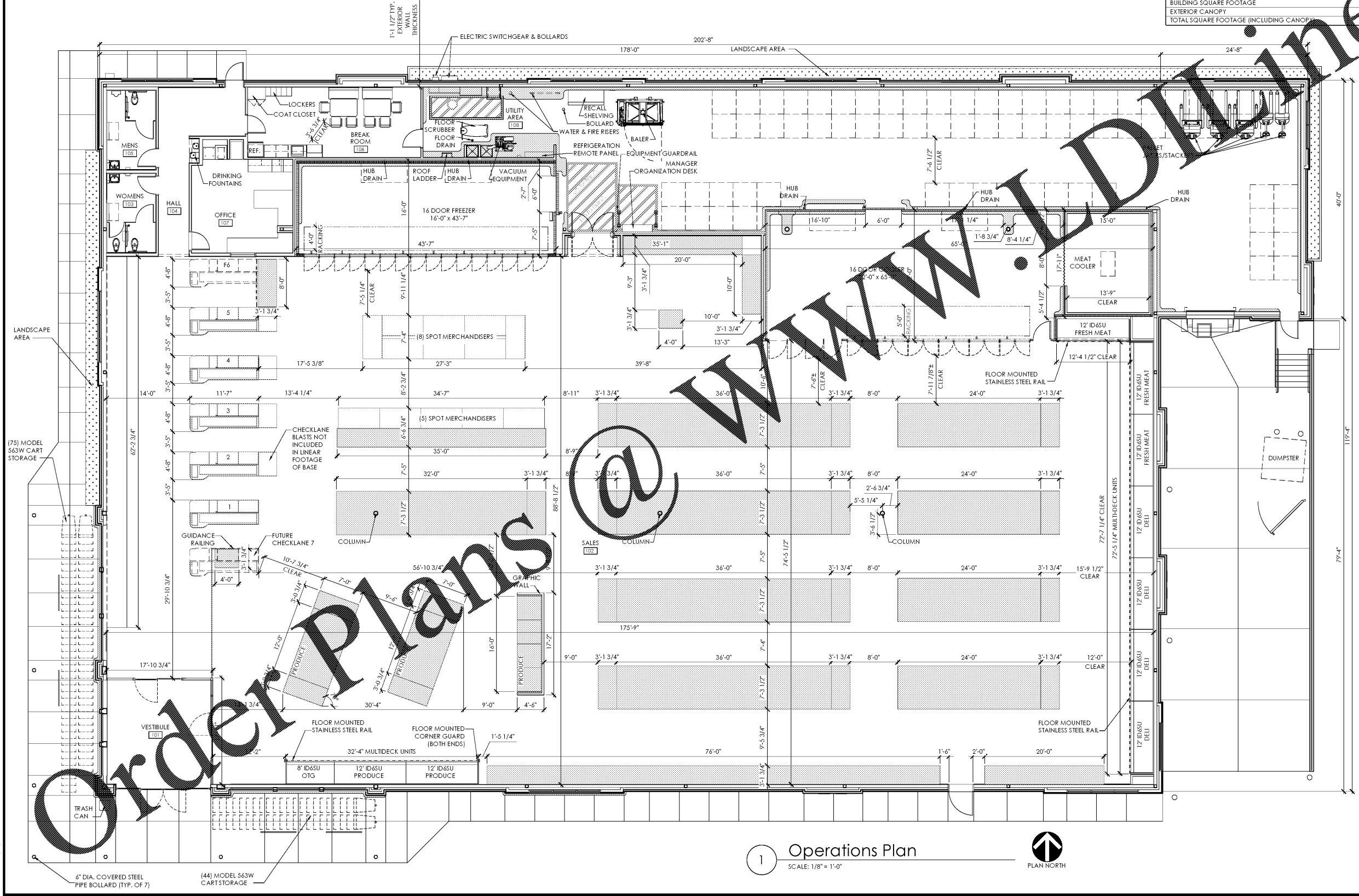

DO NOT SCALE PLANS
 Copying, Printing, Software and other processes required to produce these prints can stretch or shrink the actual paper or layout. Therefore, scaling of this drawing may be inaccurate. Contact the consultants with any need for additional dimensions or clarifications.

ms consultants, inc.
 engineers, architects, planners
 920 Main Campus Drive
 Suite 430
 Raleigh, NC 27606-5213
 phone 919.772.5565
 fax 919.779.2308

DRAWN BY: MEM/KNW
 REVIEWED BY: JAB

Seal

ALDI Inc.
 1985 Old Union Church Road
 Salisbury, NC 28146
 (704) 642-8822
 (704) 642-6078 fax

ALDI Inc. Store #: 65
 Charlotte, NC
 6113 Idlewild Road
 Charlotte, NC 28212
 Mecklenburg County
 Project Name & Location:

Operations Plan
 Drawing Name:
 Prototype Rls. 09/07/17 Project No. 40452-13
 Type: LHSD-V8
 Scale: As Noted Drawing No. A-131

- NOTES:**
- THIS DRAWING IS FOR GENERAL FITTING LAYOUT AND REFERENCE TO EQUIPMENT ONLY. ALL INFORMATION IS FOR ALDI OPERATIONAL USE ONLY AND SHALL NOT BE USED FOR CONSTRUCTION OR BIDDING PURPOSES.
 - ALL DIMENSIONS TO WALLS ARE TO FACE OF STUD.
 - ALL SHELVING DIMENSIONS ARE TO FACE OF GONDOLA. THIS FACILITY DOES NOT CONTAIN A BAKERY, A BUTCHER, A DELI OR FISH COUNTER.
 - ALL FOOD IS PREPACKAGED. THERE IS NO ON SITE FOOD PREPARATION.
 - GONDOLA LOCATIONS ARE MEASURED FROM THE FACE OF THE STAINLESS STEEL PRICE TAG MOLDING (SSPTM).

1 Operations Plan
 SCALE: 1/8" = 1'-0"
 PLAN NORTH