

Order Plans @ WWW.LDLINE.COM

**GENERAL NOTES:**

1. SEE SHEET P-2.0 FOR ALL GENERAL NOTES.
2. PIPING SHALL BE INSTALLED BETWEEN TRUSSES OR THROUGH TRUSSES IN CEILING SHIPPING ROOM AS SHOWN WITH ALL ITEMS LOCATED ABOVE THE BOTTOM OF STRUCTURE UNLESS OTHERWISE NOTED ON PLAN.
3. P.C. SHALL TEST ALL EQUIPMENT AND PIPING CONNECTIONS FOR LEAKS AS PART OF FINAL COMPLETION OF CONSTRUCTION PROCESS.

**KEYED NOTES:**

1. CONNECT TO EXISTING WATER LINE. CONTRACTOR TO VERIFY SIZE AND LOCATION. PROVIDE BACKFLOW PREVENTOR PER REQUIREMENTS OF LOCAL JURISDICTION.
2. PROVIDE THERMOSTATIC MIXING VALVE AT ALL HAND SINKS AND LAVATORIES NOT ALREADY PROVIDED WITH THEM. SET AT 110°F MAXIMUM.
3. ROUTE FILTERED WATER LINE IN WALL. TRANSITION TO TYPE COPPER PIPE. ROUTE UNDERGROUND THROUGH 2" PVC PIPE TO UNDER COUNTER. TRANSITION BACK TO STAINLESS COPPER PIPING AND ROUTE TO EQUIPMENT AS NECESSARY. PVC PIPE SHALL STUB UP ABOVE FINISHED FLOOR. SEE DETAIL 6P-4.0.
4. WATER FILTRATION SYSTEM. MOUNT TOP OF SYSTEM ON CEILING. VERIFY ACTUAL LOCATION.
5. PROVIDE A PRESSURE REDUCING VALVE, PRESSURE GAUGE, AND SHUT-OFF VALVE AT PLUMBING CONNECTIONS TO OVEN.
6. PROVIDE A PRESSURE REDUCING VALVE FOR ESPRESSO MACHINE.
7. PROVIDE DETAIL 11/P-4.1 FOR WATER HEATER CONNECTION DIAGRAM AT ISLAND OASIS STATIONS.
8. REFER TO DETAIL 1/P-4.1 BEVERAGE WATER PIPING SCHEMATIC.
9. REFER TO DETAIL 2/P-4.1 FOR BLODGETT OVEN PIPING SCHEMATIC.
10. REFER TO DETAIL 11/P-4.1 FOR WATER HEATER DETAIL.
11. REFER TO SHEET P-4.3 FOR 3M WATER FILTRATION SYSTEM SCHEMATIC.
12. LOCATE HOT WATER RECIRCULATION PUMP ABOVE CEILING.
13. MAIN DOMESTIC WATER SERVICE ENTRY LOCATION. INSTALL BACKFLOW PREVENTOR IN VERTICAL POSITION. MOUNT TEST PORTS FACING OUT FOR ACCESSIBILITY. REFER TO DETAIL 6P-4.2.

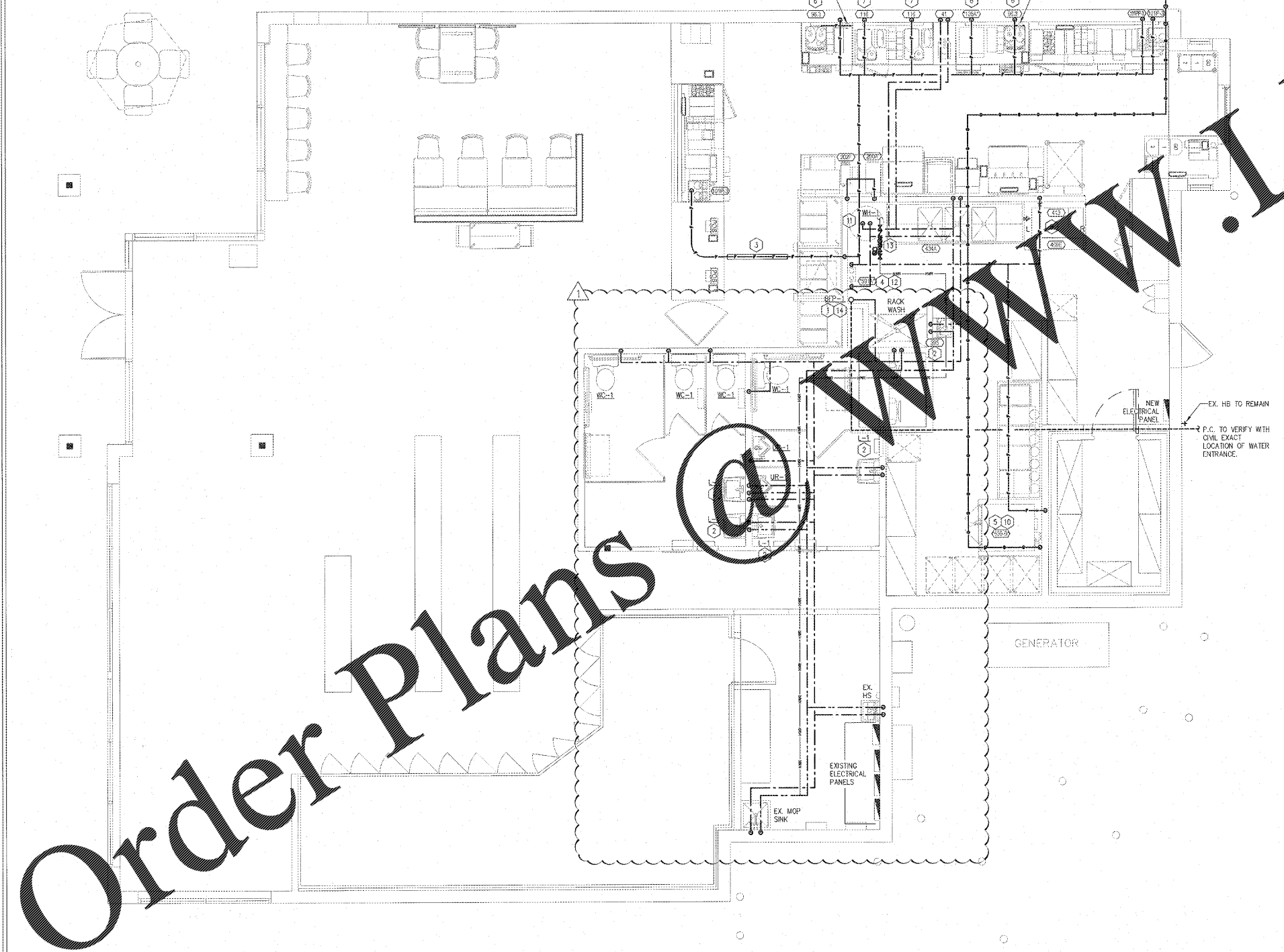

IF ANY DISCREPANCIES ARE FOUND ON THE PLANS, THE PLUMBING CONTRACTOR SHALL SHALL BID AND INSTALL THE MORE CONSERVATIVE SPECIFICATION AND CALL ENGINEER FOR CLARIFICATION.

PRIOR TO SUBMITTING BID, CONTRACTOR SHALL VISIT SITE TO EXAMINE SITE CONDITIONS. CONTRACTOR SHALL EXAMINE EXISTING CONDITIONS AND REUSE AND RECONNECT TO EXISTING SERVICE WHERE POSSIBLE. ALL REUSED PIPING AND EQUIPMENT MUST COMPLY WITH STATE AND LOCAL PLUMBING CODE.

LOCATION AND CONFIGURATION OF EXISTING WASTE/VENT, WATER, AND GAS PIPING ARE BASED ON EXPOSED AS-BUILT INFORMATION. CONTRACTOR SHALL FIELD VERIFY ALL CONDITIONS PRIOR TO STARTING WORK. MAKE ADJUSTMENTS AS REQUIRED BASED ON ACTUAL BUILDING EQUIPMENT CONFIGURATION.

WHILE EVERY ATTEMPT HAS BEEN MADE IN THE PREPARATION OF THIS PLAN TO AVOID MISTAKES, THE DESIGNER AND COMPANY CANNOT GUARANTEE AGAINST ERROR OR UNFORESEEN FIELD CONDITIONS. THE CONTRACTOR OR BUILDER MUST CHECK ALL DIMENSIONS, DETAILS AND REPORT ANY DISCREPANCIES.

THESE PLANS ARE CONFIDENTIAL PROPERTY OF DUNKIN' BRANDS, INC. UNDER RESTRICTED ACCESS.

**dunkin' brands**

PROJECT NO.: 17229

**NRD** national restaurant designers  
ARCHITECTS & ENGINEERS

3005 Carrington Mill Blvd., Morrisville, NC 27560  
ph: 919 544 7251 fax: 919 544 9390  
A Division of LMHT Associates

COMMITTEE OF VIRGINIA ARCHITECTS  
RESERVATION # 100333  
PROF. EXP. 5/15

NO.	DESCRIPTION	DATE	SCALE	DRAWN	CKD	APPD
1	SET REVISIONS OWNER COMMENTS (RESTROOM CHANGE)	5/2/18				
	SHEET REVISIONS					

DD FRESH BREW 1.0  
908 MARKET DRIVE, EMPORIA, VA

**PLUMBING  
WATER AND GAS PLAN**

PC# 358084

**P-1.2**

1 WATER AND GAS PLAN  
1/4"=1'-0"