

Order Plans @

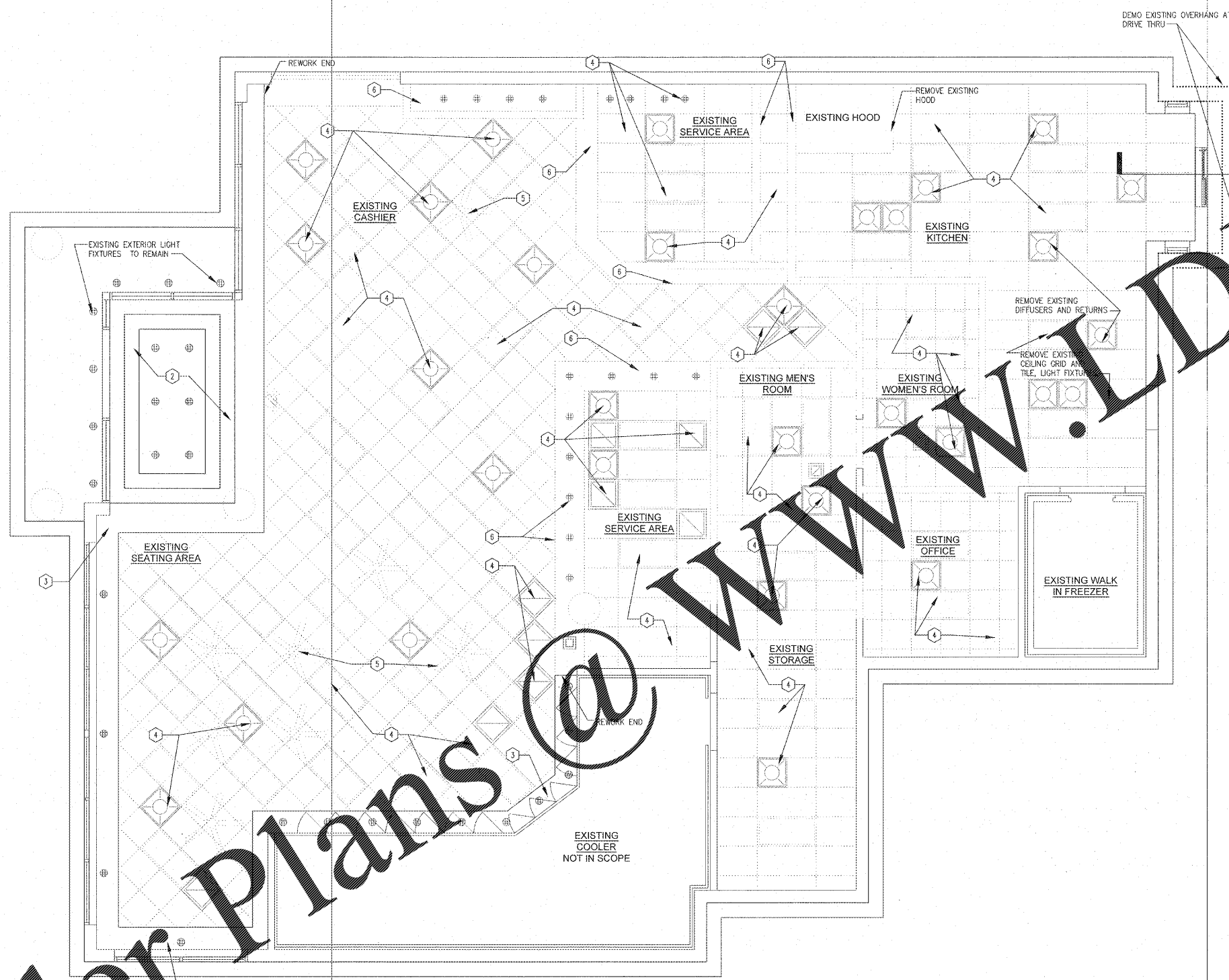

- DEMOLITION NOTES**
- 1 EXISTING EXTERIOR LIGHTING SHALL REMAIN.
 - 2 EXISTING ENTRY ELEMENTS & LIGHTING SHALL REMAIN.
 - 3 EXISTING GYPSUM SOFFIT & LIGHTING SHALL REMAIN.
 - 4 EXISTING CEILING GRID, CEILING TILES, LIGHT FIXTURES, AND HVAC DIFFUSERS SHALL BE REMOVED.
 - 5 EXISTING CEILING FANS SHALL BE REMOVED. CAP ALL UNUSED UTILITIES AS REQUIRED.
 - 6 REMOVE EXISTING GYPSUM SOFFIT, FRAMING & LIGHT FIXTURES.

THESE PLANS ARE CONFIDENTIAL PROPERTY OF DUNKIN' BRANDS, INC. UNDER RESTRICTED ACCESS.

Dunkin' Brands

PROJECT NO.: 17229

NRD national restaurant designers
ARCHITECTS & ENGINEERS

3005 Carrington Hill Blvd., Morrisville, NC 27560
ph: 919 544 7251 fax: 919 544 9399
A Division of LMNT Associates

COMMITTEE OF VIRGINIA ARCHITECTS
Chm. Russell Lehmann
Lic. No. 03971

NO	DESCRIPTION	DATE	SCALE	DRAWN	CKD	APPD

3-18-18

DATE SCALE DRAWN AY TD

SET REVISIONS SHEET REVISIONS

DD FRESH BREW 1.0
DUNKIN DESIGN GUIDELINES

DEMO CEILING PLAN

PC NUMBER

D-2.0

1 DEMO CEILING PLAN
1/4" = 1'-0" NOTE

NOTE: DRAWINGS ARE NOT TO SCALE IF SHEET IS PLOTTED ON 11" x 17"