

ROOF GENERAL NOTES:

1. ROOF SYSTEMS SPECIFIED SHALL BE APPLIED ONLY BY MANUFACTURER APPROVED APPLICATOR IN ORDER TO MEET GUARANTEE REQUIREMENTS.
2. ALL ROOFING DETAILS TO BE VERIFIED AND COORDINATED WITH MANUFACTURER'S SPECIFICATIONS AND WARRANTIES.
3. PONDING WATER IS DEFINED AS WATER THAT DOES NOT DRAIN OR DISSIPATE FROM THE ROOF WITHIN 48 HOURS AFTER PRECIPITATION.
4. REMOVE SIGN & RETURN TO OWNER.
5. THE EXISTING MEMBRANE ROOFING IS TO REMAIN AND IS TO BE PATCHED AND REPAIRED WHERE NECESSARY. ANY EXISTING PONDING AREAS TO BE CORRECTED TO DRAIN TO EXISTING ROOF DRAINS. NEW ROOFING MEMBRANE @ TOWER TO BE OVER-LAPPED ONTO EXISTING AS DESCRIBED BY ROOFING PROVIDER.
6. ROOFING SUBCONTRACTOR TO COORD. ALL TRAPES OF ROOF ACCESSORIES FOR PLACEMENT OF TAPERED RIGID INSULATION LAY-OUT AND SUBSEQUENT INSTALLATION IN ORDER TO AVOID PONDING WATER CONDITIONS ATTRIBUTABLE TO BOARD LAY-OUT.

ROOF PLAN KEY NOTES:

1. LIGHT BAND SIGN VENDOR; G.C. TO COORDINATE POWER & BLOCKING AS REQ'D.
2. NEW CONTINUOUS FINISH COPING. @ ALL PARAPETS, EXISTING NEW
3. NEW TRANSITIONAL ROOF AREA WITH NEW MEMBRANE, CDX. PLY, ROOF WEATHING. SEE SECTIONS.
4. WIDE EDGE TRANSITIONAL ROOF AREA & NEW PARAPET(S) AREAS TO ADJ. W/ FACE OF ORIGINAL, EXISTING PARAPET WALL. REFER TO WALL SECTION.
5. FINISHED METAL CANOPY BY SIGN VENDOR; G.C. TO COORD. POWER & BLOCKING REQUIRED - **SEE ELEVATIONS**
6. REPAIR / REPLACE EXISTING OVERFLOW SCUPPER AS REQ'D. ENSURE THAT SCUPPERS DRAIN PROPERLY. - FIELD VERIFY LOCATION & QUANTITY
7. EXISTING ROOF DRAINS - REPLACE ALL SEDIMENT CAGES & ENSURE ALL ROOF DRAINS PROPERLY DRAIN ALL WATER TO STORM OR PARKING DRAIN. CLEAN & REPAIR ALL DRAIN-LINES AND DRAIN HEADS IN NON-WORKING CONDITION.

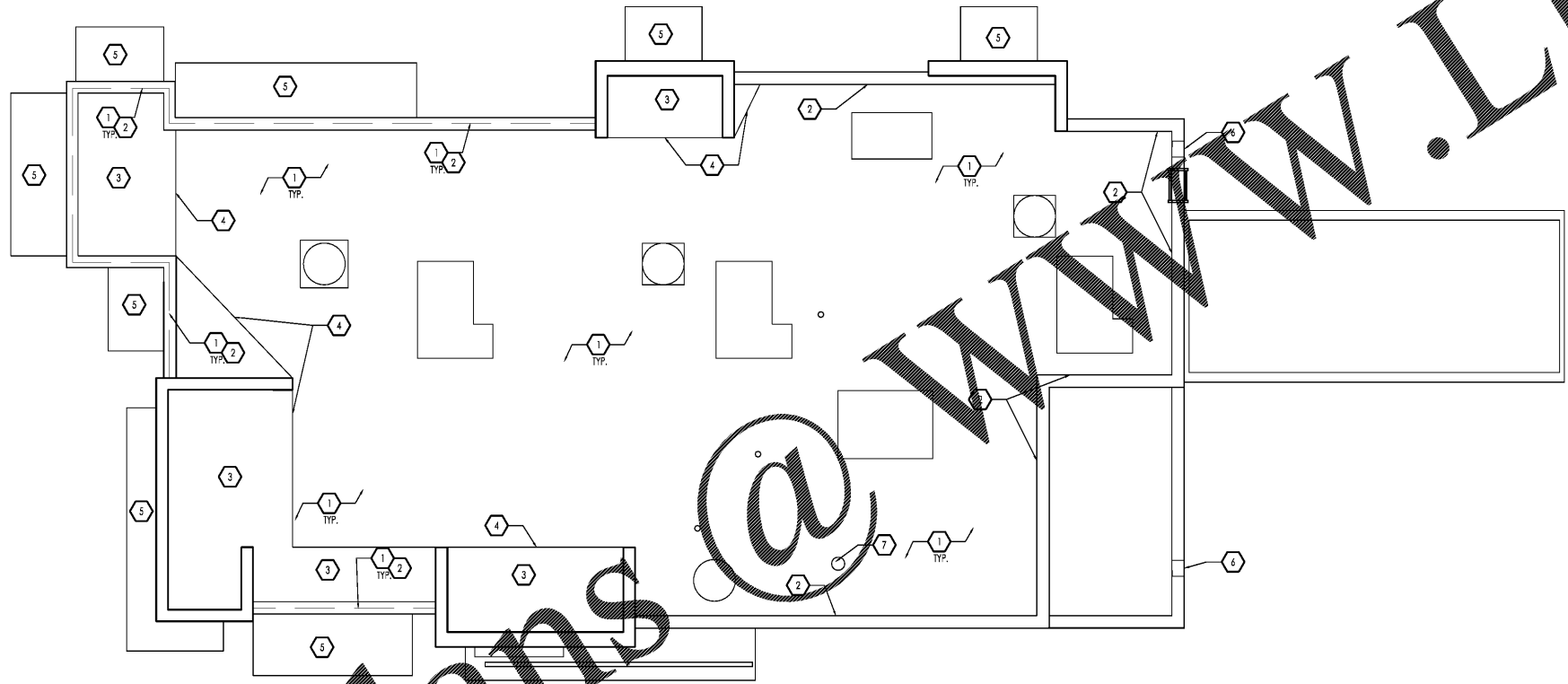

ROOF PLAN
SCALE: 3/16" = 1'-0"

Order Plans

WWW.LDILLING.COM

NO.	DATE	CHECKED BY: ENR	DATE ON	RELEASED FOR CONSTRUCTION



PREMIER KINGS, INC.
5529 CARMICHAEL RD
MONTGOMERY, AL 36117
PHONE: (334) 312-0849

2126 Morris Avenue
Pineville, NC 28134
Phone: (704) 322-1251
Fax: (704) 322-1778
email: info@hphaha.com
www.hphaha.com

James M. Huxtestein
architect AIA



PROJECT #1702037
BURGER KING RENOVATION
154 S MAIN ST.
BAXLEY, GA 31513