

INTERIOR NOTES

- ALL INTERIOR FINISHES MUST MEET THE REQUIREMENTS OF TABLE 903.9 OF THE IBC. INTERIOR WALLS AND CEILING FINISHES SHALL BE INSTALLED IN ACCORDANCE WITH THE CURRENT APPLICABLE CODES.
- ALL EXPOSED TRUSSES, BLOCKING, ROOF SHEATHING, DUCTWORK, JUNCTION BOXES, EXPOSED CONDUITS, ETC. TO BE PAINTED EXP-1 IN DINING AREA.

FINISH SCHEDULE

ROOM	NUMBER	NAME	FLOOR	BASE	WALL	CEILING	REMARKS
100	DINING	PT-1	PTB-1	SEE PLAN	EXP-1	PAINT WALL ABOVE STOREFRONT W-5, SOFFITS SP-1	
101	ORDER	PT-1	PTB-1	SEE PLAN	EXP-1		
102	MENS	PT-1	PTB-1	SEE PLAN	RCP-1	REFER TO ELEVATIONS ON A802	
103	WOMENS	PT-1	PTB-1	SEE PLAN	RCP-1	REFER TO ELEVATIONS ON A802	
104	CORRIDOR	PT-1	PTB-1	WP-1	DAG-1		
105	SERVICE	QT-1	QTB-1	SEE PLAN	KAG-1	SOFFIT SP-1	
106	DRIVE-THRU	QT-1	QTB-1	FRP-1	KAG-1		
107	KITCHEN	QT-1	QTB-1	FRP-1/SSP-1	KAG-1		
108	DRY STOR.	QT-1	QTB-1	FRP-1	KAG-1		
109	CORRIDOR	QT-1	QTB-1	MFG	MFG		
110	COOLER	QT-1	QTB-1	MFG	MFG		
111	FREEZER	QT-1	QTB-1	MFG	MFG		
112	UTILITY	CONC	-	-	-		

INTERIOR FINISH LEGEND

FLOORING	WALLS	FURNITURE/ ACCESSORIES
PT-1 PORCELAIN FLOOR TILE: DAL-TILE, GLAZED PORCELAIN TILE, STYLE: BB12 BAY BRIDGE, COLOR: TRESTLE, SIZE: 12" X 24", GROUT: DAL-TILE CUSTOM PRODUCT SANDED GROUT, #60 CHARCOAL WITH 1/8" JOINTS LATEX MODIFIED LOCATIONS: DINING, ORDER, RESTROOMS, CORRIDOR	ALUM-1 PRE-FINISHED ALUMINUM INSULATED COOLER/ FREEZER WALL AND CEILING PANELS (BY OTHERS) LOCATIONS: WALK-IN COOLER/ FREEZER	C-1 CHAIR FRAME: POWDER COAT CHAIR FRAME, COLOR: SILVER CHAIR SEAT: CF STINSON, VINYL CHAIR SEAT, STYLE: SCOUT, COLOR: RED SC053 FIRE LOCATIONS: DINING AREA
PTB-1 PORCELAIN TILE COVE BASE: DAL-TILE, GLAZED PORCELAIN TILE, STYLE: BB12-S969TB1P, COLOR: TRESTLE, SIZE: 6" X 12", GROUT: DAL-TILE CUSTOM PRODUCT SANDED GROUT #60 CHARCOAL W/ 1/8" JOINTS LATEX MODIFIED LOCATIONS: DINING, ORDER, RESTROOMS, CORRIDOR	CG-1 CORNER GUARDS: STAINLESS STEEL FINISH LOCATIONS: ALL WALL CORNERS, SEE PLAN	BB-1 BOOTH FRAME: FULLERTON VINYL BACK PAD: STINSON, VINYL PAD, STYLE: SCOUT, COLOR: RED SC053 FIRE FIBERGLASS SEAT: OBSIDIAN, FIBERGLASS SEAT, COLOR: BLACK LEGS: 6" ADJUSTABLE STAINLESS STEEL LOCATIONS: DINING AREA
QT-1 QUARRY FLOOR TILE: DAL-TILE, QUARRY TILE, STYLE: QUARRY TEXTURES ABRASIVE, COLOR: 0701 DIABLO RED, SIZE: 6" X 6", GROUT: DAL-TILE CUSTOM PRODUCT EPOXY CEG-LITE #60 CHARCOAL WITH 3/8" JOINTS LOCATIONS: SERVICE AREAS BEHIND SERVICE GATE	FRP-1 WALL COVERING: MARLITE, FRP, COLOR: P199 BRIGHT WHITE, FINISH: PEBBLED FINISH LOCATIONS: SERVICE AREAS BEHIND SERVICE GATE	SS-1 COUNTERTOP: STARON, SOLID SURFACE, COLOR: ASPEN PEPPER AP640, FINISH: EASE EDGES LOCATIONS: FRONT COUNTER, UNDER WALL
QTB-1 QUARRY TILE COVE BASE: DAL-TILE, QUARRY TILE, STYLE: QUARRY TEXTURES Q3565, COLOR: 0701 DIABLO RED, SIZE: 6" X 6", GROUT: DAL-TILE CUSTOM PRODUCT EPOXY CEG-LITE #60 CHARCOAL WITH 3/8" JOINTS LOCATIONS: AREAS BEHIND SERVICE AREA GATE	RAT-1 WALL TILE: DAL-TILE, GLASS TILE, STYLE: ISIS GLASS TILE, COLOR: BRICK DUST, SIZE: 2" X 12", GROUT: DAL-TILE CUSTOM PRODUCT POLYBLEND SANDED #60 CHARCOAL LOCATIONS: RESTROOMS WALLS ACCENT BAND	SS-1 TABLETOP: WILSON ART, LAMINATE, STYLE: CALCUTTA MARBLE, COLOR: 4925K-01 EDGES: 3/8" X 5/8" T-MOLD, STYLE: SMOOTH ALUMINUM, COLOR: ALUMINUM WALL PAINT: SHERWIN WILLIAMS, PAINT, STYLE: CHROME PEARL 2005-50, COLOR: CHERRY, FINISH: WITH SELF-ADJUSTING LEVELERS LOCATIONS: DINING AREA
QTB-2 QUARRY TILE BULLNOSE BASE: DAL-TILE, QUARRY TILE, STYLE: QUARRY TEXTURES Q1665, COLOR: 0701 DIABLO RED, SIZE: 6" X 6", GROUT: DAL-TILE CUSTOM PRODUCT EPOXY CEG-LITE #60 CHARCOAL WITH 3/8" JOINTS LOCATIONS: RECESSED MOP SINK	RG-1 RESTROOM WALL TILE GROUT: CUSTOM BUILDING PRODUCTS GROUT, POLYBLEND SANDED, COLOR: #60 CHARCOAL, RUNNING BOND PATTERN LOCATIONS: RESTROOM WALL TILE GROUT	TT-1 TRASH CONTAINER: BIRWOOD STRT-DT TOP: STARON, SOLID SURFACE, STYLE: SAMSUNG TEMPEST FR148, COLOR: RADIANCE (SHIMMER), FINISH: TRASH OPENING OVAL CUT FRONT AND SIDES: FORMICA, LAMINATE, STYLE: FORMICA 7737-58, COLOR: NATURAL CHERRY EDGES: OUTWATER, T-MOLD, COLOR: SILVER FRAME: SHERWIN WILLIAMS, PAINT, COLOR: BLACK LOCATIONS: DINING AREA
D-1 DOOR: SEE DOOR SCHED. FORMICA, LAMINATE, STYLE: SPECTRUM RED 845-58, COLOR: SPECTRUM RED, FINISH: GLOSS DOOR FRAME: SEE DOOR SCHED. MARLITE, PREHUNG, STYLE: 500 SERIES, COLOR: ALUMINUM, SATIN FINISH DOOR HARDWARE: SEE DOOR SCHED. SATIN NICKEL FIN. LOCATIONS: ALL INTERIOR DOORS	RWT-1 WALL TILE: DAL-TILE, PORCELAIN TILE, STYLE: EGYPTIAN BEIGE, COLOR: CS50, SIZE: 12" H X 24" W, GROUT: DAL-TILE CUSTOM PRODUCT POLYBLEND SANDED #60 CHARCOAL LOCATIONS: RESTROOM WALLS	TC-1 TRASH CONTAINER: BIRWOOD STRT-DT TOP: STARON, SOLID SURFACE, STYLE: SAMSUNG TEMPEST FR148, COLOR: RADIANCE (SHIMMER), FINISH: TRASH OPENING OVAL CUT FRONT AND SIDES: FORMICA, LAMINATE, STYLE: FORMICA 7737-58, COLOR: NATURAL CHERRY EDGES: OUTWATER, T-MOLD, COLOR: SILVER FRAME: SHERWIN WILLIAMS, PAINT, COLOR: BLACK LOCATIONS: DINING AREA
SF-1 STOREFRONT DOOR: YKK AP, ALUMINUM STOREFRONT, STYLE: MODEL 20D, COLOR: YSIN CLEAR, FINISH: CLEAR ANODIZED PLUS LOCATIONS: DINING AREA	RWS-1 WALL TILE: RESTROOM WALL TILE ALUMINUM SCHLUTER TRIM CAP, COLOR: SCHIENE A125, L-SHAPED, ALUMINUM FINISH LOCATIONS: RESTROOM WALLS	LTG-1 PENDANT LIGHTING: ELK, GLASS LED, STYLE: ELK502-IFR-LED, 13.5 WATT 800 LUMENS, COLOR: RED / SATIN NICKEL, SIZE: 9"W X 12"H, FINISH: 6-8" FROM FINISH FLOOR TO BOTTOM OF PENDANT LOCATIONS: DINING AREA
KD-1 KITCHEN GATE: REFER TO DOOR SCHEDULE. ELIASON, COLOR: P-11 PLUS GRAY LOCATIONS: GATE BETWEEN SERVICE AND DINING	SSP-1 WALL COVERING: 22 GA. STAINLESS STEEL WALL PANEL, APPLIED WITH CONSTRUCTION ADHESIVE LOCATIONS: WALLS BEHIND KITCHEN HOODS	CONC CONCRETE
DAG-1 CEILING TILE: USG INTERIORS, ACOUSTIC TILE, STYLE: GLACIER, COLOR: WHITE, SIZE: 24" X 24" X 5/16", FINISH: REVEALED EDGE CEILING GRID: USG INTERIORS, EXPOSED GRID, STYLE: DXL, COLOR: WHITE, SIZE: 15" X 15" LOCATIONS: CORRIDOR	W-1 WALL PAINT: SHERWIN WILLIAMS, PAINT, STYLE: PROMAR 200 ZERO VOC, COLOR: GRAY CITY SCAPES SW7067, FINISH: SEMI-GLOSS APPLIED WITH 3/4" NAP ROLLER LOCATIONS: DINING	OTHER ABBREVIATIONS
EXP-1 EXPOSED TRUSSES: SHERWIN WILLIAMS, PAINT, STYLE: PROMAR 200 ZERO VOC, COLOR: GRAY CITY SCAPES SW7067, FINISH: SEMI-GLOSS APPLIED WITH 3/4" NAP ROLLER LOCATIONS: DINING	W-2 WALL PAINT: SHERWIN WILLIAMS, PAINT, STYLE: PROMAR 200 ZERO VOC, COLOR: GRAY CITY SCAPES SW7067, FINISH: SEMI-GLOSS APPLIED WITH 3/4" NAP ROLLER LOCATIONS: DINING AND RESTROOM ACCENT WALLS	WALLS (CONTINUED)
KAG-1 CEILING TILE: USG INTERIORS, GYPSUM LAY-IN PANELS, STYLE: VINYL FACED SHEETROCK CLIMAPLUS, COLOR: SAT WHITE 050, SIZE: 24" X 48" X 1/2" CEILING GRID: USG INTERIORS, DOUBLE-WEB HOT DIPPED GALVANIZED STEEL, STYLE: DOWN ENVIRONMENTAL, COLOR: ZALA - WHITE, SIZE: 15" X 15" LOCATIONS: SERVICE AREAS BEHIND SERVICE GATE	W-3 WALL COVERING: MFC, PDB PREFINISHED CORRUGATED SIDING, STYLE: SIGNATURE-300, COLOR: SLATE GRAY, FINISH: FACTORY FINISH LOCATIONS: DINING AREA	W-4 WALL PAINT: SHERWIN WILLIAMS, PAINT, STYLE: PROMAR 200 ZERO VOC, COLOR: SW7006 EXTRA WHITE, FINISH: SEMI-GLOSS APPLIED WITH 3/4" NAP ROLLER LOCATIONS: DINING AREA
RCP-1 CEILINGS: SHERWIN WILLIAMS, PAINT, STYLE: PROMAR 200 ZERO VOC, COLOR: SW7006 EXTRA WHITE, FINISH: SEMI-GLOSS APPLIED WITH 3/4" NAP ROLLER LOCATIONS: RESTROOMS	W-5 WALL PAINT: SHERWIN WILLIAMS, PAINT, STYLE: PROMAR 200 ZERO VOC, COLOR: GRAY CITY SCAPES SW7067, FINISH: SEMI-GLOSS APPLIED WITH 3/4" NAP ROLLER LOCATIONS: DINING AREA	W-5 WALL COVERING: WALLPAPER, STYLE: SPECIAL GRAPHICS, COLOR: SPECIAL GRAPHICS LOCATIONS: CORRIDOR
SP-1 CEILING SOFFIT: SHERWIN WILLIAMS, PAINT, STYLE: PROMAR 200 ZERO VOC, COLOR: SW7006 EXTRA WHITE, FINISH: SEMI-GLOSS APPLIED WITH 3/4" NAP ROLLER LOCATIONS: DINING AND SERVICE AREAS, SEE PLAN	W-6 WALL TRIM: MARLITE PRE-FINISHED WOOD TRIM, COLOR: BLACK CUT BLACK WG477 LOCATIONS: DINING AREA	

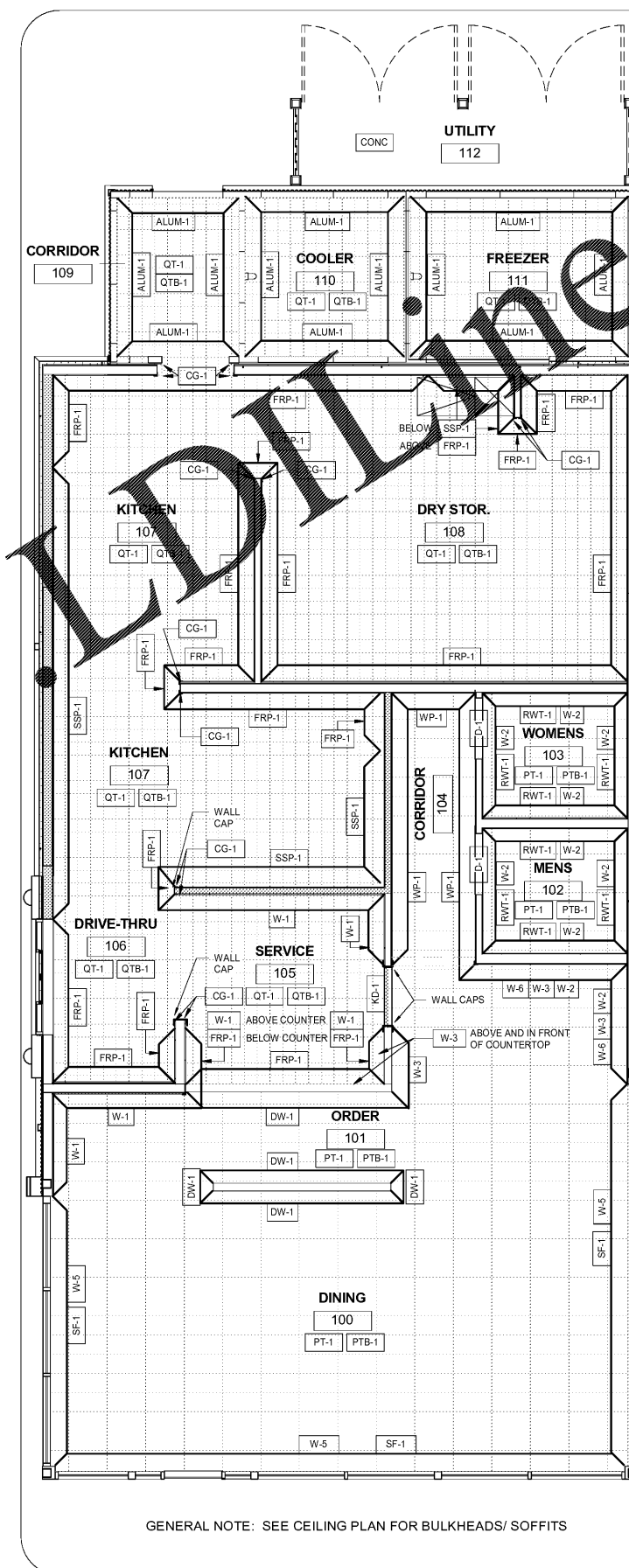

GENERAL NOTE: SEE CEILING PLAN FOR BULKHEADS/ SOFFITS

1 FINISH FLOOR PLAN

SCALE: 1/4" = 1'-0"



#ATL034
CONYERS, GA



ISSUED FOR
CONSTRUCTION

1447 Highway 138
Conyers, Georgia 30012
Rockdale County, Georgia

Revisions		
#	Date	Description

Project Number: 18028
Issued for: CONSTRUCTION
Issue Date: 03/22/18

DRAWING TITLE
**FINISH PLAN,
SCHEDULE AND
DETAILS**

SHEET NUMBER
A751

Order Plans @ WDW