



03.22.2018

#ATL034  
 CONYERS, GA



ISSUED FOR  
 CONSTRUCTION

1447 Highway 138  
 Conyers, Georgia 30012  
 Rockdale County, Georgia

Revisions		
#	Date	Description

Project Number: 18028  
 Issued for: CONSTRUCTION  
 Issue Date: 03/22/18

DRAWING TITLE  
**EQUIPMENT PLAN**

SHEET NUMBER  
**A701**

**STORAGE CALCULATIONS**

DRY STORAGE		
ITEM 23	7 UNITS WITH 4 SHELVES 24X60 SHELVES @ 10 LF PER SHELF	= 280 LF
ITEM 37.1	2 UNITS WITH 4 SHELVES 18X60 SHELVES @ 7.5 LF PER SHELF	= 060 LF
FREEZER STORAGE		
ITEM 33	6 UNITS WITH 1 SHELF 24X48 SHELF @ 8 LF PER SHELF	= 048 LF
COOLER STORAGE		
ITEM 35	2 UNITS WITH 4 SHELVES 24X36 SHELVES @ 6 LF PER SHELF	= 048 LF
ITEM 35	2 UNITS WITH 4 SHELVES 24X60 SHELVES @ 10 LF PER SHELF	= 080 LF
<b>TOTAL STORAGE ALL TYPES</b>		<b>516 LF</b>

**EQUIPMENT NOTES**

1. WALK-IN REFRIGERANT LINES SHOULD BE ROUTED FROM WALK-INS TO ROOF IN WALL CAVITY. SEE CUTSHEETS FOR ADDITIONAL INFORMATION
2. SEE MECHANICAL, ELECTRICAL, PLUMBING DRAWINGS FOR ADDITIONAL EQUIPMENT REQUIREMENTS
3. SEE A 702 FOR EQUIPMENT SCHEDULE.
4. REFER TO EQUIPMENT CUTSHEETS FOR ADDITIONAL INFORMATION
5. WATER FILTRATION SYSTEM FURNISHED BY EQUIPMENT SUPPLIER AND INSTALLED BY GENERAL CONTRACTOR

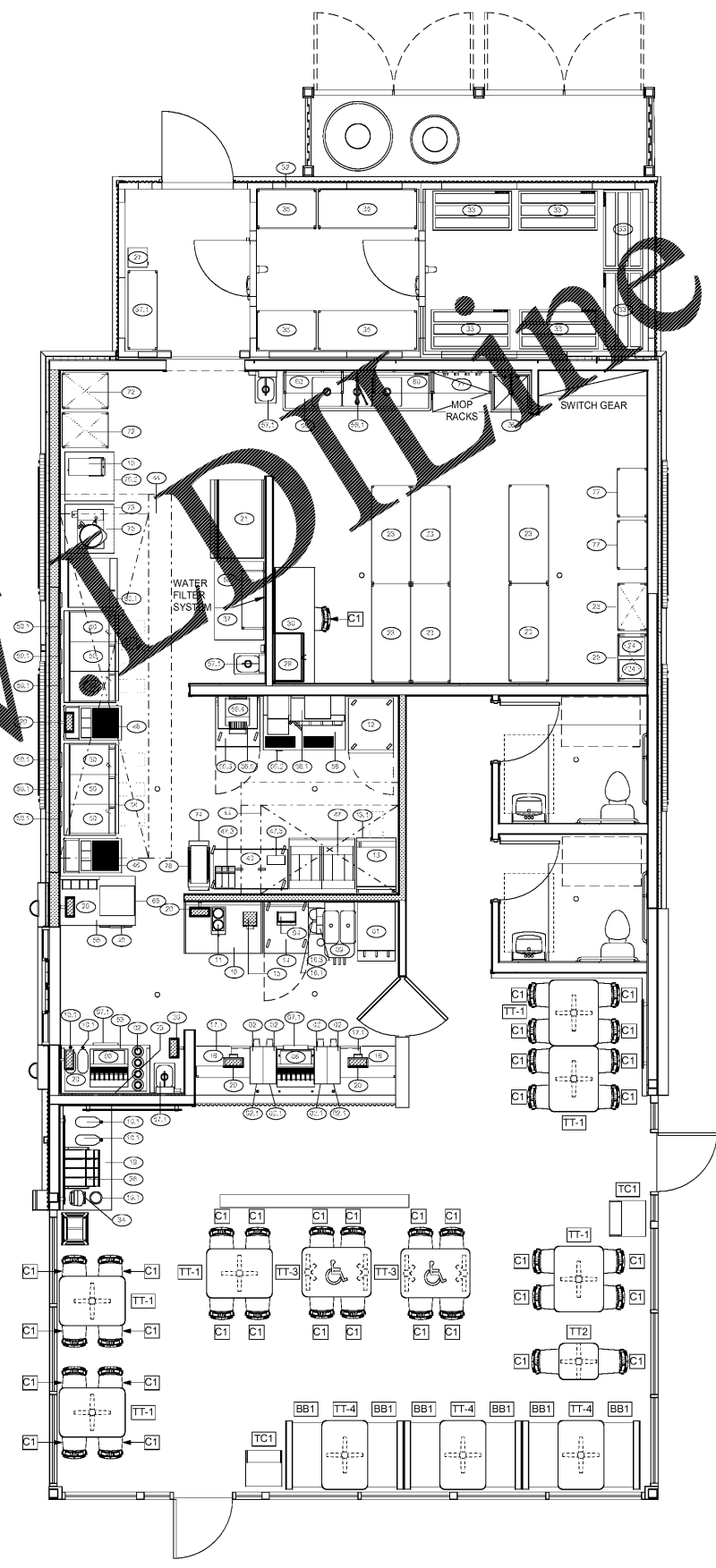

**1 EQUIPMENT FLOOR PLAN**  
 SCALE: 1/4" = 1'-0"

Order Plans @ [www.wldline.com](http://www.wldline.com)