

EQUIPMENT KEYNOTES

Key Value	Keynote Text
K1.1	WALL BACKING BY G.C.

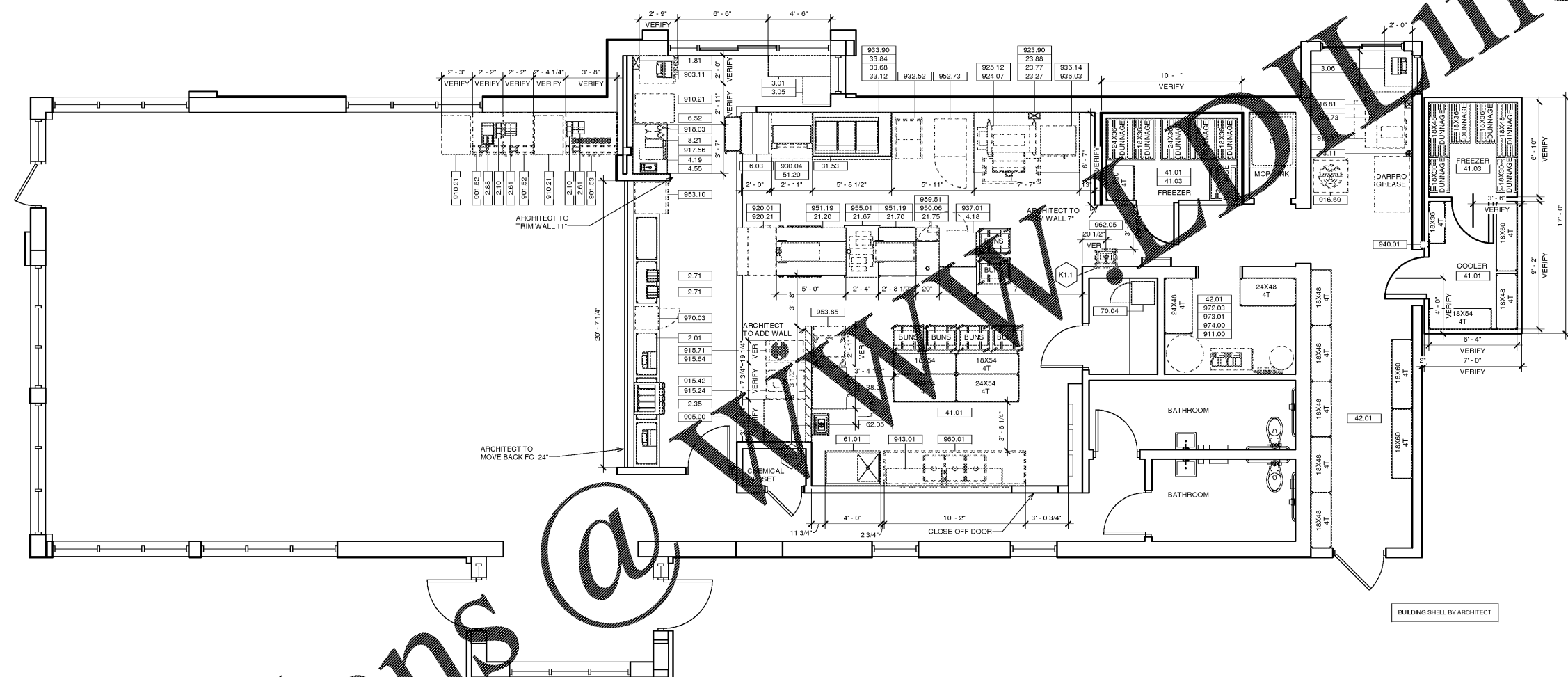

1 KES Equipment Plan  
1/4" = 1'-0"

- DRAWING NOTES**
- THIS DRAWING REFLECTS THE EQUIPMENT ORDERED AS OF THE DATE SHOWN. ADDITIONS OR DELETIONS MAY BE MADE TO THE ORDER, AND THESE CHANGES MAY NOT BE REFLECTED IN THIS DRAWING. PLEASE CONTACT FRANKIE, INC. TO ADDRESS ANY QUESTIONS OR TO CONFIRM YOUR ORDER.
  - ANY DEVIATIONS FROM THESE PLANS, FOR ANY REASON, SHALL BE DONE WITHOUT PRIOR WRITTEN NOTIFICATION TO FRANKIE FOODSERVICE SYSTEMS, INC. FRANKIE FOODSERVICE SYSTEMS, INC. SHALL NOT BE HELD RESPONSIBLE FOR DEVIATIONS, CHANGES, ADDITIONS OR DELETIONS NOT REVIEWED AND APPROVED IN ADVANCE BY A FRANKIE REPRESENTATIVE.
  - FRANKIE FOODSERVICE SYSTEMS HAS PREPARED THESE PLANS ACCURATELY AS POSSIBLE WITH THE INFORMATION PROVIDED. FRANKIE SHALL NOT BE HELD RESPONSIBLE FOR ANY ADDITIONAL CONSTRUCTION COSTS DUE TO INACCURATE OR INCOMPLETE ARCHITECTURAL INFORMATION. ANY COSTS INCURRED DUE TO ADJUSTMENTS TO THESE PLANS SHALL BE THE RESPONSIBILITY OF THE OWNER'S EXPENSE.
  - FOR ANY KITCHEN EQUIPMENT, NO WORK IS TO BE PERFORMED WITHIN THE AREA UNLESS SPECIALLY INSTALLED OTHERWISE ON THESE DRAWINGS OR BY A FRANKIE REPRESENTATIVE IN A WRITTEN COMMUNICATION.
- GENERAL CONTRACTOR NOTES**
- FRANKIE SHALL BE RESPONSIBLE FOR VERIFYING ALL BUILDING DIMENSIONS, EQUIPMENT PLACEMENT, EQUIPMENT PLACEMENT, & UTILITY LOCATIONS. PLEASE NOTIFY FRANKIE REPRESENTATIVE IN WRITING & ADJUSTMENTS TO THE DRAWINGS ARE REQUIRED.
  - ALL WORK SHALL BE PERFORMED BY A QUALIFIED LICENSED CONTRACTOR IN ACCORDANCE WITH ALL COUNTRY, STATE, & LOCAL CODES.
  - ALL WORK SHALL BE COMPLETED IN A NEAT, PROFESSIONAL, & SAFE WORKMANLIKE MANNER.
  - NOTIFY FRANKIE IMMEDIATELY IF COMPLIANCE WITH ANY CODES IS IN CONFLICT WITH THESE DRAWINGS.
  - NOTIFY FRANKIE IMMEDIATELY IF THESE DRAWINGS DIFFER FROM THE ARCHITECTURAL OR MEP DRAWINGS.
  - THESE DRAWINGS ONLY INCLUDE THE REQUIREMENTS FOR THE ITEMS PROVIDED BY FRANKIE. G.C. TO VERIFY THE REQUIREMENTS FOR ITEMS NOT PROVIDED BY FRANKIE. REFER TO ARCHITECTURAL, STRUCTURAL, OR MEP DRAWING FOR OTHER REQUIREMENTS.
  - G.C. SHALL PROVIDE & INSTALL PLYWOOD WALL BACKING FOR EQUIPMENT WHERE IT IS REQUIRED.
  - G.C. TO DETERMINE THE LOCATION OF A SET REMOTE CONDENSERS ON ROOF.
  - G.C. TO PROVIDE & INSTALL EQUIPMENT STAND & PITCH PANS FOR ROOF MOUNTED CONDENSING UNITS.
  - G.C. SHALL PROVIDE ACCESS FOR THE EQUIPMENT TRUCK TO WITHIN 10' (3m) OF THE BUILDING DOORS PRIOR TO THE ARRIVAL OF THE EQUIPMENT TRUCK AT THE RESTAURANT.
  - BY OWNER EQUIPMENT WILL BE LISTED IN THE MAIN EQUIPMENT SCHEDULE.

*Make it Wonderful*



**Frankie Foodservice Supply, Inc.**  
800 Aviation Parkway  
Smyrna, TN 37167  
Tel. +800 472-2954  
fr\_customer-service-us@frankie.com  
www.frankiesupply.com

© 2017 Frankie Foodservice Systems, Inc. These drawings and specifications are the property of Frankie Foodservice Systems, Inc. and shall not be reproduced, copied or transmitted in any form or by any means, without the prior written consent of Frankie Foodservice Systems, Inc. Frankie Foodservice Systems, Inc. is an Equal Opportunity Employer. All rights reserved.

**Burger King**  
2397  
KES EQUIPMENT PLAN  
Burger King  
998 SUNSET BLVD  
JESUP  
GA 31545 USA  
NORTH AMERICA  
FREESTANDING

Electrical Service: 208V-230V  
Cooking Equipment: UNSPECIFIED  
Market Manager: M. COUYOUMLIJIAN  
Frankie Project Number: 1393989  
Frankie Order Number: 602818D  
Created By: HP033  
Date Created: 04/19/2018  
Modified By: HP033  
Drawing Status: As Noted  
Unit: INCH  
Drawing Number: Jesup, GA.ite  
Revision: A

Sheet Name: **K1.0**



*Order Plans @ www.orderplans.com*

REV #	DATE	DESCRIPTION
A	04/19/2018	Initial Issue