

STATE	PROJECT NUMBER	SHEET NO.	TOTAL SHEETS
GA.	T.O. 16-024	27	43

NOTE:
 THE CONTRACTOR IS RESPONSIBLE FOR ORGANIZING AND SEQUENCING THE DEMOLITION AND CONSTRUCTION OF ALL SIDEWALKS SO THAT THE CONTRACTOR WILL ONLY DISTURB ONE BLOCK AT A TIME. THE CONTRACTOR SHALL PROVIDE COMPOST FILTER SOCKS AT THE LOW END AND EVERY 20'-30' WITHIN THE DISTURBED AREA, OR AS DIRECTED BY THE ENGINEER. THE COMPOST FILTER SOCKS SHOULD BE PERPENDICULAR TO THE SIDEWALK/ROADWAY FOR ALL DISTURBED AREAS. COMPOST FILTER SOCKS SHOULD BE REUSED AND RELOCATED AFTER WORK IS COMPLETED AND STABILIZED AS WORK PROGRESSES ONE BLOCK AT A TIME.

MATCHLINE - STA. 131+50.00

MATCHLINE - STA. 138+00.00

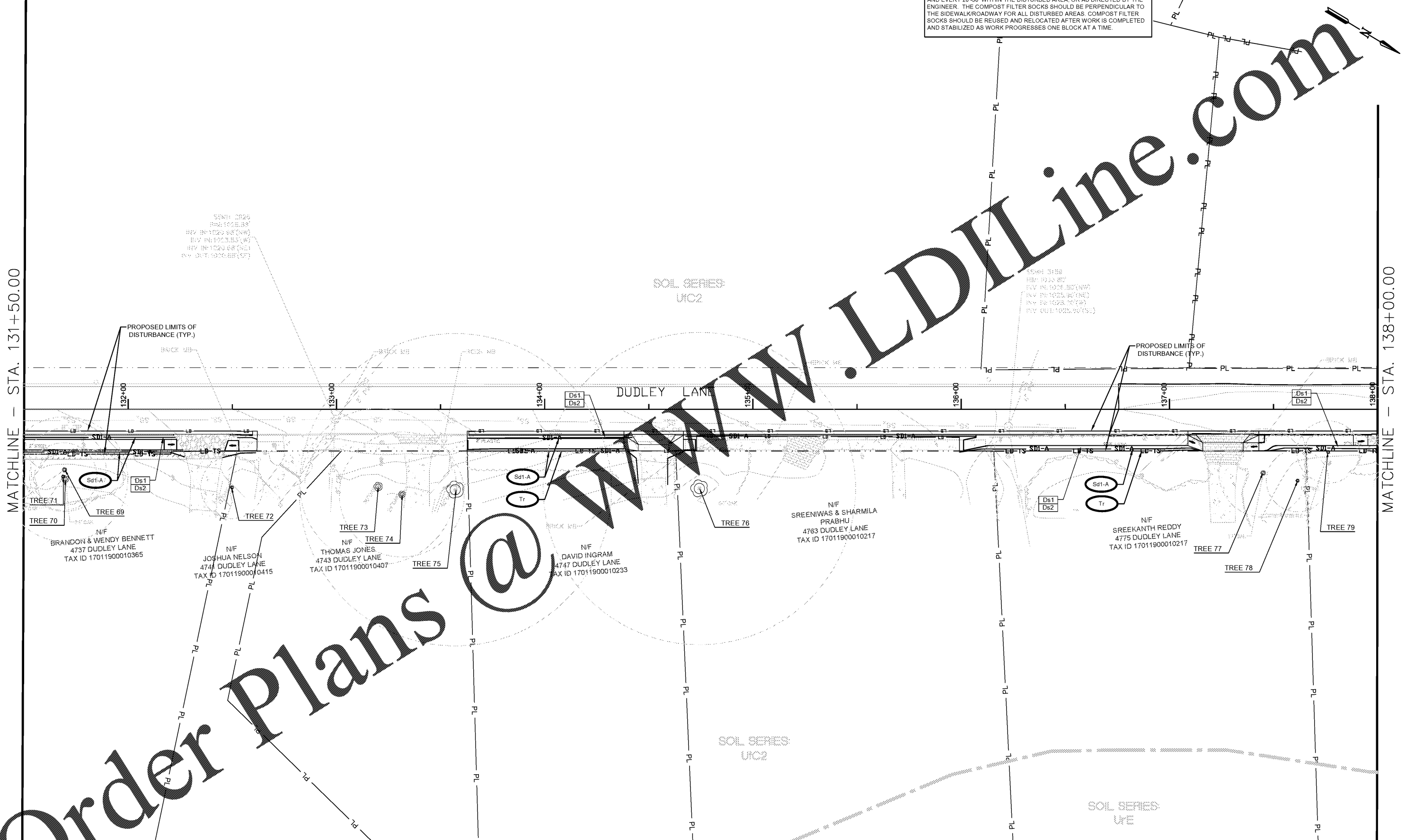

ATKINS
 1600 RIVEREDGE PARKWAY, NW
 SUITE 700
 ATLANTA, GEORGIA 30328
 770-933-0280

PROPERTY AND EXISTING R/W LINE
 REQUIRED R/W LINE
 CONSTRUCTION LIMITS
 EASEMENT FOR CONSTRUCTION
 & MAINTENANCE OF SLOPES
 EASEMENT FOR CONSTR. OF SLOPES
 EASEMENT FOR CONSTR. OF DRIVES
 HISTORICAL PARCEL
 BEGIN LIMIT OF ACCESS
 END LIMIT OF ACCESS
 EXIST. LIMIT OF ACCESS
 REVD. R/W & LIMIT OF ACCESS

SANDY SPRINGS
 GEORGIA

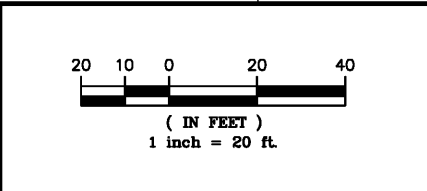

JOB NO. 00625500
 DRAWN **KMM**
 DESIGNED **KMM**
 CHECKED **JDB**
 QC **JDB**



DATE	REVISIONS

CITY OF SANDY SPRINGS
 PUBLIC WORKS
 BMP LOCATION DETAILS
 PHASE II
 DUDLEY LANE SIDEWALK
 PROJECT (T.O. 16-024)

DRAWING NO. 54-13

Feb 19, 2018 - 12:00pm
 M:\COSS - Task Order 16-024 - Dudley Lane Sidewalk Project\CAD\ESPC\Revisions for Sidewalk Extension\16-ESPC-PLAN-Ext.dwg