

#	PLAN KEYED NOTES
1	PLUMBING CONTRACTOR SHALL FIELD VERIFY LOCATION OF EXISTING SANITARY PIPING (SIZE AND INVERT), PRIOR TO MAKING ANY NEW PLUMBING CONNECTION. NOTIFY THE ENGINEER IF INVERT CAN NOT BE MET.
2	EXISTING 1-1/2" WATER SERVICE, EXTERIOR RPZ. FIELD VERIFY EXACT LOCATION PRIOR TO BID.
3	CONNECT TO EXISTING 1" CW STUB-OUT PROVIDED WITH SHUT OFF VALVE WITH A NEW 1" LINE.
4	CONNECT TO 4" SANITARY STUB-OUT CAPPED FOR FUTURE CONNECTION
5	INSTALL WATER HEATER ON PLATFORM SCHEDULE TO WALLS ABOVE CEILING AS REQUIRED. ROUTE 3/4" DRAIN WITH 3/4" OVER FLOW THROUGH AND DOWN WALL TO DISCHARGE INTO SINK WITH AIR GAP AS REQUIRED. INDICATE EXACT LOCATION OF NETWORK ABOVE CEILING.

SEAL:
THIS DOCUMENT IS **NOT FOR CONSTRUCTION**
UNLESS THE ARCHITECT OR ENGINEER'S
SIGNATURE AND SEAL APPEAR BELOW

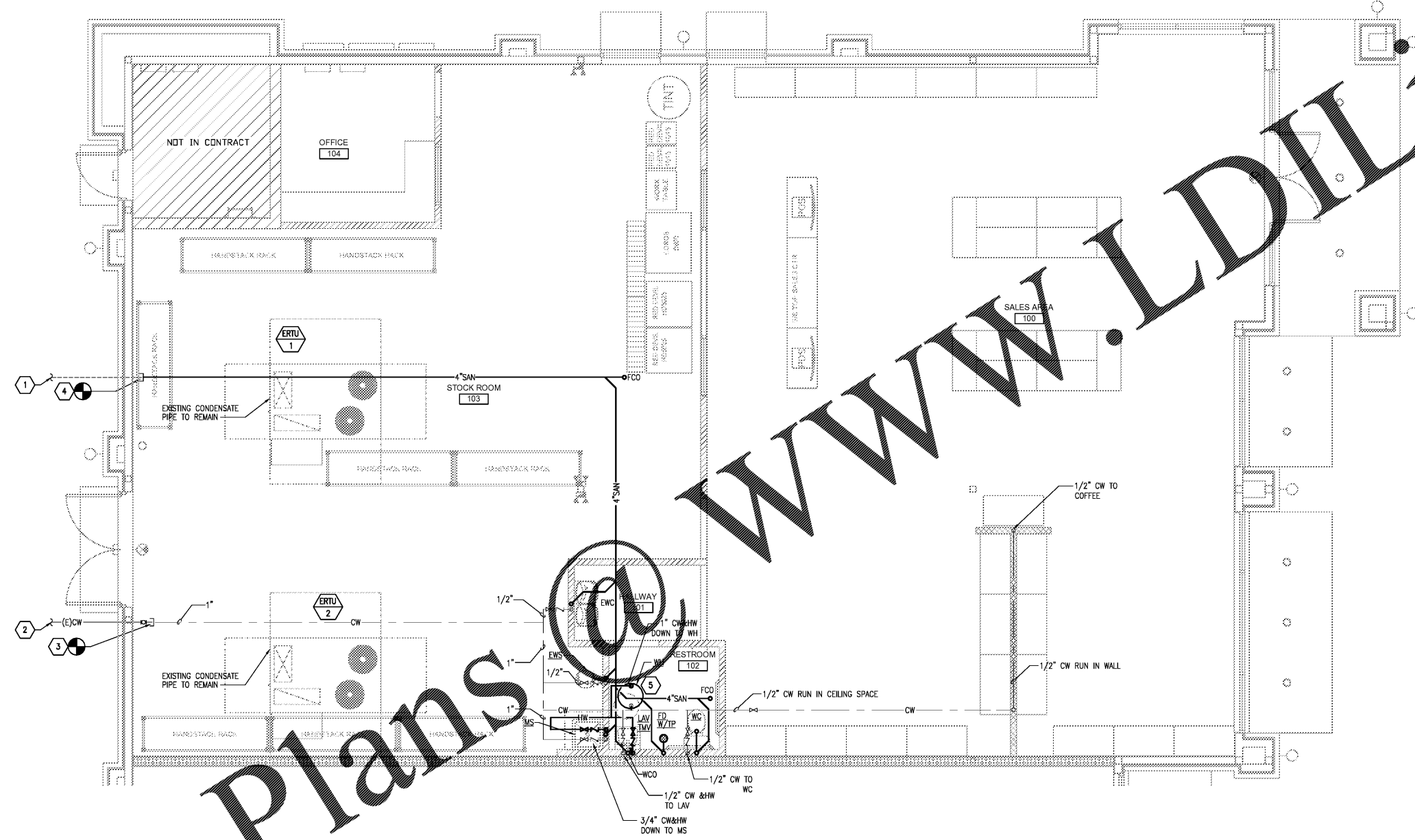

PLUMBING PLAN
1/4" = 1'-0"
NORTH

NO.	DATE	REMARKS
04.04.18		PERMIT SUBMIT
03.26.18		OWNER REVIEW
03.23.18		OWNER REVIEW

SHERWIN WILLIAMS

8909 IMMOKALEE ROAD
NAPLES, FL 34120

PROJECT NO: 2018.0102
DATE: 03.19.18

P101
PLUMBING PLAN

CHECKED: PD DRAWN: AC

Order Plans @

WWW.LDILINE.COM

COPYRIGHT © 2018 INTERPLAN LLC. RESERVE COPYRIGHTS RESTRICTING THESE DOCUMENTS TO THE ORIGINAL SITE OR PURPOSE FOR WHICH THEY WERE PREPARED. REPRODUCTIONS, CHANGES OR ABUSEMENTS ARE PROHIBITED.