

Order Plans @

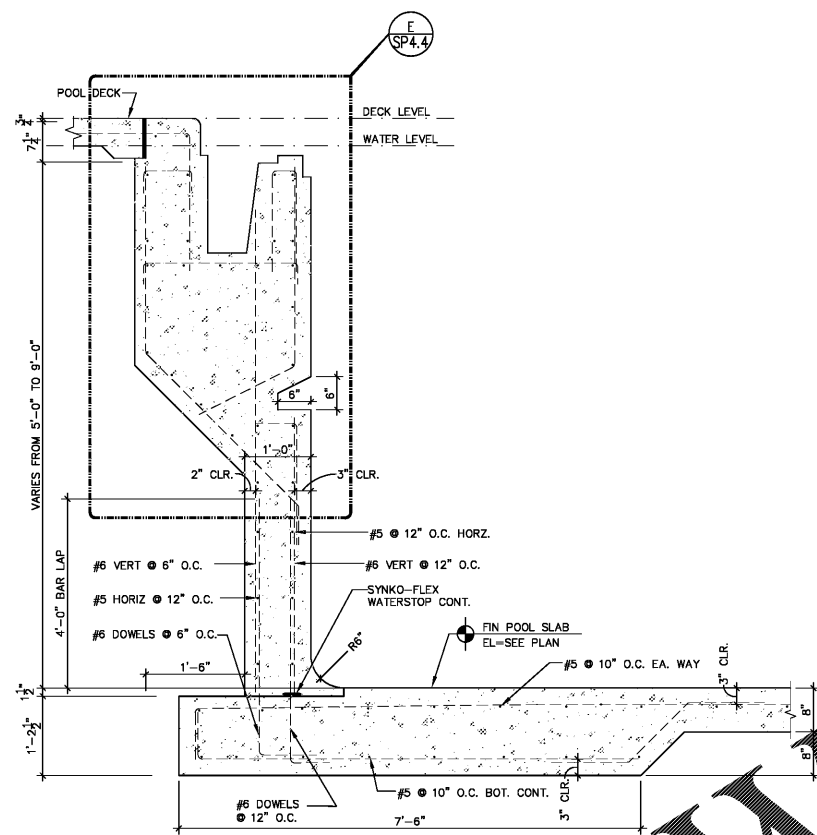

W16 COMPETITION POOL - WALL SECTION
SCALE: 3/4" = 1'-0"

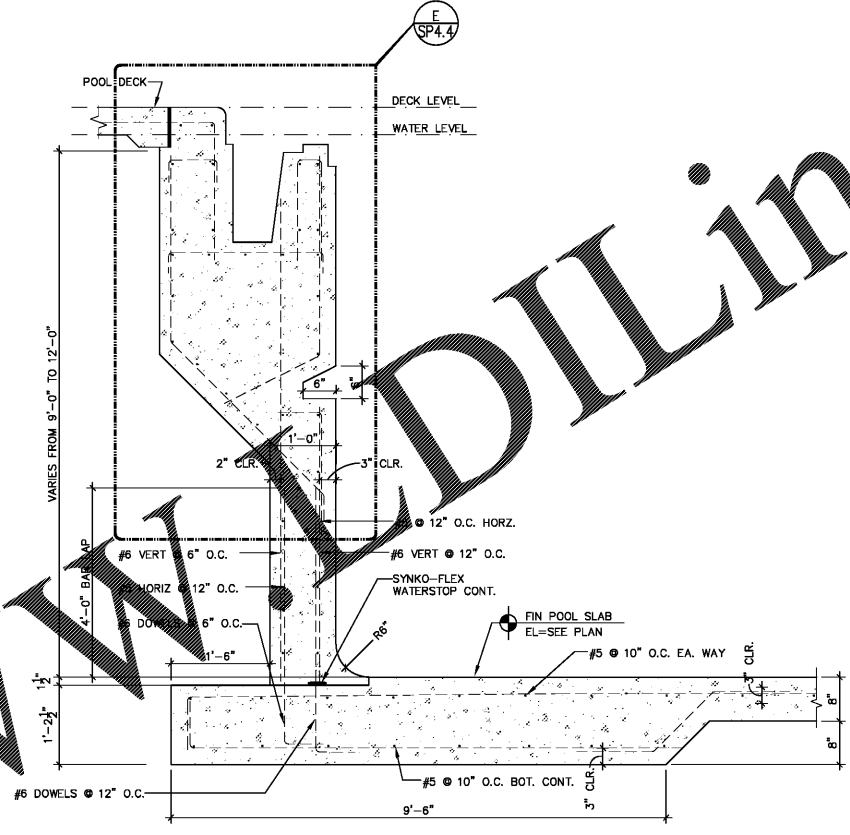

W15 COMPETITION POOL - WALL SECTION
SCALE: 3/4" = 1'-0"

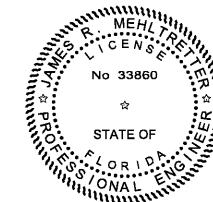

Digitally signed by JAMES R MEHLTRETTER
DN:
OID.0.9.2342.19200300.100.1.1-A
0109800000158F46F62F600000
CB7.CN=JAMES R
MEHLTRETTER, O=IdenTrust
ACES Unaffiliated Individual, C=US
Date: 2017.12.15 12:54:10-05'00'

MASTER CONSULTING ENGINEERS, INC.
STRUCTURAL CONSULTANTS
5523 WEST CYPRESS ST., #200
TAMPA, FLORIDA 33607
813.287.3600 FAX 813.287.3822
www.mceengineers.com
THIS DRAWING AND ALL INFORMATION CONTAINED HEREIN IS THE SOLE PROPERTY OF MASTER CONSULTING ENGINEERS, INC. NO PART OF THIS DRAWING OR INFORMATION CONTAINED HEREIN IS TO BE REPRODUCED, COPIED, ALTERED OR USED IN ANY MANNER WITHOUT THE EXPRESS WRITTEN PERMISSION OF MASTER CONSULTING ENGINEERS, INC.
CA: 8428 PROJ NO. 3104-056
© COPYRIGHT 2017

Scale: AS SHOWN
Designed by: SL
Drawn by: JW
Checked by: JRM
Date: DECEMBER 2017
Project No. 48285014

POOL WALL SECTIONS

BUTLER PARK
AQUATIC CENTER
CITY OF NORTHPORT, FL



Kimley-Horn
2201 West Royal Lane, Suite 275, Irving, Texas 75063
PH: 972.261.1400
FLORIDA REGISTERED ENGINEERING FIRM #89
FLORIDA REGISTERED LANDSCAPE ARCHITECTURE FIRM LC-0000219
© 2017 KIMLEY-HORN AND ASSOCIATES, INC.