

Order Plans

WWW.LDILINE.COM

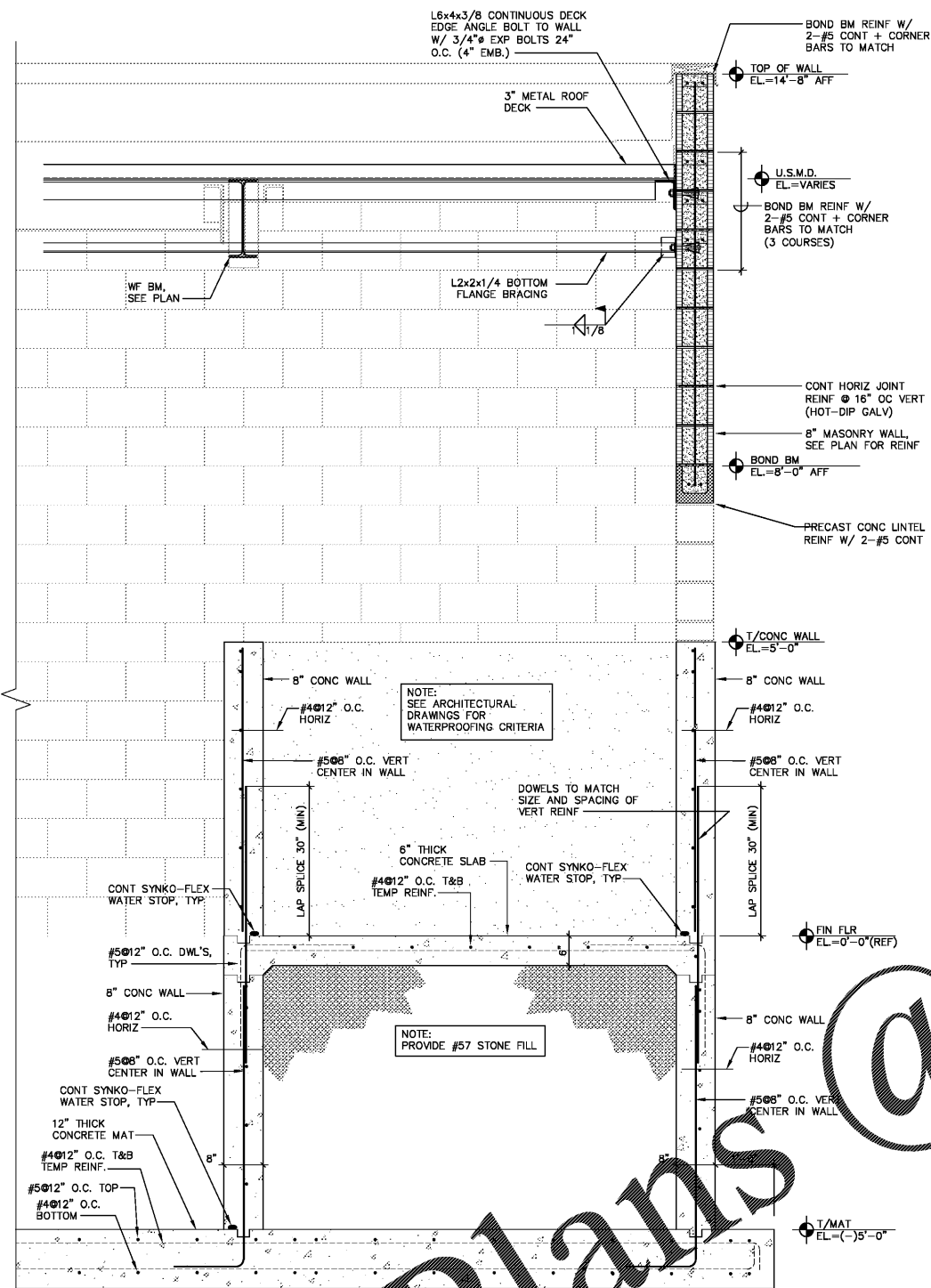

W4 WALL SECTION
SCALE: 3/4" = 1'-0"

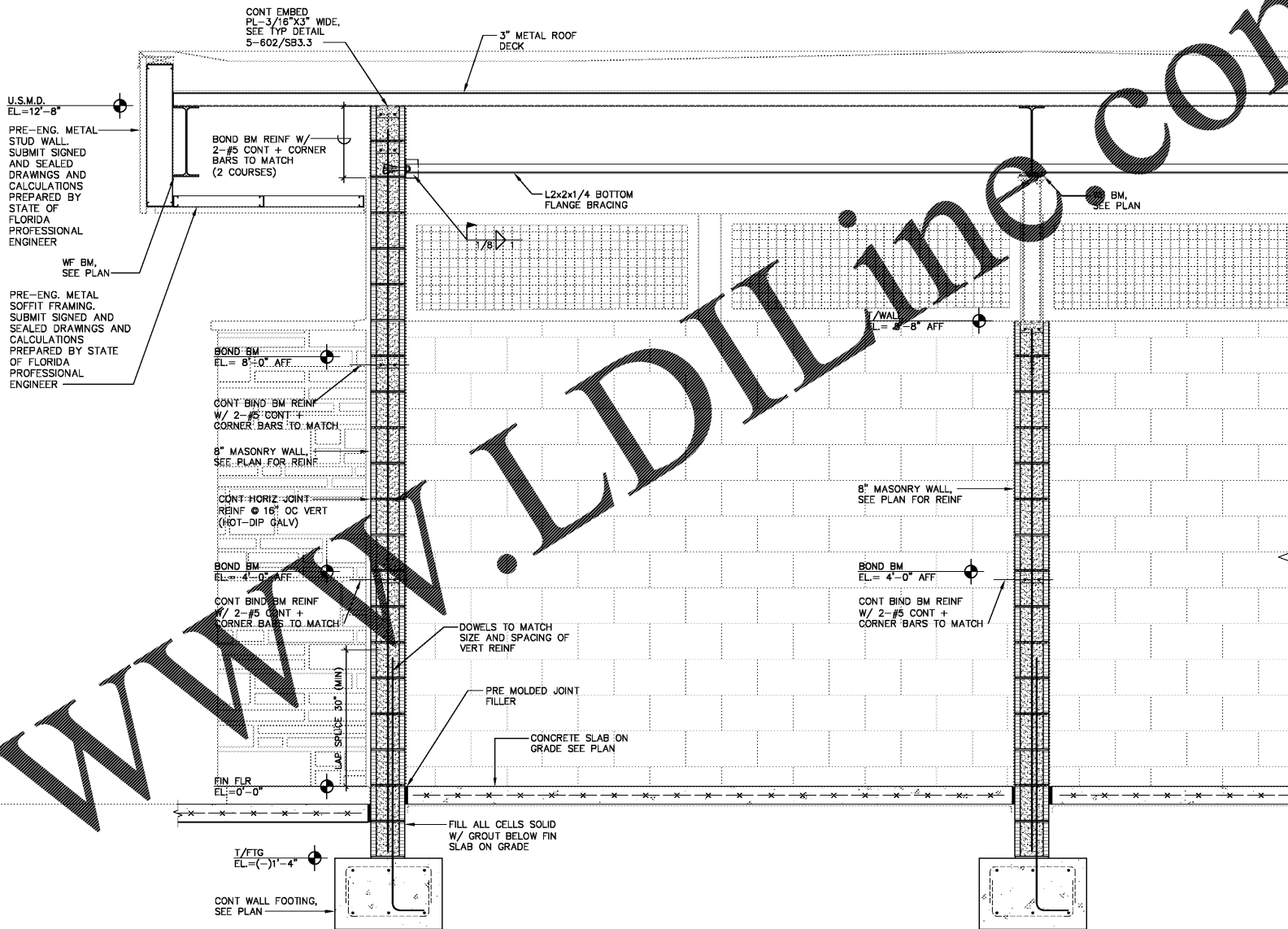

W3 WALL SECTION
SCALE: 3/4" = 1'-0"

Kimley-Horn
2201 West Royal Lane, Suite 275, Irving, Texas 75063
PH: 972.421.4200
FLORIDA REGISTERED ENGINEERING FIRM #860
FLORIDA REGISTERED LANDSCAPE ARCHITECTURE FIRM LC-0000219
© 2017 KIMLEY-HORN AND ASSOCIATES, INC.



BUTLER PARK
AQUATIC CENTER
CITY OF NORTHPORT, FL

FILTRATION BUILDING
SECTIONS

Scale: AS SHOWN
Designed by: SL
Drawn by: JW
Checked by: JRM
Date: DECEMBER 2017
Project No. 48285014

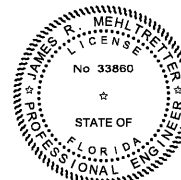

Digitally signed by JAMES R MEHLRETTER
DN:
OID.0.9.2342.19200300.100.1.1
=A0109800000158F46F62F60
0000CB7.CN=JAMES R
MEHLRETTER, O=IdenTrust
ACES Unaffiliated Individual,
C=US
Date: 2017.12.15
12:28:54-05'00'

MASTER CONSULTING ENGINEERS, INC.
STRUCTURAL CONSULTANTS
5523 WEST CYPRESS ST., #200
TAMPA, FLORIDA 33607
813.287.3600 FAX: 813.287.3622
www.mceengineers.com
THIS DRAWING AND ALL INFORMATION CONTAINED HEREIN IS THE SOLE PROPERTY OF MASTER CONSULTING ENGINEERS, INC. AND IS NOT TO BE REPRODUCED, COPIED, OR TRANSMITTED IN ANY FORM OR BY ANY MEANS, ELECTRONIC OR MECHANICAL, INCLUDING PHOTOCOPYING, RECORDING, OR BY ANY INFORMATION STORAGE AND RETRIEVAL SYSTEM.
CA: 8426 PROJ. NO. 3104-056
© COPYRIGHT 2014

SHEET
SF5.2

FL00001 Project:0104 Warehouse:James0104:056 Butler Park North Purification/Filtration Buildings/SF5.1 TIRBU:8157 Area: 12/15/2017 8:53:34 AM John