

1 FLOOR PLAN - NORTHWEST QUADRANT
SCALE: 3/8" = 1'-0"

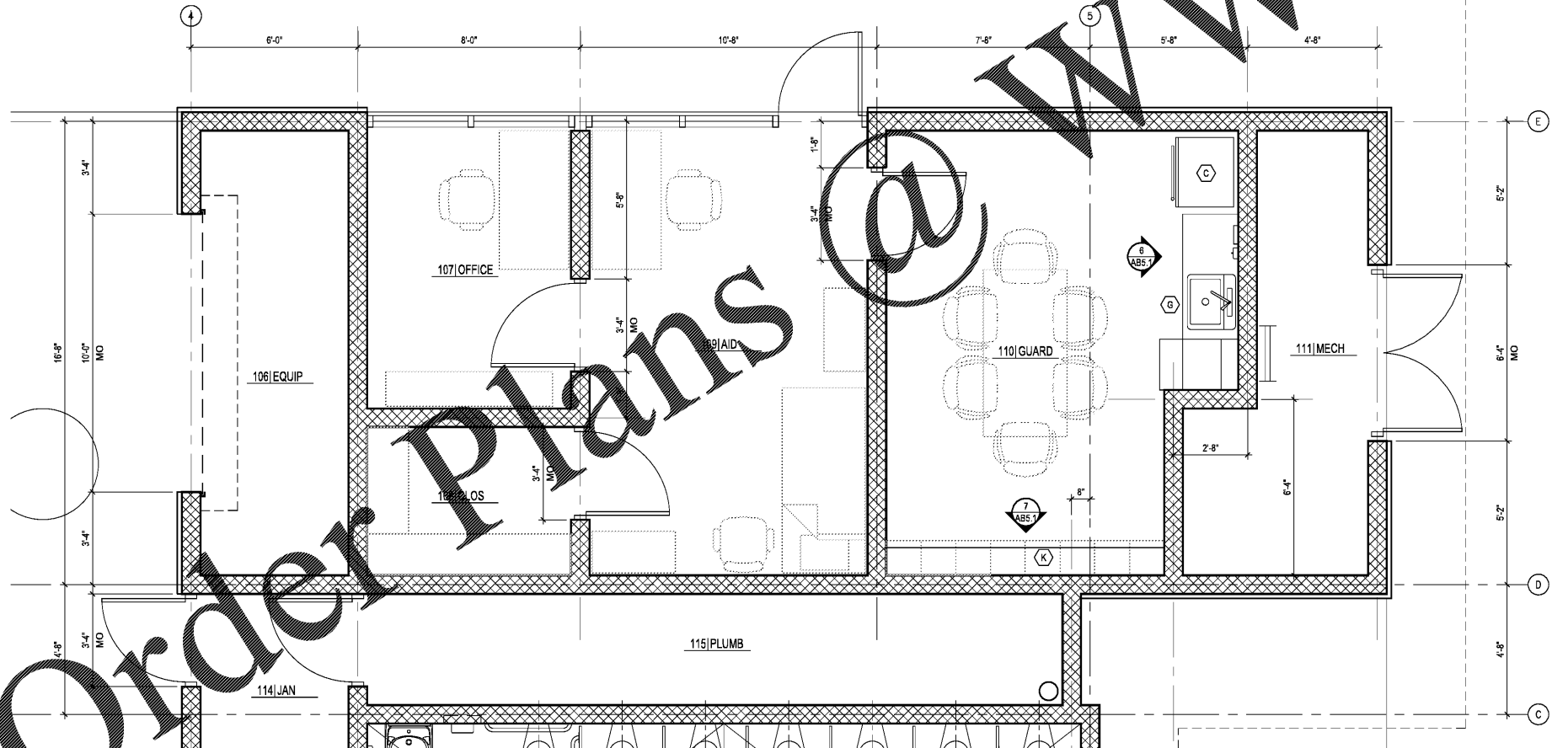

2 FLOOR PLAN - NORTHEAST QUADRANT
SCALE: 3/8" = 1'-0"

DRAWING LEGEND

- XXXX ROOM TAG. SEE FINISH SCHEDULE THIS SHEET.
- DOOR TAG. SEE DOOR SCHEDULE THIS SHEET.
- X WINDOW FRAME TAG. SEE WINDOW SCHEDULE THIS SHEET.
- DETAIL NUMBER ELEVATION OR SECTION CALL-OUT DETAIL SHEET.
- X SPECIFIC NOTE TAG.

WALL LEGEND

- CONC MASONRY WALL. SEE STRUCT. GENERAL NOTES THIS SHEET.

SPECIFIC NOTES

- 1 BOX
- 2 ROOF ACCESS LADDER. SEE SPEC.
- 3 ROLLER SHADES. SEE SHEET AB8.2.

EQUIPMENT NOTES

- A FLAKE ICE MACHINE: MANATOWOC MODEL SF-400 ON B-420 BIN. BY OWNER
- B STAINLESS STEEL TRIPLE BOWL SINK. SEE PLUMB.
- C REFRIGERATOR / FREEZER - GE MODEL GTS18SCKSS 17.9 CU FT
- D PIZZA WARMER BY OWNER
- E STAINLESS STEEL SINGLE BOWL HAND WASH SINK. SEE PLUMB.
- F 18"W X 84"L FIXED SOLID PLASTIC BENCH BY LOCKER MANUFACTURER
- G STAINLESS STEEL SINGLE BOWL SINK. SEE PLUMB.
- H PRINTER ON COUNTER TOP. BY OWNER.
- J LOCKERS: (36) SOLID PLASTIC TWO-TIER 15"W X 30"H X 15"D ON 4" HIGH CONC HOUSEKEEPING PAD. SEE SHEET A-402a.
- K LOCKERS: (8) SOLID PLASTIC TWO-TIER 15"W X 2-6"H X 15"D ON 4" HIGH CONC HOUSEKEEPING PAD
- L PIZZA WARMER. BY OWNER
- M GLASS SWING DOOR REFRIGERATOR: TRUE FOOD SERVICE EQUIPMENT, INC. MODEL GDM-26
- N GLASS SWING DOOR FREEZER: TRUE FOOD SERVICE EQUIPMENT, INC. MODEL GDM-19T-F
- P GLASS DOOR REFRIGERATOR (UNDER COUNTER): TRUE FOOD SERVICE EQUIPMENT INC. MODEL TUC-48G-LP.
- Q HOT DOG GRILLER. BY OWNER.
- R POPCORN MACHINE - GOLD MODEL POP MAXX 14 OZ POPPER 2552
- S WALL-MOUNTED SLAT WALL. SEE SHEET A-501a.
- T MENU BOARD. OWNER PURCHASE, CONTRACTOR INSTALL.
- U UNDERCOUNTER ICEMAKER, HOSHIZAKI MODEL AM-50BAE-AD, CONTRACTOR INSTALL.
- V UNDERCOUNTER REFRIGERATOR, TRUE MODEL TUC-24-HC-FDG01 CONTRACTOR INSTALL.

GENERAL NOTES

1. PLAN DIMENSIONS INDICATING WALL LOCATIONS ARE TO CENTERLINE OF WALL CMU. TYP.
2. INSTALL CORE-FILL FOAM INSULATION IN ALL CAVITIES OF ALL CMU WALLS THAT SEPARATE AIR CONDITIONED SPACES FROM NON-AIR CONDITIONED SPACES INCLUDING THE BUILDING EXTERIOR. DRILL INJECTION HOLES THROUGH THE NON-AIR CONDITIONED OR EXTERIOR FACE-SIDE OF THE CMU WALLS RECEIVING INSULATION AND INJECT THE INSULATION INTO THE CMU CAVITIES PRIOR TO INSTALLING THE STONE AND STUCCO FINISHES ON THE EXTERIOR WALLS.
3. SEE REFLECTED CEILING PLAN SHEET AB2.1 FOR LOCATIONS OF CONC MASONRY WALLS WITH T/O CMU @ EL. 12'-8" AND CONC MASONRY WALLS WITH T/O CMU @ EL. 8'-8".

Kimley-Horn
2201 West Royal Lane, Suite 215, Irving, Texas 75063
Florida Registered Professional Engineer Firm #96
Florida Registered Landscape Architecture Firm LC-C000219
© 2017 KIMLEY-HORN AND ASSOCIATES, INC.

Jason Jensen
2017.12.15
16:09:12
-05'00"

BUTLER PARK
AQUATIC CENTER
CITY OF NORTH PORT, FL

BATHHOUSE BUILDING
ENLARGED FLOOR PLANS

Scale: AS SHOWN
Designed by: CD
Drawn by: CD
Checked by: JJ
Date: DECEMBER 2017
Project No. 4828501.4

SHEET
AB4.1