

FIRE PARTITION LEGEND

(1) HOUR FIRE WALL

LIFE SAFETY SYMBOLS

- EMERGENCY LIGHT
- LIGHTED EXIT SIGN
- EMERGENCY LIGHT/LIGHTED EXIT SIGN
- FIRE EXTINGUISHER (3A-40BC)

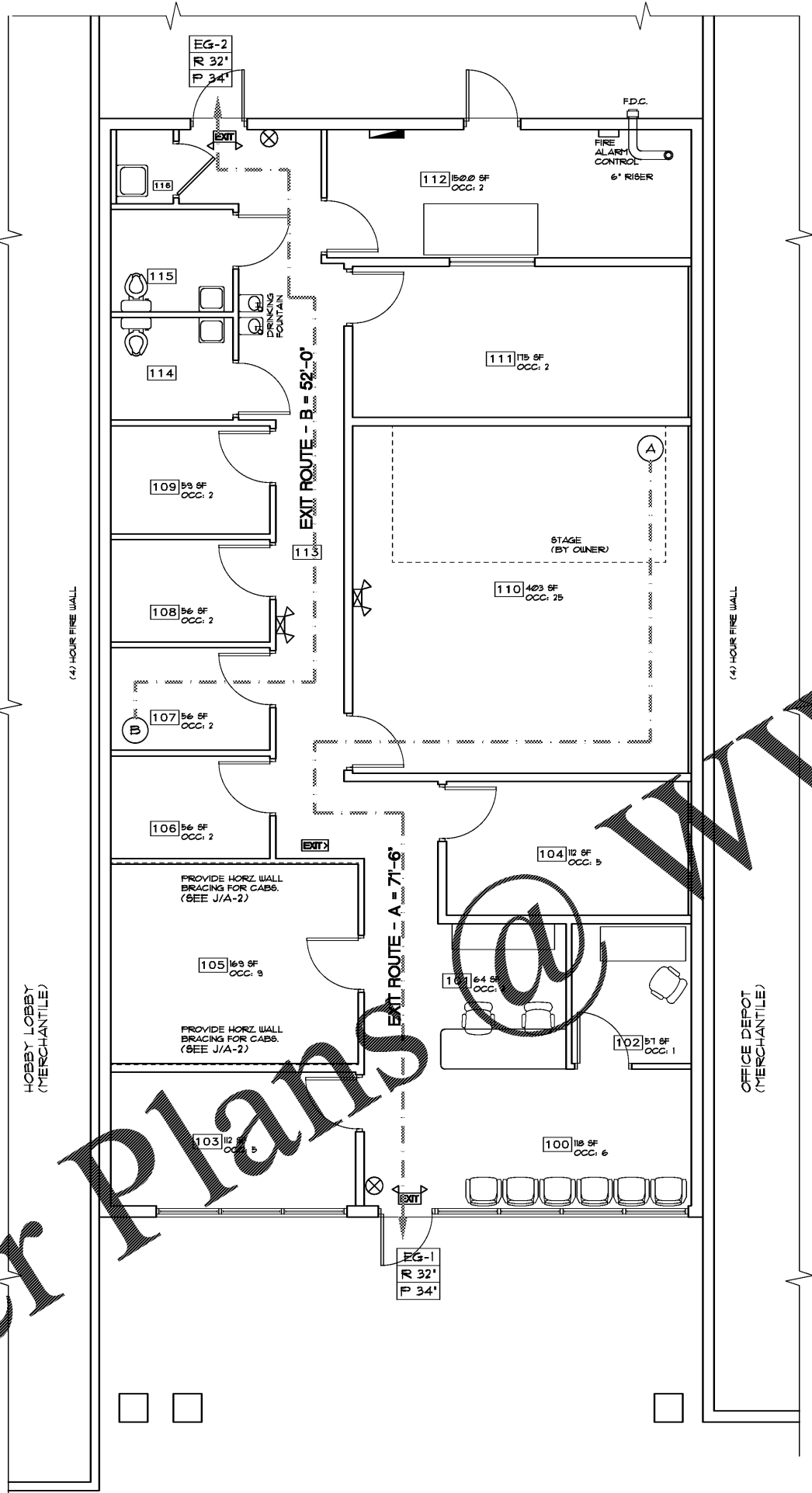

TYPE OF CONSTRUCTION:
ONE STORY
FULLY SPRINKLERED
CONSTRUCTION TYPE: TYPE II-B

TYPE II-B	ALLOWABLE	PROVIDED
BUILDING AREA	9,000 SF.	3,604 SF.
BUILDING HEIGHT ABV. GRADE	40 FEET	25.3 FEET

ZONING DESIGNATION:
COMMERCIAL

- CODES USED FOR BUILDING DESIGN:
- FLORIDA BUILDING CODE: BUILDING, 6th Edition (2017)
 - FLORIDA BUILDING CODE: EXISTING BUILDING, 6th Edition (2017)
 - FLORIDA BUILDING CODE: PLUMBING, 6th Edition (2017)
 - FLORIDA BUILDING CODE: MECHANICAL, 6th Edition (2017)
 - FLORIDA BUILDING CODE: FUEL GAS, 6th Edition (2017)
 - FLORIDA BUILDING CODE: ACCESSIBILITY, 6th Edition (2017)
 - 2014 NATIONAL ELECTRICAL CODE
 - 2015 LIFE SAFETY CODE, NFPA 101
 - FLORIDA FIRE PREVENTION CODE 6th EDITION (2017)

SQUARE FOOTAGE:

AREAS (SF)		TOTAL
BUILDING TOTAL:		2,273

OCCUPANCY CLASSIFICATION:
OCCUPANCY: BUSINESS - B-1
USE: TUTORING MUSIC

OCCUPANCY USE CALCULATIONS:

USE	GROSS AREA (SF)	FLOOR AREA PER OCCUPANT (SF)	OCCUPANTS
BUSINESS	2,273	100 GROSS	23
MAX. OCCUPANCY BY AREA:			23

USE	NET AREA (SF)	SEATS/OCCUPANTS	
OFFICE/REC/CONTROL	265	5	
TUTORING ROOMS	1,241	54	
WAITING	115	6	
MAX. OCCUPANCY BY ROOM USE:			65

PLUMBING FIXTURE CALCULATIONS:
UNIT 1

WATER CLOSETS:	REQUIRED	PROVIDED
MALE (1 PER 25)	1	1
FEMALE (1 PER 25)	1	1

LAVATORIES:	REQUIRED	PROVIDED
MALE (1 PER 40)	1	1
FEMALE (1 PER 40)	1	1

WATER FOUNTAINS:	REQUIRED	PROVIDED
(1 PER 100)	1 (H/L/O)	1 (H/L/O)

SERVICE SINK:	REQUIRED	PROVIDED
	1	1

MEANS OF EGRESS:

	ALLOWABLE	PROVIDED
EGRESS WIDTH/OCCUPANT (1005.3.2):	02'	(32" MIN.)
MIN. CLEAR OPENING OF EXIT DR. (1010.1.1):	32"	34"
COMMON PATH OF TRAVEL (1006.2.1):	75'	N/A
MAX TRAVEL DISTANCE (1017.2):	200'	83'
CORRIDOR/AISLE FIRE RATING (1020.1):	(1) HR (COVER OCC.)	N/A
MIN. CORRIDOR/AISLE WIDTH (1020.2):	44"	N/A
MAX. DEAD END (1020.4):	20'	10'
MIN. NO. OF EXITS (1006.1):	1 (PER UNIT)	3

EGRESS WIDTH PER OCCUPANT:
TOTAL REQUIRED (1005.1): 32' WIDTH (MIN.)

EG-#	CLEAR WIDTH	EG-1 (MAIN)	EG-2 (REAR)
REQ.		32'	32'
PROV.		32'	32'

PROJECT
Bach to Rock
3609 Lake Emma Road
Lake Mary, Florida

ARCHITECT
GERALD GROSS AIA, FARA
Architect
205T North Ibis Drive
Briny Breezes, Florida 33453
386.574.9088
FL REG. ARCHITECT NO. AR0005998

GENERAL CONTRACTOR
EDC Group
Build Maintain Optimize
755 RINEHART ROAD, STE. 200
LAKE MARY, FLORIDA 32746

INDEX

A-1	LIFE SAFETY PLAN/COVER PAGE
A-2	FLOOR PLAN and WALL SECTION
A-3	REFLECTIVE CEILING PLAN INTERIOR ELEVATION
E-1	ELECTRICAL PLAN
M-1	MECHANICAL PLAN
M-2	MECHANICAL NOTES
P-1	PLUMBING SEWER PLAN
S-1	DETAILS
S-1	SPEC DETAILS

DESIGNER HEREBY EXPRESSLY RESERVES HIS COPYRIGHT AND OTHER PROPERTY RIGHTS IN THESE PLANS. THESE PLANS, DRAWINGS AND OTHER PROPERTY RIGHTS ARE NOT TO BE REPRODUCED, CHANGED OR COPIED IN ANY FORM OR MANNER WHATSOEVER, NOR ARE THEY TO BE ASSIGNED TO ANY PARTY WITHOUT FIRST OBTAINING THE EXPRESSED WRITTEN PERMISSION AND SIGNATURE OF GERALD R. GROSS ARCHITECT.

REVISIONS

VERSION - 5

LIFE SAFETY PLAN
BACH TO ROCK
Lake Mary Florida

GERALD R. GROSS
AIA, FARA
205T North Ibis Drive
Briny Breezes, Florida 33453
386-574-9088
FL REG. ARCHITECT
NO. AR0005998

PROJECT NO.:
edc-BACH2ROCK5A1
DATE:
2 FEB 2016
DRAWN BY:
TTL

SHEET NO.:
A-1

Order Plans @ WWW.EDC.COM