

NOTE:
THIS PLAN IS PART OF AN OVERALL SET OF PLANS. THIS SHEET IS CONSIDERED INVALID UNLESS ACCOMPANIED BY ALL OTHER DRAWINGS IN THE SET OF PLANS ON THE JOB SITE OR FOR BIDDING PURPOSES. THE GENERAL CONTRACTOR SHALL BE RESPONSIBLE FOR PROVIDING A COMPLETE SET OF PLANS TO ALL THOSE CONDUCTING WORK ON THIS PROJECT.

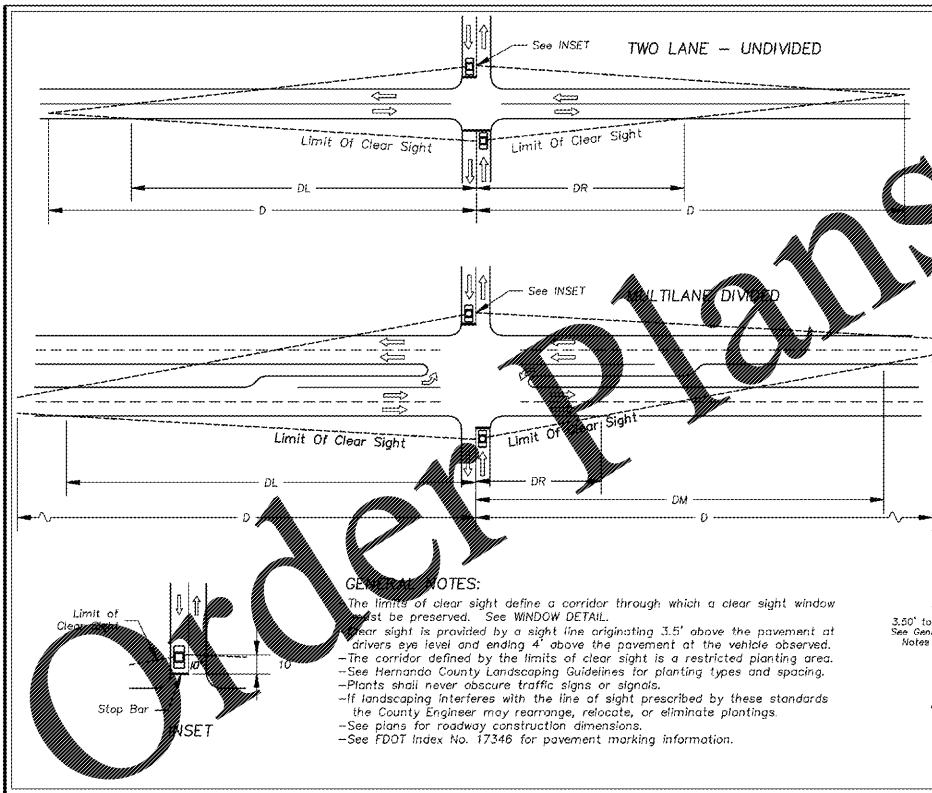

Design Speed (MPH)	D	DL	DR	DM
30	380'	290'	120'	300'
35	470'	370'	150'	370'
40	580'	450'	180'	460'
45	710'	550'	220'	560'
50	840'	650'	260'	670'
55	990'	760'	300'	780'
60	1150'	890'	360'	910'

Design Speed (MPH)	D	DL	DR	DM
30	380'	290'	120'	300'
35	470'	370'	150'	370'
40	580'	450'	180'	460'
45	710'	550'	220'	560'
50	840'	650'	260'	670'
55	990'	760'	300'	780'
60	1150'	890'	360'	910'

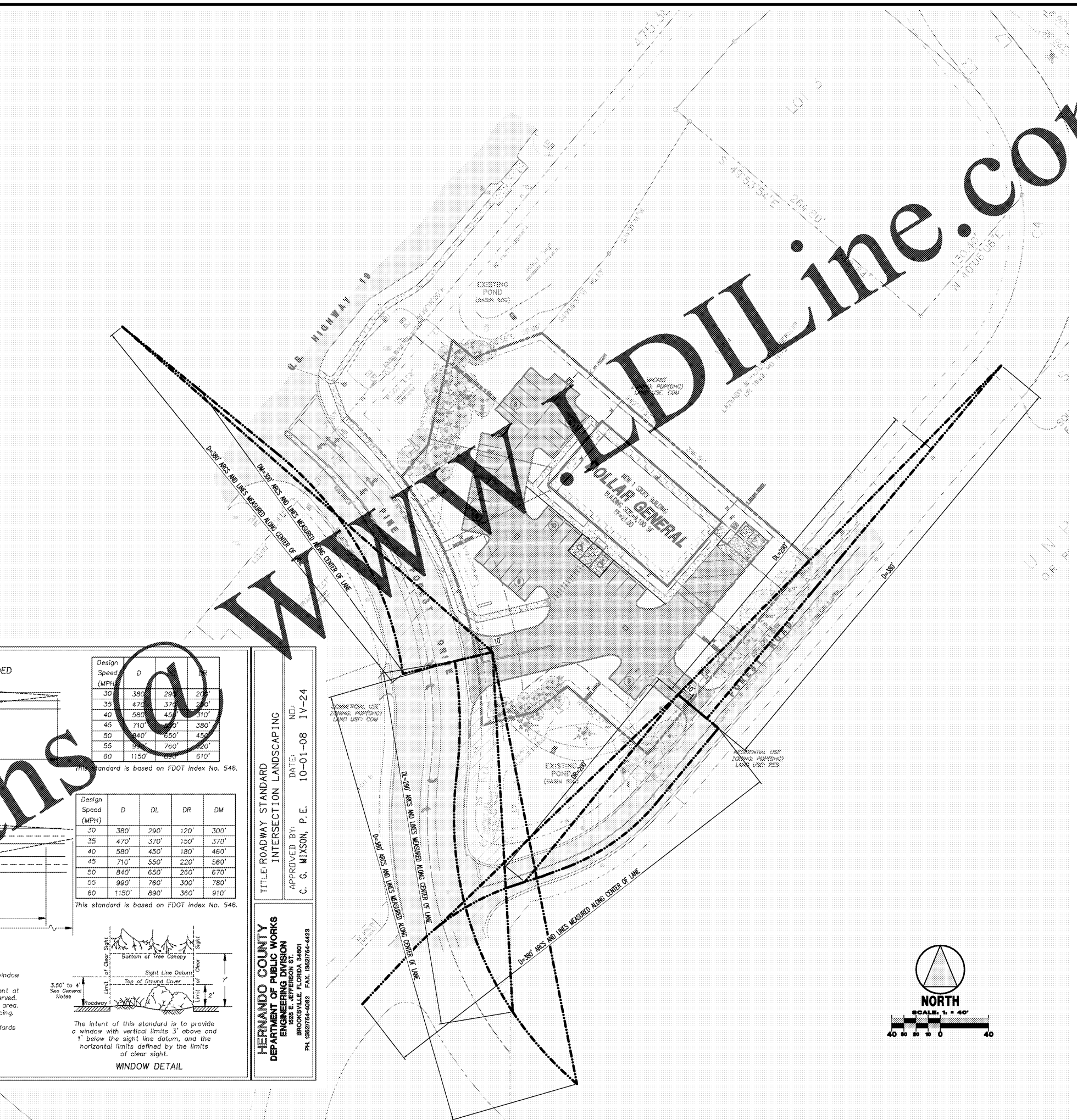
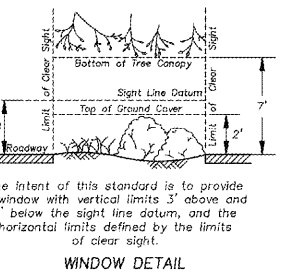

GENERAL NOTES:
The limits of clear sight define a corridor through which a clear sight window must be preserved. See WINDOW DETAIL.
Clear sight is provided by a sight line originating 3.5' above the pavement at driver's eye level and ending 4' above the pavement at the vehicle observed.
The corridor defined by the limits of clear sight is a restricted planting area.
See Hernando County Landscaping Guidelines for planting types and spacing.
Plants shall never obscure traffic signs or signals.
If landscaping interferes with the line of sight prescribed by these standards, the County Engineer may rearrange, relocate, or eliminate plantings.
See plans for roadway construction dimensions.
See FDOT Index No. 17346 for pavement marking information.

TITLE: ROADWAY STANDARD INTERSECTION LANDSCAPING
APPROVED BY: [Signature] DATE: 10-01-08 IV-24
C. G. MIXSON, P. E.
HERNANDO COUNTY DEPARTMENT OF PUBLIC WORKS ENGINEERING DIVISION
825 E. JEFFERSON ST. BROOKSVILLE, FLORIDA 34401
PH: (827)64-4482 FAX: (827)64-4423

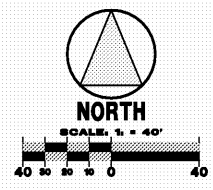

www.dline.com

PROJECT TITLE DOLLAR GENERAL SEC US 19 AND PINE FOREST DRIVE HERNANDO COUNTY, FL	SHEET TITLE VISIBILITY TRIANGLE PLAN	SHEET No. VT.1	DATE 10/21/17															
<p style="text-align: center;">PALMETTO CAPITAL GROUP, INC.</p> <p style="font-size: 8pt;">T.A. Civil, Inc. Certificate of Authorization # 00029995 PO BOX 7649 Clearwater, Florida 33758-7649 Phone: 727-446-9000</p>		<p style="font-size: 8pt;">Professional Engineer 50035 FL Reg No.</p>																
<p style="font-size: 8pt;">Revisions</p> <table border="1" style="width: 100%; border-collapse: collapse;"> <tr><th>No.</th><th>Date</th><th>By</th></tr> <tr><td>1</td><td>02/12/18</td><td>AVF</td></tr> <tr><td>2</td><td></td><td>AVF</td></tr> <tr><td>3</td><td></td><td>AVF</td></tr> <tr><td>4</td><td></td><td>AVF</td></tr> </table>		No.	Date	By	1	02/12/18	AVF	2		AVF	3		AVF	4		AVF	<p style="font-size: 8pt;">CADD Tech AVF Designer AVF Engineer SAL</p>	
No.	Date	By																
1	02/12/18	AVF																
2		AVF																
3		AVF																
4		AVF																