

NOTE:
THIS PLAN IS PART OF AN OVERALL SET OF PLANS. THIS SHEET IS CONSIDERED INVALID UNLESS ACCOMPANIED BY ALL OTHER DRAWINGS IN THE SET OF PLANS ON THE JOB SITE OR FOR BIDDING PURPOSES. THE GENERAL CONTRACTOR SHALL BE RESPONSIBLE FOR PROVIDING A COMPLETE SET OF PLANS TO ALL THOSE CONDUCTING WORK ON THIS PROJECT.

- HANDICAP ACCESSIBILITY DESIGN NOTES:**
- ALL DESIGN WITHIN THE HANDICAP ACCESSIBLE ZONES SHALL COMPLY WITH FEDERAL AND LOCAL ADA STANDARDS. THE FOLLOWING CRITERIA IS PROVIDED AS A GUIDE AND BASIS FOR DESIGN CONTAINED HEREIN. QUOTED RULES ARE FROM "ADA STANDARDS FOR ACCESSIBLE DESIGN". ANY LOCAL JURISDICTIONAL RULES THAT EXCEED ADA CODE MUST ALSO BE COMPLIED WITH AND IS DESIGNED ON THIS PLAN ACCORDINGLY.
 - APPLICABLE RULES ARE NOT LIMITED TO CRITERIA CONTAINED HEREIN AND IS ONLY PROVIDED FOR CONVENIENCE AND IS ONLY AS A GENERAL REFERENCE.
 - IT IS THE CONTRACTOR'S RESPONSIBILITY TO ASSURE MINIMUM ACCESSIBILITY RULES ARE MET ALONG THE HANDICAP ROUTE(S). CRITERIA FOR CONSTRUCTION IS NOT LIMITED TO THESE NOTES OR THE PLAN. REFER TO ADA CODE AND LOCAL CODE FOR ADDITIONAL INFORMATION.
 - REFER TO BUILDING PLANS FOR HANDICAP DESIGN RELATIVE TO THE BUILDING. ANY DESIGN THAT DOES NOT CORRESPOND, MATCH OR OTHERWISE COMPLY WITH THE SITE DESIGN CONTAINED IN THESE PLANS MUST BE REPORTED TO THE ENGINEER OF RECORD AND BUILDING DESIGNER BEFORE CONDUCTING RELATIVE WORK.
 - MAXIMUM SLOPES:
 CROSS SLOPE OF ROUTE: 2% PERPENDICULAR TO RUN (405.3 ADA)
 DESIGNATED RAMP: 1:12 ALONG RUN (405.2 ADA)
 2% PERPENDICULAR TO RUN (405.3 ADA)
 RUNNING SLOPE OF ROUTE: 5% ALONG RUN (403.3 ADA)
 CROSS SLOPE OF LANDINGS: 2% IN BOTH DIRECTIONS (405.7.1 ADA)
 CROSS SLOPE OF PARKING: 2% IN BOTH DIRECTIONS (502.4 ADA)
 COUNTER SLOPES AT RAMP: 1:20 AT RAMP/PAVE TRANSITION (406.2 ADA)
 - CHANGES IN LEVEL SHALL NOT EXCEED 1/4" VERTICALLY (303.2 ADA). REFER TO BUILDING PLANS WHERE ACCESSIBLE ROUTE LEADS TO DOORS AND OTHER BUILDING FEATURES.
 - CHANGES IN LEVEL EXCEEDING 1/2" SHALL BE RAMPED (303.4 ADA).
 - RAMP RISES:
 MAXIMUM RAMP RISE BETWEEN LANDINGS SHALL NOT EXCEED 30" (405.6 ADA)
 RISES LESS THAN OR EQUAL TO 6" DO NOT REQUIRE HANDRAILS (405.8 ADA)
 - LANDINGS MEASURING A MINIMUM 60" X 60" SHALL BE PROVIDED AT CHANGES IN DIRECTION (405.7.4 ADA).
 - LANDINGS SHALL BE PROVIDED AT THE TOPS OF CURB RAMP. THE LANDING CLEAR LENGTH ALONG RUN SHALL BE 36" MINIMUM AND BE AT LEAST AS WIDE AS THE RAMP IT SERVES (405.4 ADA).
 - CLEAR WIDTHS AND LENGTHS:
 CLEAR WIDTHS OF WALKING SURFACES SHALL BE 36" MINIMUM (403.5.1 ADA)
 CLEAR WIDTHS BETWEEN HANDRAILS AT RAMP SHALL BE 36" MINIMUM (405.5 ADA)
 LANDING WIDTHS SHALL MATCH THE WIDTH OF THE RAMP IT SERVES (405.7.2 ADA)
 LANDING LENGTHS SHALL BE 60" MINIMUM (405.7.3 ADA)

NEW 1 STORY BUILDING
DOLLAR GENERAL
 BUILDING SIZE = 9,000 SF
 FF = 21.00

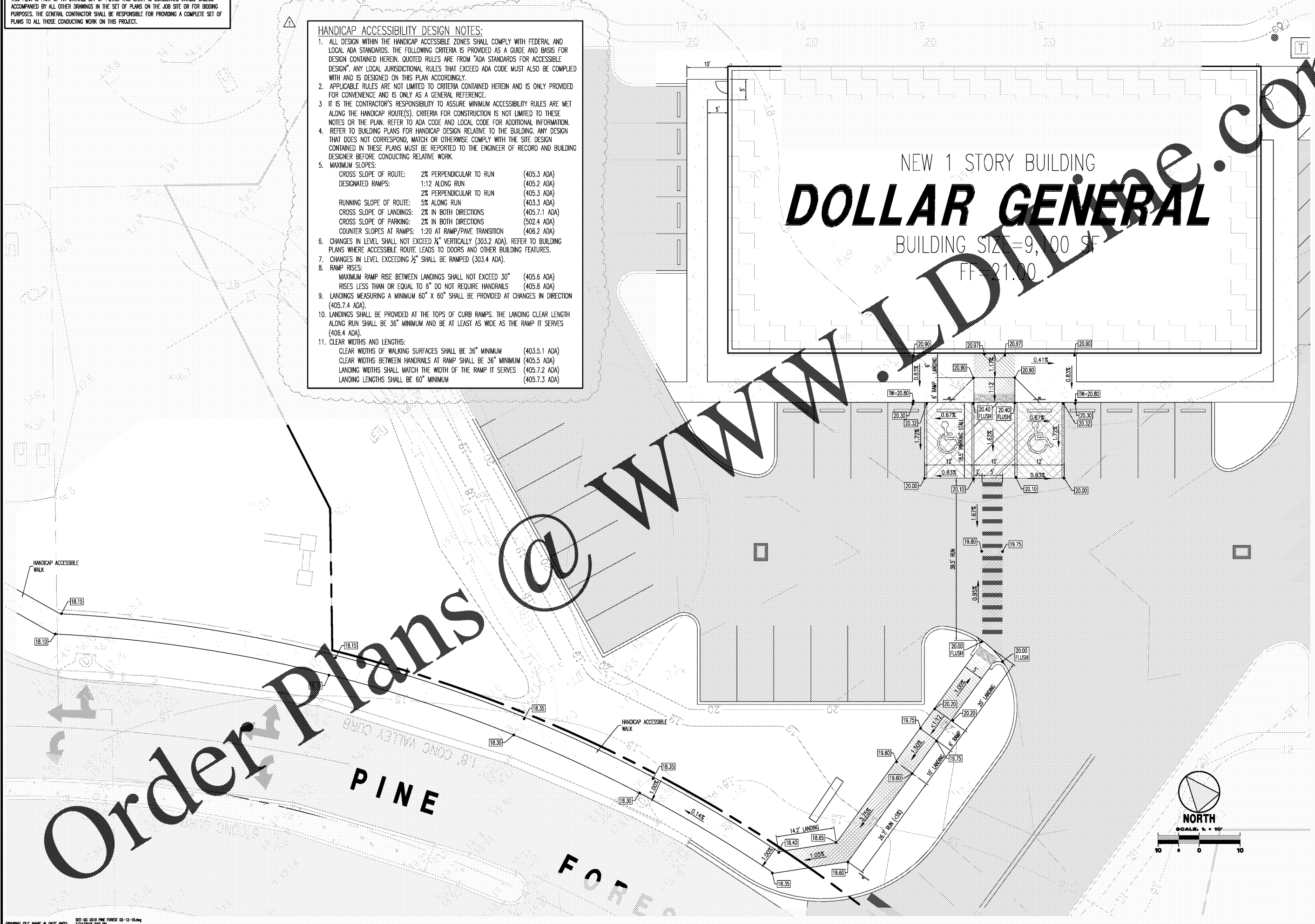

Order Plans @ www.JDPlans.com

Revisions	By	Date
1	AVF	02/12/18
2	AVF	
3	AVF	
4	AVF	

CADD Tech	AVF	Project No.	
Designer	AVF	Scale	
Engineer	SAL	Date	10/21/17

PALMETTO CAPITAL GROUP, INC.
 I.A. Civil, Inc.
 Certificate of Authorization # 00029995
 PO BOX 7649
 Clearwater, Florida 33758-7649
 Phone: 727-446-9000

DOLLAR GENERAL
 SEC US 19 AND PINE FOREST DRIVE
 HERNANDO COUNTY, FL

HANDICAP ACCESSIBILITY PLAN

SHEET No.
C3.3