

D:\VAEG Backup\From Drive C\Wlers Engineering Group\Projects\DSE OE-1 Rainbow Rascals Childcare\Elec\DSE_OE1_ELEC.dwg, 9/14/2017 12:23:46 PM

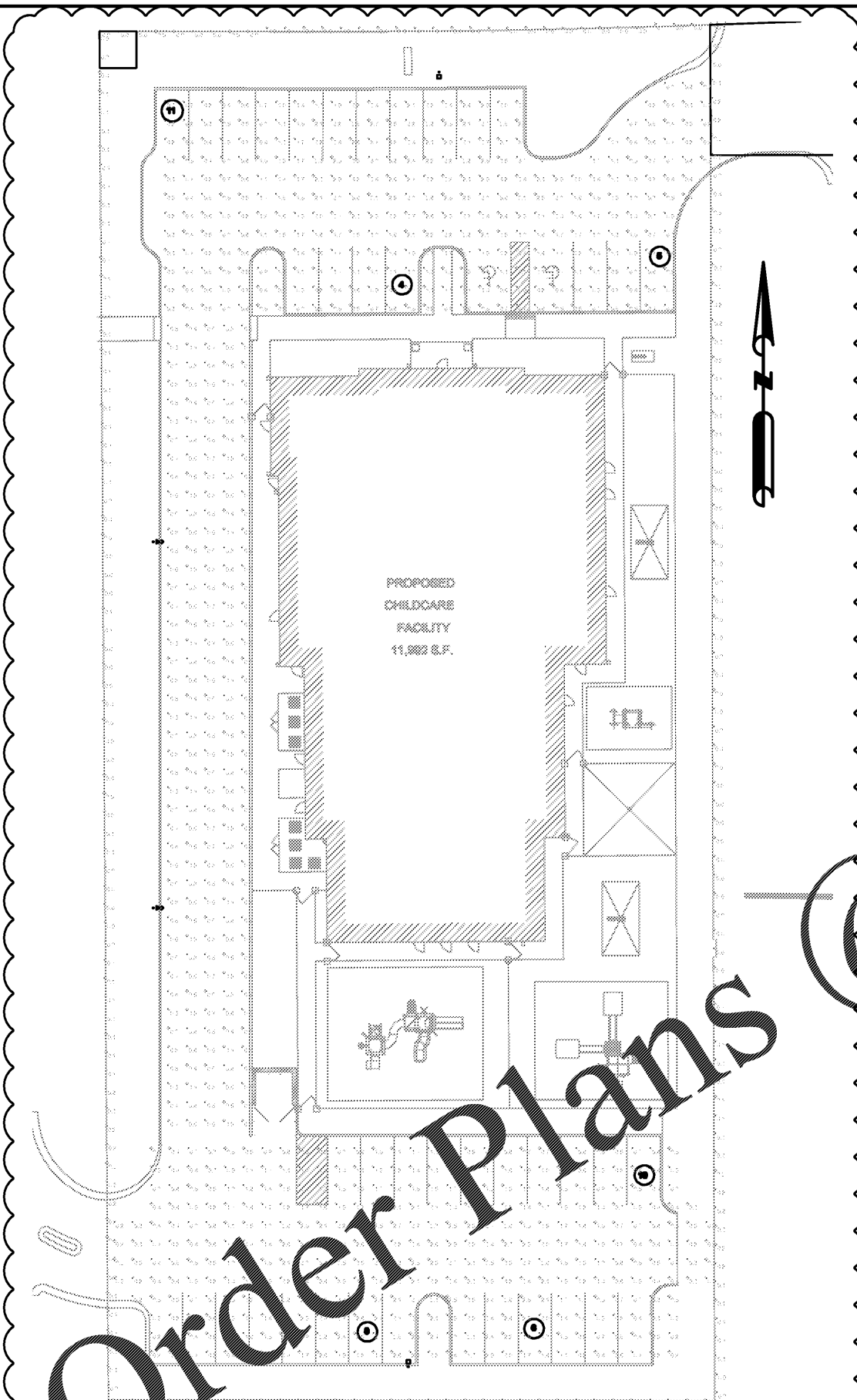

CIMARRON LED

ORDERING INFORMATION (SEE NEXT PAGE)

SPALLING LIGHTING

APPROXIMATE LIGHTING

ORDERING INFORMATION (SEE NEXT PAGE)

SPALLING LIGHTING

APPROXIMATE LIGHTING

ORDERING INFORMATION (SEE NEXT PAGE)

SPALLING LIGHTING

APPROXIMATE LIGHTING

CIMARRON LED CL1S

ORDERING INFORMATION (SEE NEXT PAGE)

SPALLING LIGHTING

APPROXIMATE LIGHTING

ORDERING INFORMATION (SEE NEXT PAGE)

SPALLING LIGHTING

APPROXIMATE LIGHTING

ORDERING INFORMATION (SEE NEXT PAGE)

SPALLING LIGHTING

APPROXIMATE LIGHTING

Statistics

Description	Symbol	Max	Avg	Min	Max/Min	Avg/Min
DRIVEWAY	+	0.8 fc	0.4 fc	0.2 fc	4.0:1	2.0:1
NORTH PARKING	+	3.7 fc	1.0 fc	0.2 fc	18.5:1	7.0:1
PROPERTY LINE	+	0.3 fc	0.1 fc	0.0 fc	N/A	N/A
SOUTH PARKING	+	3.8 fc	1.4 fc	0.2 fc	19.0:1	7.0:1

REVIS 60. THE SITE LIGHTING EXCEEDS 0.5 CANDLES AT THE PROPERTY LINE ALONG THE SOUTHWEST, SOUTHWEST AND NORTHEAST CORNERS OF THE PROPERTY.

REVIS 76. MAXIMUM HEIGHT OF A LIGHT POLE IS 25'. PLAN SHOWS 30'.

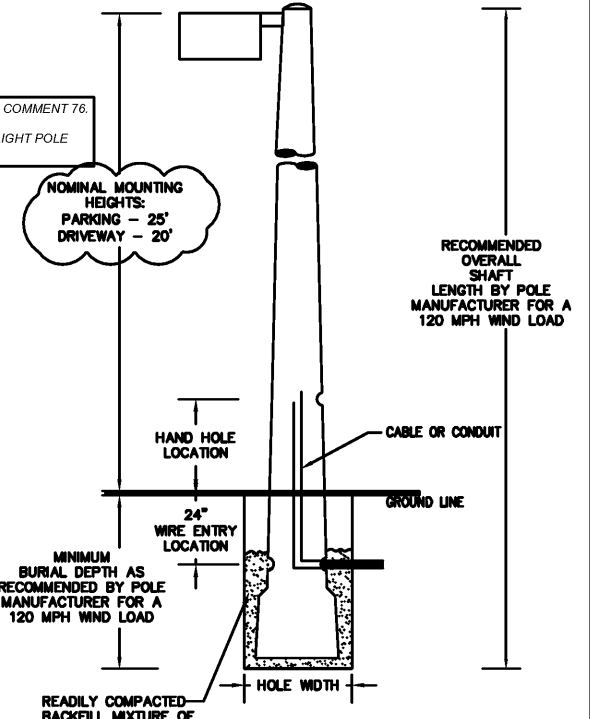

DIRECT BURIAL CONCRETE POLE DETAIL

NOTE:

1. PROVIDE PRESTRESS, CONCRETE POLE FOR DIRECT BURIAL APPLICATION.
2. COORDINATE EXACT LOCATION OF POLES WITH LANDSCAPE AND SITE CONTRACTOR PRIOR TO INSTALLATION OF SITE LIGHTING POLES, NOTIFY ENGINEER OF CONFLICTS.

REVIS 60. THE SITE LIGHTING EXCEEDS 0.5 CANDLES AT THE PROPERTY LINE ALONG THE SOUTHWEST, SOUTHWEST AND NORTHEAST CORNERS OF THE PROPERTY.

Order Plans

DAVE SCHMITT ENGINEERING, INC.
3680 AVALON PARK EAST BLVD. SUITE 310
ORLANDO, FL 32828
407-207-9088 FAX 407-207-9089
Certification of Authorization #27471

CONTRACTOR'S AFFIDAVIT

I hereby state that these "As-Builts" were furnished to me by the contractor listed below. I, or an employee under my direct supervision have reviewed these "As-Builts" and believe them to be in compliance with my knowledge of what was actually constructed. This statement is based upon site observations of the construction.

Contractor: _____ Engineer: _____
Not valid without the signature and the original raised seal of a Florida Registered Engineer.

REVISIONS

DATE	BY	DESCRIPTION	DATE	BY	DESCRIPTION
09/28/17	NVA	PLANS REVIEW COMMENTS			

WELERS ENGINEERING GROUP, LLC
C.A. #26055
13807 CAYWOOD POND DRIVE
WINDERMERE, FLORIDA 34786
T-407-721-1146
ALERT@WELERSGROUP.COM

NOT FOR CONSTRUCTION - FOR PD SUBMITTAL ONLY

Rainbow Rascals Childcare
Lake Mary Blvd and east side of S. 5th Street
SITE LIGHTING PLAN

DATE: JULY 2017
PROJECT NO.: DSERAS01
DRAWN BY: NVA
CHECKED BY: NVA
SCALE: 1"=30'
SHEET: EL1