

2 COOLER WALL CLOSURE DTL.
SCALE: NONE

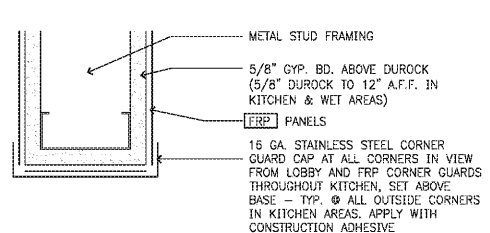

3 CORNER GUARD DTL.
SCALE: 3/4" = 1'-0"

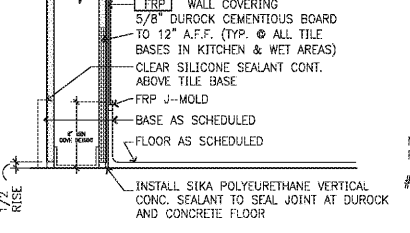

4 TILE BASE DETAIL
SCALE: 1 1/2" = 1'-0"

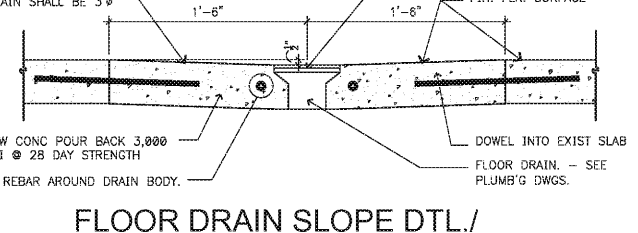

5 FLOOR DRAIN SLOPE DTL./ TRENCH DRAIN DETAIL (SIM.)
SCALE: 1 1/2" = 1'-0"

FINISH SPECIFICATIONS:

- FLOORS:**
- F1 VINYL PLANK FLOORING: ARMSTRONG - NATURAL CREATIONS ARBORART - TP041 NOUVEAU MAPLE LIGHT NATURAL 4" X 36". INSTALL AT 45 DEGREE ANGLE. ORDER PRODUCT THROUGH ADLETA AT 972.820.5600 (CONTACT: THERESA BROWN) - NOTHING BUNDT CAKE'S CORPORATE ACCOUNT, CREDIT CARD PURCHASE ONLY. (TYPICAL LEAD TIME IS APPROX. 10-14 BUSINESS DAYS)
 - F2 IGO - QUARTZ TROWELLED EPOXY FLOORING, COLOR IGO QUARTZ #503, INTERNATIONAL COATING INC. - 1.800.624.8919 OR WWW.INTERNATIONALCOATINGS.COM
 - F3 SUNBELT 1100 RESINOUS EPOXY FLOOR SEAMLESS TROWEL SYSTEM, COLOR: BROWN G.C. TO COORDINATE SCHEDULING WITH ADEQUATE ADVANCED NOTICE PRIOR TO FLOOR INSTALLATION (APPROX. 2-3 WEEKS). INSTALLATION AND PRODUCT PROVIDED BY SUNBELT FLOOR. CONTACT: SUNBELT FLOORING AT 908.608.7623
 - F4 QUARRY TILE: DAL'TILE - 6"x6" 0078 GOLDEN BROWN PAVER, SMOOTH SURFACE, GROUT SPECTRALOCK - COLOR #43 CHOCOLATE TRUFFLE
 - F5 SEALED CONCRETE. CONFIRM SELECTION WITH OWNER.
- BASE:**
- B1 INTEGRAL WOOD BASE: PART OF WAINSCOTING KIT (WC-1). PAINT (PT-1)
 - B2 6" INTEGRAL BASE SUNBELT 1100, TROWEL SYSTEM, COLOR - BROWN
 - B3 COVE VINYL BASE - ARMSTRONG, #81 GRAPHITE GREY, 1/8" X 3/4". CONFIRM SELECTION W/OWNER
 - B4 QUARRY TILE BASE: DAL'TILE 6"x6" 0078 GOLDEN BROWN PAVER, SMOOTH SURFACE, GROUT SPECTRALOCK - COLOR #43 CHOCOLATE TRUFFLE
 - ALU PRE-FAB. FREEZER UNIT: INSULATED FACTORY FLOORING AND BASE
- WALLS:** NO ALTERNATES ARE ACCEPTABLE
- FRP FRP GLASS REINFORCED PANELS: 'MARLITE' FRP, FINE PEBBLED #P100, COLOR - WHITE, FULL HEIGHT TO 10'-0" A.F.F. (U.N.O.). PROVIDE ALL NECESSARY TRIMS AND ACCESSORIES. 'MARLITE' FRP WITH #5100 S/2 (S. CO.) WHITE BEHIND BAKING AREA ONLY.
 - WC-1 RAISED PANEL WAINSCOT: CONTRACTOR PROVIDED MILLWORK OR KITCHEN EQUIPMENT SUPPLIER PROVIDED MILLWORK AS DETAILED IN SECTION 9/AS.0, PAINT (PT-4) - LOCATION: LOBBY WALLS
 - WC-2 RAISED PANEL WAINSCOT: CONTRACTOR PROVIDED MILLWORK OR KITCHEN EQUIPMENT SUPPLIER PROVIDED MILLWORK AS DETAILED IN SECTIONS SHT. A5.0, PAINT (PT-4) - LOCATION: P.O.S. INTER MILLWORK
 - PT-1 PAINT: 'SHERWIN-WILLIAMS' SW7008 - ALABASTER, SEMI-GLOSS W/ ONE COAT LATEX PRIMER BASE.
 - PT-2 PAINT: 'SHERWIN-WILLIAMS' SW6103 - TEA CHEST, LOW SHEEN W/ ONE COAT LATEX PRIMER BASE.
 - PT-3 PAINT: 'SHERWIN-WILLIAMS' SW6688 - SOLARIA, LOW SHEEN W/ ONE COAT LATEX PRIMER BASE.
 - PT-4 PAINT: 'SHERWIN-WILLIAMS' SW7008 - ALABASTER, SEMI-GLOSS W/ ONE COAT LATEX PRIMER BASE.
 - ALU PRE-FAB. FREEZER UNIT: INSULATED FACTORY WALLS & CEILING.
 - SS STAINLESS STEEL PANEL
- CEILING:**
- ACT-1 VINYL CLAD GYP. BD. CEILING TILES: 'ARMSTRONG' VINYL CLAD #BP670, 2'x4'x5/8". VINYL CLAD, CEILING TILES W/ 15/16" PRELUDE XL 'T' BAR GRID, COLOR - WHITE.
 - ACT-2 ACOUSTIC CEILING TILE: 'ARMSTRONG' LEDGES I, SINGLE RAISED PANEL #8013, 2'x2'x5/8" LAY-IN TILE, FLUSH REGULAR, NON-PERFORATED W/ 15/16" PRELUDE 'T' BAR GRID, COLOR - WHITE. (THIS PRODUCT IS A LONG LEAD TIME ITEM)
 - GYP. GYPSUM BOARD: 5/8" TYPE 'X' GYPSUM BOARD, PAINT, REF. RCP SECTIONS.
- ARMSTRONG NATIONAL ACCOUNT PROGRAM - FOR PRICING PLEASE CONTACT ARMSTRONG NATIONAL ACCOUNT CUSTOMER SERVICE 1.800.442.4212. ACCOUNT QUESTIONS, PLEASE CONTACT DEBORAH PICKENS (480.695.9053) DR DPICKENS@ARMSTRONGCEILINGS.COM
- MISC:**
- PL-1 PLASTIC LAMINATE: 'WILSONART' #1572-60, ANTIQUE WHITE (CRAFTING COUNTER / DESK / EMPLOYEE TABLE)
 - WSS WILSONART SOLID SURFACE #1573 MG OR EQ. (POS STATIONS & SURROUNDS / BACK COUNTER)

MISC. FINISH DETAILS

GENERAL NOTES:

- REFER TO WALL SECTIONS AND ELEVATIONS FOR ADDITIONAL INFORMATION AND REQUIREMENTS.
- INTERIOR WALL AND CEILING FINISH MATERIALS SHALL BE INSTALLED IN ACCORDANCE WITH ALL APPLICABLE CODES.
- ALL FINISHES SHALL MEET FLAME SPREAD AND SMOKE DEVELOPMENT RATINGS FOR THEIR USE, AS REQUIRED BY LOCAL CODES.
- TAPE, BED, FLOAT & SAND GYP BD JOINTS. FINISH TO A LITE ROLLED TEXTURE AT ALL PAINTED AREAS. PAINT (1) COAT OF PRIMER AND (2) COATS OF COLOR.
- WALLS & CEILING: SMOOTH, DURABLE, NONABSORBENT, WASHABLE. (EXCEPTION: UNOPENED FOOD PRODUCT AT STORAGE AND SALES AREAS)
- G.C. SHALL PROVIDE WOOD BACKING FOR ALL WALL MOUNTED / RECESSED ITEMS (U.N.O.). ANY AND ALL WOOD USED WITHIN WALLS OR ABOVE FINISH CEILINGS SHALL BE FIRE-RETARDANT, TREATED WOOD.
- G.C. SHALL CAULK JOINT BETWEEN CEILING GRID & FRP WALL PANELS IN ALL KITCHEN AREAS.
- G.C. SHALL PREP AND MAKE SMOOTH EXISTING CONCRETE SLAB PRIOR TO NEW FLOOR FINISH INSTALLATION.
- ALL HOLLOW METAL DOORS AND FRAMES (U.N.O.), SHALL BE PRIMED & PAINTED
- CHANGES IN LEVEL UP TO 1/4" BETWEEN DIFFERENT FLOOR FINISHES CAN BE MADE VERTICAL AND WITHOUT EDGE TREATMENT. CHANGES IN LEVEL OF 1/4" - 1/2" SHALL BE MADE WITH A BEVELED TRANSITION OR OTHER MATERIAL WITH A SLOPE NO GREATER THAN 1:2. CHANGES IN LEVEL GREATER THAN 1/2" SHALL BE ACCOMPLISHED BY MEANS OF A RAMP. VERIFY FINISH OF TRANSITION STRIP MATERIAL WITH OWNER. G.C. SHALL FURNISH & INSTALL RUBBER TRANSITION STRIP WHERE KITCHEN FLOORING MEETS WOOD FLOORING (MATCH KITCHEN FLOOR COLOR).
- CONTRACTOR & MILLWORK SUBCONTRACTOR SHALL HAND SELECT WOOD & WOOD TRIM TO ENSURE MATERIAL IS FREE FROM KNOTS, WARP, CRACKS, GUGGES, SPLITS AND, IN GENERAL, IS OF EXCELLENT VISUAL QUALITY. INSTALL MATERIAL OF THE LONGEST PRACTICAL LENGTHS & SIZES TO MINIMIZE THE NUMBER OF JOINTS.
- G.C. SHALL PLACE ORDERS FOR ALL FINISHES, MATERIALS, EQUIPMENT, ETC. AT THE START OF THE PROJECT. SUBSTITUTIONS ARE NOT ACCEPTED FOR ANY ITEMS, UNLESS NOTED OTHERWISE. OWNER AND ARCHITECT MUST BE INFORMED OF LEAD TIME PROBLEMS WITHIN THE FIRST TWO WEEKS OF PROJECT.
- G.C. SHALL INSTALL FURNITURE, FIXTURES AND EQUIPMENT ITEMS IN ACCORDANCE WITH 'PROCUREMENT PACKAGE' PROVIDED BY FRANCHISEE (N.I.C.). ALL ITEMS IN 'PROCUREMENT PACKAGE' ARE PROCURED BY FMG CONSTRUCTION FOR THE FRANCHISEE AT FRANCHISEE'S COST UNLESS OTHERWISE NOTED.
- G.C. SHALL APPLY MANUFACTURER RECOMMENDED GROUT SEALANT AND WAX TO ALL QUARRY TILE & COVE BASE. VERIFY WITH OWNER THE TIMING AND APPLICATION OF SEALER.
- TENANT'S G.C. SHALL PROVIDE SERVICES FOR FINAL CLEAN UP, PRIOR TO TURNING STORE OVER. TO INCLUDE, MOPPING AND BROOM CLEAN UP.
- PROVIDE 12" HIGH x 5/8" DUROCK ALONG BOTTOM PORTION OF ALL WALLS WITHIN KITCHEN, PREP AREAS, AND RESTROOM WALLS. INSTALL 5/8" W.R. GREEN BD. ABOVE - TYP. REMOVE EXISTING GYP. BD. ALONG LOWER 12" WHERE EXISTS WITHIN THOSE AREAS AND INSTALL DUROCK. IN ALL CASES INSTALL WITH A GAP OF 3/8" ABOVE FINISH SLAB AND FILL GAP WITH CONTINUOUS BEAD OF CAULK EQUAL TO NP-1, EXTERIOR TILT/WALL JOINT FILLER. REFER DETAIL 4/A3.0.
- G.C. SHALL INSTALL SALES FLOORING PRIOR TO FINISHING WITH QUARTER ROUND AT WAINSCOT
- G.C. SHALL INSTALL, CAULK, AND PAINT ALL FRONT OF HOUSE WAINSCOT AND MILLWORK. PAINT (PT-4)

FINISH SCHEDULE

SPACE	FLOOR	BASE	WALLS	CEILING	CLG. HT.	REMARKS
MARK	F1	F2	F3	F4	F5	
LOBBY	100				10'-0"	* GYP. BD. SOFFIT AT 10'-0" A.F.F. - REF. RCP. ** PAINT REAR WALL - PT-2 - REF. ELEV.
CRAFTING AREA	101				10'-0"	* REFER TO FINISH PLAN FOR SMOOTH FRP LOCATIONS
BAKING AREA	102				10'-0"	* REFER TO FINISH PLAN FOR SMOOTH FRP LOCATIONS
FROSTING AREA	103				10'-0"	* REFER TO FINISH PLAN FOR SMOOTH FRP LOCATIONS
WALK-IN CHILLER *	104					* PRE-FAB. CHILLER WALLS, FLOORING AND CEILING
WALK-IN REFRIGERATOR *	105					* PRE-FAB. COOLER WALLS AND CEILING - FLOORING SHALL MATCH FLOORING SCHEDULED IN KITCHEN AREAS
UTILITY	106				10'-0"	* REFER TO FINISH PLAN FOR STAINLESS STEEL AND FRP LOCATIONS
RESTROOM	107				9'-0"	* INTEGRATED EPOXY BASE, 4" FRP AND PAINT ABOVE
EMPLOYEE	108				9'-0"	OPEN
OFFICE	109				9'-0"	

NOTE: ALL INTERIOR FINISHES MUST COMPLY WITH MINIMUM SMOKE DEVELOPMENT AND MAXIMUM FLAME SPREAD REQUIREMENTS.

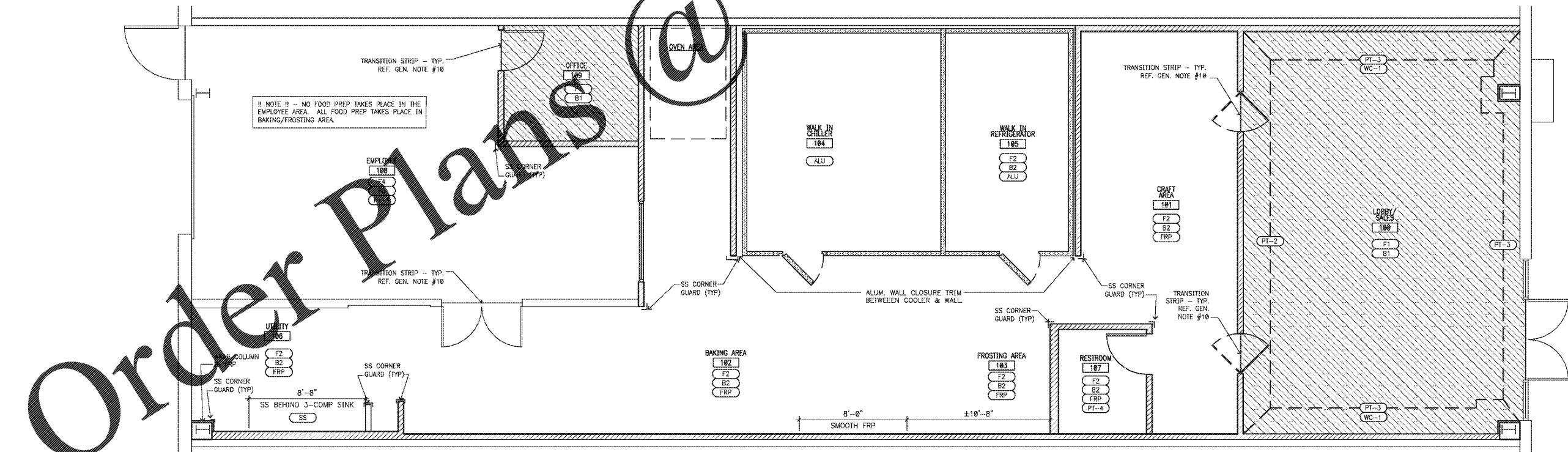

1 FINISH FLOOR PLAN
SCALE: 1/4" = 1'-0"

ARCHITECTURE
ENGINEERING
INTERIOR DESIGN
PROJECT MANAGEMENT

604 CREEKLAND STREET
SUITE 100
MIAMI, FLORIDA 33134
PH 407.645.5008
FX 407.629.9124

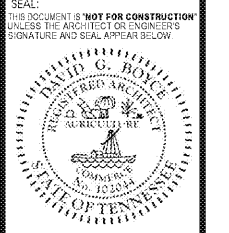

Digitally signed by David G. Boyce
Date: 2018.04.11 14:18:34 -0400

PAINT CONTACT:
JOSH MEHAFFEY
SHERWIN WILLIAMS
817.456.1842
SWREP4874@SHERWIN.COM

04.11.18 PERMIT SUBMIT
04.04.18 OWNER REVIEW

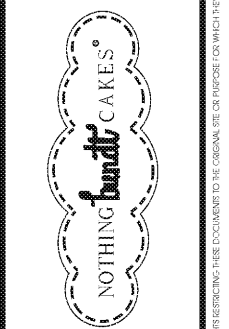

CREEKSIDE PLAZA
4110 N MT. JULIET RD.
MT. JULIET, TN 37122

PROJECT NO: 2018.0044
DATE: 2018.04.11

A3.0
FINISH PLAN &
FINISH
SCHEDULE
CHECKED: MCP DRAWN: ABKE