

VICINITY MAP - CITY OF ANDREWS  
SCALE: 1" = 2000'

**CONSTRUCTION NOTES:**

- CLEARING:** LIMITED CLEARING REQUIRED CONTRACTOR TO INSPECT SITE FOR REQUIRED CLEARING PRIOR TO BID.
- WETLANDS:** N/A
- TEMPORARY CONSTRUCTION ENTRANCE:** SEE THIS SHEET AND DETAIL. ALTERNATIVE ENTRY MUST BE APPROVED BY THE ENGINEER. IF A SECOND CONSTRUCTION ENTRY IS USED, INSTALL TEMPORARY CONSTRUCTION ENTRANCE PER DETAIL (100' X 24').
- CATCH BASIN SEDIMENT PROTECTION:** REFERENCE SEE DETAIL SHEET FOR FOLLOWING DETAILS:
  - DANDY BAG.
  - TYPE A - SEDIMENT TUBE INLET PROTECTION
  - SILT SACK EROSION CONTROL FOR CATCH BASIN
  - SEDIMENT TUBE DETAIL TO BE CONSTRUCTED AS SHOWN ON DETAIL SHEETS.
- CATCH BASIN PROTECTION:** PROVIDE CATCH BASIN INLET PROTECTION:
  - TYPE J C.B. (CURB INLET) - USE FOR CB-4 AND CB-5.
    - "SILT SACK EROSION CONTROL FOR CATCH BASIN - DETAIL" OR
    - "SEDIMENT TUBE - DETAIL"
  - TYPE F C.B. (GRATE INLET) - USE FOR CB-1, CB-2, CB-3, CB-5 AND CB-6.
    - DANDY BAG
    - TYPE A - SEDIMENT TUBE INLET PROTECTION
  - TYPE G C.B. (THROAT INLET) - USE FOR CB-8 & CB-9
    - TYPE A SEDIMENT TUBE INLET PROTECTION
- PERMIT BOX:** SEE LOCATION ON THIS PLAN. SEE "PERMIT BOX" DETAIL. KEEP SWPPP IN BOX. ALTERNATIVELY KEEP SWPPP IN CONSTRUCTION TRAILER, IF PROVIDED.
- RECORD DRAWING SURVEY:** THE RECORD DRAWING SURVEY SHALL BE PROVIDED BY THE OWNER THROUGH HIS ENGINEER, ETS.

**EROSION CONTROL LEGEND:**

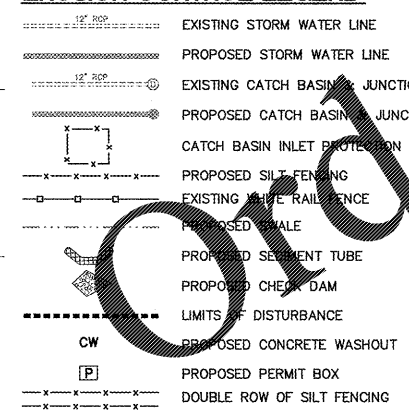

**SEDIMENT AND EROSION CONTROL NOTES:**

CONTRACTOR TO PROVIDE SEDIMENTATION AND EROSION CONTROL AS FOLLOWS : DURING EARLY PHASES OF CLEARING AND OTHER CONSTRUCTION, CONTRACTOR TO ROUTE DRAINAGE THROUGH NATURAL VEGETATED BUFFER AREAS. PROVIDE SILT FENCING ALONG DRAINAGEWAYS AND PERIMETERS AS SHOWN ON THE DRAWINGS. ONCE DEFINED SWALES ARE CONSTRUCTED, THE CONTRACTOR WILL PROVIDE AND MAINTAIN SEDIMENTATION CONTROL AT ALL CATCH BASINS, PIPE OUTLETS, AND OTHER CRITICAL AREAS AS SHOWN ON THE DRAWINGS. CONTRACTOR TO MAINTAIN EROSION CONTROL METHODS DURING ENTIRE COURSE OF CONSTRUCTION AND WILL PREVENT INFILTRATION OF SEDIMENTATION AND EROSION INTO DRAINAGE STRUCTURES, LAKES AND WETLANDS. UNDER NO CIRCUMSTANCES WILL ANY WETLAND AREAS BE UTILIZED FOR SEDIMENTATION BASINS.

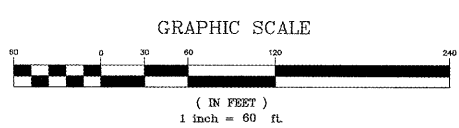
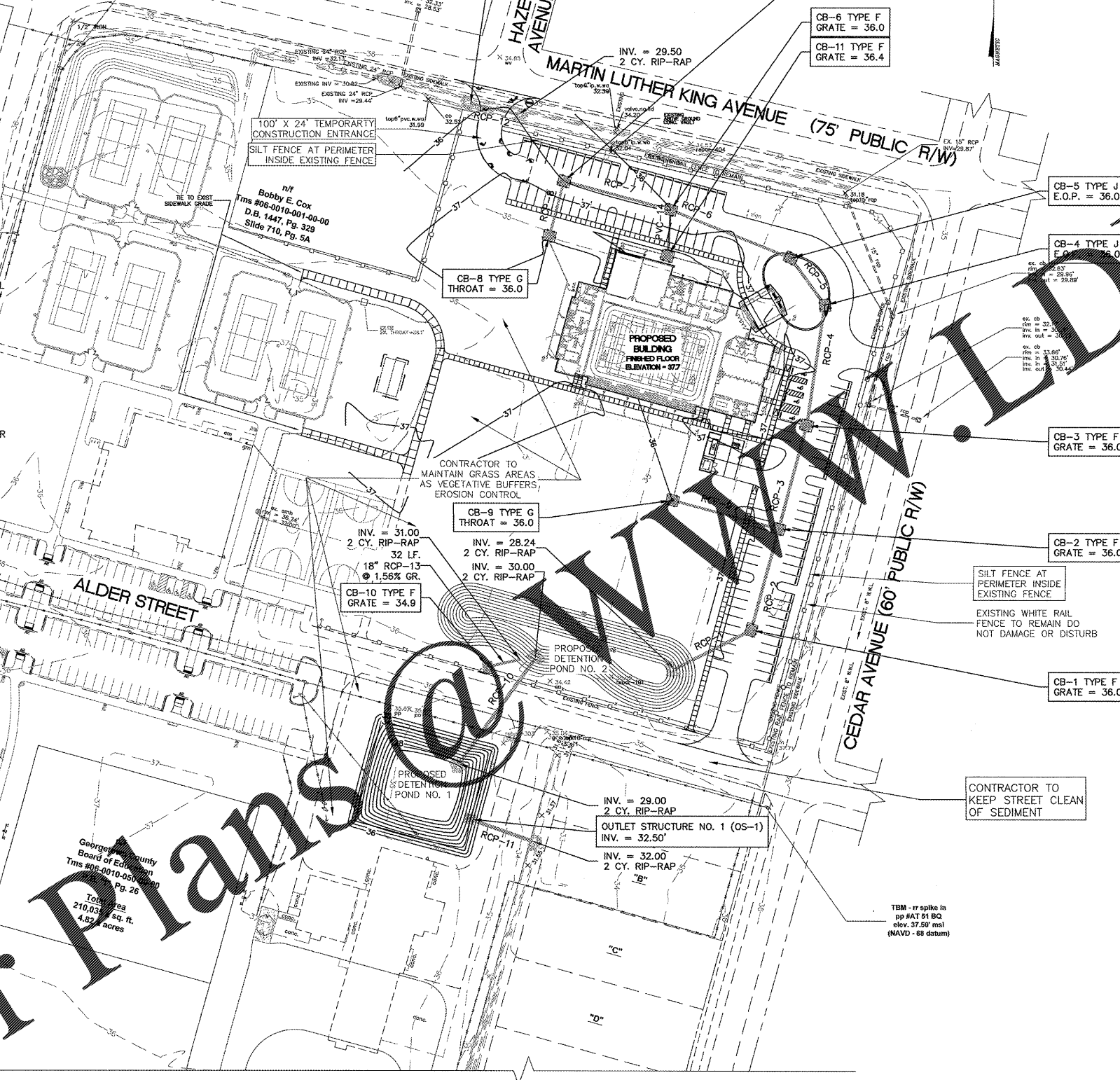

**THE CONTRACTOR WILL BE REQUIRED TO OBSERVE THE FOLLOWING:**

- IF NECESSARY, SLOPES WHICH EXCEED EIGHT (8) VERTICAL FEET SHOULD BE STABILIZED WITH SYNTHETIC OR VEGETATIVE MATS, IN ADDITION TO HYDROSEEDING. IT MAY BE NECESSARY TO INSTALL TEMPORARY SLOPE DRAINS DURING CONSTRUCTION. TEMPORARY BERMS MAY BE NEEDED DAILY UNTIL THE SLOPE IS BROUGHT UP TO GRADE.
- STABILIZATION MEASURES SHALL BE INITIATED AS SOON AS PRACTICABLE IN PORTIONS OF THE SITE WHERE CONSTRUCTION ACTIVITIES HAVE TEMPORARILY OR PERMANENTLY CEASED, BUT IN NO CASE MORE THAN 14 DAYS AFTER THE CONSTRUCTION ACTIVITY IN THAT PORTION OF THE SITE HAS TEMPORARILY OR PERMANENTLY CEASED, EXCEPT AS STATED BELOW.
  - WHERE STABILIZATION BY THE 14TH DAY IS PRECLUDED BY SNOW COVER OR FROZEN GROUND CONDITIONS STABILIZATION MEASURES MUST BE INITIATED AS SOON AS PRACTICABLE.
  - WHERE CONSTRUCTION ACTIVITY ON A PORTION OF THE SITE IS TEMPORARILY CEASED, AND EARTH-DISTURBING ACTIVITIES WILL BE RESUMED WITHIN 14 DAYS, TEMPORARY STABILIZATION MEASURES DO NOT HAVE TO BE INITIATED ON THAT PORTION OF THE SITE.
- ALL SEDIMENT CONTROL MEASURES SHALL BE INSPECTED EVERY CALENDAR DAY IF PERIODIC INSPECTION OR OTHER INFORMATION INDICATES THAT A BMP HAS BEEN INAPPROPRIATELY OR INCORRECTLY INSTALLED, THE PERMITEE MUST ADDRESS THE NECESSARY REPLACEMENT OF MODIFICATION REQUIRED TO CORRECT THE BMP WITHIN 48 HRS OF IDENTIFICATION.
- PROVIDE SILT FENCE AND/OR OTHER CONTROL DEVICES AS REQUIRED, TO CONTROL SOIL EROSION DURING UTILITY CONSTRUCTION. DISTURBED AREAS SHALL BE CLEANED, GRADED, AND STABILIZED WITH GRASS IMMEDIATELY AFTER THE UTILITY INSTALLATION. EROSION COVER AND TEMPORARY SEEDING TO THE END OF EACH DAY ARE RECOMMENDED. WATER IS ENCOUNTERED WHILE TRENCHING THE WATER SHOULD BE FILTERED TO REMOVE ANY SEDIMENTS BEFORE BEING PUMPED BACK INTO ANY WATERS OF THE STATE.
- ALL SEDIMENT CONTROL DEVICES SHALL BE PROPERLY MAINTAINED DURING ALL PHASES OF CONSTRUCTION UNTIL THE COMPLETION OF ALL CONSTRUCTION ACTIVITIES AND ALL DISTURBED AREAS HAVE BEEN STABILIZED. ADDITIONAL CONTROL DEVICES MAY BE REQUIRED DURING CONSTRUCTION IN ORDER TO CONTROL EROSION AND/OR OFFSITE SEDIMENTATION. ALL TEMPORARY CONTROL DEVICES SHALL BE REMOVED ONCE CONSTRUCTION IS COMPLETED AND THE SITE IS STABILIZED.
- CONTRACTOR MUST TAKE NECESSARY ACTION TO MINIMIZE THE TRACKING OF MUD ONTO THE PAVED ROADWAY(S) FROM CONSTRUCTION AREAS AND THE GENERATION OF DUST. THE CONTRACTOR SHALL DAILY REMOVE MUD/SOIL FROM PAVEMENT, AS MAY BE REQUIRED.
- RESIDENTIAL SUBDIVISIONS REQUIRE EROSION CONTROL FEATURES FOR INFRASTRUCTURE AS WELL AS FOR INDIVIDUAL LOT CONSTRUCTION. INDIVIDUAL PROPERTY OWNERS SHALL FOLLOW THESE PLANS DURING CONSTRUCTION OR OBTAIN APPROVAL OF AN INDIVIDUAL PLAN IN ACCORDANCE WITH S.C. REG. 72-300 ET SEQ. AND SCR 100000.
- TEMPORARY DIVERSION BERMS AND/OR DITCHES WILL BE PROVIDED AS NEEDED DURING CONSTRUCTION TO PROTECT WORK AREAS FROM UPSLOPE RUNOFF AND/OR TO DIVERT SEDIMENT-LADEN WATER TO APPROPRIATE TRAPS OR STABLE OUTLETS.
- ALL WATERS OF THE STATE (WOS), INCLUDING WETLANDS, ARE TO BE FLAGGED OR OTHERWISE CLEARLY MARKED IN THE FIELD. A DOUBLE ROW OF SILT FENCE IS TO BE INSTALLED IN ALL AREAS WHERE A 50-FOOT BUFFER CAN'T BE MAINTAINED BETWEEN THE DISTURBED AREA AND ALL WOS. A 10-FOOT BUFFER SHOULD BE MAINTAINED BETWEEN THE LAST ROW OF SILT FENCE AND ALL WOS.
- LITTER, CONSTRUCTION DEBRIS, OILS, FUELS, AND BUILDING PRODUCTS WITH SIGNIFICANT POTENTIAL FOR IMPACT (SUCH AS STOCKPILES OF FRESHLY TREATED LUMBER) AND CONSTRUCTION CHEMICALS THAT COULD BE EXPOSED TO STORM WATER MUST BE PREVENTED FROM BECOMING A POLLUTANT SOURCE IN STORM WATER DISCHARGES.
- A COPY OF THE SWPPP, INSPECTIONS RECORDS, AND RAINFALL DATA MUST BE RETAINED AT THE CONSTRUCTION SITE OR A NEARBY LOCATION EASILY ACCESSIBLE DURING NORMAL BUSINESS HOURS, FROM THE DATE OF COMMENCEMENT OF CONSTRUCTION ACTIVITIES TO THE DATE THAT FINAL STABILIZATION IS REACHED.
- INITIATE STABILIZATION MEASURES ON ANY EXPOSED STEEP SLOPE (3H:1V OR GREATER) WHERE LAND-DISTURBING ACTIVITIES HAVE PERMANENTLY OR TEMPORARILY CEASED, AND WILL NOT RESUME FOR A PERIOD OF 7 CALENDAR DAYS.
- MINIMIZE SOIL COMPACTION AND, UNLESS INFEASIBLE, PRESERVE TOPSOIL.
- MINIMIZE THE DISCHARGE OF POLLUTANTS FROM EQUIPMENT AND VEHICLE WASHING, WHEEL WASH WATER, AND OTHER WASH WATERS. WASH WATERS MUST BE TREATED IN A SEDIMENT BASIN OR ALTERNATIVE CONTROL THAT PROVIDES EQUIVALENT OR BETTER TREATMENT PRIOR TO DISCHARGE.
- MINIMIZE THE DISCHARGE OF POLLUTANTS FROM DEWATERING OF TRENCHES AND EXCAVATED AREAS. THESE DISCHARGES ARE TO BE ROUTED THROUGH APPROPRIATE BMPS (SEDIMENT BASIN, FILTER BAG, ETC.).
- THE FOLLOWING DISCHARGES FROM SITES ARE PROHIBITED:
  - WASTEWATER FROM WASHOUT OF CONCRETE, UNLESS MANAGED BY AN APPROPRIATE CONTROL;
  - WASTEWATER FROM WASHOUT AND CLEANOUT OF STUCCO, PAINT, FORM RELEASE OILS, CURING COMPOUNDS AND OTHER CONSTRUCTION MATERIALS;
  - FUELS, OILS, OR OTHER POLLUTANTS USED IN VEHICLE AND EQUIPMENT OPERATION AND MAINTENANCE;
  - SOAPS OR SOLVENTS USED IN VEHICLE AND EQUIPMENT WASHING.
- AFTER CONSTRUCTION ACTIVITIES BEGIN, INSPECTIONS MUST BE CONDUCTED AT A MINIMUM OF AT LEAST ONCE EVERY CALENDAR WEEK AND MUST BE CONDUCTED UNTIL FINAL STABILIZATION IS REACHED ON ALL AREAS OF THE CONSTRUCTION SITE.
- IF EXISTING BMPS NEED TO BE MODIFIED OR IF ADDITIONAL BMPS ARE NECESSARY TO COMPLY WITH THE REQUIREMENTS OF THIS PERMIT AND/OR SO'S WATER QUALITY STANDARDS, IMPLEMENTATION MUST BE COMPLETED BEFORE THE NEXT STORM EVENT WHENEVER PRACTICABLE. IF IMPLEMENTATION BEFORE THE NEXT STORM EVENT IS IMPRACTICABLE, THE SITUATION MUST BE DOCUMENTED IN THE SWPPP AND ALTERNATIVE BMPS MUST BE IMPLEMENTED AS SOON AS REASONABLY POSSIBLE.
- A PRE-CONSTRUCTION CONFERENCE MUST BE HELD FOR EACH CONSTRUCTION SITE WITH AN APPROVED ON-SITE SWPPP PRIOR TO THE IMPLEMENTATION OF CONSTRUCTION ACTIVITIES. FOR NON-LINEAR PROJECTS THAT DISTURBS 10 ACRES OR MORE THIS CONFERENCE MUST BE HELD ON-SITE UNLESS THE DEPARTMENT HAS APPROVED OTHERWISE.

**SEDIMENTATION AND EROSION CONTROL CONSTRUCTION SEQUENCE NOTE:**

- IN ORDER TO MINIMIZE THE IMPACT OF SEDIMENTATION AND EROSION, THE CONTRACTOR SHALL OBSERVE THE FOLLOWING SEQUENCE OF CONSTRUCTION OPERATIONS:
- INSTALLATION OF PERIMETER CONTROLS.
  - CLEARING AND GRUBBING DURING THE BEGINNING OF THE PROJECT.
  - MAINTAIN EXISTING VEGETATIVE BUFFERS FOR EROSION AND SEDIMENT CONTROL DURING THE BEGINNING OF THE PROJECT.
  - INSTALLATION OF SEDIMENT BASINS, TRAPS AND OTHER ITEMS WHERE SHOWN OR REQUIRED BY THE PLANS AND SPECIFICATIONS DURING THE BEGINNING OF THE PROJECT.
  - ROAD GRADING.
  - COMPLETION OF THE SITE GRADING.
  - GRAVITY UTILITY INSTALLATION (WASTEWATER AND STORM WATER).
  - WATER MAIN AND ELECTRIC, TELEPHONE AND CABLE TELEVISION INSTALLATION.
  - FINAL GRADING AND LANDSCAPING STABILIZATIONS.
  - REMOVAL OF SEDIMENT CONTROLS AT THE END OF THE PROJECT.

Georgetown County Regional Parks  
Andrews Regional Recreation Center

Owner:  
Georgetown County  
716 Prince Street  
Georgetown, SC 29442

SGA ARCHITECTURE  
ARCHITECTURE AND INTERIOR DESIGN  
245 Business Center Lane / PO Box 1859  
Pawleys Island, SC 29585  
Phone: 843.237.3421 / Fax: 843.237.1992  
www.SGAarchitect.com

Civil Consultant:  
**ETS**  
ENGINEERING AND TECHNICAL SERVICES, INC.  
CONSULTING ENGINEERS  
58 Cardenraugh Lane  
Pawleys Island, S.C. 29585  
Phone: (843) 237-3002 Fax: (843) 237-2269

MEP Consultant:  
Charleston Engineering  
125 B Wiggins Creek Dr.  
Charleston, SC 29412  
843-762-4242  
Mechanical, Plumbing & Electrical

Structural Consultant:

Irrigation Consultant:

Professional Engineer Seal:  
SOUTH CAROLINA  
ENGINEERING AND TECHNICAL SERVICES, INC.  
No. C00439  
Corporate Seal  
Michael A. Robinson  
No. 8285  
04.03.18  
Individual Seal

MEMBERS OF THE AMERICAN INSTITUTE OF ARCHITECTS  
COPYRIGHT 2017. ALL RIGHTS RESERVED.  
PRINTED OR ELECTRONIC DRAWINGS AND DOCUMENTATION MAY NOT BE REPRODUCED IN ANY FORM WITHOUT WRITTEN PERMISSION FROM SGA ARCHITECTURE

Job Number: 2017024  
Date:  
Drawn by: LW  
Checked by: MFR

Notes:

Revisions:  
03-29-2018 REV. POND 2

SEDIMENT AND EROSION CONTROL PLAN  
C104