

- LOCKER ROOM COUNTER NOTES:**
- 1.3 PAIR PIVOT HINGES PER DOOR
 2. ALL PANEL CORES TO BE 3/4" PARTICLE BOARD OR EQUAL
 3. FIXTURES SHALL CONFORM TO ARCHITECTURAL WOODWORK INSTITUTE OR WOODWORK INSTITUTE OF CALIFORNIA "CUSTOM" GRADE STANDARDS
 4. FINISH TO BE PLASTIC LAMINATE AT ALL EXPOSED SURFACES INCLUDING BASE. FINISH TO BE PAINT AT ALL SEMI-EXPOSED SURFACES
 5. PLASTIC LAMINATE TO BE WILSONART 0315-60 "PLATINUM"
 6. PAINT TO MATCH PLASTIC LAMINATE, SEMI-GLOSS.
 7. MICROWAVE DUPLEX TO BE INSTALLED W/ EXTENSION AND W/ DEVICE AND COVER PLATE FLUSH AT FINISHED BACK OF CABINET - SEE ELEC. DWGS.
 8. COUNTER AND SINK TO BE COMPLETE AND FUNCTIONING IN EVERY ASPECT AND DETAIL AT TIME OF CONSTRUCTION TURNOVER, NO EXCEPTION.

2 LOCKER ROOM COUNTER BY G.C.
A4.1 SCALE: 1/2"=1'-0"

TOILET ACCESSORIES

NOTES:
 1. UNLESS OTHERWISE NOTED, ALL TOILET ROOM ACCESSORIES ARE BY BOBRICK. GENERAL CONTRACTOR SHALL PROVIDE AND INSTALL ALL TOILET ACCESSORIES AS NOTED.

| ITEM DESCRIPTION | MANUFACTURER'S ITEM # |
|---|--|
| A SURFACE MOUNTED TOILET SEAT COVER DISPENSER 40" MAX. A.F.F. TO HIGHEST OPERABLE PART | B-221 |
| B SURFACE MOUNTED SOAP DISPENSER 40" MAX. A.F.F. TO HIGHEST OPERABLE PART | PROVIDED AND INSTALLED BY ROSS STORES |
| C SURFACE MOUNTED TOILET TISSUE DISPENSER 12" MAX. FROM FRONT EDGE OF TOILET SEAT AND 19" MIN. A.F.F. TO BOTTOM OF DISPENSER | B-2892 JUMBO |
| D SURFACE MOUNTED SANITARY NAPKIN DISPOSAL, 40" MAX. A.F.F. TO HIGHEST OPERABLE PART (WOMEN'S TOILET ROOM ONLY) | B-270 |
| E S.S. GRAB BARS WITH CONCEALED MOUNTING, MOUNTED 33" TO CENTER LINE A.F.F., BOTH BARS TO BE MOUNTED 12" MAX. FROM COMMON CORNER. SIDE BAR TO BE 62" MIN. LONG WITH THE FRONT END TO EXTEND 24" BEYOND FRONT EDGE OF TOILET SEAT. BACK BAR TO BE 38" MIN. LONG. 18" VERTICAL GRAB BAR MOUNTED AT 47" A.F.F. MAX. AND 40" FROM WALL CORNER | B-4806 W/ 2502 ANCHOR PLATES |
| F MIRROR W/ S.S. FRAME, 18"x36". BOTTOM EDGE OF MIRROR REFLECTING SURFACE 40" MAX. A.F.F. (MIRRORS PROVIDED IN THE WOMEN'S TOILET ROOM ONLY, NO MIRROR IN THE MEN'S TOILET ROOM) SEAL BACK EDGE OF MIRROR W/ SILICONE | SENTRY MIRRORS #8MS 1836 WITH 5 REPLACEMENT ANTI GRAFFITI PLEXI-SHIELDS |
| G HAND DRYER, SEMI-RECESSED, 40" MAX. A.F.F. TO BOTTOM OF BACK PLATE, 4" MAX. PROJECTION | AMERICAN DRYER EXTREME AIR EXTRACT (STEEL WHITE) WITH ADA-W ACCESS KIT |
| H TIME MIST DISPENSER - MOUNTED @ 7'-6" A.F.F. (SOURCE: SUPREME INDUSTRIAL PRODUCTS, SEE SHEET A0.0 FOR CONTACT INFO.) | OMNIAIR DISPENSER #74356 (WHITE, 2.8" X 2.75" X 5.358") ONE DISPENSER REQUIRED PER RESTROOM. REFILL INSTALLED BY ROSS |
| I TOILET ROOM PARTITIONS: ACCESSIBLE STALL DOOR TO BE EQUIPPED WITH AUTOMATIC CLOSING DEVICE, A CLEAR OPENING WIDTH OF 34" WITH THE DOOR POSITIONED AT 80" FROM ITS CLOSED POSITION, AND THE INSIDE AND OUTSIDE OF THE DOOR IS TO BE EQUIPPED WITH A LOOP OR U-SHAPED HANDLE IMMEDIATELY BELOW THE LATCH. THE LATCH HARDWARE SHALL NOT REQUIRE THE USER TO GRASP OR TWIST IN ORDER TO OPERATE. PROVIDE ROBE HOOK ON ACCESSIBLE STALL DOOR AT 48" AFF. | BOBRICK, DURALINE SERIES 1062.87 OVERHEAD BRACED, INSTITUTIONAL HARDWARE COLOR: F4500 "BLACK STAR" DOOR STOPS ON ALL PARTITION DOORS. PROVIDE POST FOR URINAL SCREEN BRACE TOP AND BOTTOM. |
| J DIAPER CHANGING STATION WHEN OPEN TOP OF TABLE TO BE 34" MAX. A.F.F. (SOURCE: GAMCO, SEE SHEET A0.0 FOR CONTACT INFO.) - NO EXCEPTION. | BGS-2 (GRAY) |

* - ROSS SPECIFIC

FIXTURE & SHEET NOTES

1. ACCESSIBLE WATER CLOSET: KOHLER HIGHCLIFF FLOOR MOUNTED TOILET K-9607-0 (1.28 GPF) WITH K-4870-C SEAT AND SLOAN ROYAL 111-1-28 EXPOSED FLUSH VALVE (1.28 GPF) WITH VACUUM BREAKER AND STOP. HEIGHT TO BE 18 1/2" MEASURED TO THE TOP OF THE TOILET SEAT. CONTROLS TO BE NO MORE THAN 44" ABOVE THE FLOOR WITH A MAXIMUM 5-POUND FORCE REQ'D FOR ACTIVATION.
2. WATER CLOSET: KOHLER WELLCOMME FLOOR MOUNTED TOILET K-9603-0 (1.28 GPF) WITH K-4870-C SEAT AND SLOAN ROYAL 111-1-28 EXPOSED FLUSH VALVE (1.28 GPF) WITH VACUUM BREAKER AND STOP.
3. RESTROOM LAVATORY: AMERICAN STANDARD, LUCERNE 0355.012 WHITE, WITH MONTEREY CENTERSET FAUCET 5502.175 WITH WRIST HANDLES. FAUCET CONTROLS SHALL BE OPERABLE WITH ONE HAND AND SHALL NOT REQUIRE TIGHT GRASPING. PINCHING OR TWISTING OF THE WRIST WITH A MAXIMUM 5-POUND FORCE REQ'D FOR ACTIVATION. ALL LAVATORIES TO BE MOUNTED WITH THE RIM 34" MAX. A.F.F., KNEE CLEARANCE BELOW THE LAVATORY SHALL EXTEND 30" MIN. IN WIDTH AND 17" MIN. IN DEPTH. HOT WATER AND DRAIN PIPES UNDER ALL LAVATORIES SHALL BE INSULATED WITH TREBRO LAQUARD GUARD DEVICE OR APPROVED EQUAL (PIPE WRAP IS NOT ALLOWED); THERE SHALL BE NO SHARP OR ABRASIVE SURFACES UNDER LAVATORIES.
4. ACCESSIBLE URINAL: KOHLER K-491-1-ET BARDON 0.5 GPF WHITE, RIM TO PROJECT 14" MIN. AND 19" MAX. FROM WALL AND 17" MAX. A.F.F.
5. JANITOR CLOSET SERVICE SINK: FLORESTONE MODEL #91 36"X24"X12" WITH STAINLESS STEEL CAP FAUCET, CENTRAL BRASS #0054-TLERC-Q SERVICE SINK FAUCET, 24" HOSE AND BRACKET.
6. DRINKING FOUNTAIN: HALSEY-TAYLOR BARRIER-FREE HACDLS5-NF DRINKING FOUNTAIN (NO REFRIGERANT), NO SUBSTITUTION - INSTALLED WITH ORIFICE AT +34" (LOW) AND +41" (HIGH) BY FERGUSON CORPORATE SALES (ROSS SPECIFIC). RETAIL CONTACT: CALL 737-988-2072, ELLEN KAUSLAND, ELLEN.KAUSLAND@FERGUSON.COM
7. ELECTRIC 4 KW / 10 QUICK RECOVERY GALLON WATER HEATER. HOT WATER HEATER MUST NOT EXCEED 60 FEET FROM HEATER TO TAP. ALL HOT WATER LINES MUST BE INSULATED. SEE DETAIL THIS SHEET FOR WATER HEATER SHELF.
8. LOCKER ROOM SINK - ELKAY CELEBRITY GECR25213 STAINLESS STEEL SINK W/ UNDERSINK, AMERICAN STANDARD, MONTEREY 9405.170 V5 FAUCET W/ WRIST SLIDE HANDLES AND W/ VANDAL-RESISTANT PICA AERATOR. FAUCET CONTROLS SHALL BE OPERABLE WITH ONE HAND AND SHALL NOT REQUIRE TIGHT GRASPING. PINCHING OR TWISTING OF THE WRIST WITH A MAXIMUM 5-POUND FORCE REQ'D FOR ACTIVATION. SINK TO BE MOUNTED WITH THE JAMMER EDGE 34" MAX. A.F.F. KNEE CLEARANCE BELOW THE COUNTER SHALL EXTEND 30" MIN. IN WIDTH AND 17" MIN. IN DEPTH. HOT WATER AND DRAIN PIPES UNDER THE COUNTER SHALL BE INSULATED OR OTHERWISE COVERED. THERE SHALL BE NO SHARP OR ABRASIVE SURFACES UNDER THE COUNTER.
9. MARBLE THRESHOLD-5/8"x2"x36" DSL BEVEL, DALY, 115-115-115, SEE DETAIL CD M70

FINISH LEGEND (SEE SHEET A6.0 FOR ADDITIONAL FINISH AND MATERIAL NOTES)

- | | | | |
|------|--|------|---|
| P 1 | PAINT BENJAMIN MOORE #2023-70 "CREME FRAICHE" EGG SHELL FINISH - AT ALL GYPSUM BOARD SURFACES, UNLESS OTHERWISE SPECIFIED. | P 4 | BM #2023-70 "CREME FRAICHE" SEMI-GLOSS FINISH |
| P 2 | PAINT 12" PERIMETER FIXTURE DECOR STRIPE, SHERWIN WILLIAMS SW #6939 "TURQUISH" EGG-SHELL ENAMEL "PROMAR" AT SALES FLOOR. SEE NOTE #10 ON SHEET A6.0 OF THE ROOM FINISH AND MATERIAL NOTES AND DETAIL 4/AS.0 FOR MORE INFORMATION. PERIMETER DECOR STRIPE TO BE REDUCED TO 8" IF CEILING IS LOWER THAN +13'-6" AFF. | P 5 | BM #2023-70 "CREME FRAICHE" SEMI-GLOSS FINISH |
| P 3 | PAINT SHERWIN WILLIAMS SW #7005 "PURE WHITE" - "PROMAR" ALKYD SEMI-GLOSS ENAMEL AT GYPSUM BOARD CEILINGS AND SOFFITS. | P 6 | BM #2023-70 "CREME FRAICHE" SEMI-GLOSS FINISH |
| P 4 | PAINT BENJAMIN MOORE #2023-70 "CREME FRAICHE" - "PROMAR" ALKYD SEMI-GLOSS - ALL INTERIOR METAL, FINISH WOODWORK, DOORS, DOOR JAMBS AND FRAMES AND ALL PAINTED SURFACES IN RESTROOMS, ALL PLYWOOD WAINSCOT IN PROCESSING ROOM. | P 7 | BM #2023-70 "CREME FRAICHE" SEMI-GLOSS FINISH |
| P 5 | RUBBER BASE, 6" JOHNSONITE #40 "BLACK" WITH PRE-FORMED CORNERS. USE JOHNSONITE 946 ADHESIVE, NO EXCEPTION. | P 8 | BM #2023-70 "CREME FRAICHE" SEMI-GLOSS FINISH |
| CG 1 | 6"-0" CORNER GUARDS. FOR INSTALLATION SEE WALL PANEL DETAIL 1/AS.1 AND MATERIALS NOTES #13/AS.0. | P 9 | BM #2023-70 "CREME FRAICHE" SEMI-GLOSS FINISH |
| CG 2 | 4"-0" CORNER GUARDS (AT LOCKER ROOM AND OFFICE HALL ONLY). FOR INSTALLATION SEE WALL PANEL DETAIL 1/AS.1. SEE FINISH AND MATERIALS NOTES #13/AS.0. | P 10 | BM #2023-70 "CREME FRAICHE" SEMI-GLOSS FINISH |
| WP 1 | 6"-0" VINYL WALL PANEL - SEE FINISH AND MATERIALS NOTES #10/AS.0 FOR PLANS. | P 11 | BM #2023-70 "CREME FRAICHE" SEMI-GLOSS FINISH |
| WP 2 | 4"-0" VINYL WALL PANEL (AT LOCKER ROOM AND OFFICE HALL ONLY) - SEE FINISH AND MATERIALS NOTES #10/AS.0 FOR PLANS. | P 12 | BM #2023-70 "CREME FRAICHE" SEMI-GLOSS FINISH |
| PR 1 | GYPSUM BOARD TO BE Sanded, Primed and PAINT READY | | |
- NOTE:**
 CERAMIC TILE BASE TO RECEIVE INSIDE AND OUTSIDE CORNERS.

INTERIOR FINISH NOTES:

1. INTERIOR BASE BUILDING PAINT COLOR IS TO BE BENJAMIN MOORE BM 2023-70 "CREME FRAICHE" (THIS INCLUDES THE ELECTRICAL ROOM AND STOCKROOM WALLS) "PROMAR" LATEX WITH AN EGG-SHELL FINISH UNLESS OTHERWISE SPECIFIED.
2. INTERIOR METAL, FINISH WOODWORK, JAMBS, DOORS AND FRAMES, PLYWOOD WAINSCOT IN PROCESSING ROOM AND ALL PAINTED SURFACES IN THE VESTIBULE, RESTROOMS AND JANITOR'S CLOSET ARE TO BE PAINTED WITH "PROMAR" ALKYD ENAMEL IN A SEMI-GLOSS FINISH.

GENERAL NOTE (INTERIOR FINISHES)

THE FLAMESPREAD OF ALL INTERIOR FINISHES SHALL BE PER INTERNATIONAL BUILDING CODE (TABLE 803.5):

- CORRIDORS - CLASS C (75 TO 200)
- OTHER SPACES - CLASS C (75 TO 200)

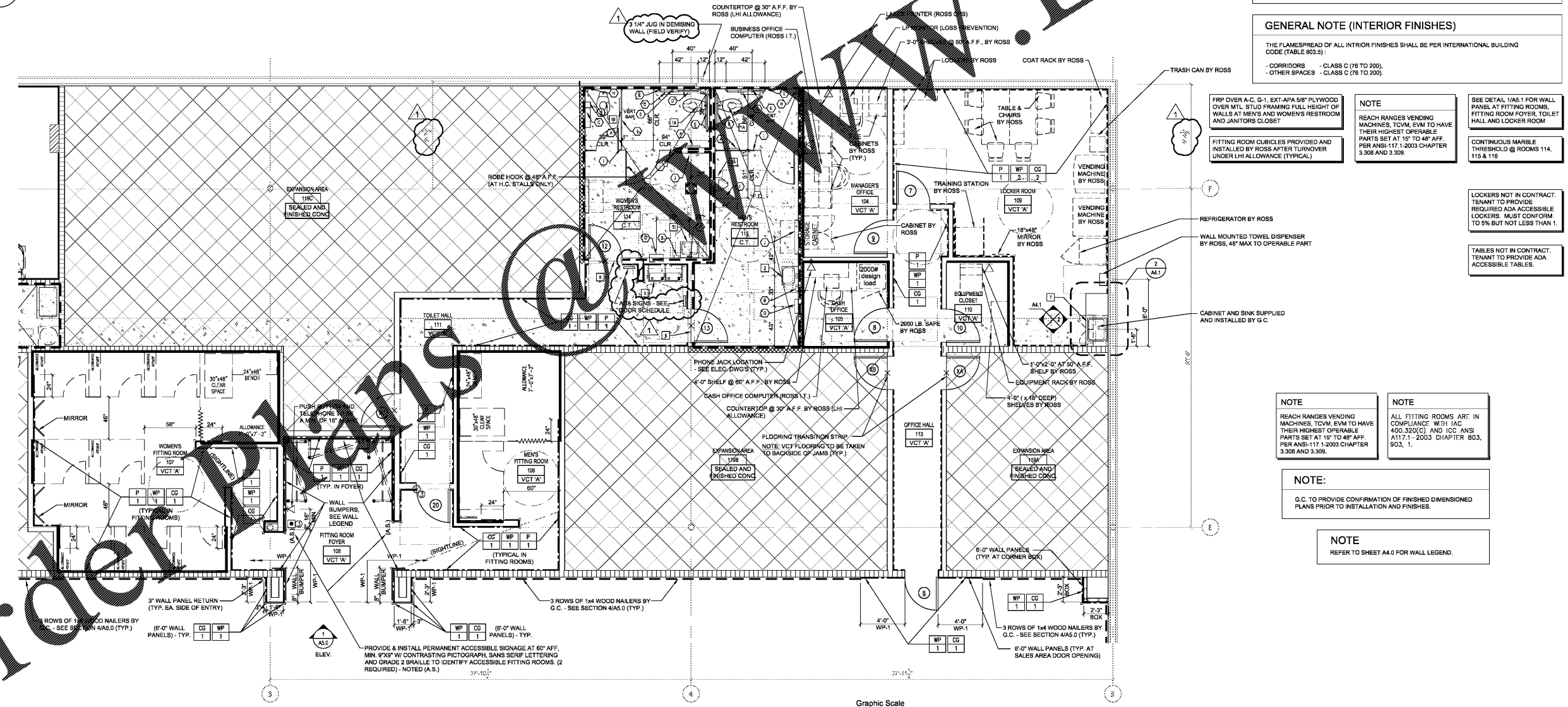

1 ENLARGED FITTING ROOM, RESTROOM AND OFFICE FIXTURE PLAN
A4.1 SCALE: 1/4" = 1'-0"

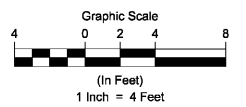

ANTHONY CASSATA
 ARCHITECT

2805 S. BRIDLEFIELD
 SUITE #340
 BROOKFIELD, IL 60523
 (312) 798-1245
 (312) 798-1243

dd's DISCOUNTS

OWNER:

ROSS STORES

5130 HACIENDA DRIVE
 DUBLIN, CA 94568

PROJECT:

dd's DISCOUNTS STORE #5352 (GREENVILLE, SC)

WHITE HORSE PLAZA
 6119 WHITE HORSE ROAD
 GREENVILLE, SC 29611

BASED ON DD'S 22K TURNKEY - EXISTING PROTOTYPE DATED MARCH, 2018

DRAWING TITLE: ENLARGED PLANS & SCHEDULES

| REV. NO. | DATE | DESCRIPTION |
|----------|----------|-----------------|
| 01 | 07/02/18 | FOR ROSS REVIEW |
| 02 | 07/17/18 | ROSS MARK-UPS |



EXPIRES: 6/30/2018

COPYRIGHT: ALL DRAWN AND WRITTEN INFO. APPEARING HEREIN SHALL NOT BE DUPLICATED, DISCLOSED OR OTHERWISE REPRODUCED WITHOUT WRITTEN CONSENT.

PFDA JOB: #16027

SCALE: AS NOTED

DRAWN BY: CHECKED BY:

SHEET NUMBER: **A4.1**