

Order Plans

WWW.LDILine.com

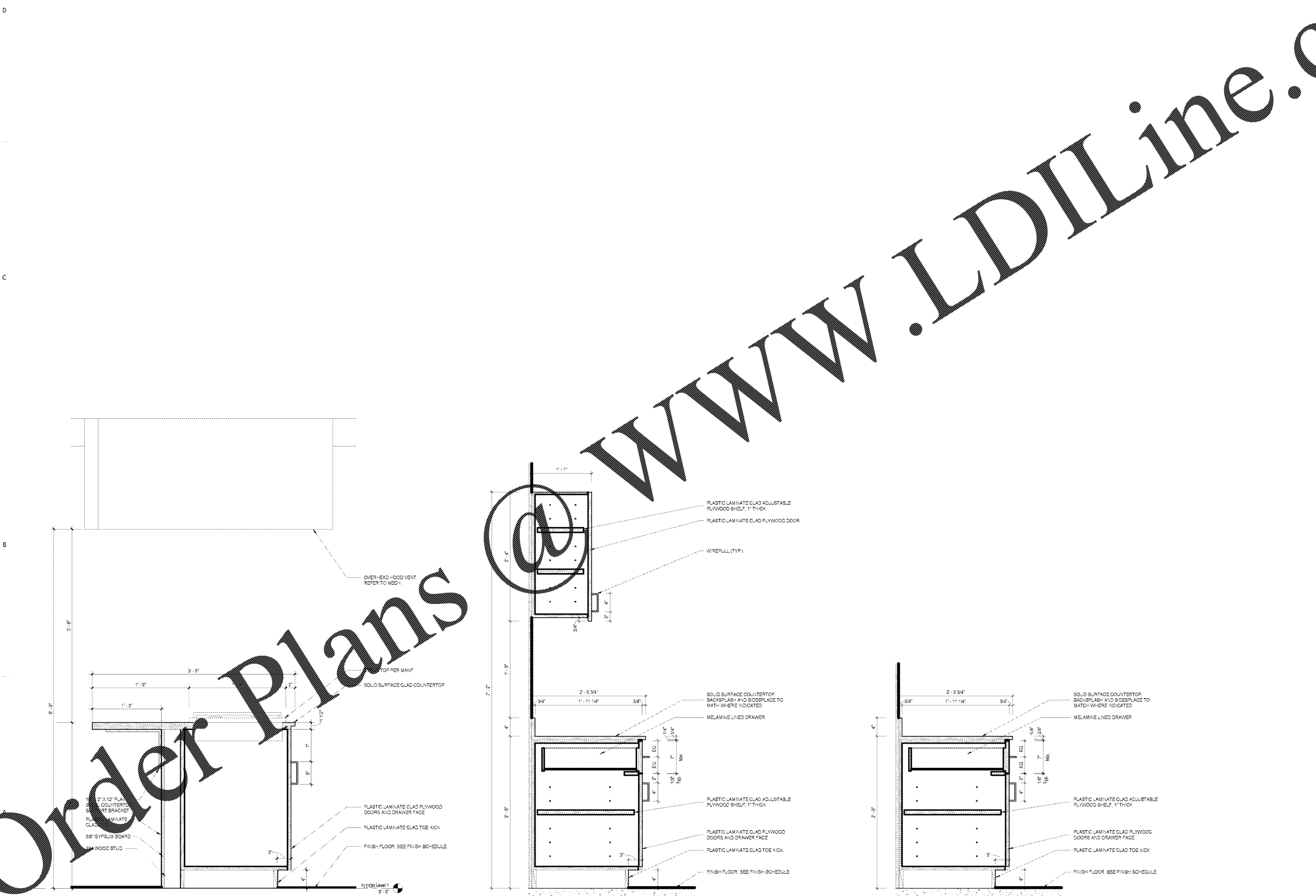

1 CASEWORK SECTION DETAIL
1/12" = 1'-0"

2 CASEWORK SECTION DETAIL
1/12" = 1'-0"

3 CASEWORK SECTION DETAIL
1/12" = 1'-0"

1890 EXTENSION SC STATE UNIVERSITY
CAMP HARRY G. DANIELS 1890 EXTENSION FACILITY - RE - BID
 Agency Review ID: H24-9649-CA
 116 Camp Daniels Road, Ellerbe, SC

SHEET ISSUE:			
NO.	DATE	DESCRIPTION	BY
1	2018.05.31	For Bid Package	MA

BD SET 05/08/2017
 PROJECT ARCHITECT: MA
 DRAWN BY: CS

SHEET TITLE:
MILLWORK SECTIONS & DETAILS

SHEET NO. 13140.00
 PROJ. NO. 13140.00

A9.22

LDI
mc millan | parsons | smith
 architects
 asheville | atlanta | charlotte | charleston | columbia | denver | dallas | denver | fort worth | houston | los angeles | new york | oakridge | oxford | richmond | san francisco | st. louis | tampa | washington, dc
 p.o. box 3922 | greenville, sc 29602-3922 | 864.242.2034
 www.mcmillanparsonsmith.com