

ALL DIMENSIONS, SPECIFICATIONS AND NOTES ARE TO BE TAKEN FROM THIS SET OF DRAWINGS. THE CONTRACTOR SHALL BE RESPONSIBLE FOR OBTAINING ALL NECESSARY PERMITS AND APPROVALS FROM THE LOCAL, STATE AND FEDERAL AUTHORITIES. THE CONTRACTOR SHALL BE RESPONSIBLE FOR OBTAINING ALL NECESSARY PERMITS AND APPROVALS FROM THE LOCAL, STATE AND FEDERAL AUTHORITIES. THE CONTRACTOR SHALL BE RESPONSIBLE FOR OBTAINING ALL NECESSARY PERMITS AND APPROVALS FROM THE LOCAL, STATE AND FEDERAL AUTHORITIES.

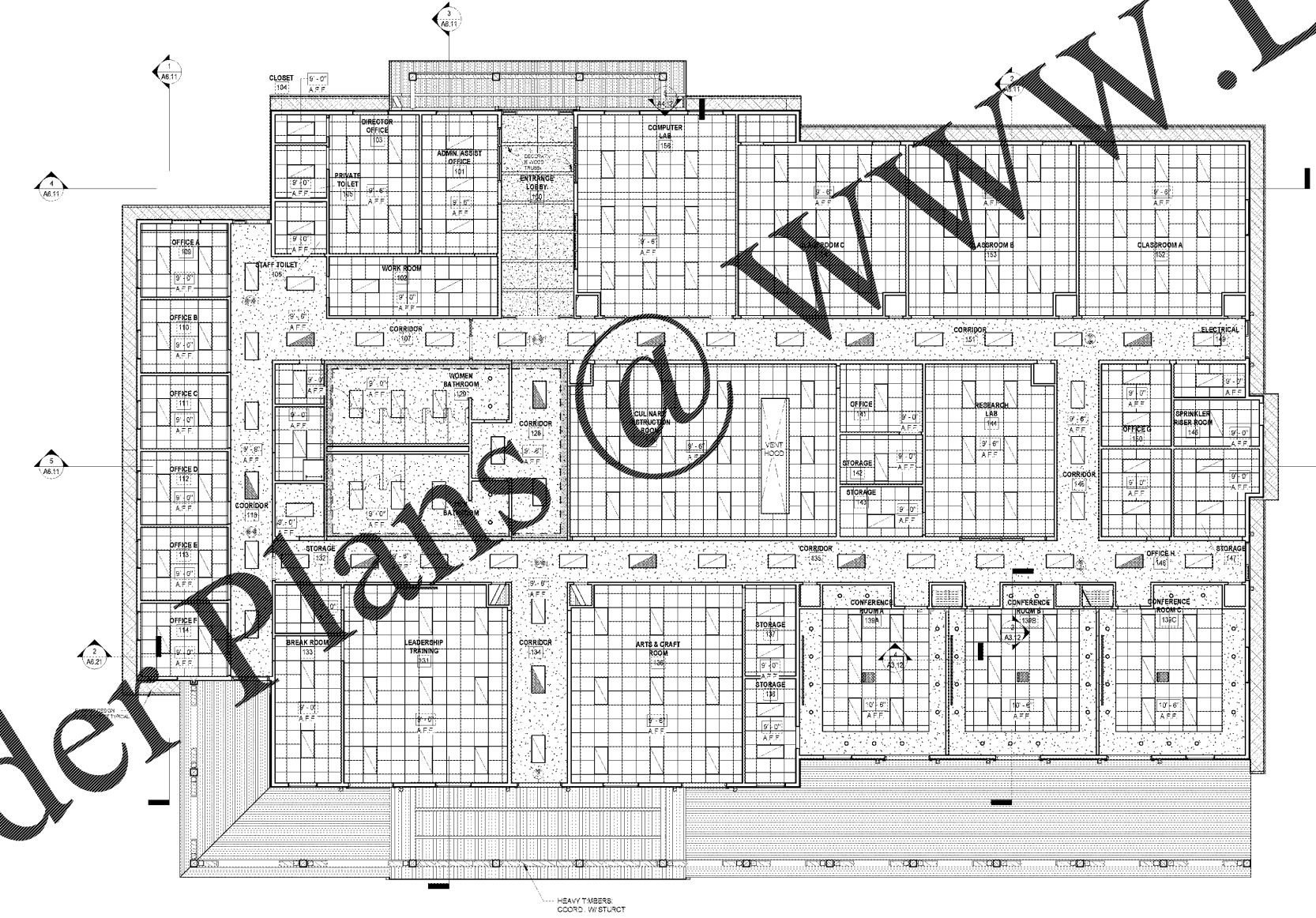

- CEILING TAG**
- ACT - CEILING SYSTEM (WHEN NOT CATED)
 - 10'-0" - CEILING HEIGHT
 - REFER TO LIFE SAFETY PLAN FOR NOMINAL LOCATIONS OF EXIT SIGNS & COORD. RIVAL LOCATIONS W/ LOCAL AUTHORITY HAVING JURISDICTION.
- 2 x 2 SUPPLY DIFFUSER
 - 2 x 2 RETURN DIFFUSER
 - EXHAUST FAN
 - RECESSED DOWNLIGHT
 - 2 x 4 FIXTURE
 - 2 x 4 FIXTURE - EMERGENCY CIRCUIT
 - PROJECTOR
 - RECESSED PROJECTOR SCREEN

REFLECTED CEILING PLAN LEGEND

Order Plans @ www.LDILine.com

PROJECT NORTH
REFLECTED CEILING PLAN
 1/8" = 1'-0"

mc millan | parsons | smith
 architects
 atlanta charlotte charlotte harrisburg
 asheville greenville greenville harrisburg
 p.o. box 8922 greenville, sc 29602-8922
 www.millparsonsmith.com



1890 EXTENSION SC STATE UNIVERSITY
CAMP HARRY G. DANIELS 1890 EXTENSION
FACILITY - RE - BID
 Agency Review ID: H24-9649-CA
 116 Camp Daniels Road, Ellenton, SC

SHEET ISSUE	
NO.	DATE
1	2018.03.27 - R-10 Package

NO.	DATE	DESCRIPTION	BY
1	11/17/2017	OSR REVIEW SUBMITTAL	SS
2			MA
3			SS / CS

SHEET TITLE:
FIRST LEVEL REFLECTED CEILING PLAN

SHEET NO. **A3.11** PROJ. NO. **13140.00**