

S
TM 231

GENERAL NOTES

1. EXISTING ECOLOGY AND AESTHETICS WILL OFTEN CAUSE ADJUSTMENT OF THESE PLANS TO FIT THE SITE. STAKE-OUT BY THE CONTRACTOR AND ADJUSTMENT BY THE LANDSCAPE ARCHITECT IS ABSOLUTELY NECESSARY.
2. LOCATIONS OF THOSE UTILITIES SHOWN ARE APPROXIMATE AND FOR INFORMATION PURPOSES ONLY. CONTRACTOR SHALL BE RESPONSIBLE FOR THE EXACT LOCATION OF ALL UTILITIES WHETHER SHOWN OR NOT SHOWN ON THESE PLANS AND SHALL BE RESPONSIBLE FOR ANY AND ALL DAMAGE RESULTING FROM THE FAILURE TO DO SO. CONTACT PALMETTO UTILITY PROTECTION SERVICE AT 1-888-121-1671 AT LEAST 12 HOURS PRIOR TO COMMENCING CONSTRUCTION.
3. CONTRACTOR SHALL INFORM LANDSCAPE ARCHITECT IF PROPOSED DESIGN IS IN CONFLICT WITH EXISTING OR PROPOSED UTILITIES. CONTRACTOR SHALL COORDINATE WITH LANDSCAPE ARCHITECT PRIOR TO CONSTRUCTION TO ADJUST PROPOSED DESIGN OR UTILITIES AS NECESSARY TO RESOLVE CONFLICTS.
4. BASE PLAN DATA DERIVED FROM SITE SURVEY PROVIDED BY J. J. JOWERS DATED 2/4/2015

**GRIMBALL
COTTELL**
LANDSCAPE ARCHITECTS, LAND PLANNERS

**mcmillan
purdum
smith**
architects

ashville atlanta charlotte denver houston newport news richmond
roanoke san diego washington dc

po box 8922 greenville, nc 28646 252-738-1866 fax 252-738-1866



1890 EXTENSION SC STATE UNIVERSITY
**CAMP HARRY G. DANIELS 1890 EXTENSION
 FACILITY CONSTRUCTION**
 Agency Review ID: H24-9649-CA
 116 Camp Daniels Road, Etowah, SC

SHEET ISSUE:		
NO.	DATE	DESCRIPTION

OSE CD REVIEW SUBMITTAL 12/16/2016

PRINCIPAL IN CHARGE:	TMC
PROJECT ARCHITECT:	TMC
DESIGNER:	ZHW

SHEET TITLE:
**TREE PROTECTION
 PLAN**

SHEET NO. PROJ. NO.
L1.00 13140.00

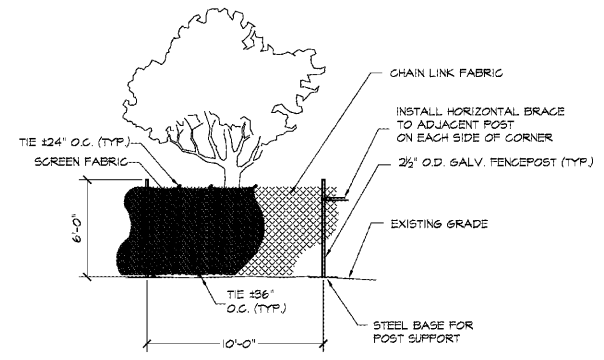

- NOTES:**
1. SEE LANDSCAPE PLANS FOR LOCATION OF TREE PROTECTION FENCING.
 2. PROVIDE PROTECTION FENCE FOR ALL TREES TO REMAIN.
 3. PROTECTION FENCING TO BE PLACED OUTSIDE OF DRIPLINE OF TREE CANOPY UNLESS OTHERWISE INDICATED ON LANDSCAPE PLAN OR APPROVED BY PROJECT MANAGER.
 4. A 4" LAYER OF HARDWOOD MULCH SHALL BE PLACED OVER TREE PROTECTION AREA.
 5. PROTECTION FENCING SHALL BE IN PLACE AND HARDWOOD MULCH PLACED PRIOR TO BEGINNING CONSTRUCTION.
 6. REQUESTS FOR PAYMENT SHALL NOT BE APPROVED UNTIL PROTECTION FENCING AND MULCH IS IN PLACE.
 7. LOCATION OF THE PROTECTION FENCING SHALL BE MARKED BY ARBORIST AND APPROVED BY PROJECT MANAGER BEFORE INSTALLATION. WHERE CONSTRUCTION IS LIKELY TO OCCUR WITHIN 5' OF PROPOSED LOCATION OF PROTECTION FENCING, CONTRACTOR SHALL HAVE LIMITS OF CONSTRUCTION MARKED BY SURVEY BEFORE PROTECTION FENCING IS INSTALLED.
 8. SCREEN FABRIC SHALL BE DARK GREEN 85% OPAQUE POLYETHYLENE KNIT MESH UV STABILIZED WITH BURST STRENGTH OF AT LEAST 2.0 P.S.I.
 9. CONTRACTOR TO ENSURE THAT NO WORK OCCURS BEHIND OR BEYOND LIMITS OF TREE PROTECTION FENCE. CONTRACTOR WILL BE RESPONSIBLE FOR ADDITIONAL TREE PROTECT FENCING BEYOND THE TREE PROTECTION FENCE LIMITS SHOWN AND ANY TREE DAMAGE IF CONSTRUCTION OCCURS AT NO COST TO OWNER. CONTACT LANDSCAPE ARCHITECT AND OWNER IF LIMITS OF CONSTRUCTION ARE TO MOVE BEHIND OR BEYOND THE TREE PROTECTION SHOWN PRIOR TO CONSTRUCTION STARTING.

A
L1.00
TREE PROTECTION FENCING
 NOT TO SCALE

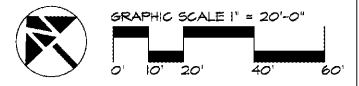

Dec 13, 2016 11:25am C:\Grimball\Active Projects on Maple\A-E Projects\Camp Daniels\CD Base.dwg

Order Plans

WWW.LDOnline.com

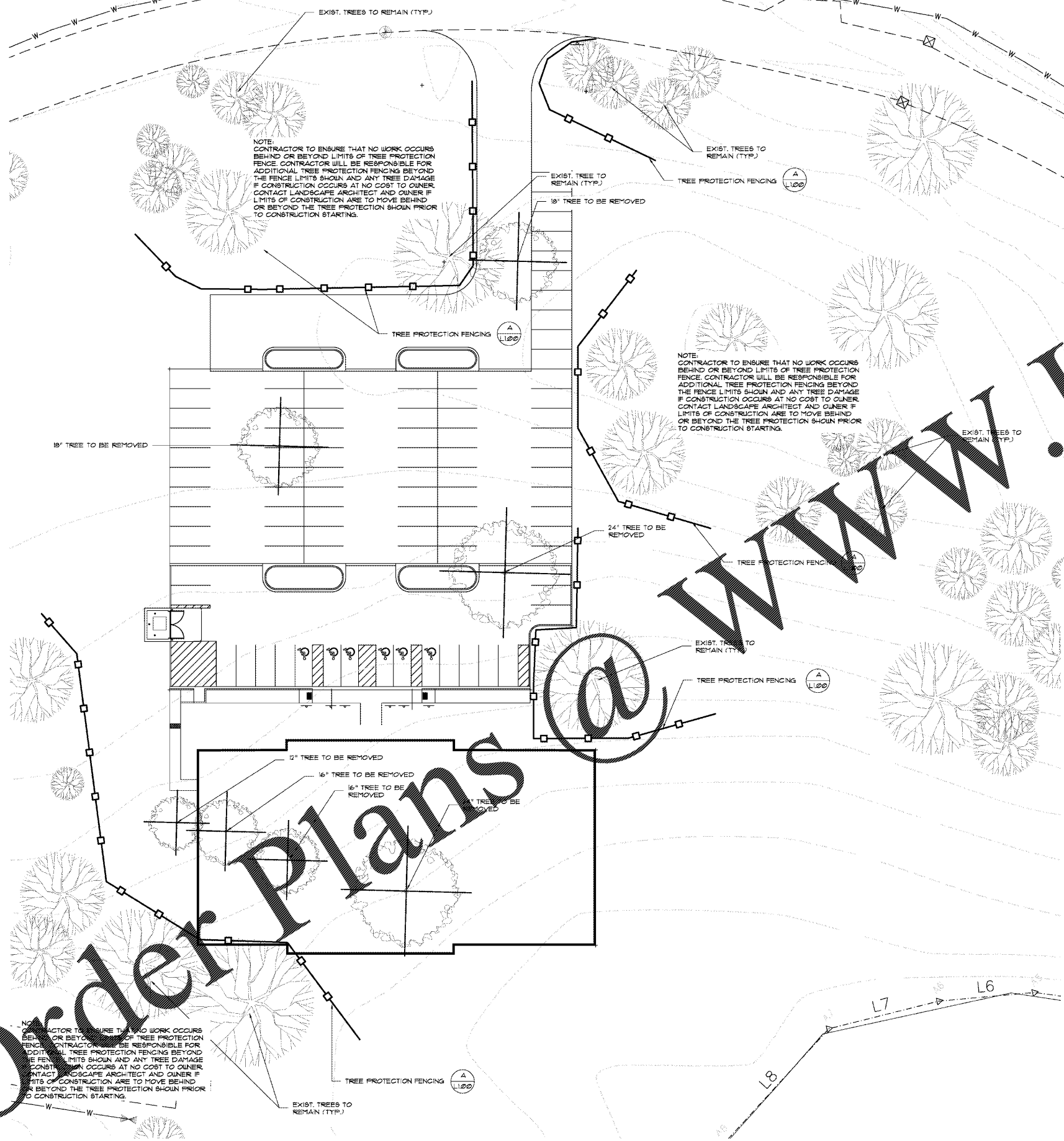

ALL DIMENSIONS UNLESS OTHERWISE NOTED ARE IN FEET AND DECIMALS THEREOF. CONTRACTOR SHALL BE RESPONSIBLE FOR VERIFYING ALL DIMENSIONS AND LOCATIONS OF UTILITIES AND EXISTING CONDITIONS PRIOR TO CONSTRUCTION. CONTRACTOR SHALL BE RESPONSIBLE FOR OBTAINING ALL NECESSARY PERMITS AND APPROVALS PRIOR TO CONSTRUCTION. CONTRACTOR SHALL BE RESPONSIBLE FOR OBTAINING ALL NECESSARY PERMITS AND APPROVALS PRIOR TO CONSTRUCTION. CONTRACTOR SHALL BE RESPONSIBLE FOR OBTAINING ALL NECESSARY PERMITS AND APPROVALS PRIOR TO CONSTRUCTION.