

600 HERITAGE DRIVE DESIGN DOCUMENTS

PARCEL IDENTIFICATION NUMBER

04211008600

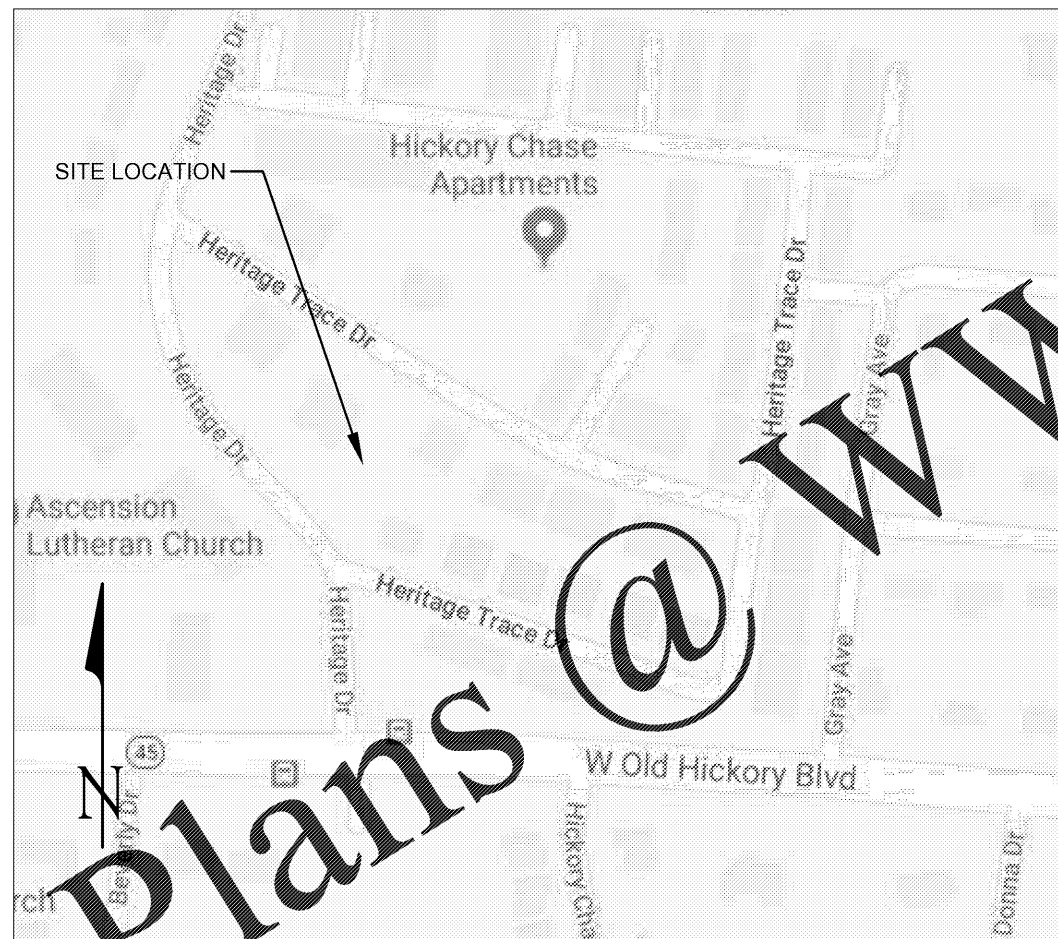

VICINITY MAP

CONTACTS:

OWNER:

VINDI CONSULTING
CONTACT: VERNANT LEE DIXON
EMAIL: LEE@VINDI CONSULTING.COM
PHONE: (601) 848-9924

ENGINEER:

S+H GROUP, LLC
2606 EUGENIA AVENUE
SUITE D
NASHVILLE, TN, 37211
CONTACT: TRIPP SMITH, PE
EMAIL: tripp@shgroupllc.com
PHONE: (615) 645-1560

METROGENIC WORKS:

720 SOUTH 5TH STREET
NASHVILLE, TN 37206
CONTACT: RORY ROWAN
EMAIL: ror@metrogenic.com
PHONE: (615) 862-8782

MWS - STORMWATER:

800 2ND AVE S
NASHVILLE, TN 37210
CONTACT: STEVE MISHU, PE
EMAIL: steve.mishu@stwater.com
PHONE: (615) 862-4780

METRO COUNCIL:

DISTRICT 8
COUNCIL MEMBER: NANCY VANREECE

INDEX OF DRAWINGS

- C0.0 COVER SHEET
- C1.0 EXISTING CONDITIONS
- C2.0 EROSION CONTROL PLAN
- C3.0 SITE LAYOUT PLAN
- C4.0 SITE UTILITY PLAN
- C5.0 GRADING AND DRAINAGE PLAN
- C6.0 DETAIL SHEET

PREPARED BY:

S+H
2606 EUGENIA AVENUE
SUITE D
Nashville, TN 37211

Order Plans

WWW.LDILine.com

DRAFT

600 HERITAGE
DRIVE
MADISON, TENNESSEE

COVER SHEET

S+H ENGINEERING
DESIGN
CONSULTING
2606 EUGENIA AVENUE
SUITE D
NASHVILLE, TN 37211
TEL: 615.645.1560

DATE: JANUARY 15, 2018

SCALE: NOT TO SCALE

DRAWN BY: R.SHELDON

REVIEWED BY: T.SMITH

SHEET NUMBER

C0.0