

Order Plans @ [www.ldline.com](http://www.ldline.com)

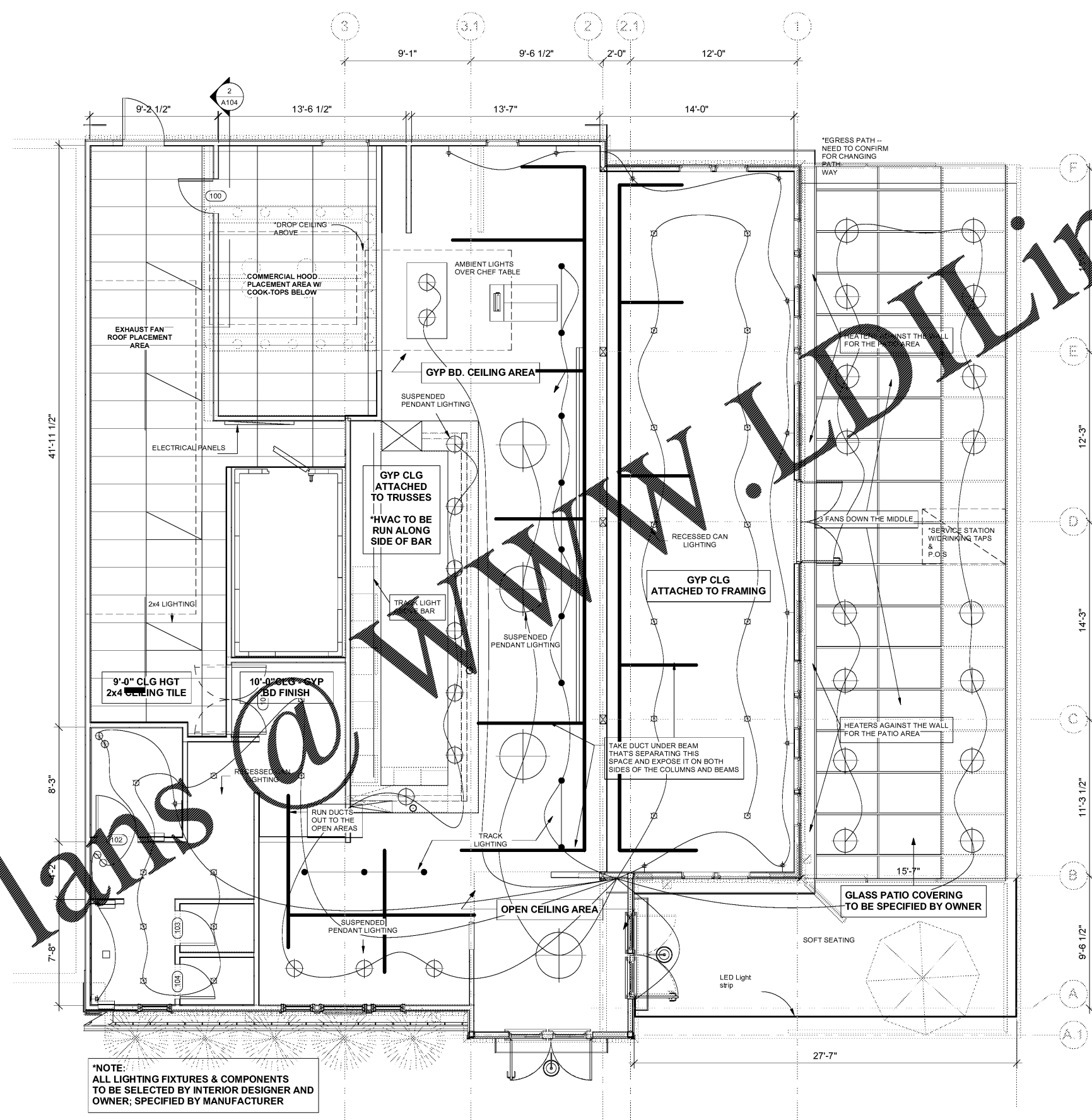

**\*NOTE:**  
ALL LIGHTING FIXTURES & COMPONENTS  
TO BE SELECTED BY INTERIOR DESIGNER AND  
OWNER; SPECIFIED BY MANUFACTURER

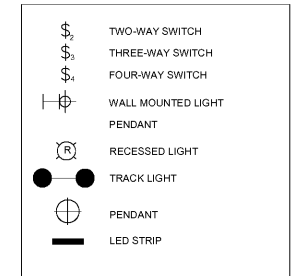

**ELECTRICAL LEGEND**

**NOTES**

\*This floor plan is only representing the interior lighting of the restaurant. Kitchen, bar and landscape are not included on this plan.

**1 PROPOSED CEILING PLAN**  
1/4" = 1'-0"

**LAPEER RESTAURANT**  
8 SOUTH MAIN STREET ALPHARETTA, GEORGIA 30009

**BALDWIN**  
ARCHITECTURAL GROUP  
M. Christopher Baldwin, Architect  
6017 Sandy Springs Cir.  
Atlanta, GA 30328  
(404) 406-9041

**Copyright Ownership**  
This drawing is the property of M.C. Baldwin, Arch. and may not be used, copied, or revised without expressed written permission.

Revision		
No.	Date	By

DATE: 11/19/2017  
DRAWN: SAY  
CHECKED: MCB

JOB NO.  
20170911

SHEET NO.  
**A103**