

DRAWING INDEX

ARCHITECTURAL

- D1 DEMOLITION PLAN
- A1 NEW FRAMING PLAN, DOOR NOTES, LEGENDS AND SCHEDULES
- A2 FLOOR FINISH PLAN, NOTES, LEGENDS AND SCHEDULES
- A3 REFLECTED CEILING PLAN - DEMOLITION
- A3.1 REFLECTED CEILING PLAN - RENOVATION
- A5 EQUIPMENT PLAN AND SCHEDULE
- A6 EXTERIOR ELEVATIONS - DEMOLITION
- A6.1 EXTERIOR ELEVATION - RENOVATION, DETAILS AND WALL SECTION
- A8 MISCELLANEOUS ARCHITECTURAL DETAILS
- A8.1 INTERIOR ELEVATIONS DUNKIN' DONUTS

STRUCTURAL

- S1 FOUNDATION PLAN

MECHANICAL

- M1 MECHANICAL PLAN DEMOLITION LAYOUT
- M2 MECHANICAL PLAN RENOVATION LAYOUT

PLUMBING

- P1 PLUMBING PLAN DEMOLITION LAYOUT
- P2 PLUMBING PLAN RENOVATION LAYOUT

ELECTRICAL

- E0 ELECTRICAL SYMBOL LEGEND AND LIGHTING FIXTURE SCHEDULE
- ED1 TRAVEL CENTER FLOOR DEMOLITION PLAN
- E1 TRAVEL CENTER FLOOR PLAN - LIGHTING
- E2 TRAVEL CENTER FLOOR PLAN - POWER
- E3 TRAVEL CENTER FLOOR PLAN - COMMUNICATIONS ROUGH-IN
- E4 TRAVEL CENTER FLOOR PLAN - FIRE ALARM
- E5 TRAVEL CENTER AND DUNKIN DONUTS ELECTRICAL EQUIPMENT SCHEDULE
- E6 TRAVEL CENTER PANELBOARD SCHEDULES

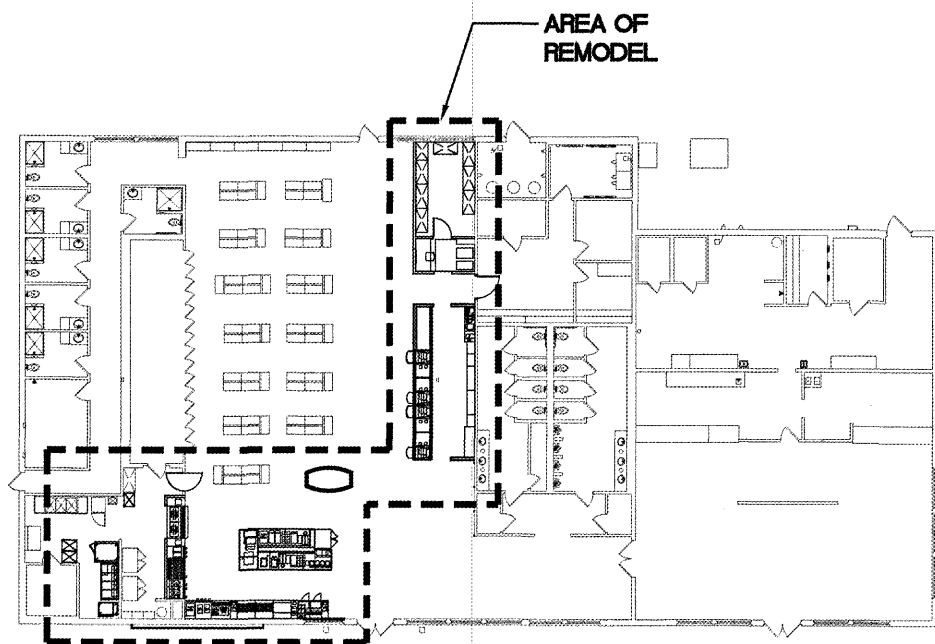

KEY PLAN - FOR REFERENCE ONLY

N.T.S.



PILOT TRAVEL CENTER

15845 WHYTE HARDEE BLVD
HARDEEVILLE, SC 29927

Order Plans @ WWW.LDILine.com

BUILDING INFORMATION	
CODE	
2003 INTERNATIONAL BUILDING CODE	
CLASSIFICATION	
TYPE VB (UNPROTECTED, UNSPRINKLED)	
OCCUPANCY	
PRINCIPLE INTENDED USE - MERCANTILE	
GROUP M - MERCANTILE, CONVENIENCE STORE	
THE PROVISIONS OF SECTION 303.1, EXCEPTION 2 PERMITS THE RESTAURANT WHICH WOULD BE CONSIDERED A-2, TO BE CLASSIFIED AS PART OF THE M OCCUPANCY BECAUSE IT HAS AN OCCUPANCY LOAD OF LESS THAN 50 PERSONS. THEREFORE THE ENTIRE FACILITY IS CONSIDERED GROUP M.	
TOTAL SQ. FOOTAGE:	11,541 SQ. FT.
REMODEL SQ. FOOTAGE:	917 SQ. FT.
NOTE: ALL NEW WORK IS WITHIN AN EXISTING FACILITY. THE RENOVATIONS WILL NOT CHANGE THE EXISTING, USE, OCCUPANCY, EGRESS, STRUCTURE, OR MAJOR SYSTEMS.	
PROJECT SUMMARY	
REMODEL OF AN EXISTING TRAVEL CENTER WITH THE FOLLOWING COMPONENTS:	
- NEW COMMON CHECKOUT	
- NEW DUNKIN' DONUTS SELF SERVE	
PILOT CORPORATION IS THE OWNER/ OPERATOR OF THE ENTIRE FACILITY.	