

GENERAL NOTES

1. THIS PLAN IS FOR WIRING AND SCHEMATIC PURPOSES. DO NOT SCALE THIS PLAN. REFER TO CIVIL SITE PLAN.
2. ALL LOW VOLTAGE WIRING INCLUDING WIRING FOR MUSIC, PAYS AND SPEAKERS SHALL BE RATED FOR 600 VOLTS MINIMUM IF IN A CONDUIT WITH 120V WIRING.

KEYED NOTES

1. LOW VOLTAGE TRANSFORMER FOR LED STALL STARS. TRANSFORMER TO BE ROOF MOUNTED IN WP ENCLOSURE. ELECTRICAL CONTRACTOR SHALL COORDINATE REQUIREMENT WITH LED INSTALLER. CONNECT A MAXIMUM OF (8) STALL STARS PER TRANSFORMER. SEE SHEET A7.01 FOR EXACT NUMBER OF "STALL STARS" & SHEET SP6.01 FOR TRANSFORMER SPECIFICATION.
2. SEE ARCHITECTURAL SHEET A7.01 FOR MORE INFORMATION ON STALL STARS. VERIFY QUANTITY WITH DETAIL.
3. PROVIDE JUNCTION BOXES W/ WP COVER ABOVE CANOPY, MTD. TO ROOF FOR CONNECTION / EXTENSION OF CONDUIT & WIRING FROM CANOPY LIGHTS, MENU LIGHTS, & LED LIGHTING TRANSFORMERS. EXTEND CONDUIT FROM JUNCTION BOX TO ADJ. SUPPORT COLUMN & DOWN COLUMN. EXTEND CONDUIT & CONDUCTORS TO PANEL "A".
4. 1" CONDUIT ABOVE CEILING WITH PULL STRING FOR MUSIC WIRING.
5. MOUNT CANOPY LIGHTING FIXTURES TO CANOPY DECK, ALIGN WITH TOP OF CANOPY COLUMNS.
6. CANOPY LIGHTING CIRCUITRY SHALL BE ROUTED OVERHEAD.
7. 1-1/2" CONDUIT LOOPED OVERHEAD FOR MENU SPEAKER WIRING.
8. 1" CONDUIT LOOPED OVERHEAD FOR MENU LIGHTING.
9. NIGHT LIGHT. CONNECT TO CIRCUIT A5, BYPASS LIGHTING CONTACTOR.
10. CONDUIT U.G. TO JUNCTION BOX FOR SPEAKER WIRE AND MUSIC WIRING.
11. PHOTO CELL ON ROOF FOR LIGHTING CONTROL.
12. WATER RESISTANT, NEMA 3R, J-BOX AT ENTRY/EXIT SIGN. SEE CIVIL PLANS FOR SITE DETAILS & LOCATIONS. VERIFY QUANTITY AND PROVIDE AS REQUIRED.

KEYED NOTES

13. PROVIDE 250V, 30A/2P, NEMA 3R, NON-FUSED DISCONNECT AT BASE OF MAIN SIGN FOR OPTEC SIGNAGE. CONTRACTOR MUST VERIFY LOCATION ON SITE PLAN. EXTEND 1" CONDUIT W/(4) #10 CU THWN AND (1) #10 THWN CU GROUND FROM PANEL A. IF LENGTH EXCEEDS 150', BRANCH CIRCUITRY SHALL BE UP-SIZED TO (4) #8 CU, (10 #8 CU GROUND IN 1" CONDUIT. SIGNS SHALL BE LISTED AND INSTALLED PER LOCAL AMENDMENTS TO NEC.
14. PROVIDE WP, NEMA 3R, JUNCTION BOX ON ROOF AT BASE OF TOWER FOR EACH TOWER SIGN. E.C. TO PROVIDE CONDUIT, WIRING, AND ELECTRICAL CONNECTION. PROVIDE 120V, 1P/20 AMP SWITCH IN ACCESSIBLE LOCATION FOR SIGN DISCONNECT MEANS. SIGNS SHALL BE LISTED AND INSTALLED PER LOCAL AMENDMENTS
15. POLE MOUNTED SITE LIGHTING. CONTRACTOR MUST VERIFY NUMBER AND LOCATIONS ON SITE PLAN. EXTEND 1" CONDUIT W/(2) #8 THWN & (1) #10 CU GROUND FROM EACH POLE LOCATION TO PANEL "A". SEE CIVIL PLANS FOR SITE DETAILS.
16. U.G. DETECTOR LOOP, SPEAKER PEDESTAL, & MENU BOARD. SEE CIVIL PLANS FOR SITE DETAILS.
17. 2" CONDUIT UNDERGROUND FOR MENU SPEAKER WIRING.
18. 2" CONDUIT UNDERGROUND FOR ORDER PEDESTAL, MENU, & MENU LIGHTING.
19. PROVIDE SURFACE MOUNTED WP, NEMA 3R, GFCI DUPLEX RECEPTACLE AT 18" A.F.F. WITH WEATHER RESISTANT IN-USE COVER.
20. NOT USED
21. NOT USED
22. NOT USED
23. PROVIDE (1) 5/8" X 8" GALVANIZED GROUND ROD AT BASE OF MAIN SIGN. INSTALL (1) #6 CU GROUND WIRE IN CONDUIT UP THE POLE TO A HEIGHT OF 12' ABOVE GRADE. LEAVE 15' EXCESS OF THE GROUND WIRE FOR BONDING TO INCOMING GROUND WIRE. CONNECTION BY OTHERS.
24. NOT USED
25. AUTOMATIC LAWN SPRINKLER CONTROLLER. MOUNTED AT 60" A.F.F.. INSTALL 1-1/2" CONDUIT U.G. TO NEAREST LANDSCAPE AREA. WIRING BY OTHERS. REF: LANDSCAPE PLAN, IF PROVIDED. VERIFY EXACT LOCATION.
26. 120V, 1PH, 20 AMP GFI RECEPT. FOR AUTOMATIC SPRINKLER CONTROLLER AND HEAT TAPE FOR HOT AND COLD WATER LINES. REFER TO SHEET E2.02 FOR LOCATION & CIRCUIT INFORMATION.
27. PROVIDE POWER & LOW VOLTAGE CONDUIT FOR POLE MOUNTED SIGN. VERIFY SIZE OF CONDUIT AND ALL SIGN REQUIREMENTS PRIOR TO BID AND INCLUDE IN BID. ADJUST ACCORDINGLY. SIGNS SHALL BE LISTED AND INSTALLED PER LOCAL REQUIREMENTS.
28. PROVIDE POWER & ALL ASSOCIATED COMPONENTS FOR BACKFLOW DEVICE WIRING CONNECTION. VERIFY LOCATION AND ALL REQUIREMENTS PRIOR TO BID AND INCLUDE IN BID. ADJUST ACCORDINGLY.
29. PROVIDE 2" CONDUIT U.G. TO JUNCTION BOX WITH PULL STRING FOR FUTURE POWER TO COLUMN AS SHOWN.
30. PROVIDE 3/4" CONDUIT U.G. TO JUNCTION BOX WITH PULL STRING FOR FUTURE POWER TO COLUMN AS SHOWN.
31. PROVIDE JUNCTION BOXES W/ WP COVER ABOVE CANOPY, MTD. TO ROOF FOR FUTURE CONNECTION / EXTENSION OF CONDUIT & WIRING.
32. PROVIDE 3/4" CONDUIT U.G. TO JUNCTION BOX FOR EVERY 15 STALLS.
33. PROVIDE 2" CONDUIT U.G. FOR EVERY 8 STALLS WITH PULL STRING FOR PAYS, MUSIC, & SPEAKER WIRING.
34. PROVIDE WP, NEMA 3R, JUNCTION BOX FOR CANOPY SIGN. E.C. TO PROVIDE CONDUIT, WIRING, AND ELECTRICAL CONNECTION. PROVIDE 120V, 1P/20 AMP SWITCH IN ACCESSIBLE LOCATION FOR SIGN DISCONNECT MEANS.

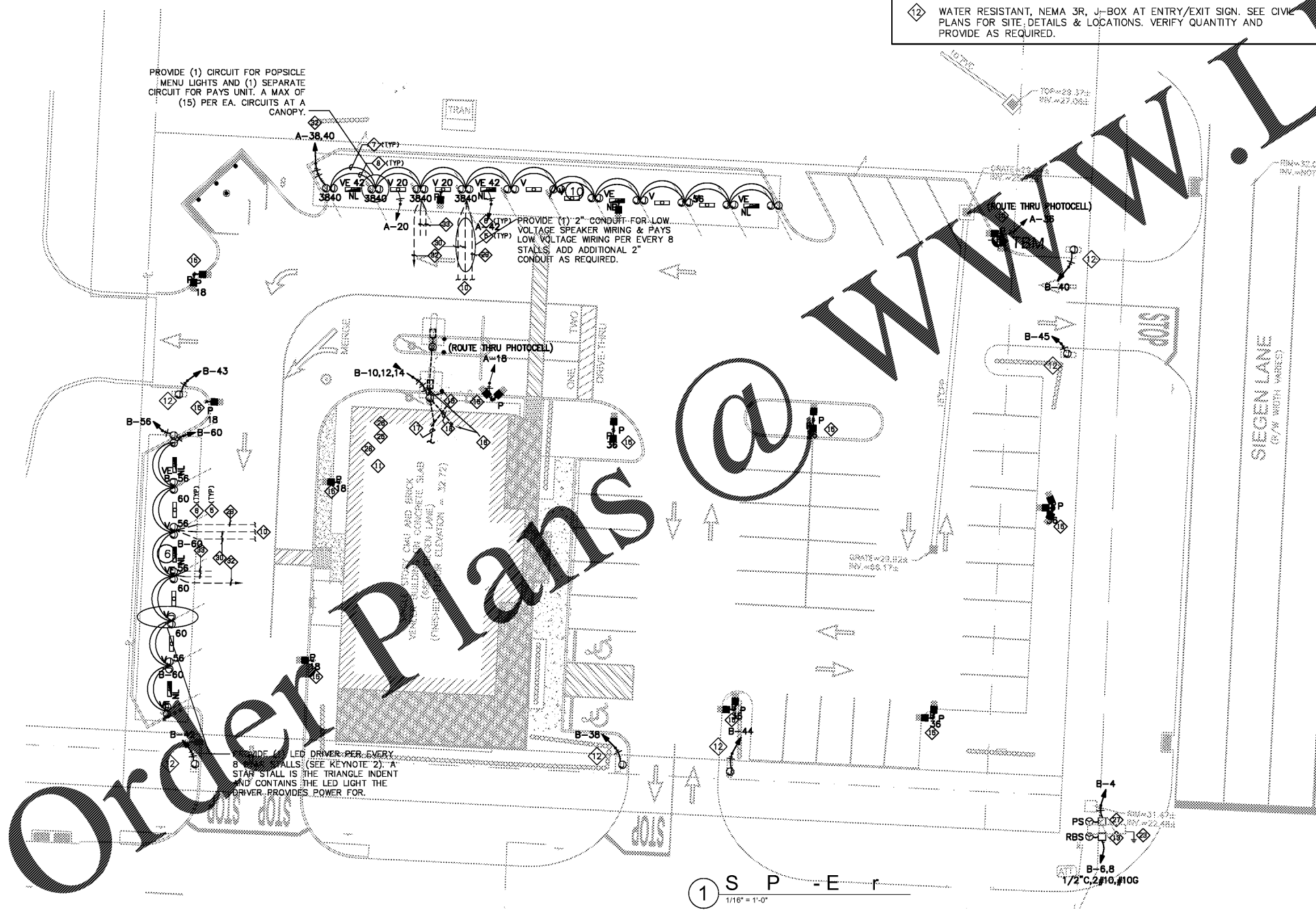

Order Plans

WWW.LDLINE.COM



STORE #6679

6808 SIEGEN LANE
BATON ROUGE, LA 70809

PROJ. NO.: 1722
DATE: 01/22/2018

SHEET TITLE:
SITE PLAN -
ELECTRICAL

DRAWING SHEET IS FULL SIZE AT 22" x 34"
REDUCED 11" x 17" SHEET IS HALF SIZE

SHEET NO.: E1.01