

www.DLine.com

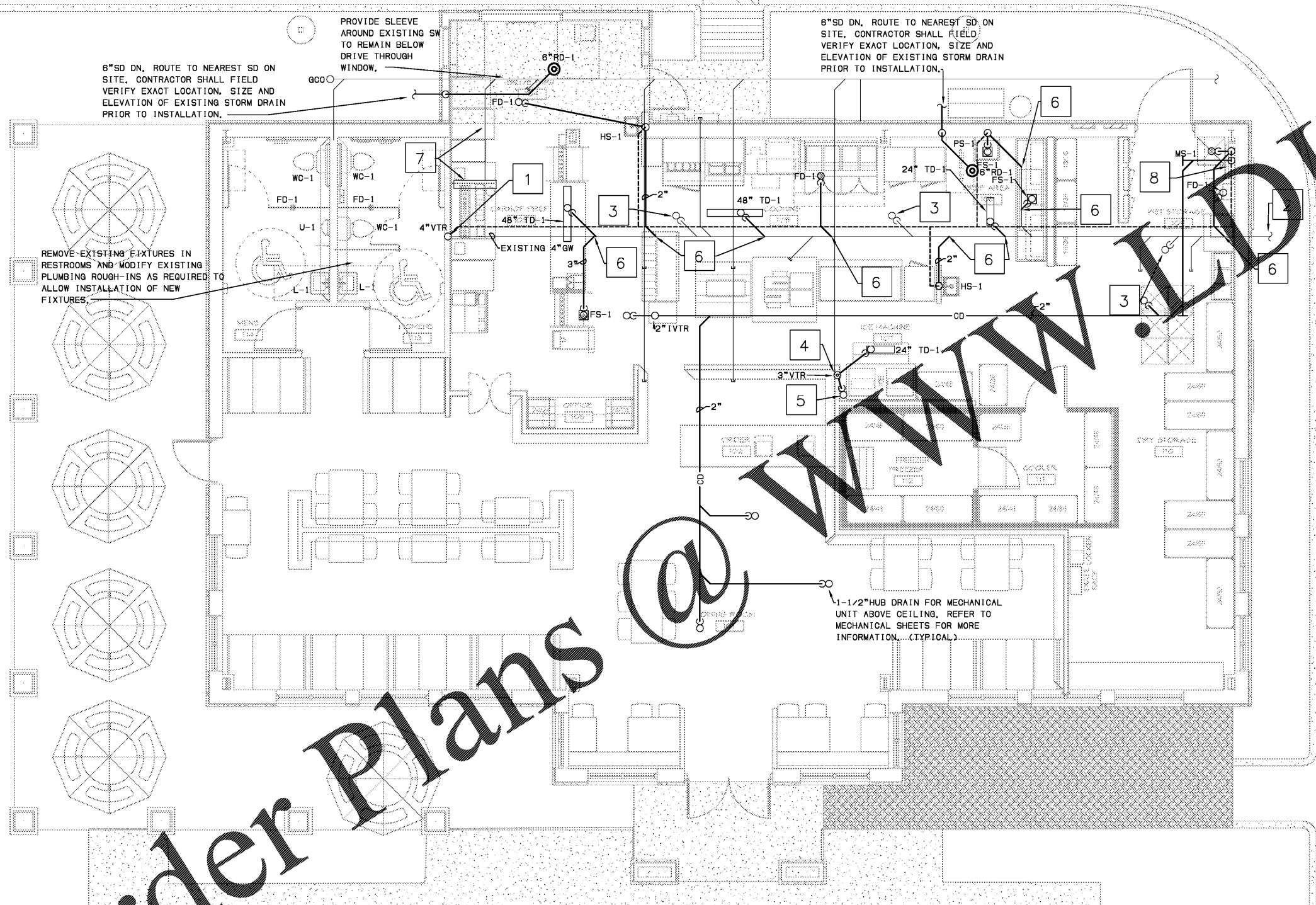

KEY NOTES:

- 1 RELOCATE EXISTING 4"GW AND GV TO NEW WALL.
- 2 EXISTING 4"GW TO EXISTING 200 LBS GREASE TRAP.
- 3 EXISTING FLOOR DRAIN TO REMAIN. COORDINATE WITH OWNER AND ARCHITECT TO VERIFY IF LOCATION ON EXISTING DRAIN IS ACCEPTABLE.
- 4 CONNECT NEW SW TO EXISTING SW. CONTRACTOR SHALL FIELD VERIFY EXACT LOCATION, SIZE AND ELEVATION OF EXISTING SW PRIOR TO INSTALLATION.
- 5 PROVIDE NEW 2" HUB DRAIN FOR FREEZER/COOLER AND MECHANICAL UNIT CONDENSATE.
- 6 CONNECT NEW GW TO EXISTING GW. CONTRACTOR SHALL FIELD VERIFY EXACT LOCATION, SIZE AND ELEVATION OF EXISTING GW PRIOR TO INSTALLATION.
- 7 EXISTING TRENCH DRAIN TO REMAIN. REMOVE EXISTING VENT FOR TRENCH DRAIN.
- 8 ROUTE 2"CD DN IN WALL. TERMINATE ABOVE MOP BASIN WITH AIR GAP.



STORE #6679

6808 SIEGEN LANE  
BATON ROUGE, LA 70809

PROJ. NO.: 1722  
DATE: 01/22/2018

SHEET TITLE:  
**FLOOR PLAN -  
PLUMBING**

DRAWING SHEET IS FULL SIZE AT 22" x 34"  
REDUCED 11" x 17" SHEET IS HALF SIZE

SHEET NO.:

P1.01

**1 FLOOR PLAN - DWV PIPING**  
1/4" = 1' - 0"

Order Plans