

PRINTED: 2/9/2019 3:06 PM  
 FILE PATH: \\PACSRV08\Civil\Jobs\10893 - SONIC - 6808 SIEGEN LN - BATON ROUGE\DESIGN\SHEETS\10893 Details-Pavement.dwg

**Original Plans @**

\* TRUNCATED DOME SURFACING WIDTHS SHALL BE GREATER THAN 48" WHERE PERPENDICULAR SIDEWALK INTERSECT AT THE EDGE OF THE ROADWAY. IN THESE AREAS THE TRUNCATED DOME SURFACE SHALL SPAN THE ENTIRE WIDTH OF THE SIDEWALK AS SHOWN ON THE PLAN SHEETS.

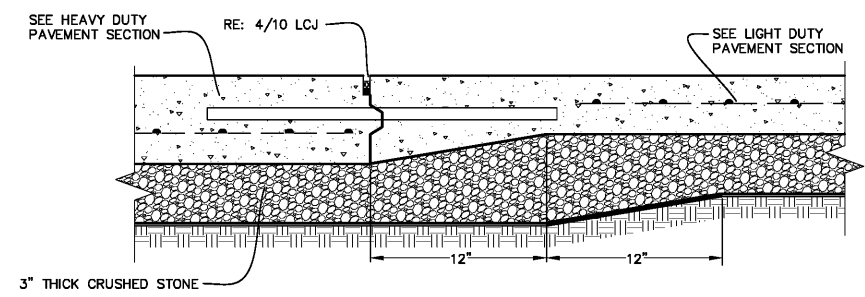

**6 PAVEMENT THICKNESS TRANSITION**  
N.T.S.

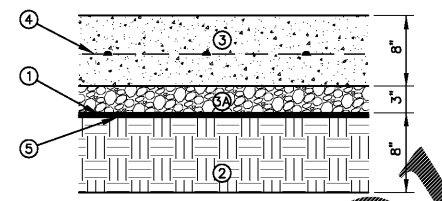

**5 DUMPSTER AREA CONCRETE PAVEMENT**  
N.T.S.

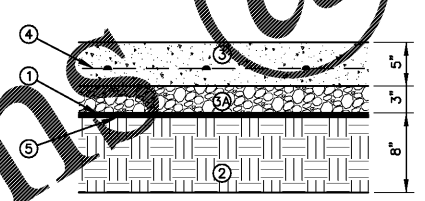

**4 LIGHT DUTY CONCRETE PAVEMENT**  
N.T.S.

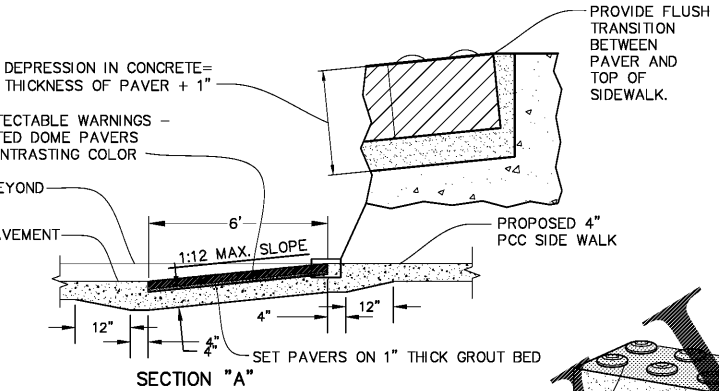

**8 TRUNCATED DOME DETAIL**  
N.T.S.

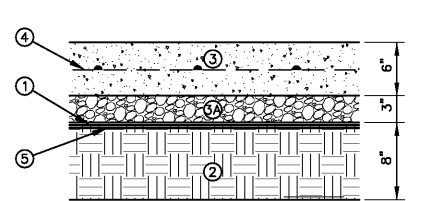

**3 HEAVY DUTY CONCRETE PAVEMENT**  
N.T.S.

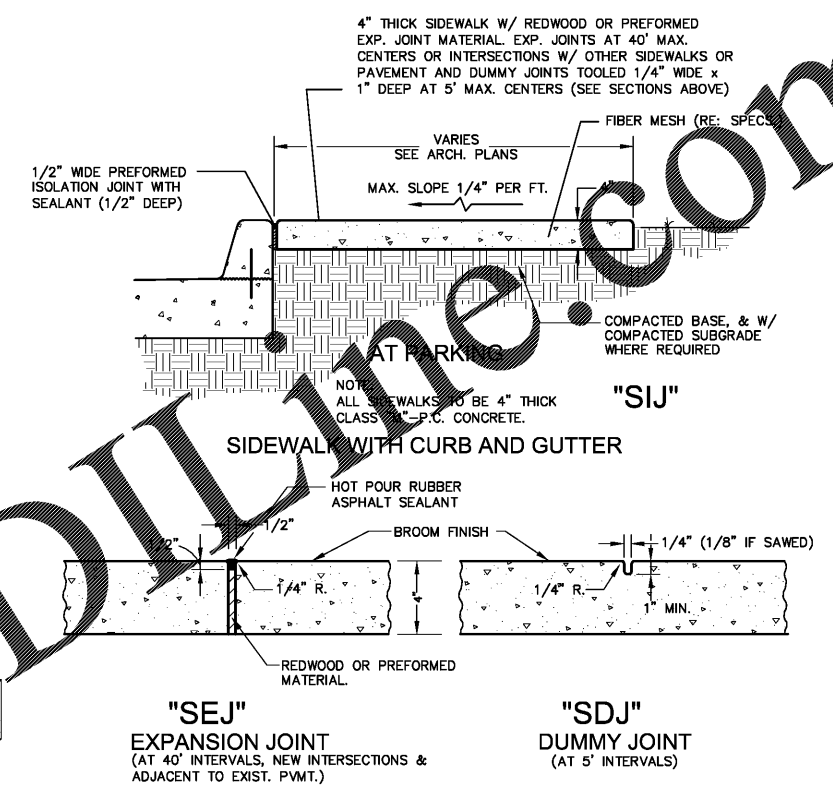

**2 SIDEWALK DETAILS**  
N.T.S.

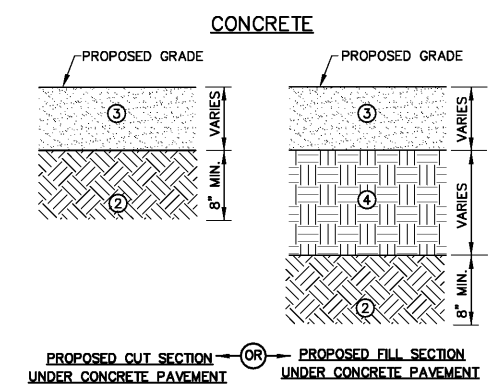

**1 TYPICAL EARTHWORK SECTIONS**  
N.T.S.

- 1 TOPSOIL LAYER - REMOVE 6" MINIMUM LAYER OF SURFICIAL VEGETATION, TOPSOIL, ORGANICS AND ANY SOFT OR LOOSE SOILS AND STOCKPILE FOR USE IN LANDSCAPING OR REMOVE FROM SITE.
  - 2 EXISTING SUBGRADE - PAVEMENT SUBGRADE SHOULD BE TESTED TO ENSURE PI IS LESS THAN OR EQUAL TO 22. SHOULD IT BE ABOVE 22, MATERIAL SHALL BE REMOVED AND REPLACED WITH SELECT FILL. THEN SUBGRADE SHALL BE SCARIFIED AND RECOMPACTED. MATERIAL SHOULD BE PROFFERED WITH A HEAVY, LOADED PNEUMATIC-TIRED VEHICLE (20 TO 25 TON) AND COMPACTED TO 95% STANDARD PROCTOR (ASTM D698) AT -1% TO +3% THEORETICAL OPTIMUM MOISTURE (8" MIN.). SUBGRADE AREAS WHICH ARE UNSTABLE SHOULD BE EXCAVATED AND REPLACED WITH DENSITY APPROVED SELECT FILL.
  - 3 PROPOSED PAVEMENT AND BASE MATERIAL (RE: SEE PAVEMENT DETAILS THIS SHEET).
  - 4 SELECT FILL MATERIAL - SHALL BE FREE OF ORGANIC OR OTHER DELETERIOUS MATERIALS, HOMOGENEOUS MIXTURE, HAVE A MAXIMUM PARTICLE SIZE OF THREE (3) INCHES, HAVE A MAXIMUM LIQUID LIMIT OF 40 AND A PLASTICITY INDEX BETWEEN 8 AND 20, AND CONSIST OF SILTY-CLAYED SANDS (SM-SC), LOW PLASTICITY SANDY CLAYS (CL), OR CLAYEY SANDS (SC) AS DEFINED BY THE UNIFIED SOIL CLASSIFICATION SYSTEM. FILL SHOULD BE PLACED IN MAXIMUM LIFTS OF 8" AND BE COMPACTED TO AT LEAST 95% OF STANDARD PROCTOR MAXIMUM DENSITY (ASTM D698) AT -1% TO +3% OPTIMUM MOISTURE CONTENT.
- GENERAL:**  
 THE PROOF-ROLLING, UNDERCUTTING AND FILLING ACTIVITIES SHOULD BE WITNESSED BY A REPRESENTATIVE OF THE GEOTECHNICAL ENGINEER AND SHOULD BE PERFORMED DURING A PERIOD OF DRY WEATHER.

<input checked="" type="checkbox"/>	THIS DRAWING IS APPROVED FOR CONSTRUCTION.
<input type="checkbox"/>	THIS DRAWING IS NOT APPROVED FOR CONSTRUCTION.
DRAWN BY	P/AF
DATE	
REVISION	DATE
CHECKED	T.C.D
BOOK NO.	N/A
JOB NO.	
DWG. NO.	10893
SCALE	SHOWN 1/2" = 1'

OWNER	KERGAN BROTHERS - SONIC DRIVE-IN RESTAURANT
PROJECT	SONIC DRIVE-IN RESTAURANT #6679
	6808 SIEGEN LANE
	BATON ROUGE, LA 70809
SHEET NUMBER	10
	OF 14

THE LOCATION OF EXISTING UNDERGROUND UTILITIES ARE SHOWN IN AN APPROXIMATE WAY ONLY. THE CONTRACTOR SHALL DETERMINE THE EXACT LOCATION OF ALL EXISTING UTILITIES BEFORE COMMENCING WORK. HE AGREES TO BE FULLY RESPONSIBLE FOR ANY AND ALL DAMAGES WHICH MIGHT BE OCCASIONED BY HIS FAILURE TO EXACTLY LOCATE AND PRESERVE ANY AND ALL UNDERGROUND UTILITIES.



CALL LOUISIANA ONE CALL - JUST DIAL 811  
 LOUISIANA STATE LAW, SECTION R.S. 40:1749.15, REQUIRES EXCAVATORS AND DEMOLISHERS TO NOTIFY A REGIONAL NOTIFICATION CENTER BY TELEPHONE 48 HOURS TO 120 HOURS IN ADVANCE OF ANY EXCAVATION OR DEMOLITION ACTIVITY. THE OWNERS/OPERATORS OF ANY UNDERGROUND FACILITY MUST THEN MARK THE AREA OR PROVIDE INFORMATION THAT WILL ENABLE AN EXCAVATOR OR DEMOLISHER TO DETERMINE THE LOCATION OF UNDERGROUND FACILITIES.

THESE DRAWINGS DO NOT INCLUDE COMPONENTS FOR CONSTRUCTION SAFETY.

SCALE NOTE  
 SCALE BAR SHOWN IS ONE INCH LONG AT FULL SCALE WHEN SCALING DRAWINGS. MEASURE BAR TO DETERMINE IF SCALE SHOWN WILL REQUIRE ADJUSTING.



10893